

Arboricultural Impacts: Summary
(For details, see below)

| Impact | No. of Trees |
|--|--------------|
| Trees to be removed | 0 |
| Groups of trees to be partially removed | 1 |
| TPO trees to be removed | 0 |
| Trees and groups of trees or shrubs to be pruned | 5 |
| Trees where supervised demolition needed within RPAs | 1 |
| Trees where manual excavation needed within RPAs | 2 |
| Trees where above soil surfacing needed within RPAs | 1 |
| Trees with proposed underground services within RPAs | 0 |

Trees/Groups to be Removed

| No | Species | Category |
|----|---------------------------|----------|
| G3 | Various (partial removal) | C (1) |

Trees to be pruned

| No. | Species | Works (Outline only) |
|-----|-----------------|--|
| 3 | Leyland cypress | Crown lift W canopy extends back to boundary to a height of 2m above ground, to increase space available for proposed planting |
| 6 | Hazel | Crown reduce eastern extents by up to 2.5m, leaving no less than 2.5m from copse centre |
| G2 | Cherry laurel | Prune eastern canopy extents back to boundary to allow space for proposed planting |
| G5 | Yew | Cut back area of southern extents as indicated on plan by up to 1m to provide clearance for proposed area of hard surfacing |
| G6 | Various | Crown reduce north extents of cherry laurel back by up to 1.5m, towards but not beyond site boundary |

Pruning is to be undertaken in accordance with the British Standard Recommendations for Tree work, BS3998: 2010. Climbing irons or spikes are not to be used whilst pruning trees.

Groups that require manual excavation within RPAs

| No. | Species | Type of structure |
|-----|---------|--------------------------|
| G5 | Yew | Proposed hard surfacing |
| G6 | Various | Proposed access driveway |

Trees that require above soil surfacing within RPAs

| No. | Species | Type of structure |
|-----|--------------|--------------------------|
| 2 | Copper beech | Proposed access driveway |

Manual Excavation

Within the root protection areas of groups G5 & G6, the first 750mm depth of any excavation, whether for hard surfacing, or underground services shall be undertaken by hand under arboricultural supervision. The soil will be loosened with a pick or fork, and then will be cleared from roots with a compressed air soil pick. All roots will be cut cleanly with a hand saw or secateurs. The edge of the excavation closest to the trees will be covered with hessian sacking to prevent drying out.

Above Soil Surfacing

Proposed hard surfacing within the root protection area (RPA) of copper beech no. 2 to be constructed in accordance with section 7.4 of BS 5837: 2012. Trees in relation to design, demolition and construction - Recommendations. Other than the careful removal, using hand tools, of any turf layer, surfaces will be installed above existing soil level, or no deeper than the base of any existing surfacing it is replacing, so that the soil is not disturbed and no roots are severed; and an appropriate ground covering, possibly using a geogrid, a geoweb, or a combination of the two will be placed beneath the sub-base to minimise compaction of the soil in which tree roots are growing. Edge supports will also be installed above existing soil level.

Ground Protection

To be installed prior to commencement of demolition or construction works, at same time as erection of protective fencing. For purely pedestrian traffic: scaffold boards or similar, of at least 35mm thickness, butted together and attached to each other with wooden battens or steel tie straps, laid either on an above ground scaffold framework, or on a compressible material (a 75mm deep layer of woodchips may be appropriate) above a biaxial geotextile grid ('geogrid' - 'Tensar' or similar) and pinned to the ground with steel pins to prevent movement. For wheeled or tracked traffic: temporary aluminium roadway ('Trakway' or similar), interlocking polyethylene tread boards ('Ground-Guards' or similar), or reinforced concrete slabs laid on an appropriate compressible layer above a biaxial geotextile grid - to be designed by a structural engineer to accommodate likely loadings.

Trees that require supervised demolition within RPAs

| No. | Species | Type of structure / surface |
|-----|--------------|-----------------------------|
| 2 | Copper beech | Dwelling extension |

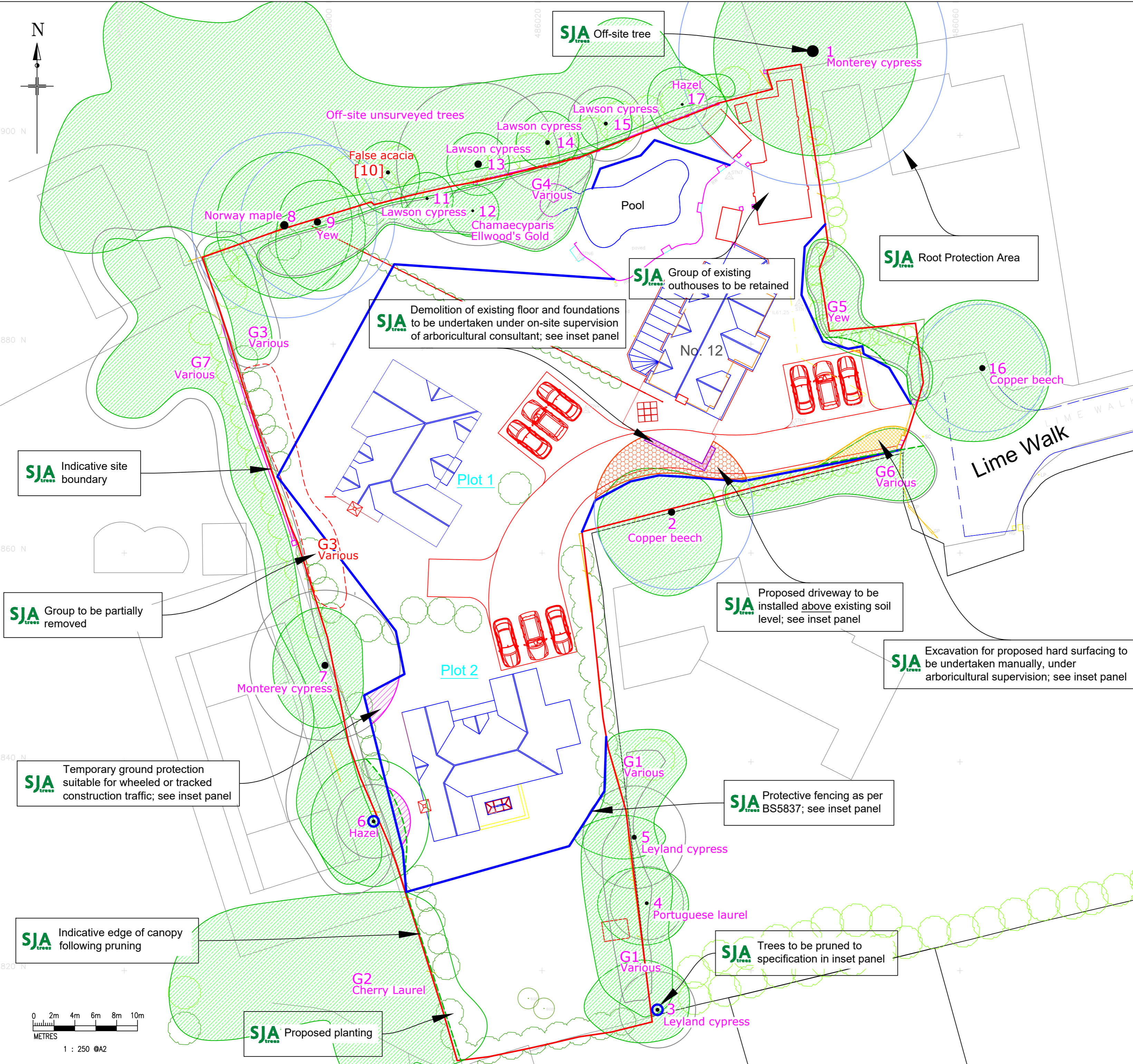

Protective Fencing

To be erected prior to the commencement of all works on site, and retained in place throughout construction. To comprise either 2.4m wooden site hoarding; or a 2m high scaffolding framework, with uprights at maximum 3m spacings, every other one braced to the ground with 45 degree struts; supporting standard anti-climb 'Heras' welded mesh fence panels secured with anti-lift devices to concrete or plastic bases pinned to the ground by scaffold uprights sunk to a minimum depth of 600mm; individual panels fixed to each other with at least 2 clamps and to scaffolding with heavy-duty cable ties. "TREE PROTECTION ZONE - KEEP OUT" or similar notices to be attached to every fifth panel.

TREE PROTECTION FENCING as shown in BS 5837: 2012, Section 6.2.2 & Figure 2.

Arboricultural Supervision

The arboricultural consultant will directly supervise all construction works that have to be undertaken within root protection areas. These include:

1. Location of protective fencing and ground protection.
2. Demolition of existing building foundations.
3. Construction of proposed hard surfacing.
4. All excavations within RPAs, whether for proposed foundations, hard surfacing, or underground services.

| | | |
|--------|------------|--|
| Rev. a | 16/04/2023 | Revision of protective fencing to protect wider areas of soft ground to preserve the soil structure for planting |
|--------|------------|--|

SJA ARBORICULTURAL PLANNING CONSULTANTS

Project: 12 Lime Walk, Maidenhead

Client: Mr Booker & Ms Juj C/o Consilio planning

Drawing: TREE PROTECTION PLAN

Drawing No: SJA TPP 24042-41a

Based On: 01-7293

Drawn By: TES Date: April 2024 Scale: 1:250 @ A2

Checked by: FPS/NHK Tel: (01737) 813058 sja@sjatrees.co.uk

| | | |
|----------------|----------------------------|-----------------------------------|
| Tree nos.: ● 1 | Category 'U' trees: ● [10] | Canopies of trees to be retained: |
|----------------|----------------------------|-----------------------------------|

| | | |
|-------------------|-------------------|----------------------|
| Category 'B' RPA: | Category 'C' RPA: | Trees to be removed: |
|-------------------|-------------------|----------------------|

| | | |
|---------------------|-----------------------|--------------------|
| Protective fencing: | Above soil surfacing: | Manual excavation: |
|---------------------|-----------------------|--------------------|

| | | |
|--------------------------|------------------------|-------------------|
| Indicative pruning line: | Supervised demolition: | Pruning required: |
|--------------------------|------------------------|-------------------|

| | | |
|--------------------|--|--|
| Ground protection: | | |
|--------------------|--|--|

For further information refer to the SJA's Tree Survey Schedule. Do not scale from this drawing; please check all dimensions on site, and notify us of any discrepancies. SJA's (the trading name of Simon Jones Associates Ltd.) cannot be held responsible for inaccuracies in the topographical plan on which this drawing is based. © Simon Jones Associates Ltd. 2024. This drawing is copyright and may not be used or changed without the written consent of SJA's. This drawing is based on the proposed layout plan shown and referred to above. SJA's authorises its reproduction, without amendment, by the Local Planning Authority (LPA), and its posting on the LPA website, to assist in consideration of this application only. This drawing is designed to reflect only the principles of layout and for design insofar as these relate to the protection of trees to be retained, and should NOT be read as a definitive engineering or construction method statement. Reference should be made to the architect or structural engineer, as appropriate, over any matters of construction detail or specification, or any engineering standards or regulatory requirements relating to proposed structures, hard surfaces or underground services.

