



## STRYDER<sup>V2</sup> TROUGHLIGHT

### Stryder V2 Troughlight - New Features

Some of the new and updated features of the Stryder V2 Troughlight are:

- The system is now IP66 certified. The Connectors, Cable Glands & Blanking Plugs are IP68 rated.
- The system has a slimmer profile body.
- There are now joining connectors allowing the maximum system size to be limitless (single piece limited to 6m)
- The new lens design maximises illumination effect and optimises the light direction.

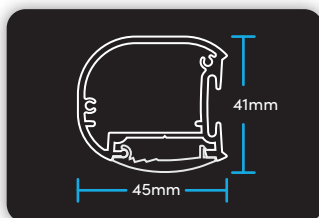

### Stryder V2 Troughlight - Component Breakdown

#### IP68 Joining Connector

Connect Multiple troughlights together without any visible connections or cables.



MW121 Silver is nearest match to silver Anodised main body

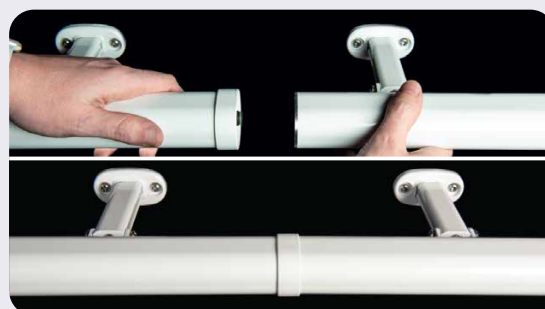

#### Slimmer Profile

Over 30% smaller than the previous troughlight design, with a closed profile to isolate power supply and cables.

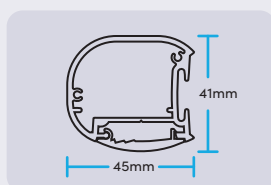

#### IP66 Certified

Full protection against dust and other similar particles.

Protection against powerful jets of water at a rate of 100 litre per minute (100kPa of Pressure)

**3 year parts warranty**

T&C's apply



## Stryder V2 Troughlight - Component Breakdown Continued...

### Optical Lens

The new clear polycarbonate lens is designed to get the most from the 24v LED strips installed (cool White or warm White) in the troughlight giving even more illumination distance and optimising light direction.

The lens is sealed using a Neophene sponge cord to stop dust/water ingress.

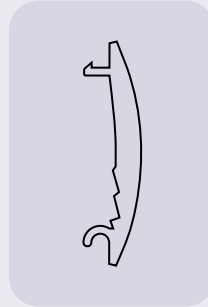

### Main Body Extrusion

The main troughlight extrusion comes at a maximum length of 6m. If a longer length is needed, multiple troughlights can be connected together using the IP68 joining connectors with no visible connections or cable.

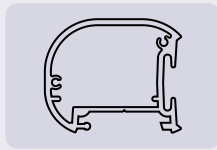

The Stryder V2 6m trough light stock finishes are; Mill, Silver Anodised, White, Black & Bespoke RAL/BS colour Powder Coating.



### End Cap Options

Our Cast End Caps (left & Right) come in different paint options. The M16 Tapped hole is to mount either a cable gland or a blanking plug depending on which side you require the power cable exiting. Complete with a EPDM Sponge Rubber Gasket to seal the product.

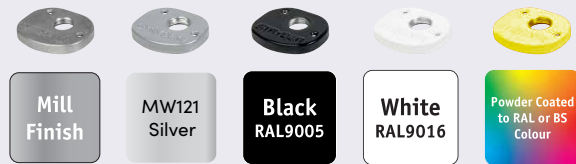

MW121 Silver is nearest match to silver Anodised main body

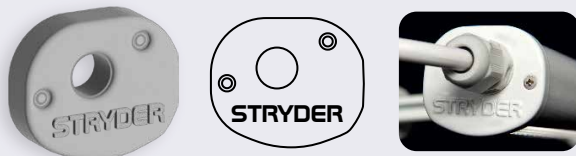

### M16 Cable Gland & Blanking Plug Colours

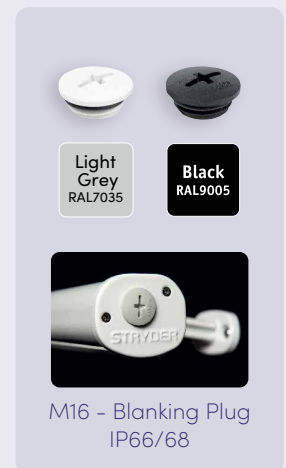
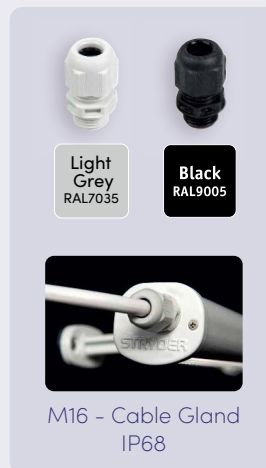

## Stryder V2 Troughlight - Component Breakdown Continued...

### Mounting Options



Wall Bracket



Tray Bracket



Double Bracket



Channel Bracket



Panel Bracket

### LED Colour Options

Two LED colour temperature options available from stock.



24v warm White LED strip 3000k (1260lm/M)



24v cool White LED strip 6000k (1330lm/M)



## Contact Us

### Main Office

Sign Supplier  
Unit 15 Dale Industrial Estate  
Radcliffe  
Manchester  
M26 1AD

### Contact

0800 133 7555  
info@signsupplier.co.uk



**SIGN SUPPLIER**



# Installation Guide

## Mounting/System Types

- 2 **Wall Bracket Mounting**
- 4 **Wall Bracket Mounting - With Joining Connector(s)**
- 7 **Channel Bracket Mounting**
- 9 **Top Tray Bracket Mounting**
- 11 **Plate Bracket Mounting**
- 13 **Double Sided Bracket Mounting**
- 16 **Optimum Lighting Chart Mounting**



## Contact Us

### Main Office

Sign Supplier  
Unit 15 Dale Industrial Estate  
Radcliffe  
Manchester  
M26 1AD

### Contact

0800 133 7555  
info@signsupplier.co.uk



**SIGN SUPPLIER**

## Wall Bracket Mounting

### Tools Required

- Drill
- Tape Measure
- Screwdriver (Phillips)
- Hex Key



### Step 1:

Mount the brackets to the wall in the desired position.

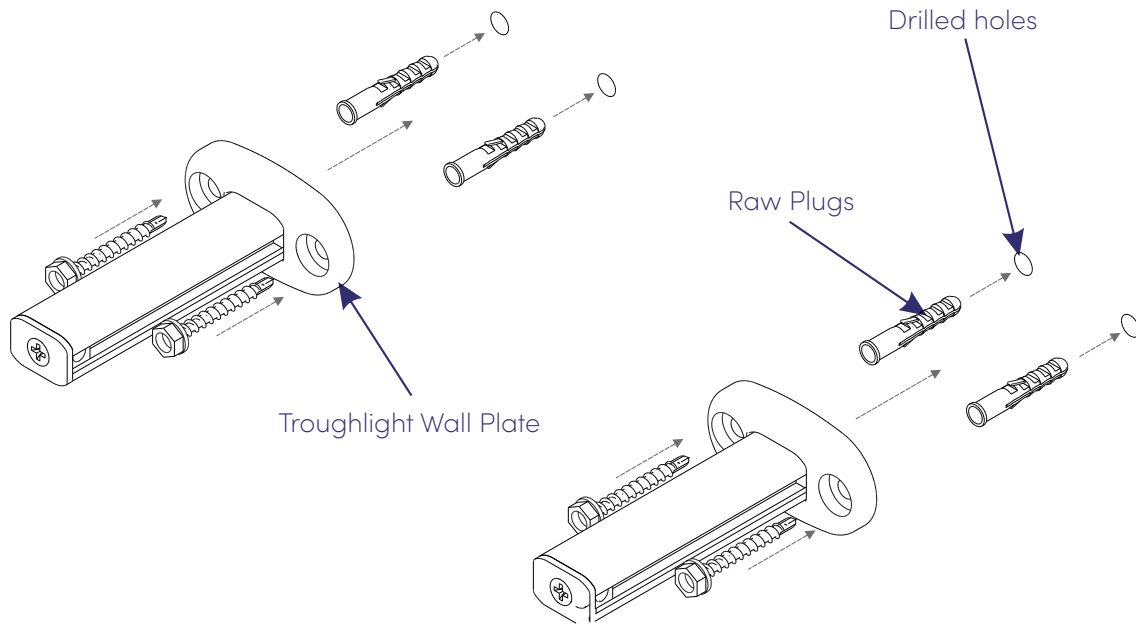

### Step 2:

Slot the sliders (mounted on the troughlight) over the wall bracket arms and bolt into place using the tooth washers & M6 bolts.

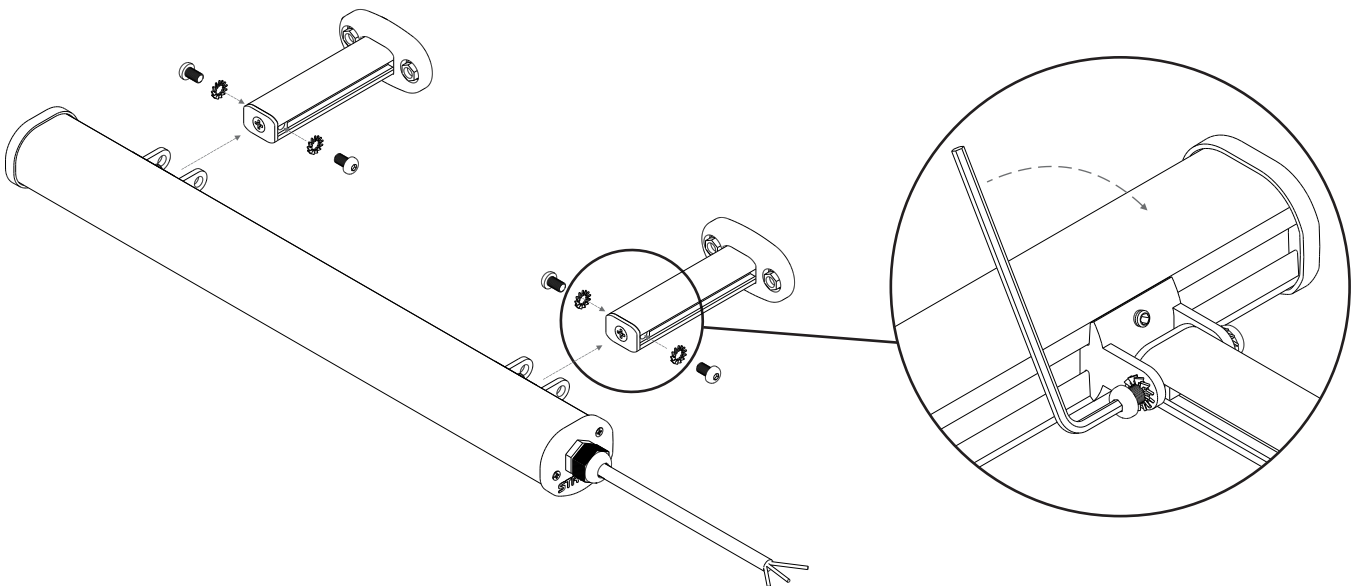

### Step 3:

Slide troughlight into position, then tighten the Grub Screws in the Slider Bracket to clamp the troughlight into place.

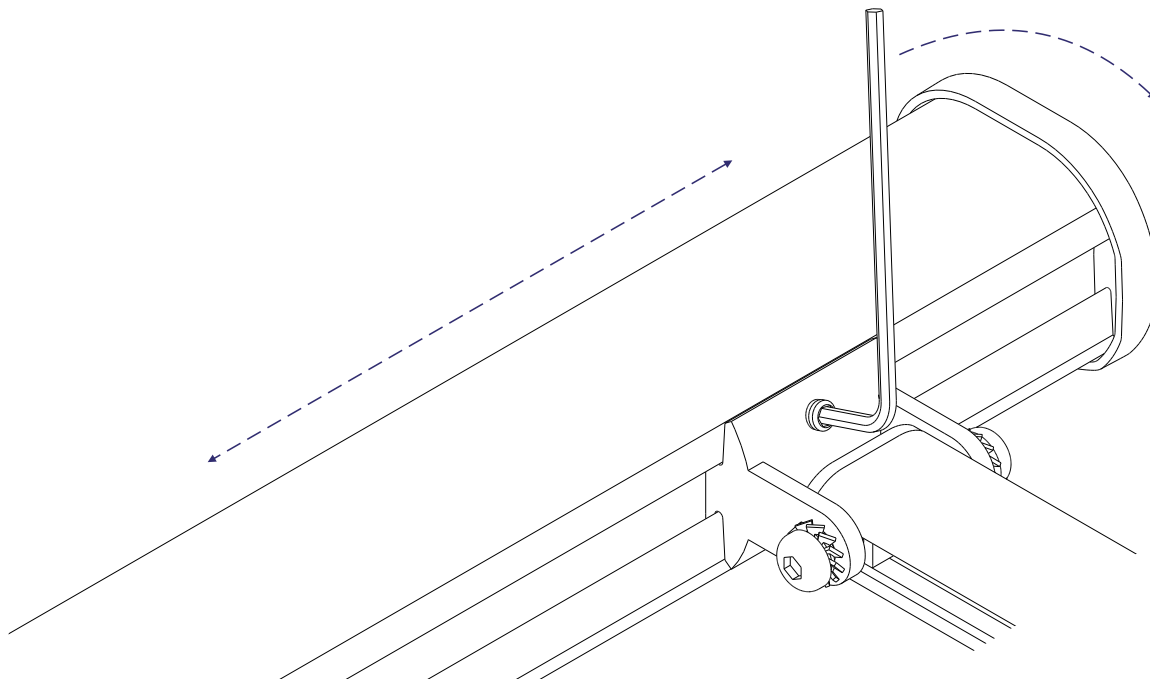

### Step 4:

Connect the 3-core cable and the troughlight is complete - Get a qualified electrician to connect your 240V Cable to the mains.

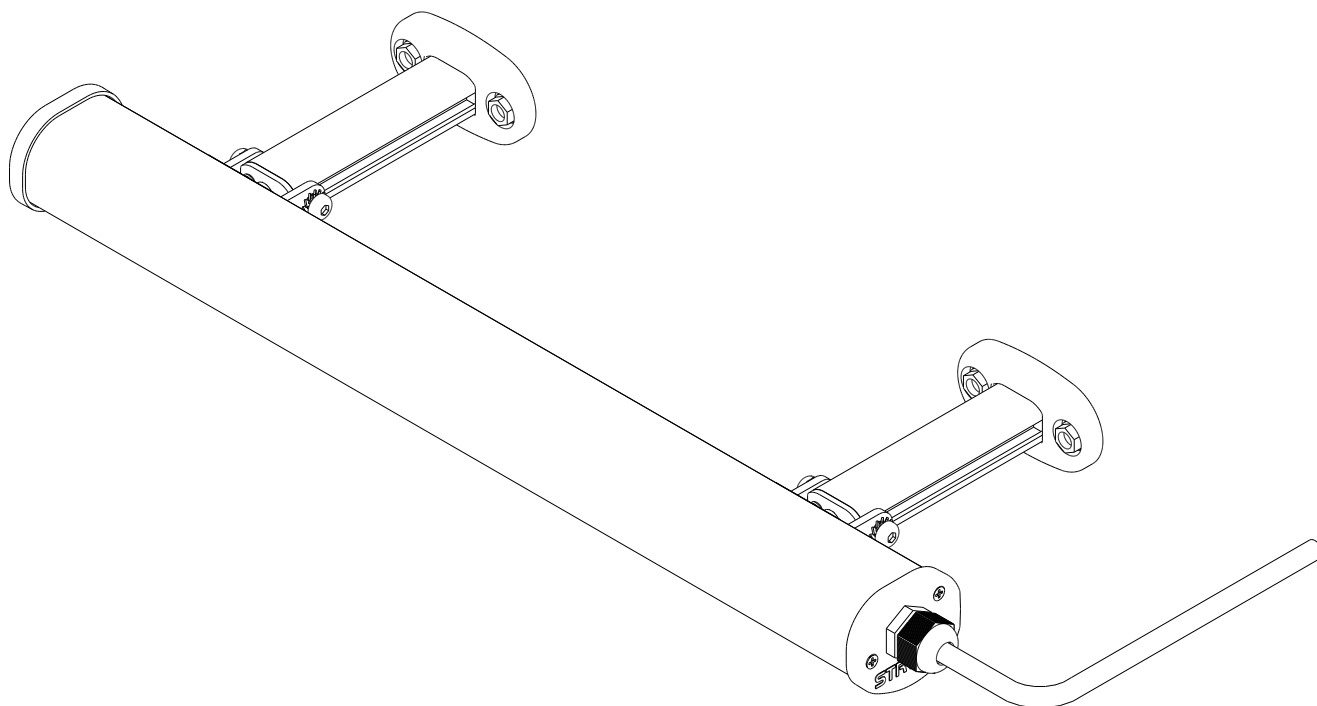

## Wall Bracket Mounting - With Joining Connector(s)

### Tools Required

- Drill
- Tape Measure
- Screwdriver (Phillips)
- Hex Key



### Step 1:

Mount the brackets to the wall in the desired position.

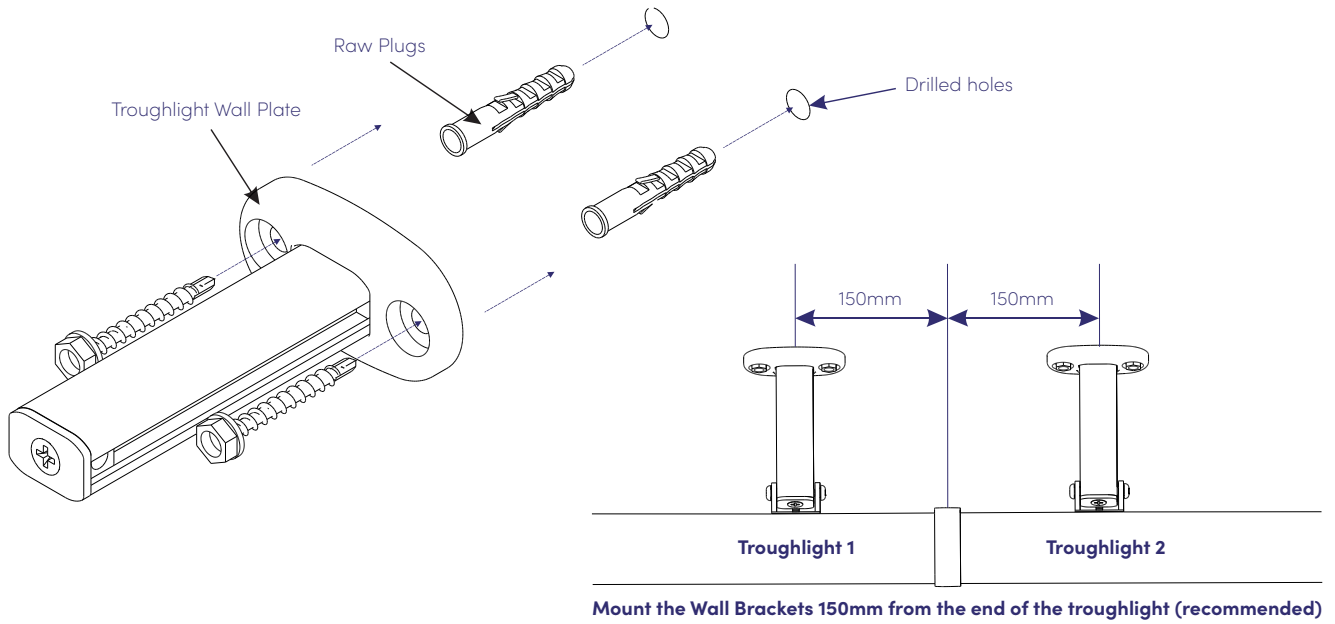

### Step 2:

Slot the sliders (mounted on the troughlight) over the wall bracket arms and bolt into place using the tooth washers & M6 bolts.

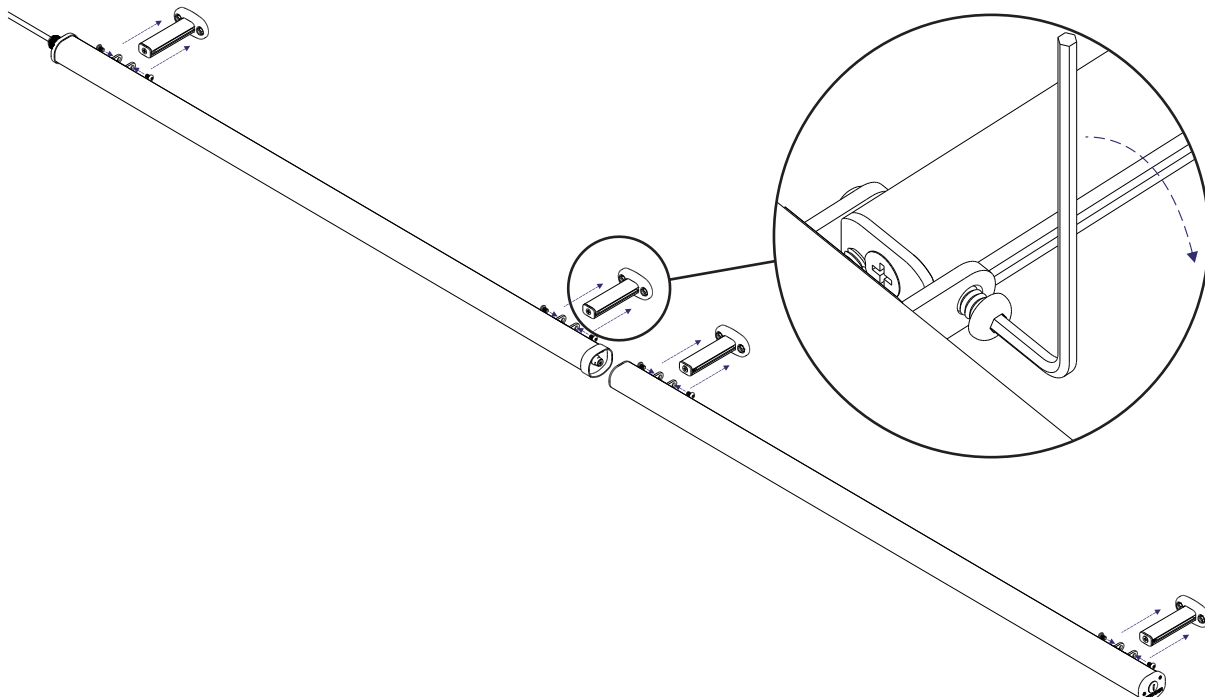

### Step 3:

Slide the troughlight along the brackets and female electrical connection onto the male connector.

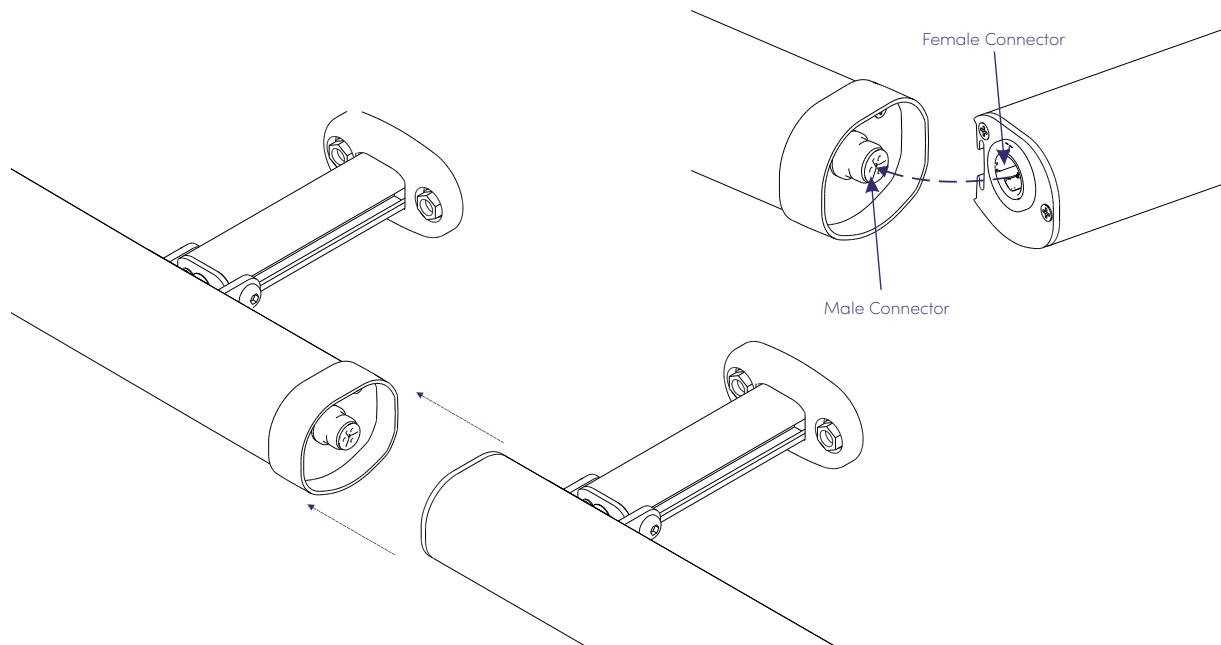

### Step 4:

Tighten the Grub Screws in the Slider Bracket to clamp the troughlights into place.

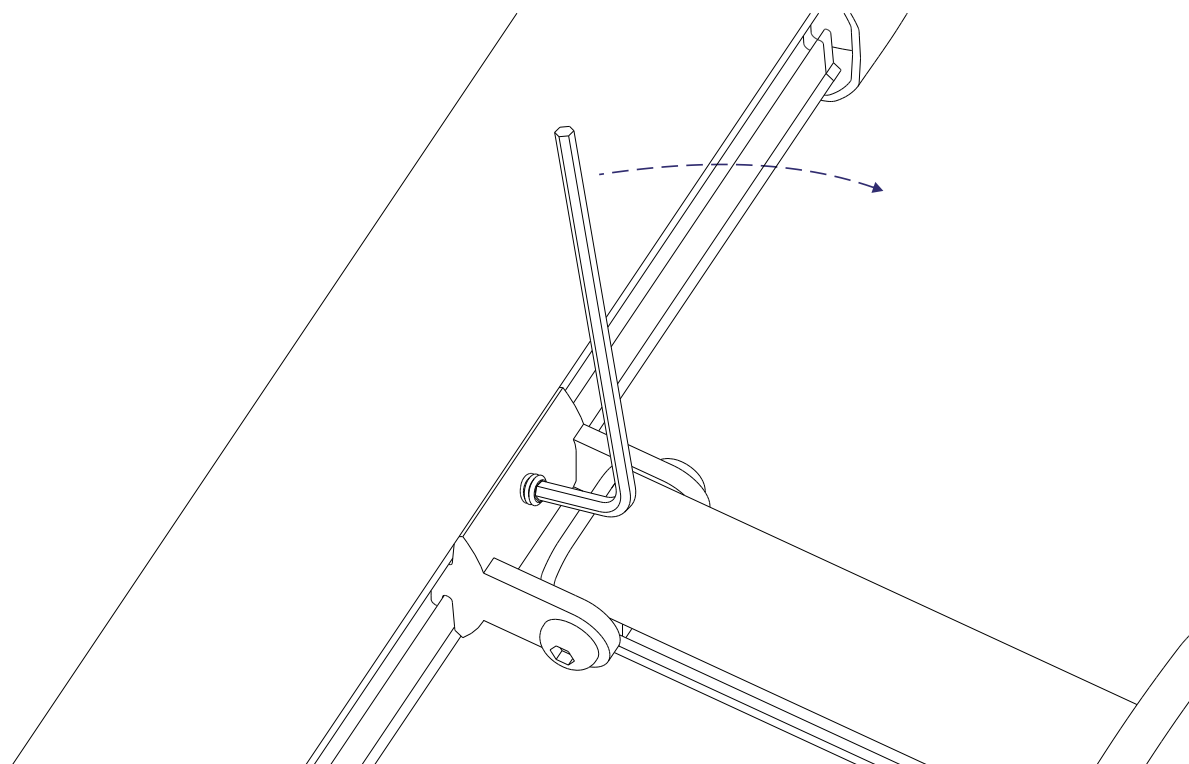



**Step 5:**

Connect the 3-core cable and the troughlight is complete - Get a qualified electrician to connect your 240V Cable to the mains.

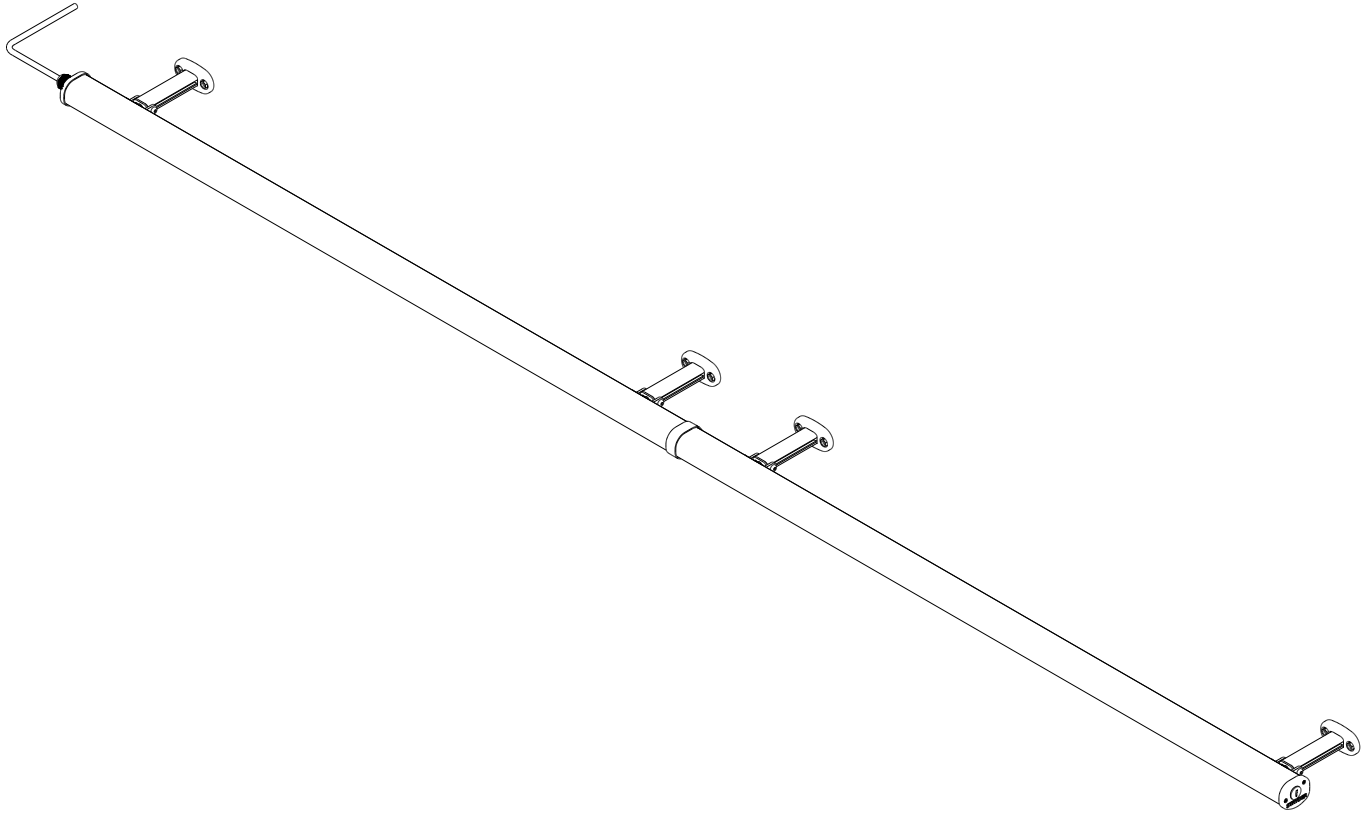

## Channel Bracket Mounting

### Tools Required

- Spanner
- Hex Key



### Step 1:

Fixing the Brackets to the channel on the back of the panel in the desired position.

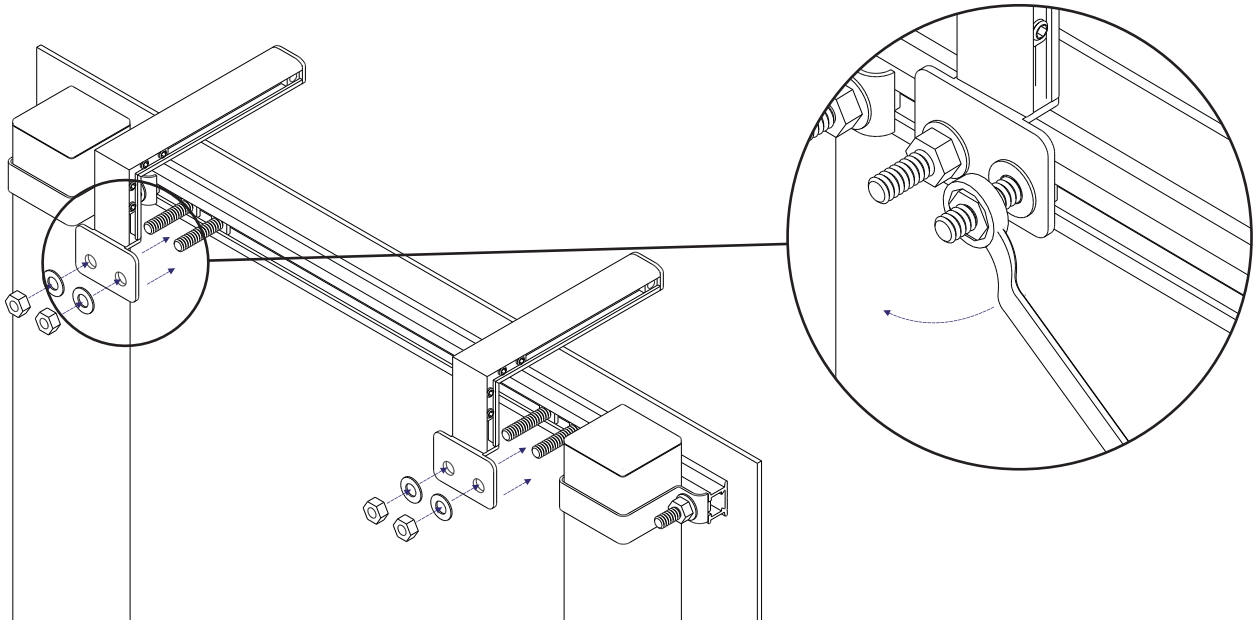

### Step 2:

Slot the sliders (mounted on troughlight) over the Channel Bracket arms and bolt in place using the external tooth washers/M6 bolts

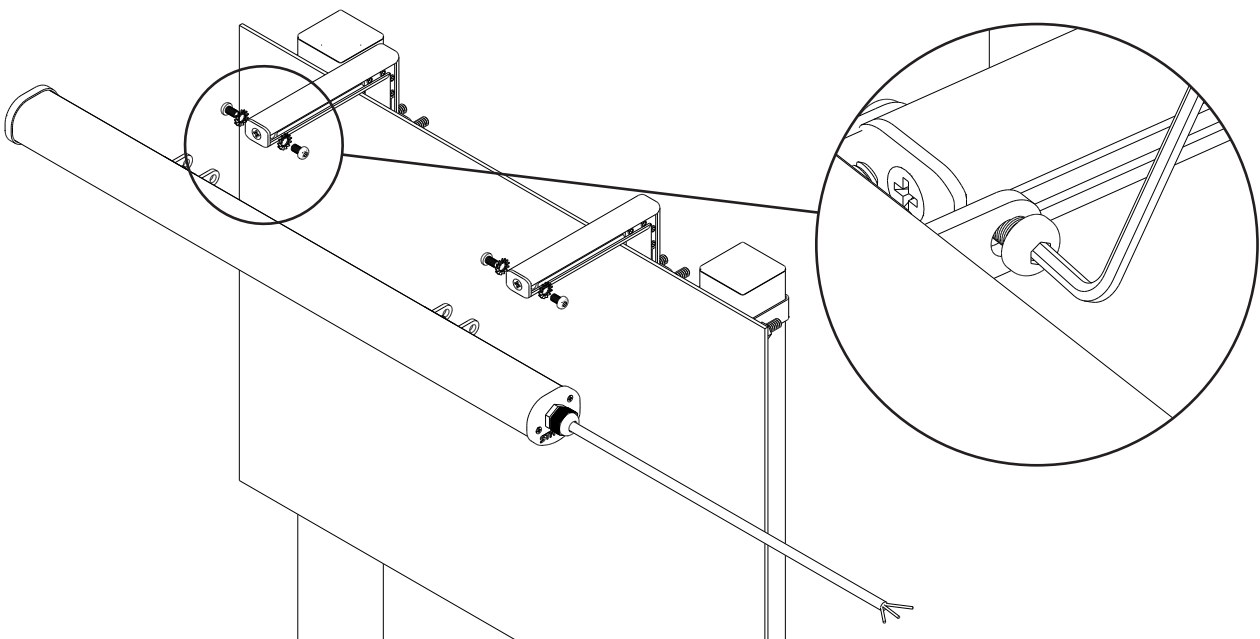

**Step 3:**

Tighten the Grub Screws in the Slider Bracket to clamp the troughlights into place.

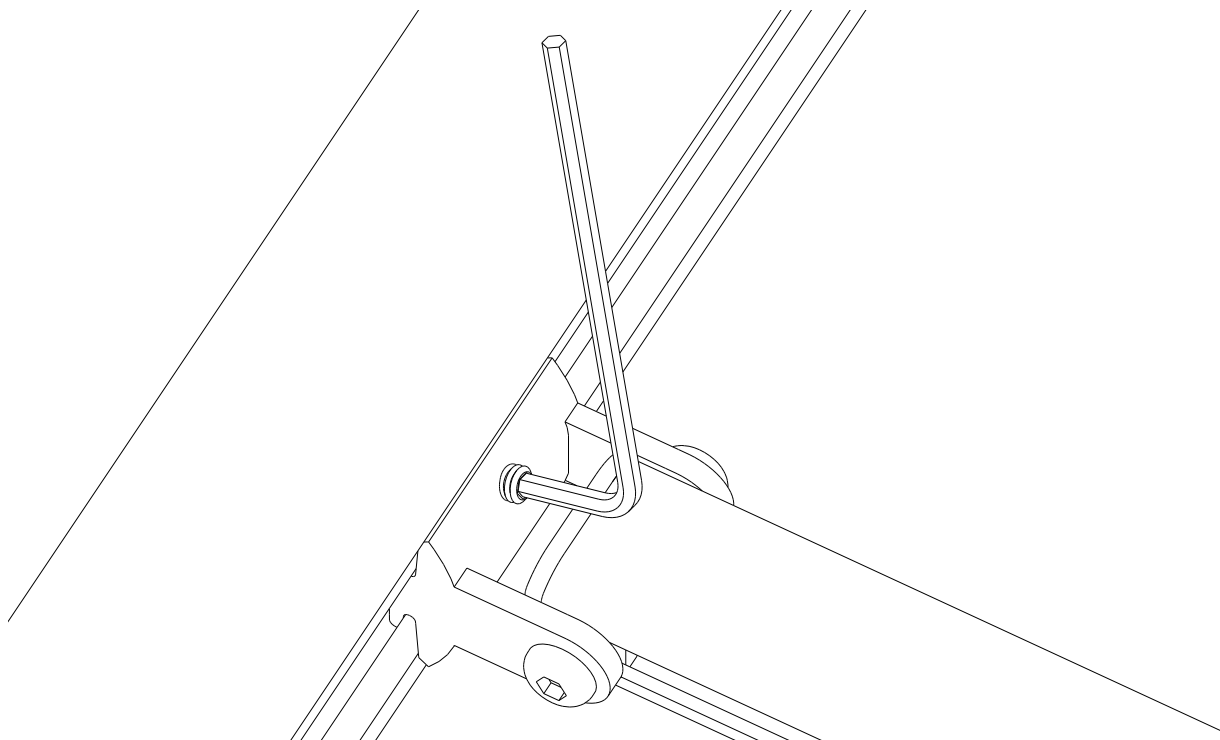

**Step 4:**

Connect the 3-core cable and the troughlight is complete - Get a qualified electrician to connect your 240V Cable to the mains.

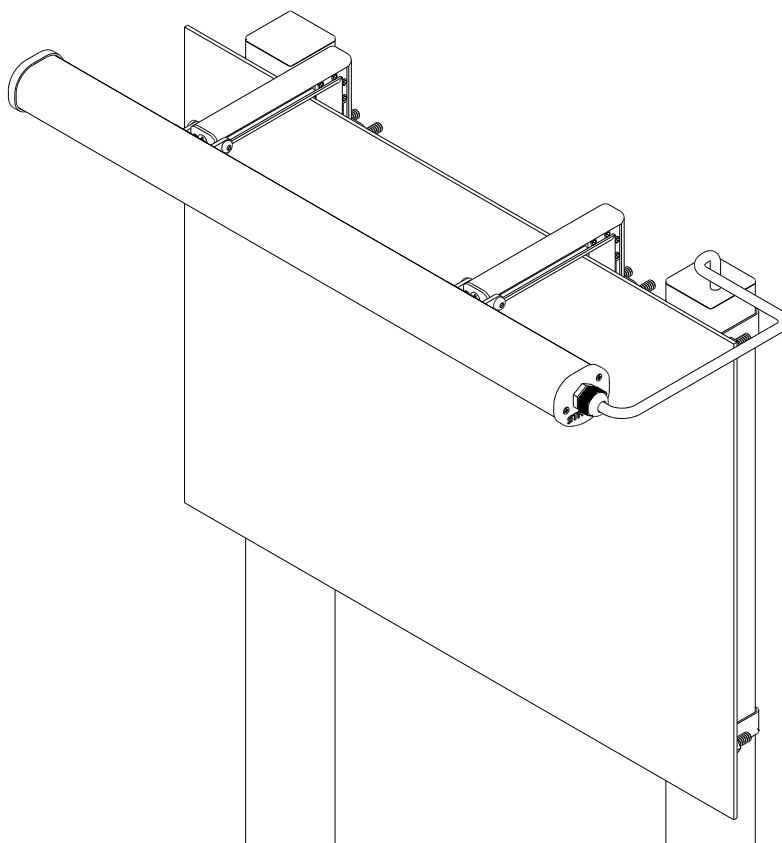

## Top Tray Bracket Mounting

### Tools Required

- Drill
- Rivet Gun
- Hex Key



### Step 1:

Place the Tray Brackets to the tray in the desired position, drill holes then rivet or bolt into place.

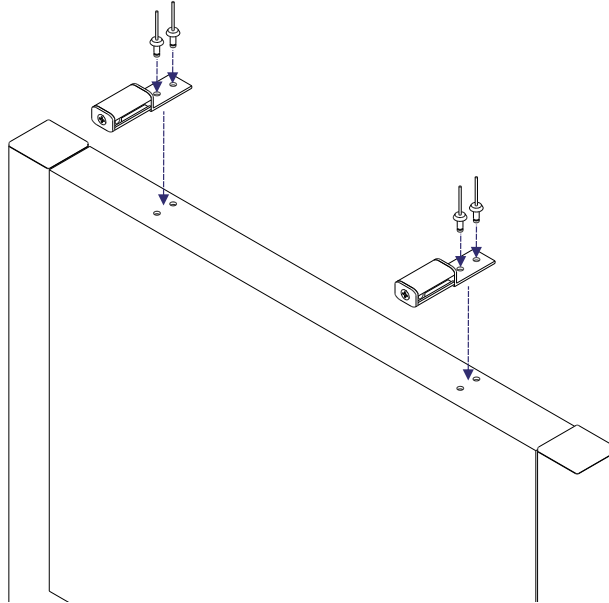

### Step 2:

Slot the sliders (mounted on troughlight) over the Tray Bracket arms and bolt into place using M6 bolts

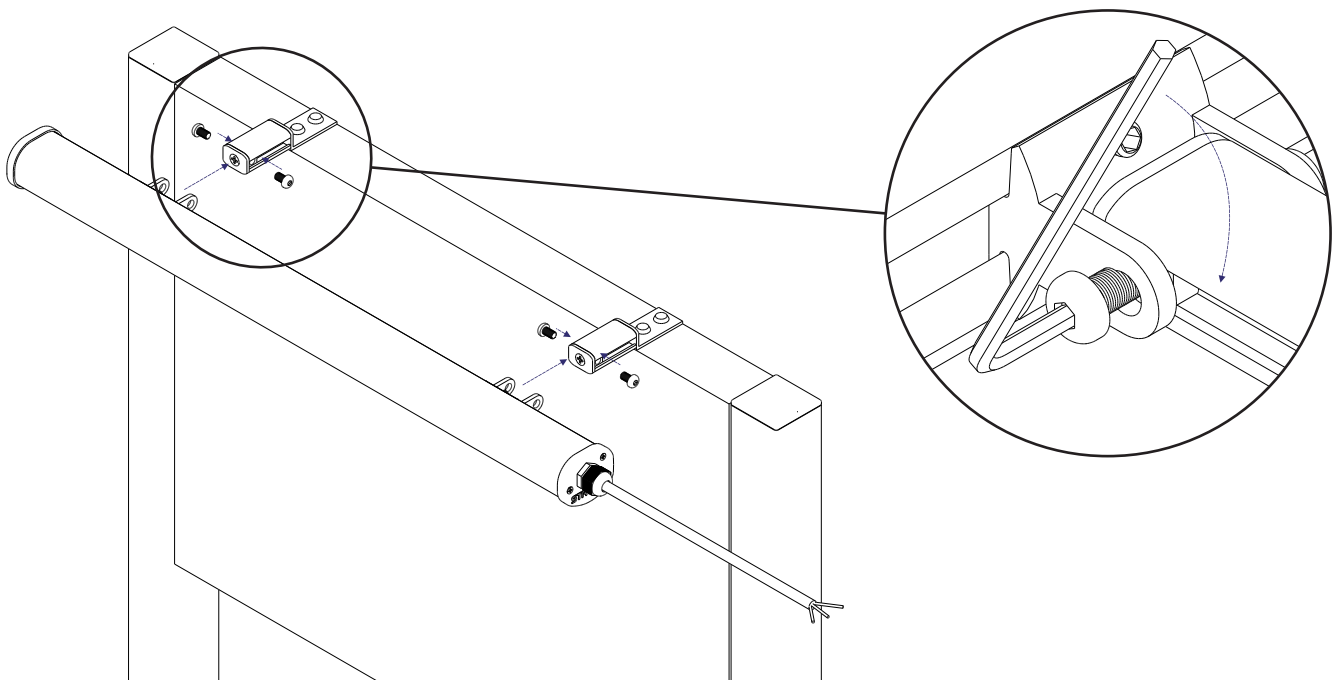

**Step 3:**

Tighten the Grub Screws in the Slider Bracket to clamp the troughlights into place.

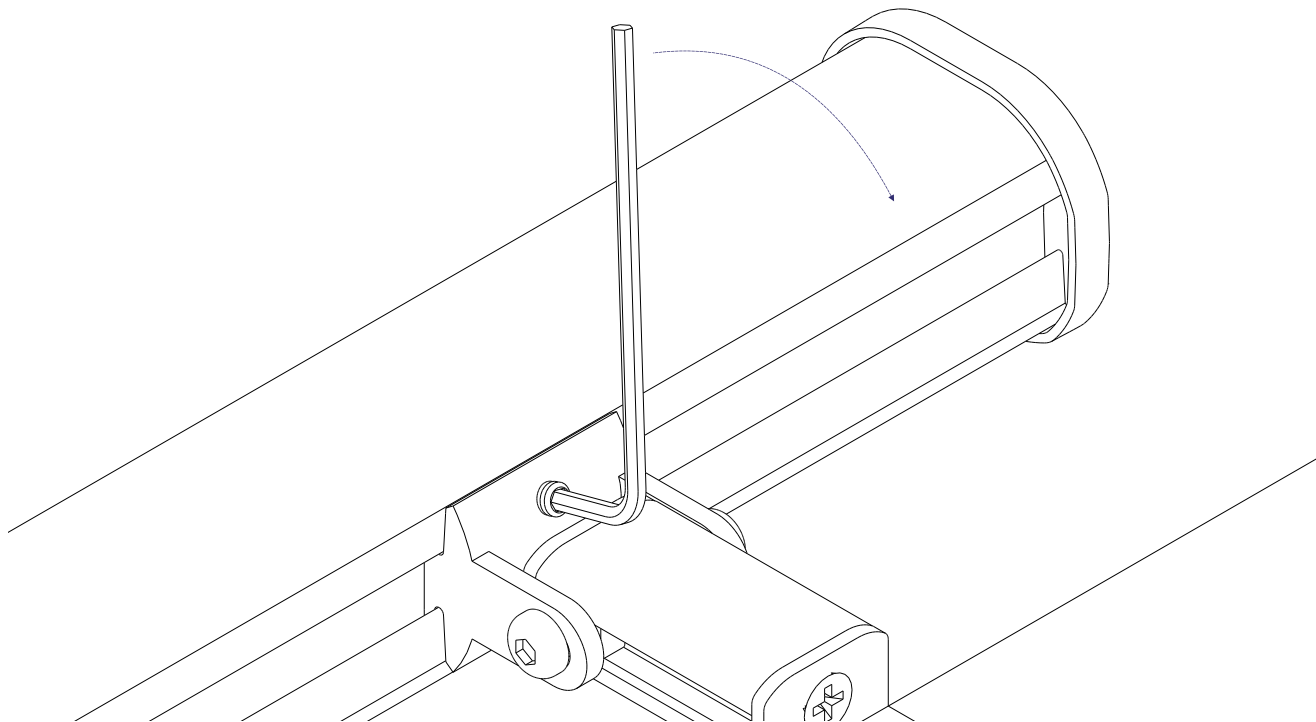

**Step 4:**

Connect the 3-core cable and the troughlight is complete - Get a qualified electrician to connect your 240V Cable to the mains.

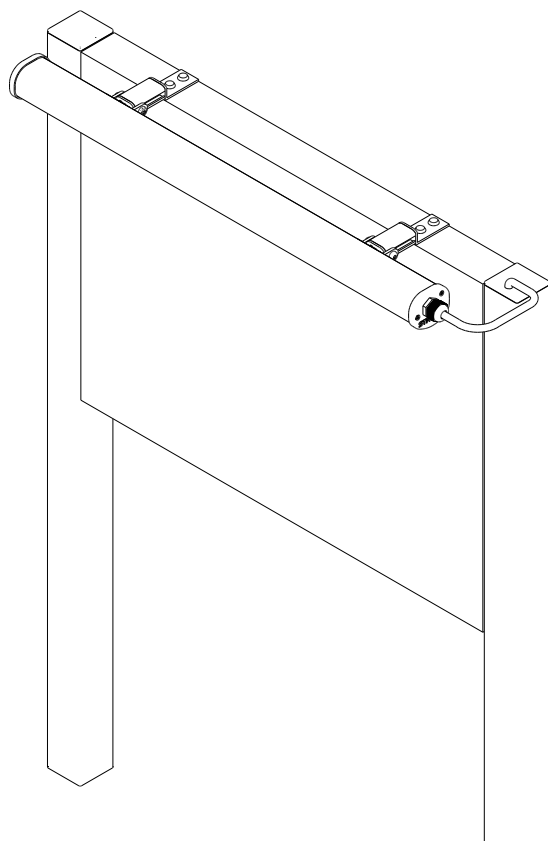

## Plate Bracket Mounting

### Tools Required

- Drill
- Rivet Gun
- Hex Key



### Step 1:

Place the Plate Brackets to the Plate in the desired position, drill holes then rivet or bolt into place.

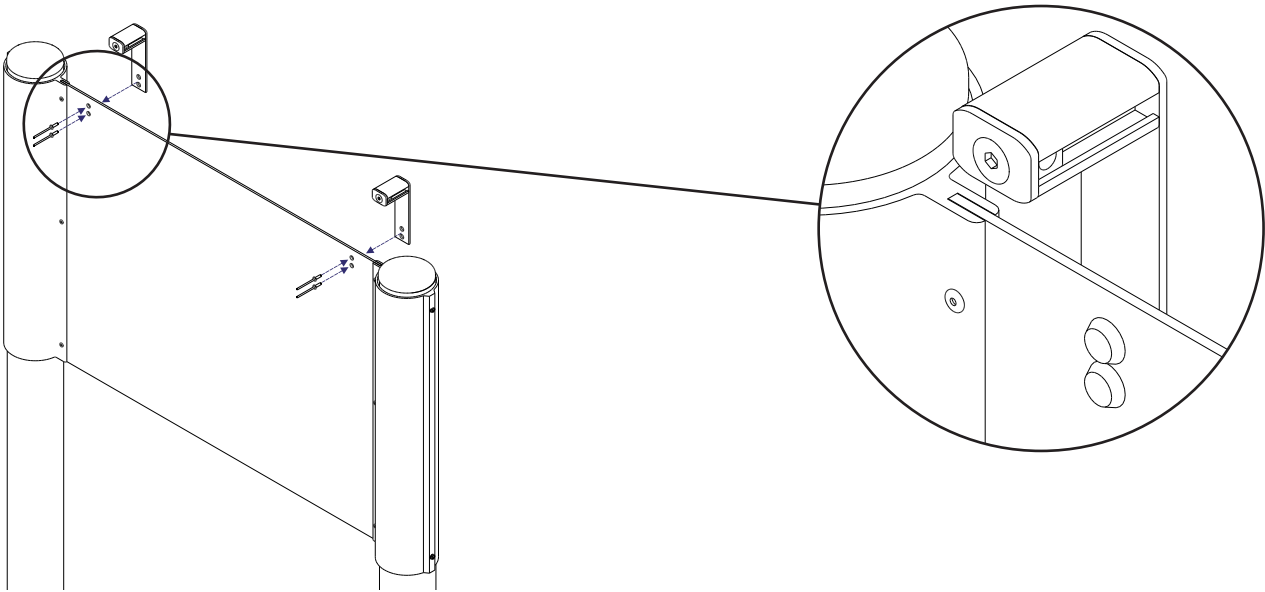

### Step 2:

Slot the sliders (mounted on the troughlight) over the Plate Bracket arms and bolt into place using M6 bolts.

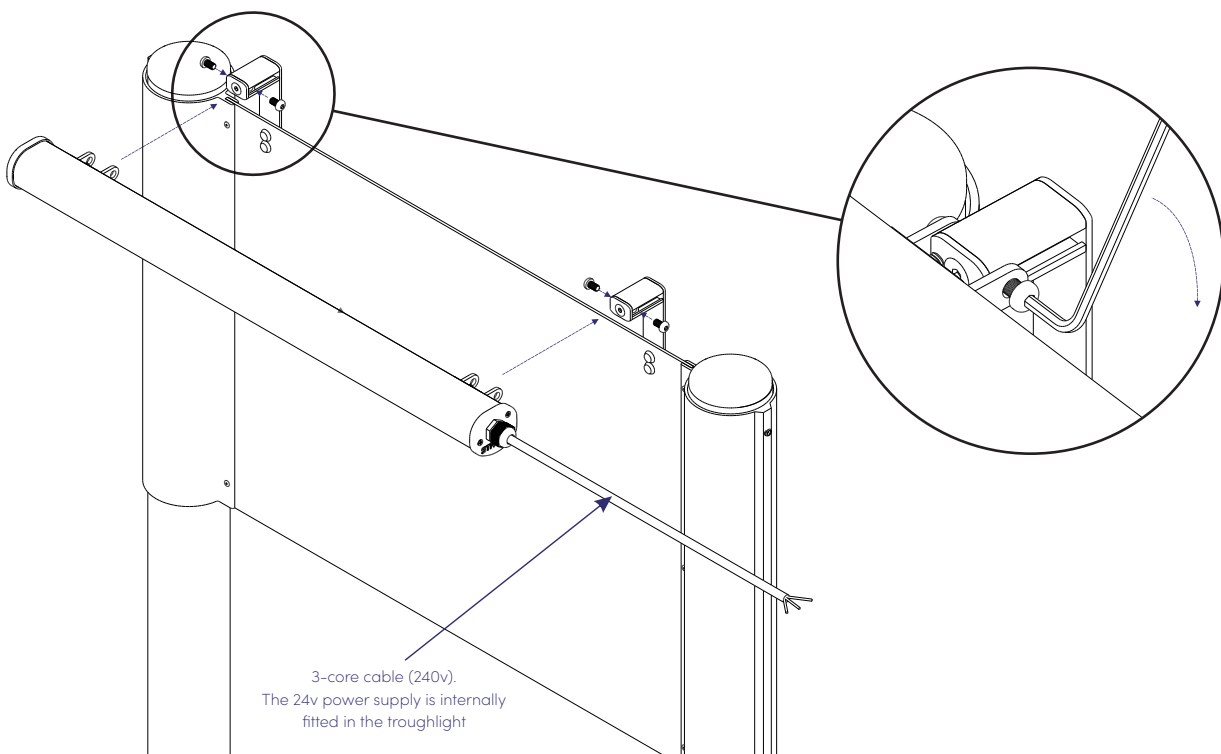

### Step 3:

Tighten the Grub Screw in the Slider Bracket to clamp the troughlight into place.

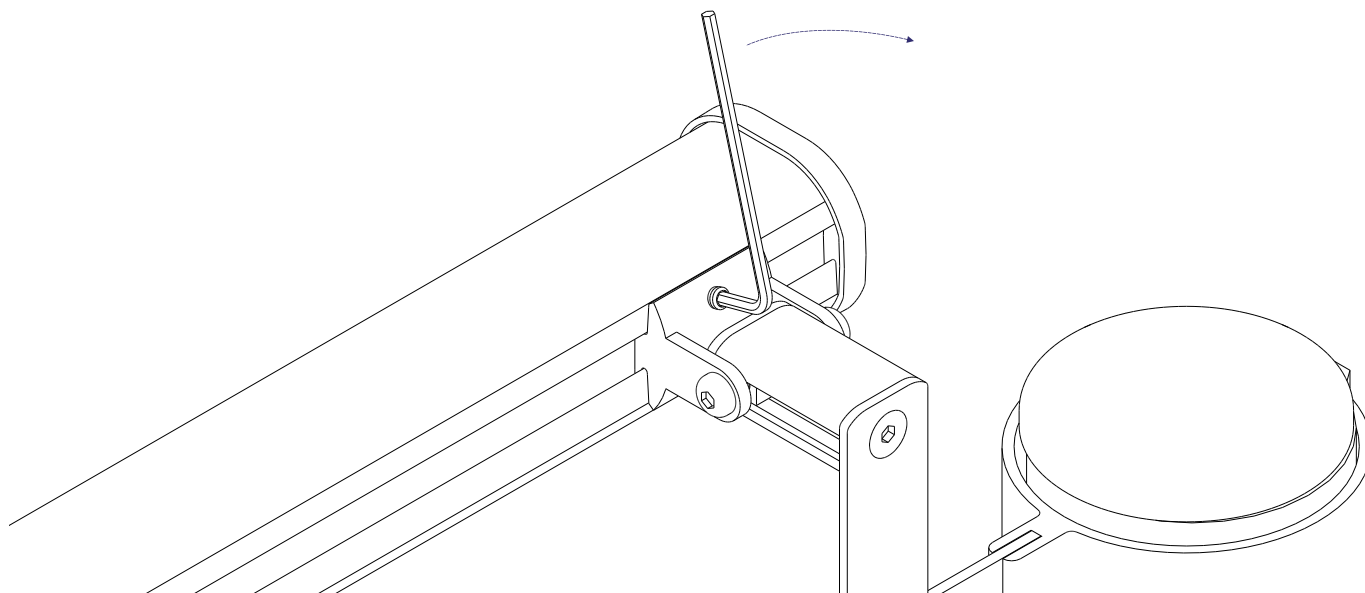

### Step 4:

Connect the 3-core cable and the troughlight is complete - Get a qualified electrician to connect your 240V Cable to the mains.

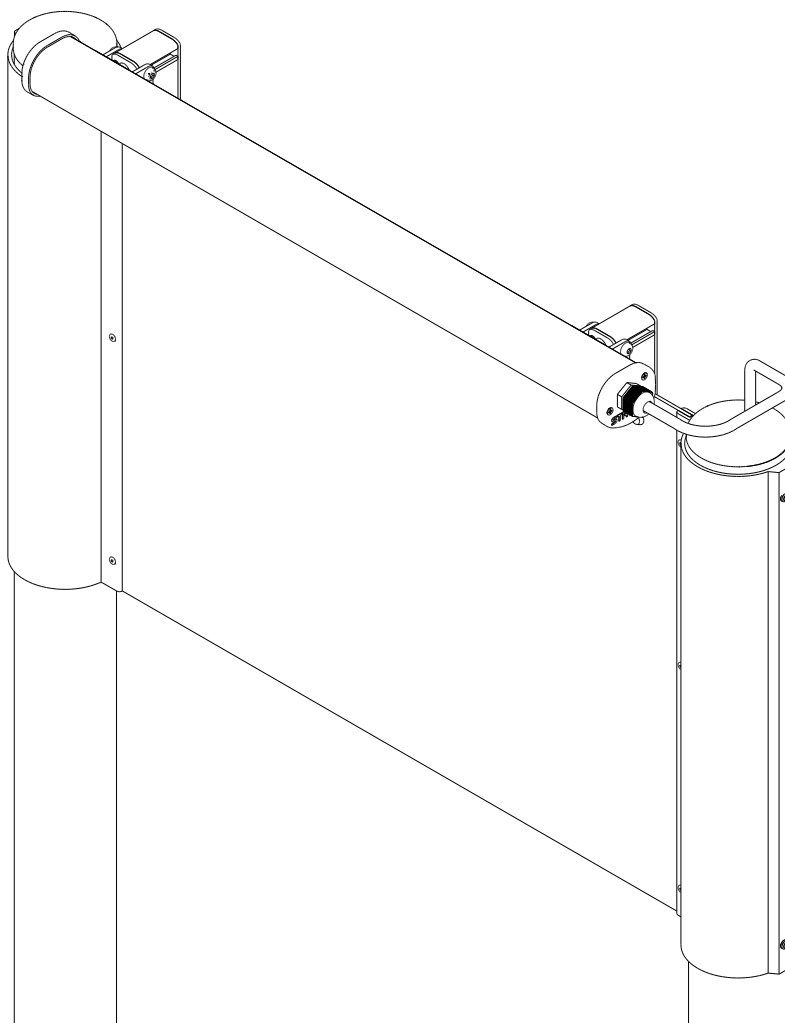

## Double Sided Bracket Mounting

### Tools Required

- Screwdriver
- Hex Key



### Step 1:

Fix the Bracket legs to the top of the Double Sided Plaza Tray in the desired position (screwdriver & hex key required)

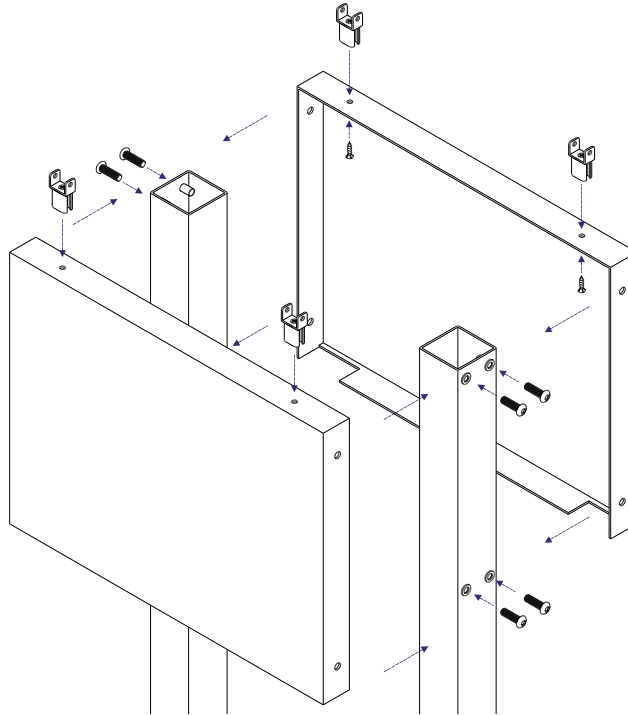

### Step 2:

Slide the top of the Bracket (Arm Extrusion) into position (centrally between brackets), then tighten into position using the external tooth washers and M6 bolts

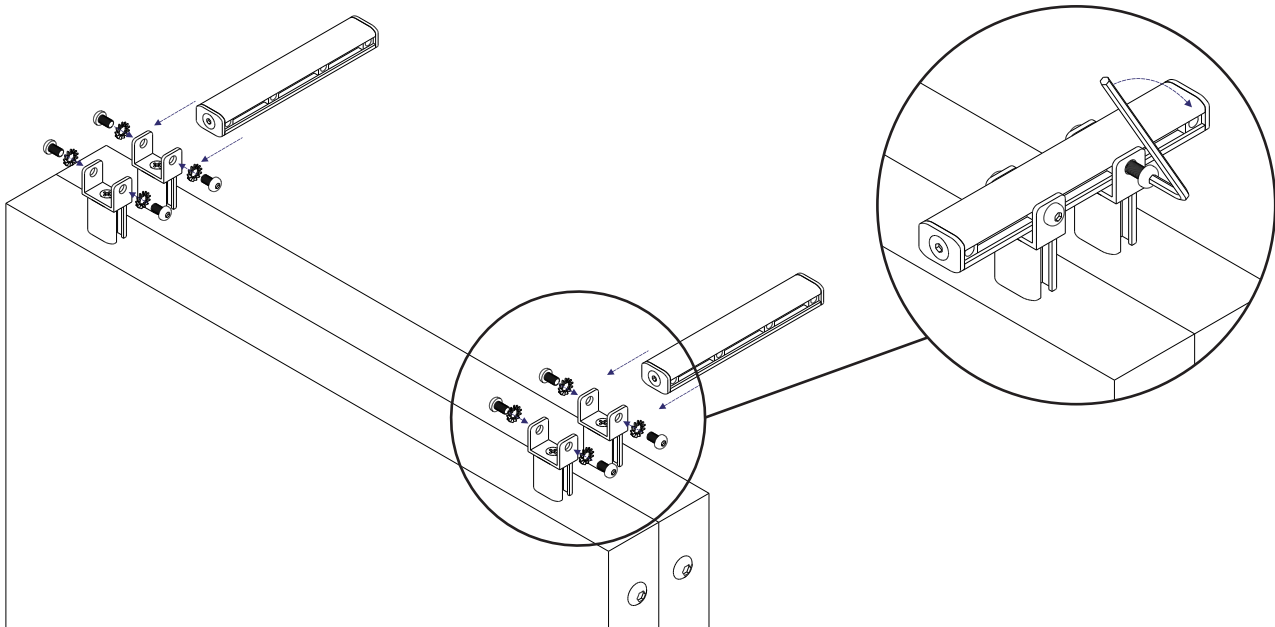



### Step 3:

Slide the Main Stryder Troughlight Extrusion with the Slider Brackets onto the Double Sided Brackets and bolt into place using the external tooth washers and M6 bolts.

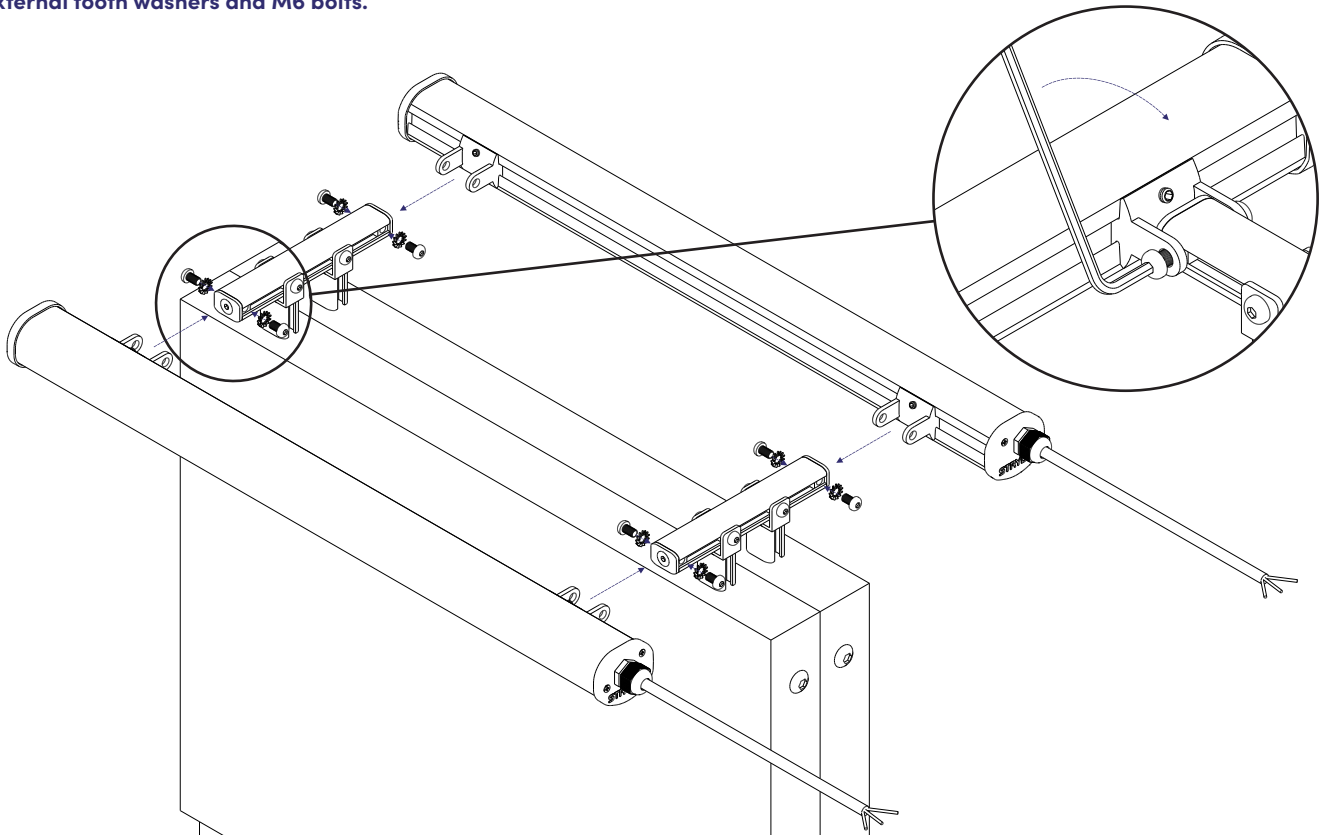

### Step 4:

Slide the troughlight into the correct position and then tighten the Grub Screws in the Slider Bracket to hold in place.

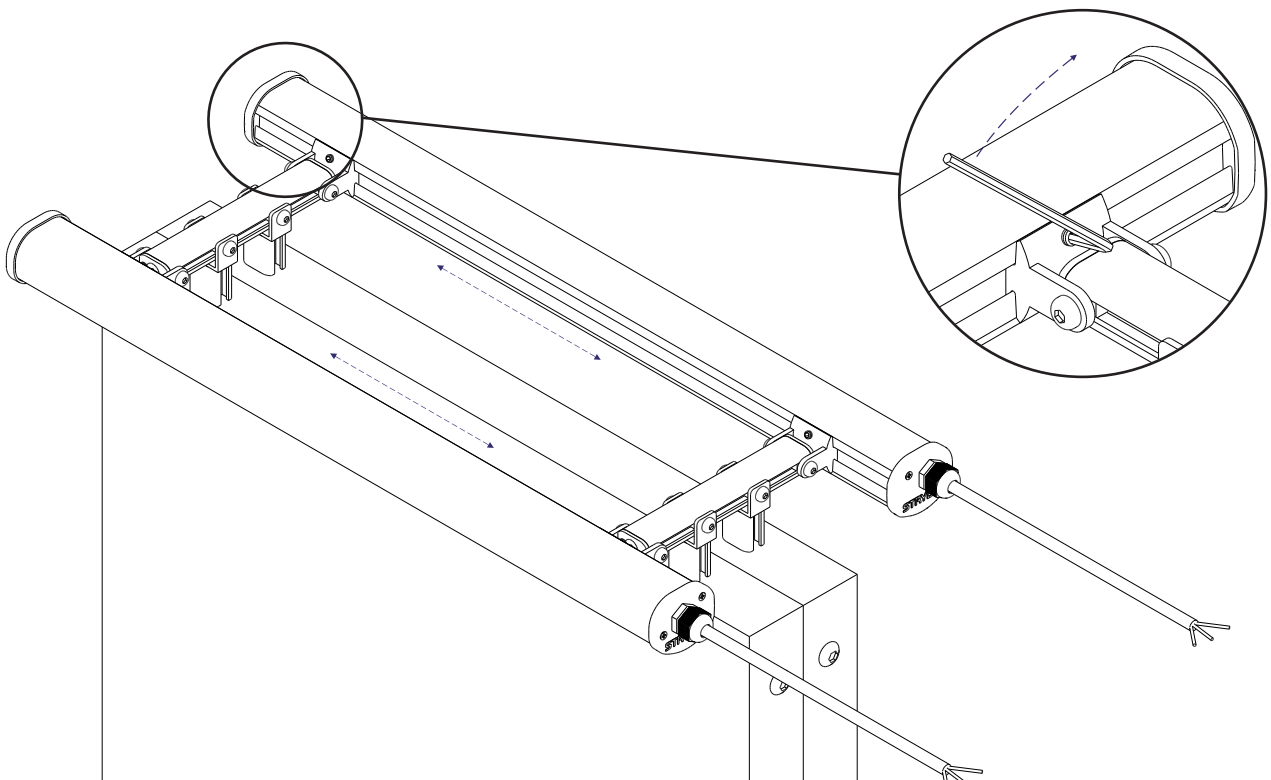

**Step 5:**

Connect the 3-core cable and the troughlight is complete - Get a qualified electrician to connect your 240V Cable to the mains.

