

Dimensions are not to be scaled from this drawing

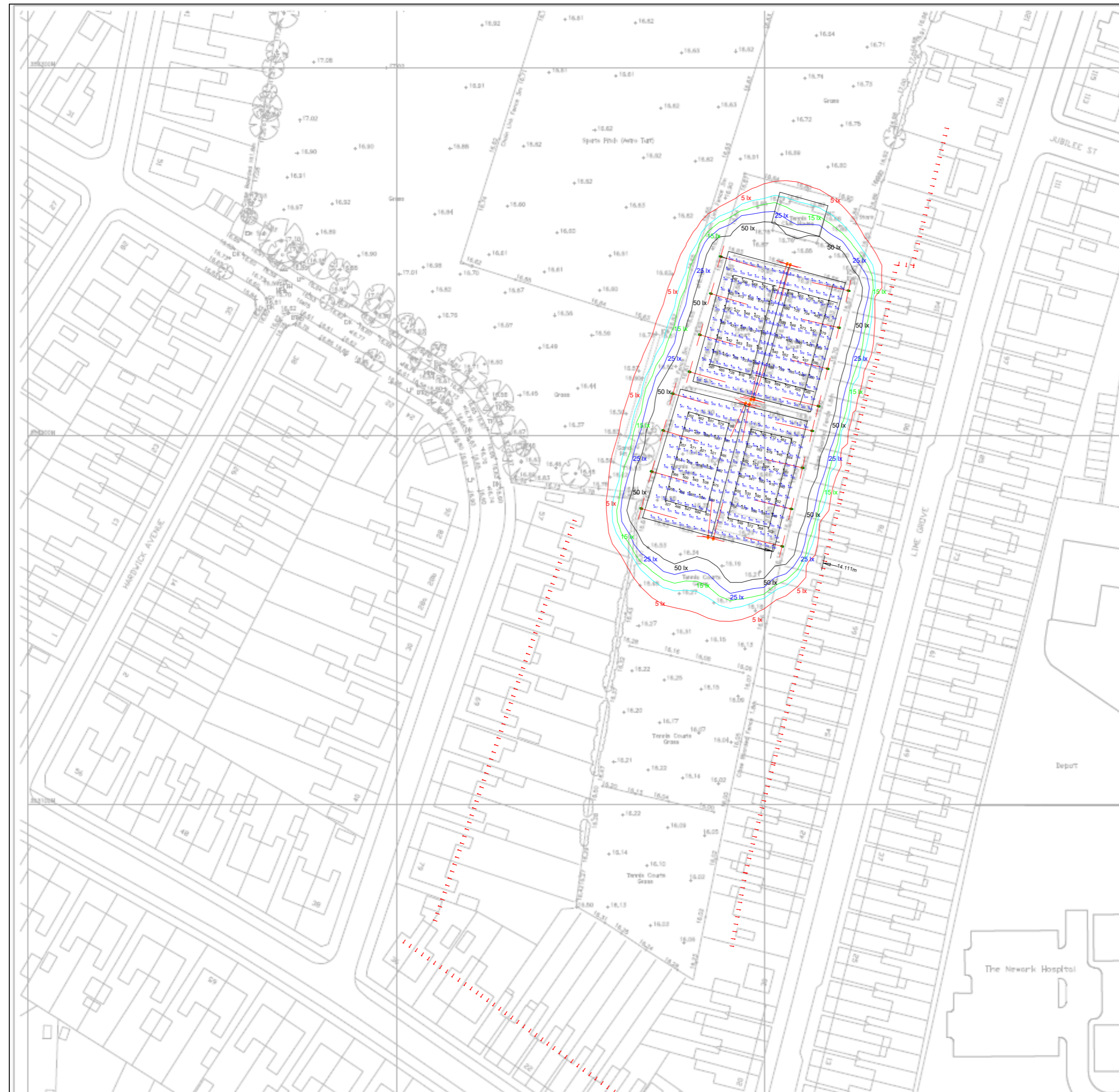

Kingfisher Lighting

Part of the Luceco PLC group of companies **LUCECO**



Obtrusive Light - Compliance Report

CIE 150:2017, E2-Low District Brightness, Pre-Curlew
 Filename: Newark Tennis Club Design A
 25/01/2024 14:22:37

Illuminance

Maximum Allowable Value: 5 Lux

Calculations Tested (13):

Calculation Label	Test Results	Max. Illum.
Harewood Ave Properties 0-5m_III_Seg1	PASS	2
Boundary Rd Properties 0-5m_1_III_Seg1	PASS	0
Boundary Rd Properties 0-5m_1_III_Seg2	PASS	0
Lime Grove Properties 0-5m_III_Seg1	PASS	2
Lime Grove Properties 0-5m_III_Seg2	PASS	0
Lime Grove Properties 0-5m_III_Seg3	PASS	4
Lime Grove Properties 0-5m_III_Seg4	PASS	5
Lime Grove Properties 0-5m_III_Seg5	PASS	4
Lime Grove Properties 0-5m_III_Seg6	PASS	5
Lime Grove Properties 0-5m_III_Seg7	PASS	4
Lime Grove Properties 0-5m_III_Seg8	PASS	2
Lime Grove Properties 0-5m_III_Seg9	PASS	0
Lime Grove Properties 0-5m_III_Seg10	PASS	0

Luminous Intensity (Cd) At Vertical Planes

Maximum Allowable Value calculated from CIE 150:2017 (varies by Projected Area sq.m. and Distance Factor)

For E2-Low District Brightness, Projected Area and Distance Factors:

(0.002, 0.57), (0.01, 1.3), (0.03, 2.5), (0.13, 5), (0.5, 10)

Projected Area (sq.m) = Approx. projected emitting area of luminaire in direction of observer

Distance (m) = Distance from luminaire to observer

Max Cd Allowed = Projected Area Factor * Distance

Calculations Tested (13):

Calculation Label	Test Results
Harewood Ave Properties 0-5m_Cd_Seg1	PASS
Boundary Rd Properties 0-5m_1_Cd_Seg1	PASS
Boundary Rd Properties 0-5m_1_Cd_Seg2	PASS
Lime Grove Properties 0-5m_Cd_Seg1	PASS
Lime Grove Properties 0-5m_Cd_Seg2	PASS
Lime Grove Properties 0-5m_Cd_Seg3	PASS
Lime Grove Properties 0-5m_Cd_Seg4	PASS
Lime Grove Properties 0-5m_Cd_Seg5	PASS
Lime Grove Properties 0-5m_Cd_Seg6	PASS
Lime Grove Properties 0-5m_Cd_Seg7	PASS
Lime Grove Properties 0-5m_Cd_Seg8	PASS
Lime Grove Properties 0-5m_Cd_Seg9	PASS
Lime Grove Properties 0-5m_Cd_Seg10	PASS

Label	CalcType	Units	Avg	Max	Min	Uniformity (Min/Max)	Obtrusivity (Min/Max)	Beam Type	Description
PFA.A	Footcandle	Lux	302.26	313	302	0.97	0.37	Horizontal	
PFA.B	Footcandle	Lux	284.26	295	281	0.93	0.38	Horizontal	
PFA.C	Footcandle	Lux	285.25	291	287	0.92	0.41	Horizontal	
PFA.D	Footcandle	Lux	272.26	282	268	0.92	0.42	Horizontal	
TFA.A	Footcandle	Lux	253.27	279	249	0.87	0.28	Horizontal	
TFA.B	Footcandle	Lux	242.27	274	248	0.84	0.28	Horizontal	
TFA.C	Footcandle	Lux	243.26	276	248	0.85	0.31	Horizontal	
TFA.D	Footcandle	Lux	243.26	281	244	0.83	0.32	Horizontal	

Label	CalcType	Units	Avg	Max	Min	Uniformity (Min/Max)	Obtrusivity (Min/Max)	Beam Type	Description
Boundary Rd Properties 0-5m_1_Cd_1	Obtrusivity - Cd	N/A	23.20	36	18	0.47	0.22	Non-Point	
Boundary Rd Properties 0-5m_1_Cd_2	Obtrusivity - Cd	N/A	23.20	37	22	0.51	0.25	Non-Point	
Boundary Rd Properties 0-5m_1_Cd_3	Obtrusivity - Cd	Lux	0.00	0	0	N/A	N/A	Non-Point	
Boundary Rd Properties 0-5m_1_Cd_4	Obtrusivity - Cd	Lux	0.00	0	0	N/A	N/A	Non-Point	
Harewood Ave Properties 0-5m_Cd_1	Obtrusivity - Cd	N/A	29.07	39	21	0.53	0.24	Non-Point	
Harewood Ave Properties 0-5m_Cd_2	Obtrusivity - Cd	Lux	0.14	2	0	0.00	0.00	Non-Point	
Lime Grove Properties 0-5m_Cd_1a	Obtrusivity - Cd	N/A	297.07	401	189	0.47	0.24	Non-Point	
Lime Grove Properties 0-5m_Cd_1b	Obtrusivity - Cd	N/A	28.00	38	25	0.68	0.21	Non-Point	
Lime Grove Properties 0-5m_Cd_1c	Obtrusivity - Cd	N/A	2.00	3	0	N/A	N/A	Non-Point	
Lime Grove Properties 0-5m_Cd_1d	Obtrusivity - Cd	N/A	291.26	393	211	0.48	0.24	Non-Point	
Lime Grove Properties 0-5m_Cd_1e	Obtrusivity - Cd	N/A	277.75	369	248	0.50	0.25	Non-Point	
Lime Grove Properties 0-5m_Cd_1f	Obtrusivity - Cd	N/A	272.26	382	247	0.51	0.25	Non-Point	
Lime Grove Properties 0-5m_Cd_1g	Obtrusivity - Cd	N/A	253.27	362	228	0.50	0.27	Non-Point	
Lime Grove Properties 0-5m_Cd_1h	Obtrusivity - Cd	N/A	253.27	401	207	0.48	0.25	Non-Point	
Lime Grove Properties 0-5m_Cd_1i	Obtrusivity - Cd	N/A	277.75	408	194	0.47	0.27	Non-Point	
Lime Grove Properties 0-5m_Cd_1j	Obtrusivity - Cd	N/A	278.00	373	26	0.34	0.19	Non-Point	
Lime Grove Properties 0-5m_M_1	Obtrusivity - Cd	Lux	0.40	2	0	0.00	0.00	Non-Point	
Lime Grove Properties 0-5m_M_2	Obtrusivity - Cd	Lux	0.00	0	0	N/A	N/A	Non-Point	
Lime Grove Properties 0-5m_M_3	Obtrusivity - Cd	Lux	0.00	0	0	N/A	N/A	Non-Point	
Lime Grove Properties 0-5m_M_4	Obtrusivity - Cd	Lux	2.25	4	1	0.44	0.25	Non-Point	
Lime Grove Properties 0-5m_M_5	Obtrusivity - Cd	Lux	0.00	1	0	0.00	0.00	Non-Point	
Lime Grove Properties 0-5m_M_6	Obtrusivity - Cd	Lux	2.00	4	2	0.67	0.30	Non-Point	
Lime Grove Properties 0-5m_M_7	Obtrusivity - Cd	Lux	0.00	1	0	0.00	0.00	Non-Point	
Lime Grove Properties 0-5m_M_8	Obtrusivity - Cd	Lux	1.00	4	1	0.53	0.25	Non-Point	
Lime Grove Properties 0-5m_M_9	Obtrusivity - Cd	Lux	0.00	2	0	0.00	0.00	Non-Point	
Lime Grove Properties 0-5m_M_10	Obtrusivity - Cd	Lux	0.00	0	0	N/A	N/A	Non-Point	

Label	CalcType	Units	Avg	Max	Min	Uniformity (Min/Max)	Obtrusivity (Min/Max)	Beam Type	Description
Boundary Rd Properties 0-5m_1_Cd_1	Obtrusivity - Cd	N/A	23.20	36	18	0.47	0.22	Non-Point	
Boundary Rd Properties 0-5m_1_Cd_2	Obtrusivity - Cd	N/A	23.20	37	22	0.51	0.25	Non-Point	
Boundary Rd Properties 0-5m_1_Cd_3	Obtrusivity - Cd	Lux	0.00	0	0	N/A	N/A	Non-Point	
Boundary Rd Properties 0-5m_1_Cd_4	Obtrusivity - Cd	Lux	0.00	0	0	N/A	N/A	Non-Point	
Harewood Ave Properties 0-5m_Cd_1	Obtrusivity - Cd	N/A	29.07	39	21	0.53	0.24	Non-Point	
Harewood Ave Properties 0-5m_Cd_2	Obtrusivity - Cd	Lux	0.14	2	0	0.00	0.00	Non-Point	
Lime Grove Properties 0-5m_Cd_1a	Obtrusivity - Cd	N/A	297.07	401	189	0.47	0.24	Non-Point	
Lime Grove Properties 0-5m_Cd_1b	Obtrusivity - Cd	N/A	28.00	38	25	0.68	0.21	Non-Point	
Lime Grove Properties 0-5m_Cd_1c	Obtrusivity - Cd	N/A	2.00	3	0	N/A	N/A	Non-Point	
Lime Grove Properties 0-5m_Cd_1d	Obtrusivity - Cd	N/A	291.26	393	211	0.48	0.24	Non-Point	
Lime Grove Properties 0-5m_Cd_1e	Obtrusivity - Cd	N/A	277.75	369	248	0.50	0.25	Non-Point	
Lime Grove Properties 0-5m_Cd_1f	Obtrusivity - Cd	N/A	272.26	382	247	0.51	0.25	Non-Point	
Lime Grove Properties 0-5m_Cd_1g	Obtrusivity - Cd	N/A	253.27	362	228	0.50	0.27	Non-Point	
Lime Grove Properties 0-5m_Cd_1h	Obtrusivity - Cd	N/A	253.27	401	207	0.48	0.25	Non-Point	
Lime Grove Properties 0-5m_Cd_1i	Obtrusivity - Cd	N/A	277.75	408	194	0.47	0.27	Non-Point	
Lime Grove Properties 0-5m_Cd_1j	Obtrusivity - Cd	N/A	278.00	373	26	0.34	0.19	Non-Point	
Lime Grove Properties 0-5m_M_1	Obtrusivity - Cd	Lux	0.40	2	0	0.00	0.00	Non-Point	
Lime Grove Properties 0-5m_M_2	Obtrusivity - Cd	Lux	0.00	0	0	N/A	N/A	Non-Point	
Lime Grove Properties 0-5m_M_3	Obtrusivity - Cd	Lux	0.00	0	0	N/A	N/A	Non-Point	
Lime Grove Properties 0-5m_M_4	Obtrusivity - Cd	Lux	2.25	4	1	0.44	0.25	Non-Point	
Lime Grove Properties 0-5m_M_5	Obtrusivity - Cd	Lux	0.00	1	0	0.00	0.00	Non-Point	
Lime Grove Properties 0-5m_M_6	Obtrusivity - Cd	Lux	2.00	4	2	0.67	0.30	Non-Point	
Lime Grove Properties 0-5m_M_7	Obtrusivity - Cd	Lux	0.00	1	0	0.00	0.00	Non-Point	
Lime Grove Properties 0-5m_M_8	Obtrusivity - Cd	Lux	1.00	4	1	0.53	0.25	Non-Point	
Lime Grove Properties 0-5m_M_9	Obtrusivity - Cd	Lux	0.00	2	0	0.00	0.00	Non-Point	
Lime Grove Properties 0-5m_M_10	Obtrusivity - Cd	Lux	0.00	0	0	N/A	N/A	Non-Point	

Newark Tennis Club		Scale	Project Number
		1: 1000 at A2	51637 / A
		Date	Drawing No.
		25 January 2024	Design A
		Lighting Designer : TF	



For our LED lighting designs a 1.0mf has been used. If this differs from the maintenance period for this project then you must advise us accordingly.

A lighting applications design service is provided by us in good faith and without charge, relating to Kingfisher products only. As such, whilst every endeavor is made for accuracy from information provided by yourselves, the final responsibility for the suitability of the design lies with the client. The company cannot, therefore, accept any liability or consequential loss incurred.

A2