

Tr. No.	Species	Ø (m)	Height (m)	
1	Alder	0.77/0.50	21	
2	Lime	0.71	15	
3	Oak	0.94	17	

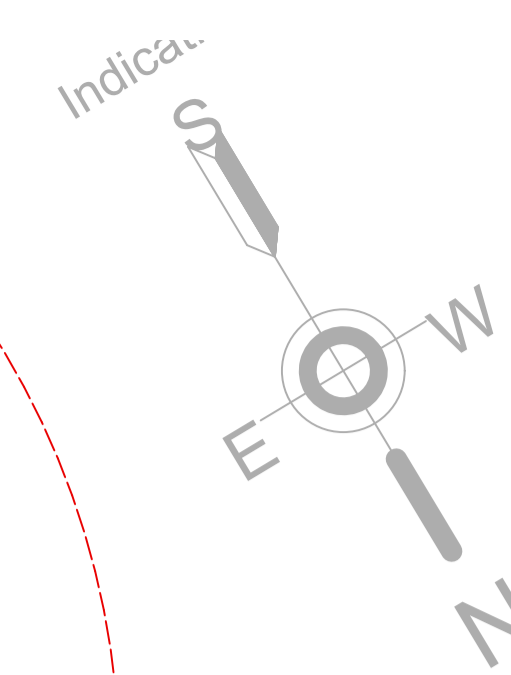

Copyright Notice
 All information remains the intellectual property of the author.
 Drawings are only to be copied or reproduced for planning purposes.
 Please seek the authors permission before reproduction or dissemination for other purposes.

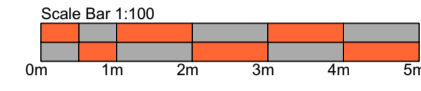
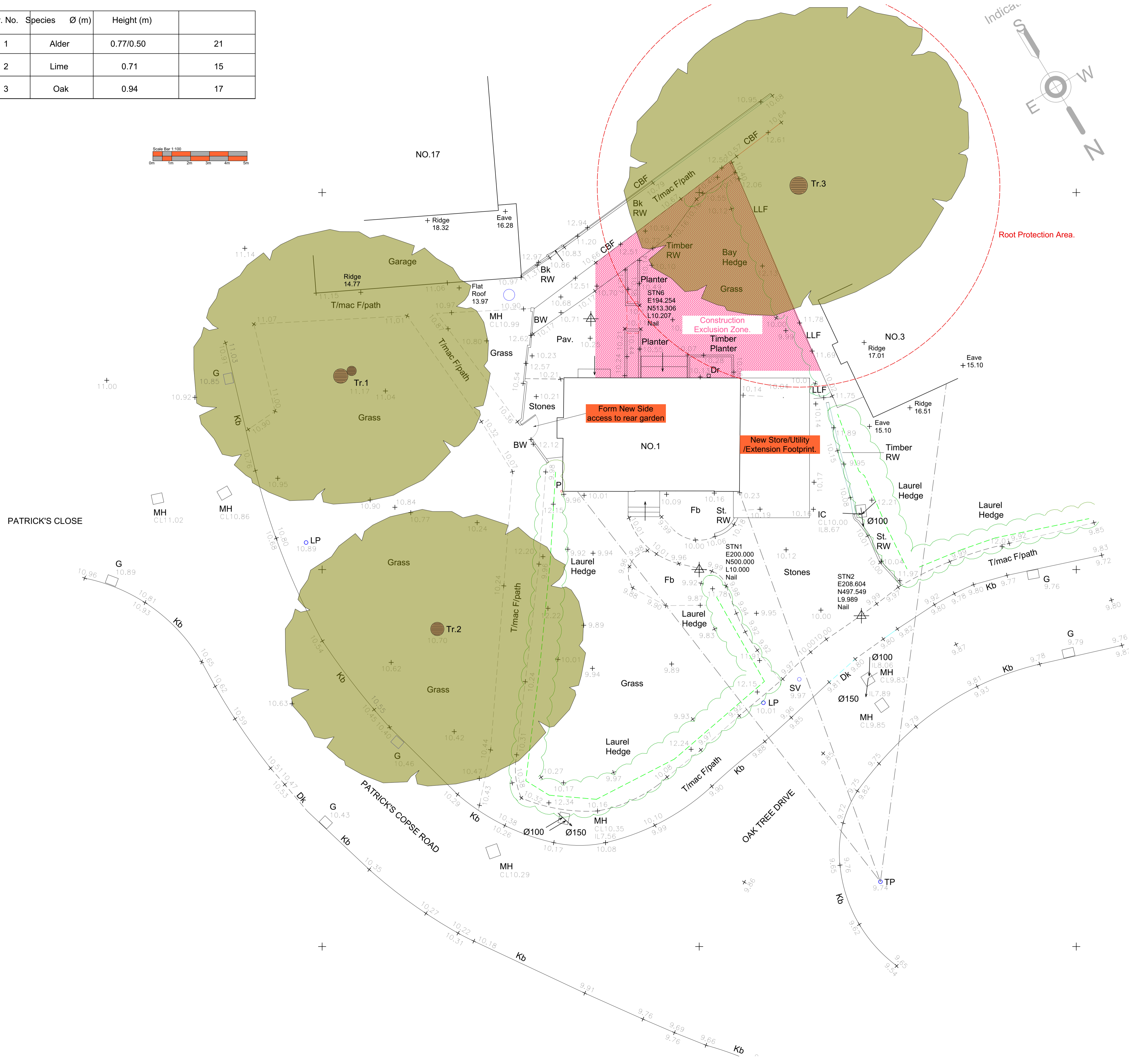

Notes
 Use only Figured Dimensions
 Always check dimensions on site and report any discrepancies to the Architect.
 Not for construction unless marked for this purpose.

REVISION	DESCRIPTION	DRAWN BY	DATE
C	Planning Issue/Scale Bar Added	SWR	08/04/24
B	Planning Issue	SWR	14/03/24
A	Issued For Information	SWR	12/03/24

SWR ARCHITECT

Unit 3, 28 The Spain
 Petersfield,
 Hants
 GU32 3LA
 T. 07919 522851
 E. swr.architect@gmail.com

TITLE **1 Oak Tree Drive , Liss, Hants, GU33 7HW. Extension and Alterations. Mr & Mrs Stribley.**

DRAWING NUMBER	REVISION	STATUS	DATE
2056/104A	C	Planning	Jan 2024

DRAWN BY **SWR**

TITLE **Site Plan Proposed**