

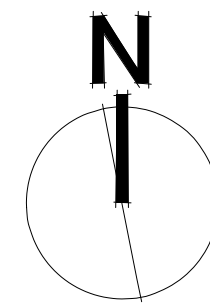

SITE LOCATION PLAN

Scale: 1:1250

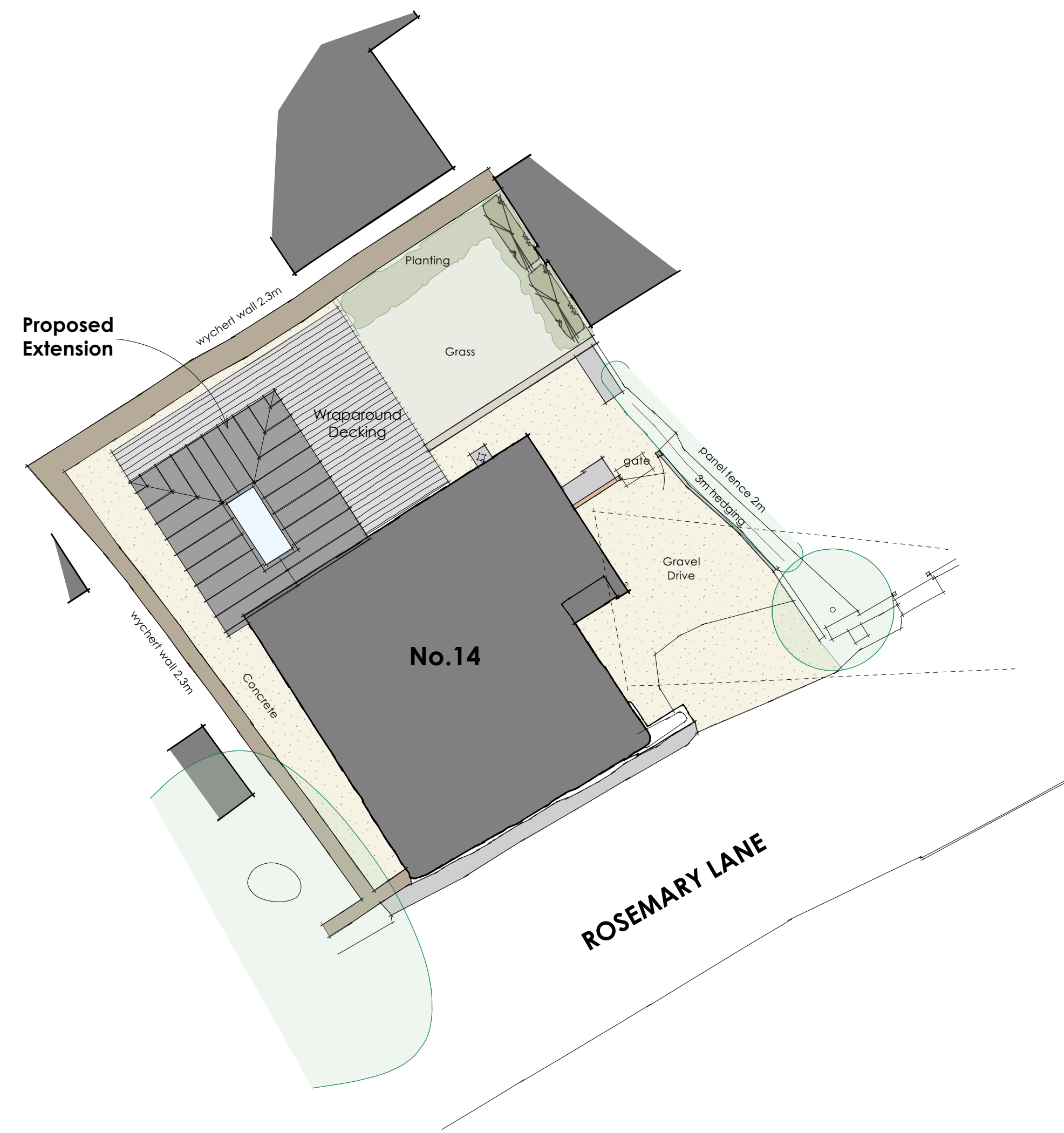
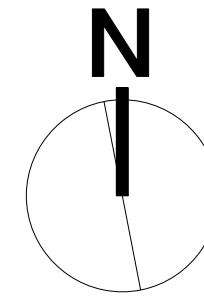
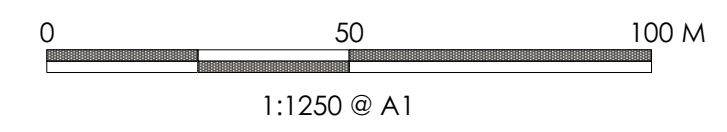

PROPOSED SITE PLAN

Scale: 1:100

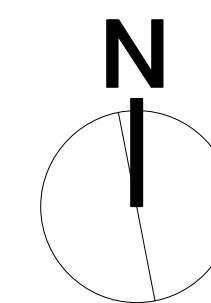
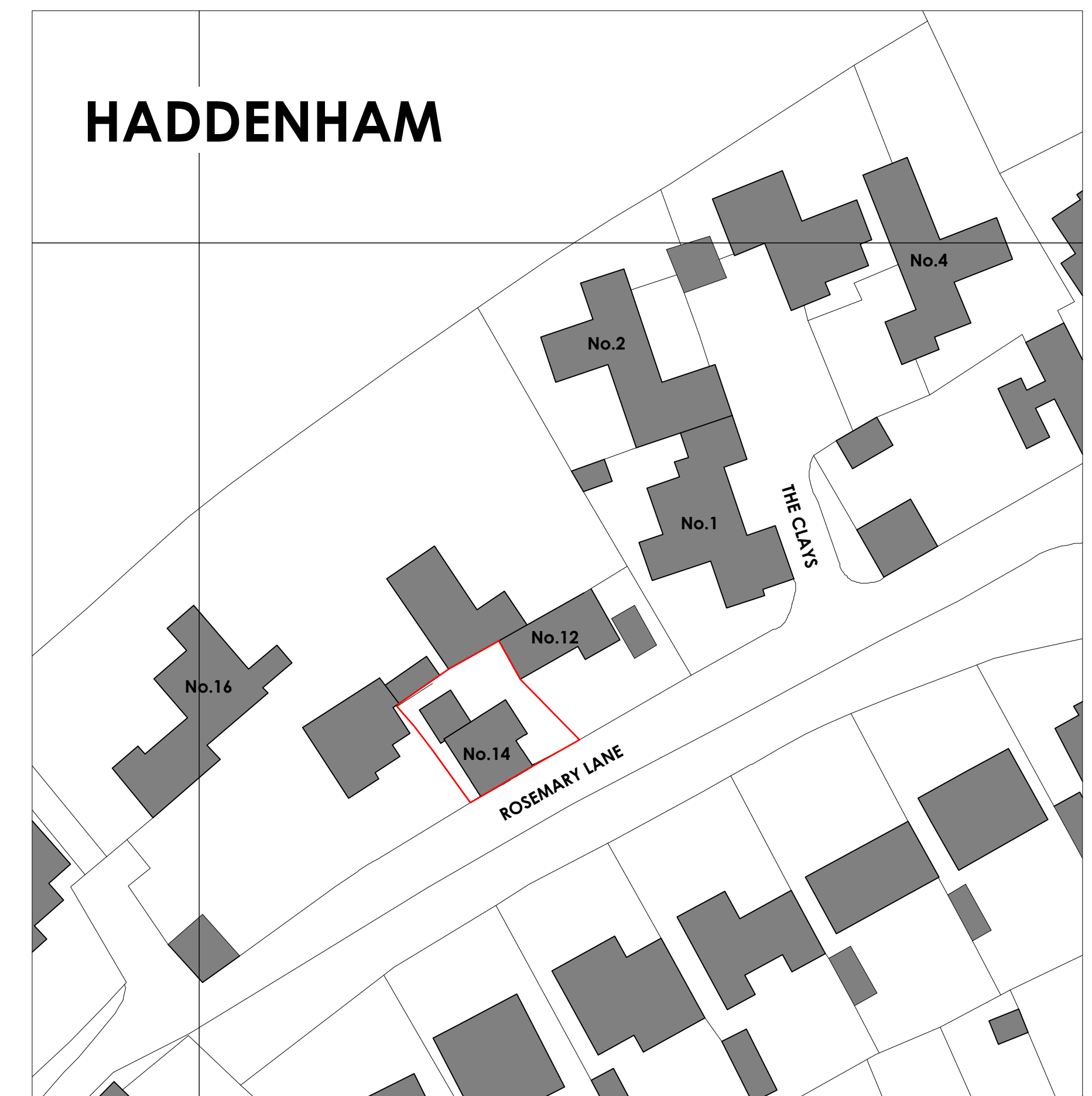
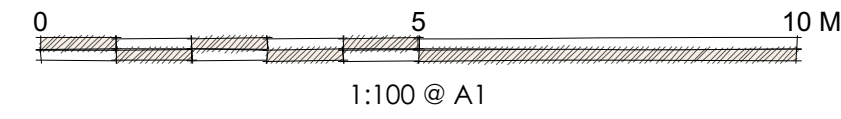

PROPOSED BLOCK PLAN

Scale: 1:500



No.	Date	Revision Notes	Initials	Notes



Client	Mr & Mrs Reed
Project	Residential Extension & Alterations
	14 Rosemary Lane Haddenham HP17 8JS

PROPOSED SITE & BLOCK PLAN		
Scale AS STATED @A1	Dwg No. 24 RLHH SP02	Revision
Drawn TL	Status PLANNING	
Date 19/02/2024		