

Notes

1. This drawing has been prepared in accordance with the scope of RPS's appointment with its client and is subject to the terms and conditions of that appointment. RPS accepts no liability for any use of this document other than by its client and only for the purposes for which it was prepared and provided.
2. If received electronically it is the recipient's responsibility to print to correct scale. Only written dimensions should be used.
3. This drawing should be read in conjunction with all other relevant drawings and specifications.
4. The scheme is subject to statutory approvals, surveys and design development.
5. © Crown copyright and database rights 2023 Ordnance Survey 100031673

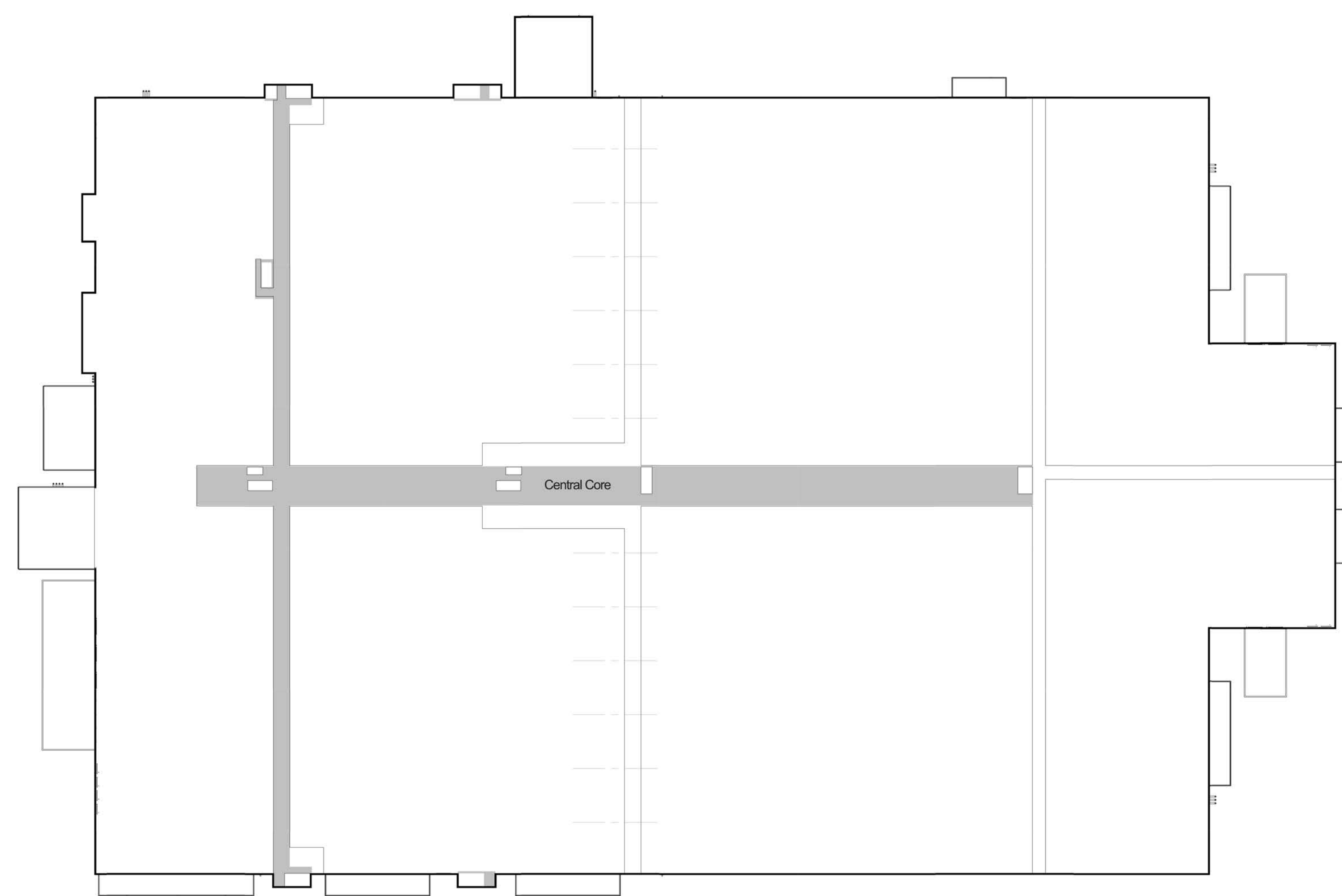

M1 - Central Core First Floor (+5.000m)

1 : 1000

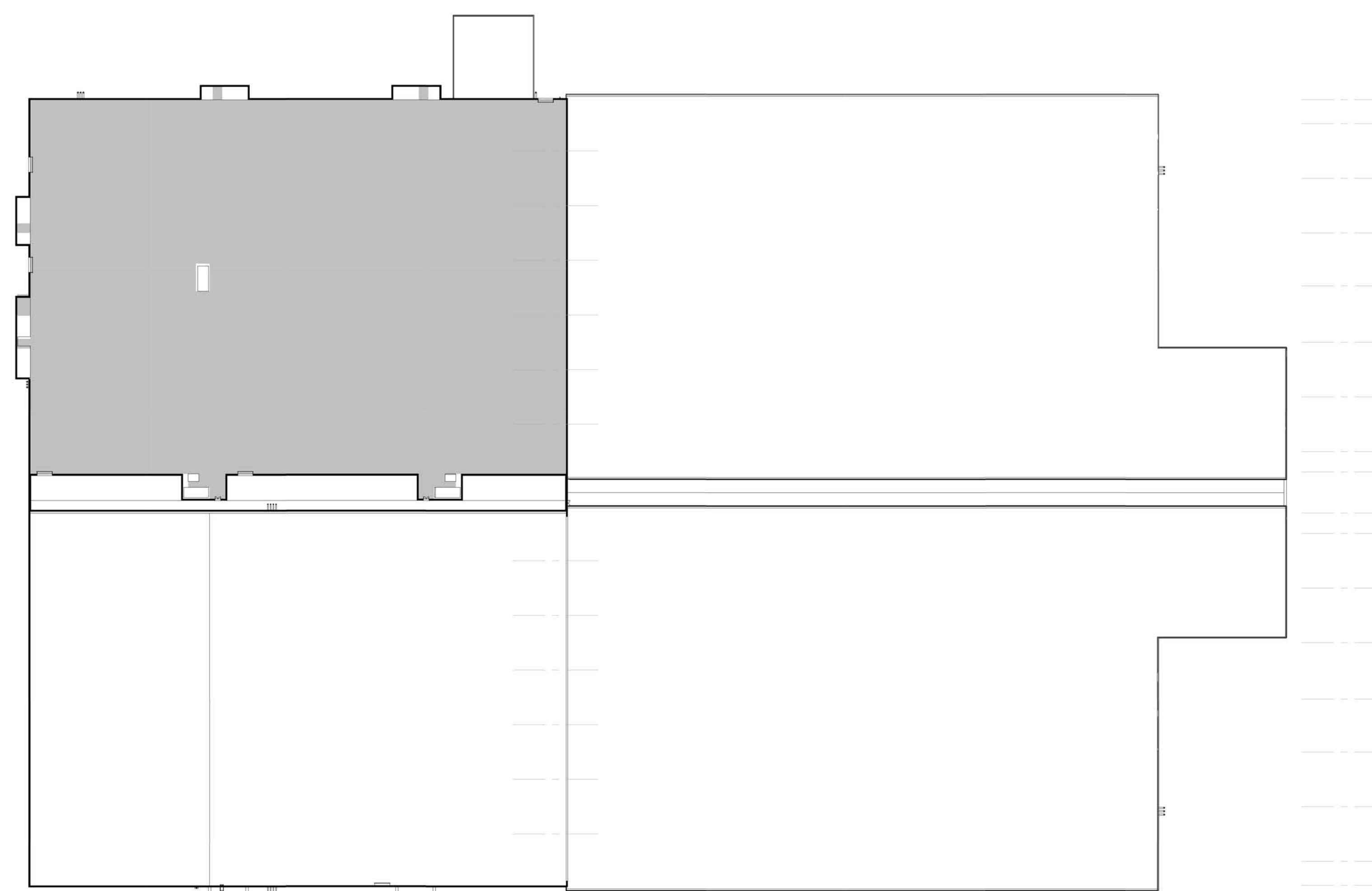

3F - Second Floor (+20.500m)

1 : 1000

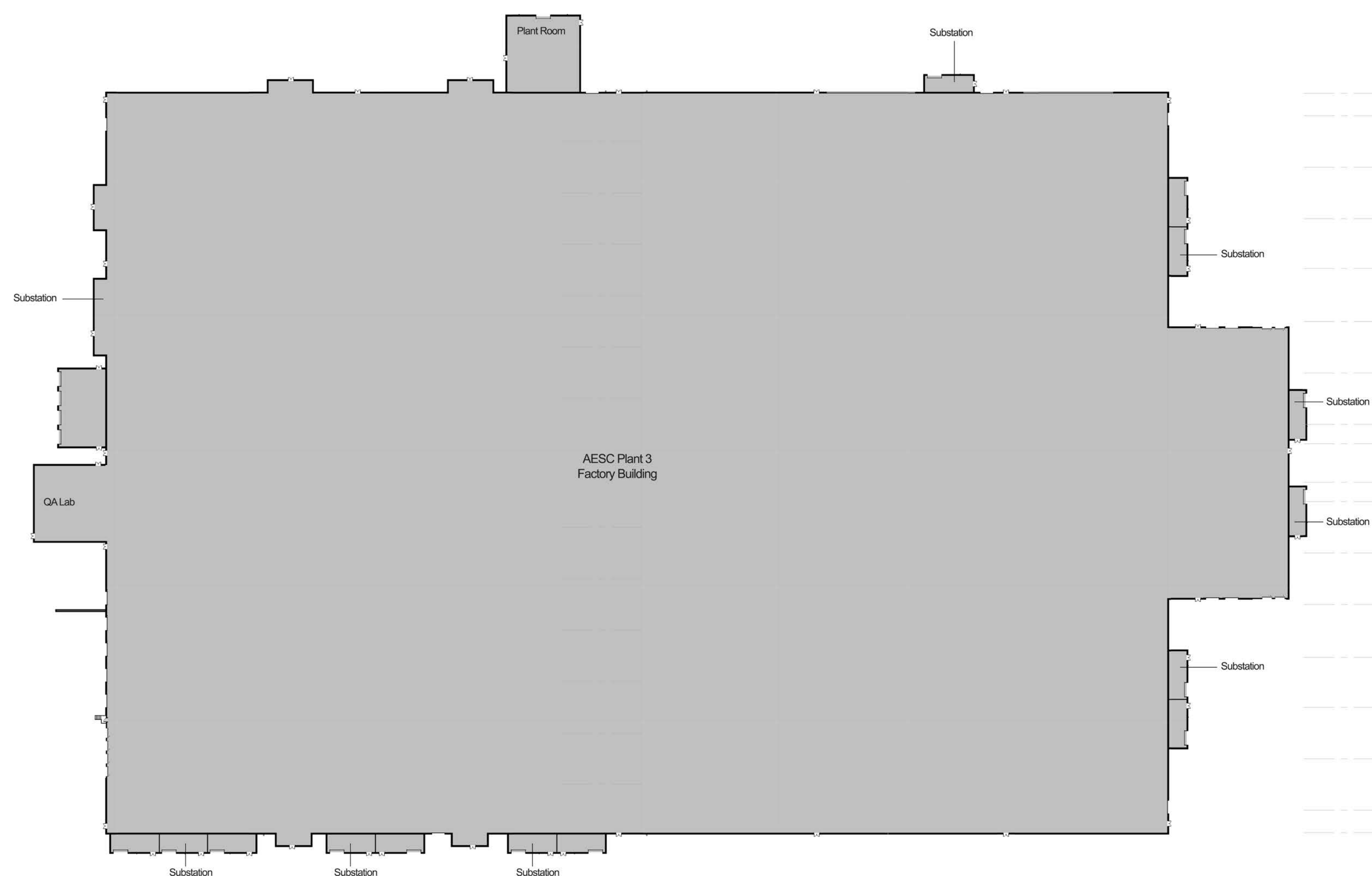

1F - Ground Floor (+0.000m)

1 : 1000

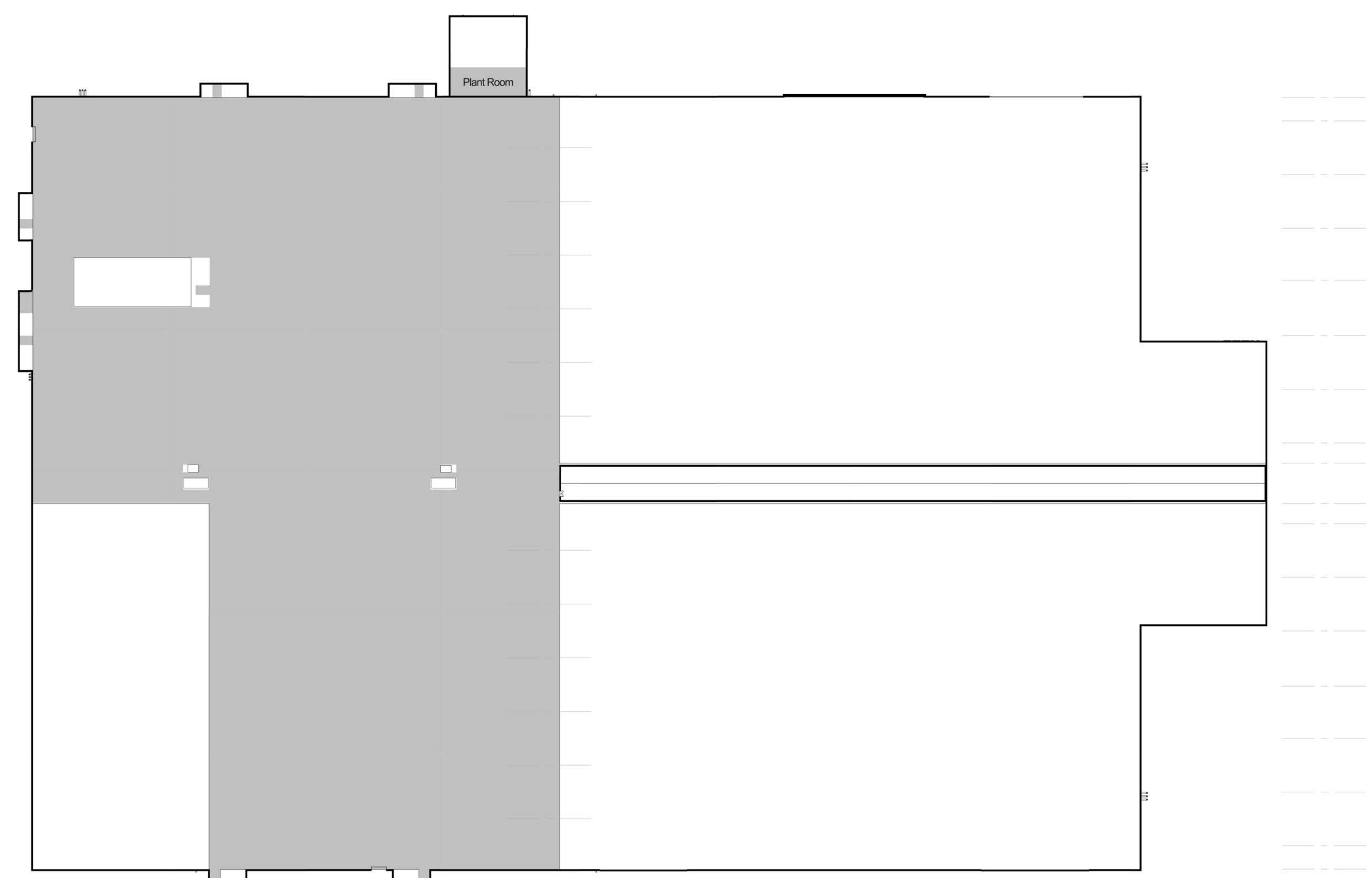

2F - First Floor (+11.000m)

1 : 1000



P02 Planning Submission	JG	JAT	29/09/23
Rev	Description	By	Apr



Sherwood House, Sherwood Avenue,
 Newark, Nottinghamshire, NG24 1QG
 T: 01636 659 700 E: rpsnewark@rpsgroup.com

Client



Project AESC Giga Factories
 Plot 2 Planning

Title AESC Plant 3
 Proposed Plans

RPS Project Number	Scale @A0	Date Created
NK020439P	1 : 1000	03/07/23
Task Team	Information	Task Information
Manager	Author	Manager
JAT	AS	OP
Status		
S2 Suitable for Information		
Document Number	Revision	
211	P02	