

Notes

1. This drawing has been prepared in accordance with the scope of RPS's appointment with its client and is subject to the terms and conditions of that appointment. RPS accepts no liability for any use of this document other than by its client and only for the purposes for which it was prepared and provided.
2. If received electronically it is the recipient's responsibility to print to correct scale. Only written dimensions should be used.
3. This drawing should be read in conjunction with all other relevant drawings and specifications.
4. This scheme is subject to statutory approvals, surveys and design development.
5. © Crown copyright and database rights 2024 Ordnance Survey 010001673

Surface Water Drainage Notes

1. Exceedences illustrated are for 1 in 100 year rainfall event plus 45% climate change.

Drawing to be read in conjunction with:
 251 - Proposed Surface Water Drainage Layout Sheet 1
 252 - Proposed Surface Water Drainage Layout Sheet 2
 253 - Proposed Surface Water Drainage Layout Sheet 3
 254 - Proposed Four Water Drainage Layout Sheet 1
 255 - Proposed Four Water Drainage Layout Sheet 2
 256 - Proposed Four Water Drainage Layout Sheet 3

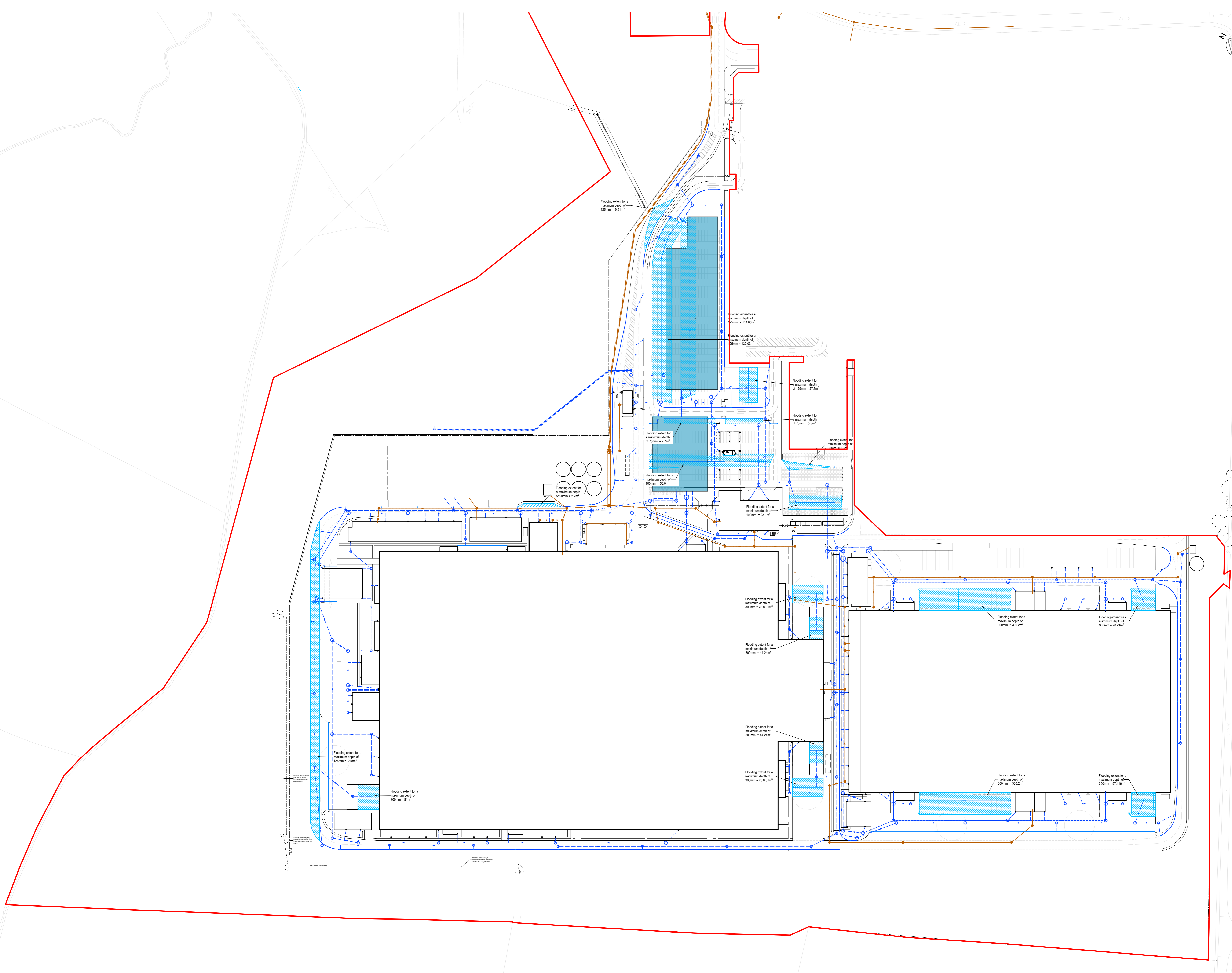

P02	Planning Submission	LMA	MM	20/02/24
Rev	Description	By	Clk	Date

rps MAKING COMPLEX EASY
 A TETRA TECH COMPANY
 Sherwood House, Sherwood Avenue,
 Newark, Nottinghamshire, NG24 1QG
 T: 01652 695 700 E: rpsnewark@rpsgroup.com

Client
AESC Waters

Project
 AESC Giga Factories
 Plot 2 Planning

Title
 Proposed Site Surface Water
 Drainage Exceedance Plan

RPS Project Number	Scale @ A0	Date Created
NK020439-P	1:1000	21/09/23
Task Team Manager	Information Author	Task Information Manager
TH	LMA	MM

Sheet	Revision
S2 (Suitable for Information)	P02
Document Number	
257	
Project Code - Originator - Function - Spec - Type - Rev - Number	
rpsgroup.com	