

Notes

1. This drawing has been prepared in accordance with the scope of RPS's appointment with its client and is subject to the terms and conditions of that appointment. RPS accepts no liability for any use of this document other than by its client and only for the purposes for which it was prepared and provided.
2. If received electronically it is the recipient's responsibility to print to correct scale. Only written dimensions should be used.
3. This drawing should be read in conjunction with all other relevant drawings and specifications.
4. The scheme is subject to statutory approvals, surveys and design development.
5. © Crown copyright and database rights 2023 Ordnance Survey 0100031673

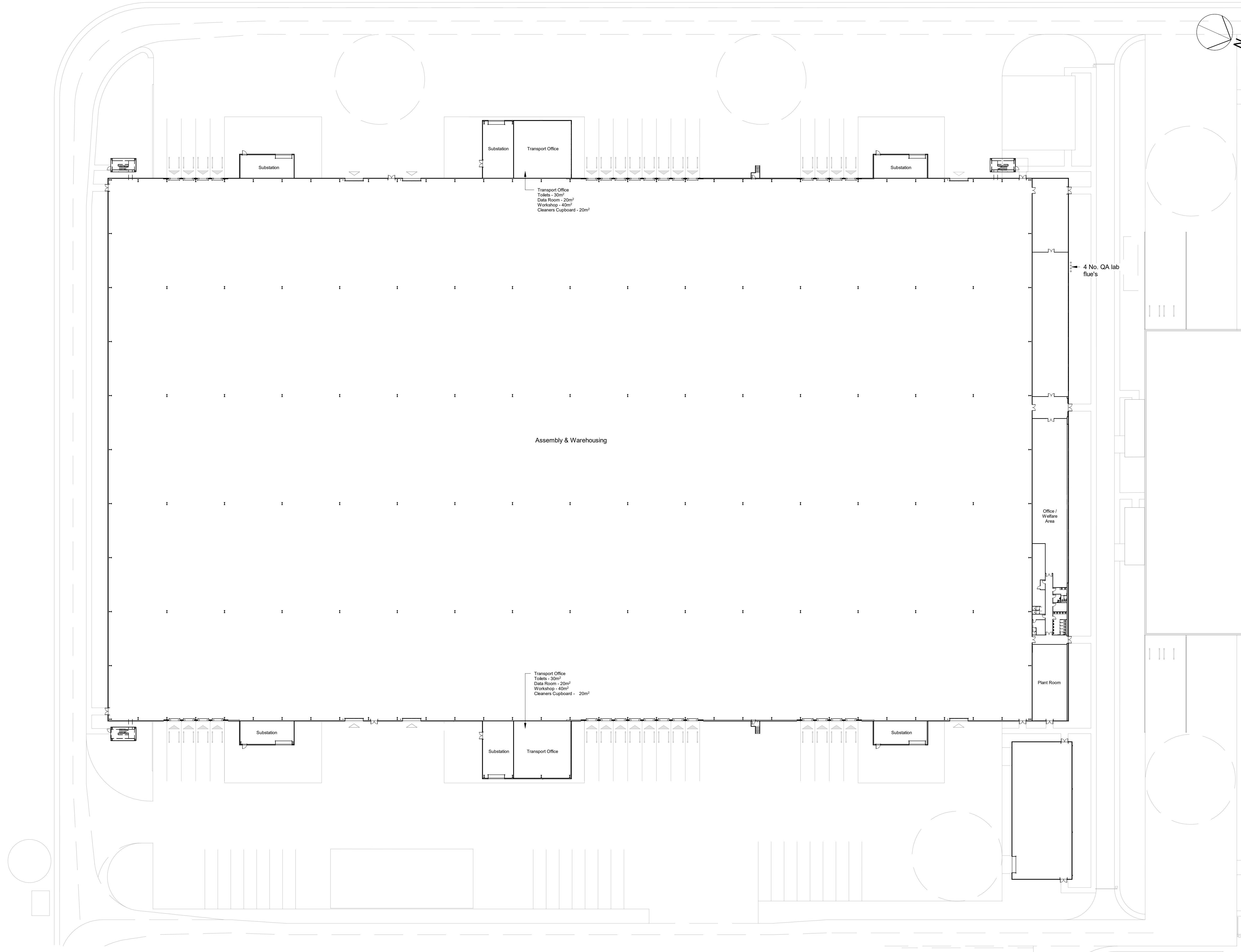

Assembly & Warehousing Proposed Plan
1 : 500



P02	Planning Submission	HH	JAT	29/09/23
Rev	Description	By	Apr	Date

rps MAKING COMPLEX EASY
A TETRA TECH COMPANY
Sherwood House, Sherwood Avenue,
Newark, Nottinghamshire, NG24 1QQ
T:01636 605 700 E:rpnewark@rpsgroup.com

Client
AESC Wates

Project AESC Giga Factories
Plot 2 Planning

Title Assembly & Warehousing
Proposed Plan

RPS Project Number NK020439P	Scale @A1 1 : 500	Date Created 03/07/23
Task Team Manager JAT	Information Author AS	Task Information Manager OP
Status S2 (Suitable for Information)	Document Number 214	Revision P02