

Notes

1. This drawing has been prepared in accordance with the scope of RPS's appointment with its client and is subject to the terms and conditions of that appointment. RPS accepts no liability for any use of this document other than by its client and only for the purposes for which it was prepared and provided.
2. If received electronically it is the recipient's responsibility to print to correct scale. Only written dimensions should be used.
3. This drawing should be read in conjunction with all other relevant drawings and specifications.
4. The scheme is subject to statutory approvals, surveys and design development.
5. © Crown copyright and database rights 2023 Ordnance Survey 0100031673

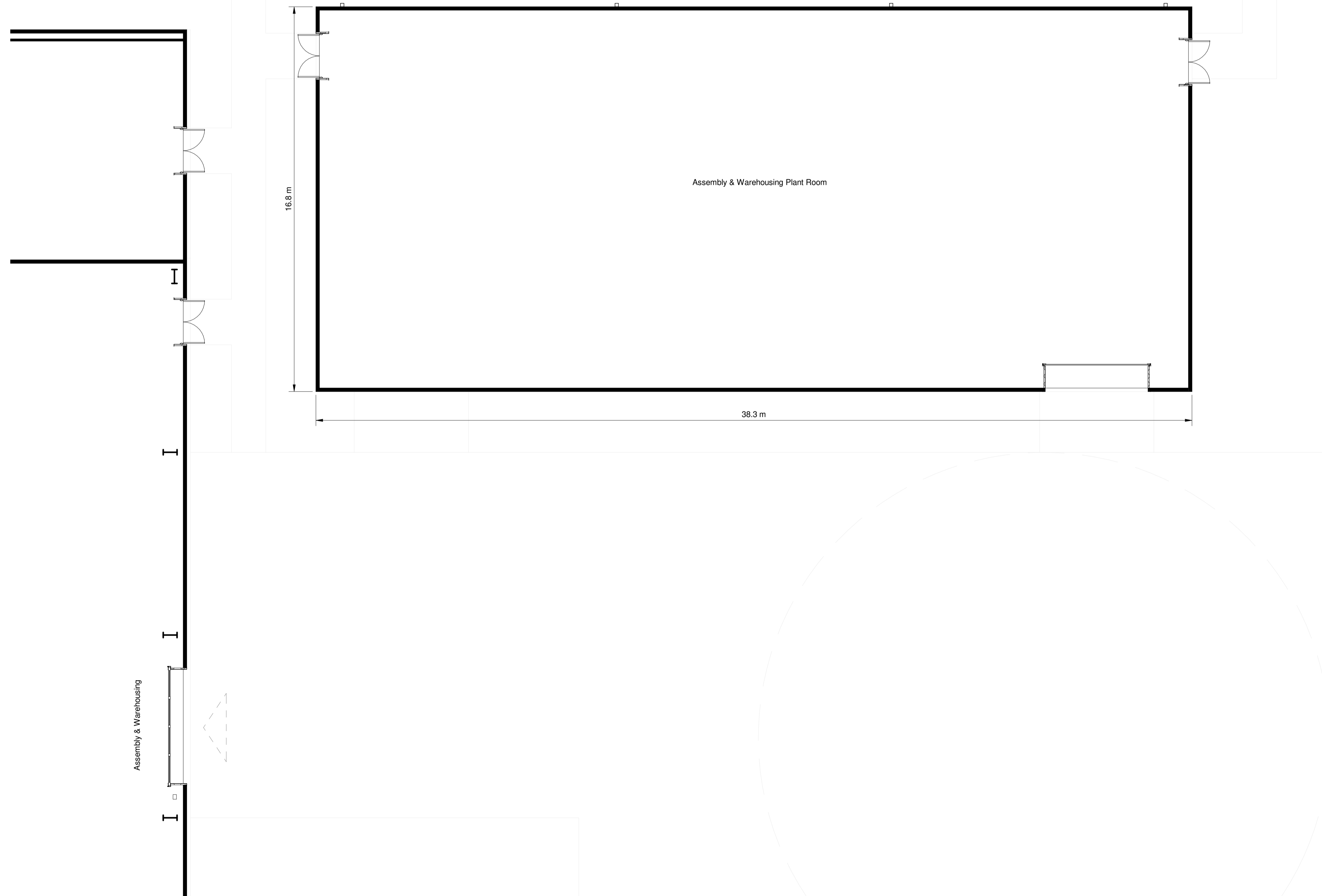

Plant Room Layout
1 : 100



P02	Planning Submission	HH	JAT	29/09/23
Rev	Description	By	Apr	Date

rps MAKING COMPLEX EASY
 A TETRA TECH COMPANY
 Sherwood House, Sherwood Avenue,
 Newark, Nottinghamshire, NG24 1QQ
 T:01636 605 700 E: rpsnewark@rpsgroup.com

Client



Project AESC Giga Factories
Plot 2 Planning

Title Assembly & Warehousing
Plant Room Proposed
Plan

RPS Project Number	Scale @A1	Date Created
NK020439P	1 : 100	03/07/23
Task Team Manager	Information Author	Task Information Manager
JAT	AS	OP

Status
S2 (Suitable for Information)

Document Number	Revision
228	P02