

Existing Site Boundary fence treatment retained.

Inner perimeter fence 2.4m Palisade type wire mesh fence (RAL 6005 green)

Existing ground level

Landscaping

Circulation Road

Gravel

AESC Plant 3 Building (Low Bay)

FFL=TBC

Gravel Footpath

Fire Access Road

AESC UK Client HD

FFL=TBC

Section 3-3
Scale 1:200

National Grid Infrastructure (indicative)

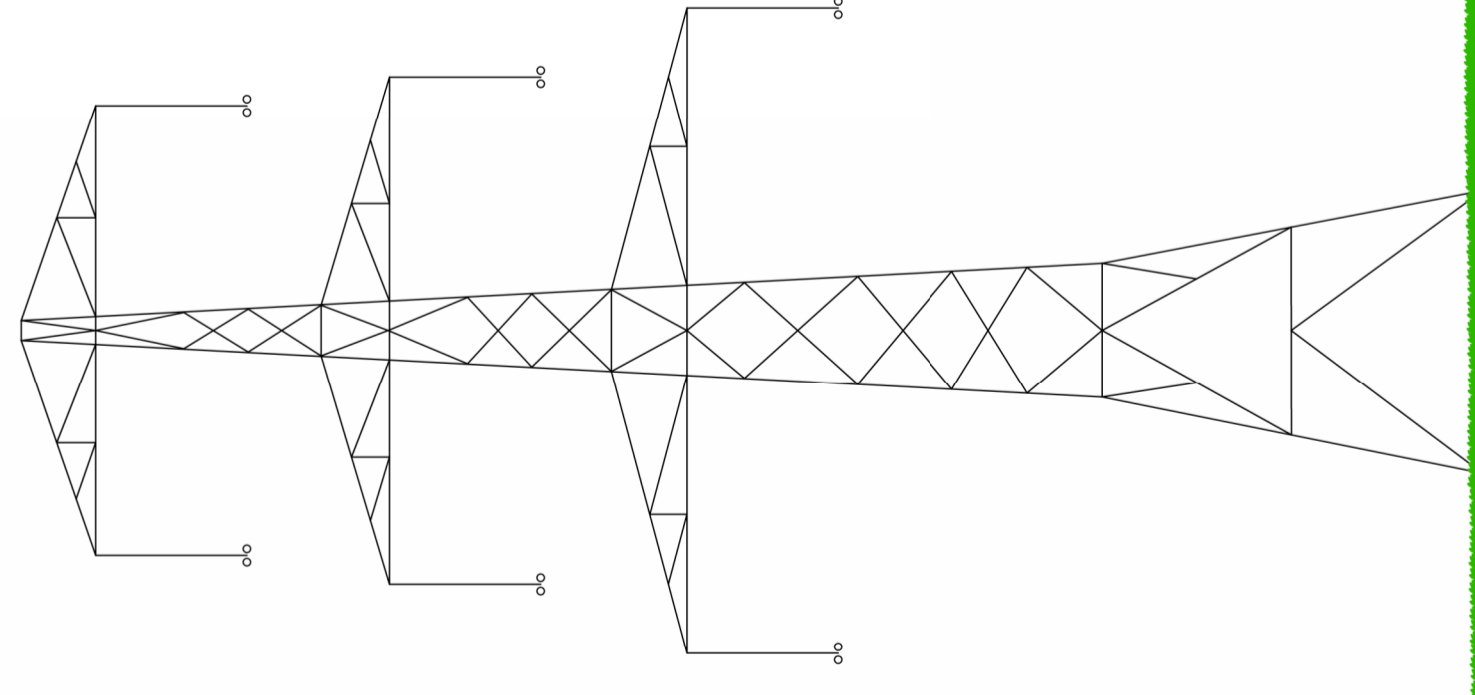

Existing Site Boundary fence treatment retained

Inner perimeter fence 2.4m Palisade type wire mesh fence (RAL 6005 green)

Existing ground level

Footpath

Circulation Road

Goods In Yard

Existing ground level

Assembly & Warehousing

FFL=TBC

Goods Out Yard

Existing ground level

Waste Canopy

AESC Plant 2 Building

Section 4-4
Scale 1:200

Perimeter fence 2.4m Palisade type wire mesh fence (RAL 6005 green)

Existing ground level

Assembly & Warehousing

FFL=TBC

Gravel

Footpath

Circulation Road

Footpath

Assembly & Warehousing

Gravel

Footpath

Fire Access Road

AESC UK Client HD

FFL=TBC

Goods Out Yard

Existing ground level

Waste Canopy

AESC Plant 2 Building

Section 5-5
Scale 1:200

- Notes
- This drawing has been prepared in accordance with the scope of RPS's services as defined in the contract. RPS does not accept liability for any use of this document for purposes other than those intended, and only for the purposes for which it was prepared and provided.
 - If revised drawings are issued, it is the responsibility of the user to ensure that the latest version is used. It is the responsibility of the user to ensure that the latest version is used.
 - This drawing should be read in conjunction with all other relevant drawings.
 - © Crown copyright and database right 2023 Ordnance Survey 100031873

Drawing Reference:

For Topographical survey received from Met Geo Environmental received December 2021 refer to PLS103 Survey Type B - PZ1-000099.MET-000099.LMS.M2.GU For 400KV Route Plans and Profile Permanent Division refer to 21762-GLE-0698-ZZ-DR-Y-060251 For 400KV Route Plans and Profile Permanent Division refer to 21762-GLE-0698-ZZ-DR-Y-060252 For Easement Plan refer to Fisher German drawing. NGE12021507-RWEP-ZZA Division 2024-06-04 (Preliminary PLS)

Refer to RPS Drawing 204 Proposed Site Layout

Refer to RPS Drawing 207 for Proposed Site Sections Sheet 1

Rev	Description	LM	TH	DATE
01	PROJ	PLANNING	20240604	

Client: AESC Wates
AESCC Cigs Factories Plot 2 Planning

Project: Proposed Site Sections Sheet 2

RPS Project Number: NK020439P
Scale @ A0: 1:200
Date Created: 05/07/23
Task Information: Information
Task Manager: TRU
Task Number: TSR

Revision: P03
Document Number: 208
Project Code: 0194497 - Facilities - Sheet 1 - Plot Area Number
rpsgroup.com

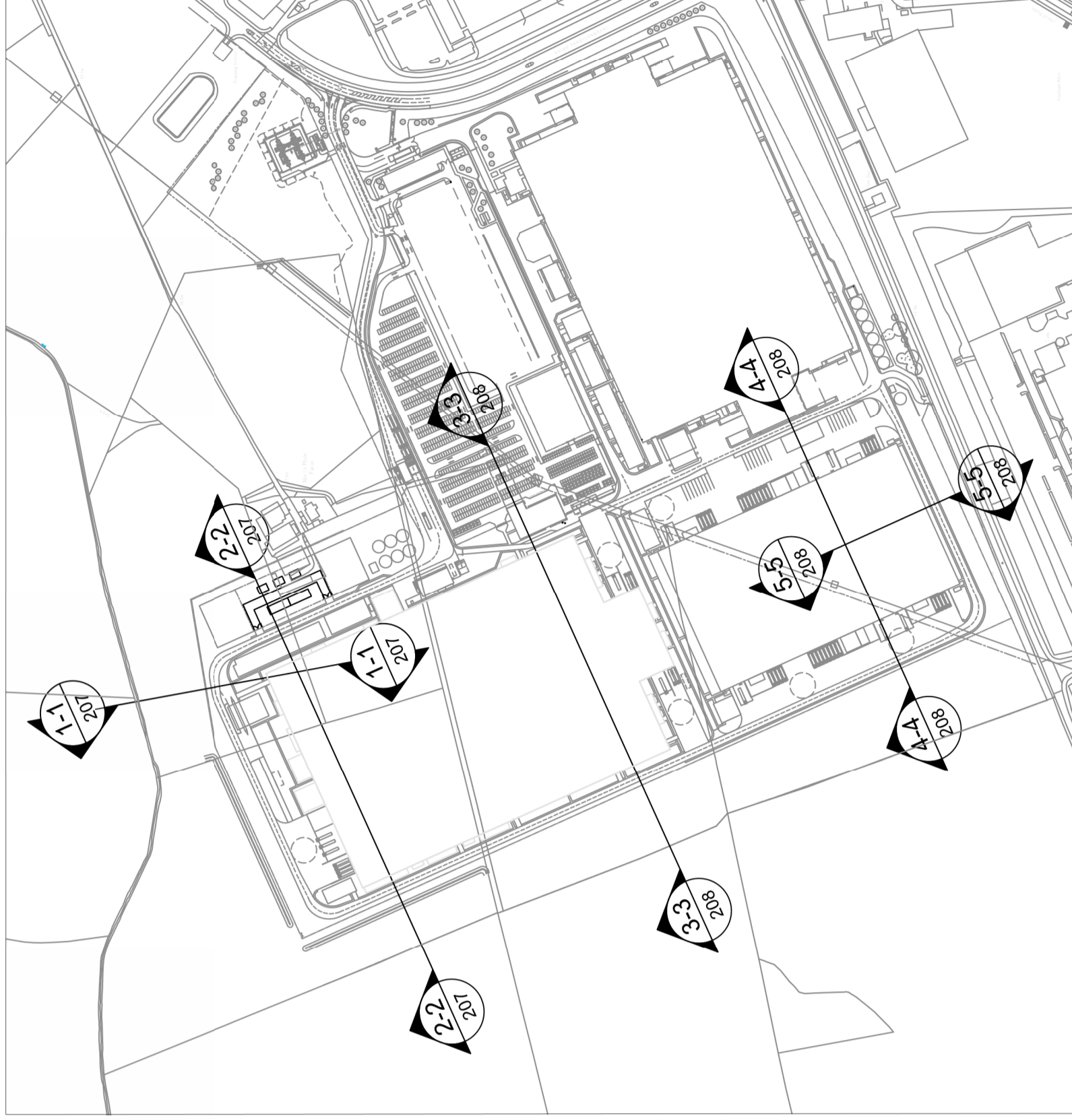
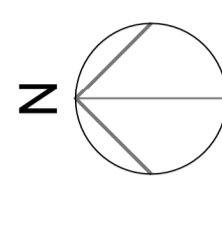

Key Plan

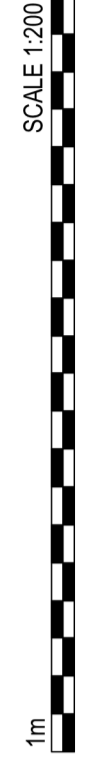

SCALE 1:200