

Notes

1. This drawing has been prepared in accordance with the scope of RPS's appointment with its client and is subject to the terms and conditions of that appointment. RPS accepts no liability for any use of this document other than by its client and only for the purposes for which it was prepared and provided.
2. If received electronically it is the recipient's responsibility to print to correct scale. Only written dimensions should be used.
3. This drawing should be read in conjunction with all other relevant drawings and specifications.
4. The scheme is subject to statutory approvals, surveys and design development.
5. © Crown copyright and database rights 2023 Ordnance Survey 0100031673

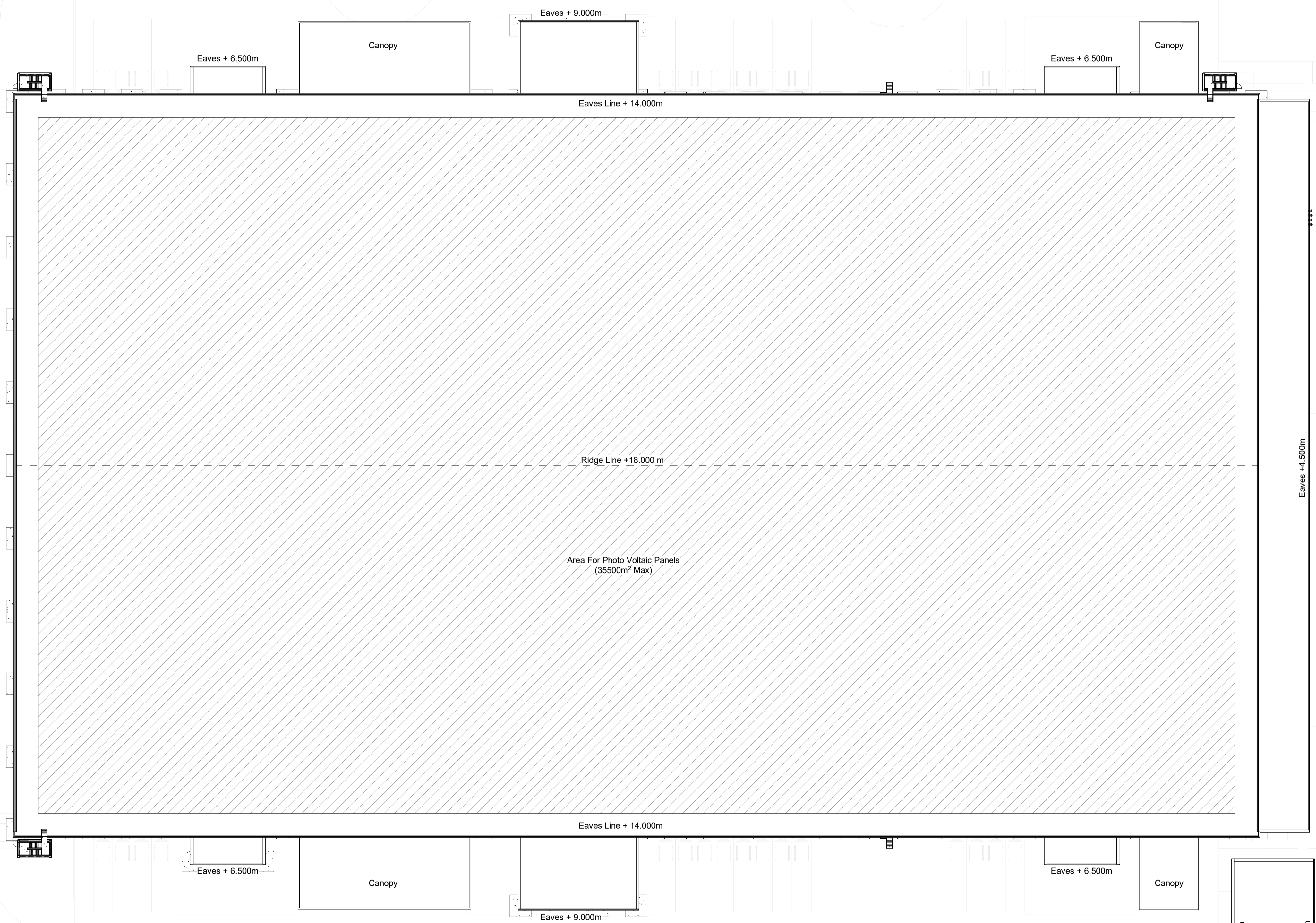

P02	Planning Submission	HH	JAT	29/09/23
Rev	Description	By	Apr	Date

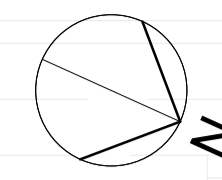

A TETRA TECH COMPANY
 Sherwood House, Sherwood Avenue,
 Newark, Nottinghamshire, NG24 1QQ
 T:01636 605 700 E:rpnewark@rpsgroup.com

Client



Project AESC Giga Factories
 Plot 2 Planning

Title Assembly & Warehousing
 Proposed Roof Plan

RPS Project Number Scale @A1 Date Created
 NK020439P 1 : 500 03/07/23

Task Team Information Task Information
 Manager Author Manager
 JAT AS OP

Status
 S2 (Suitable for Information)

Document Number Revision
 215 P02

rpsgroup.com

Assembly & Warehousing Proposed Roof Plan

1 : 500

