

Notes

1. This drawing has been prepared in accordance with the scope of RPS's appointment with its client and is subject to the terms and conditions of that appointment. RPS accepts no liability for any use of this document other than by its client and only for the purposes for which it was prepared and provided.
2. If received electronically it is the recipient's responsibility to print to correct scale. Only written dimensions should be used.
3. This drawing should be read in conjunction with all other relevant drawings and specifications.
4. The scheme is subject to statutory approvals, surveys and design development.
5. © Crown copyright and database rights 2023 Ordnance Survey 0100031673

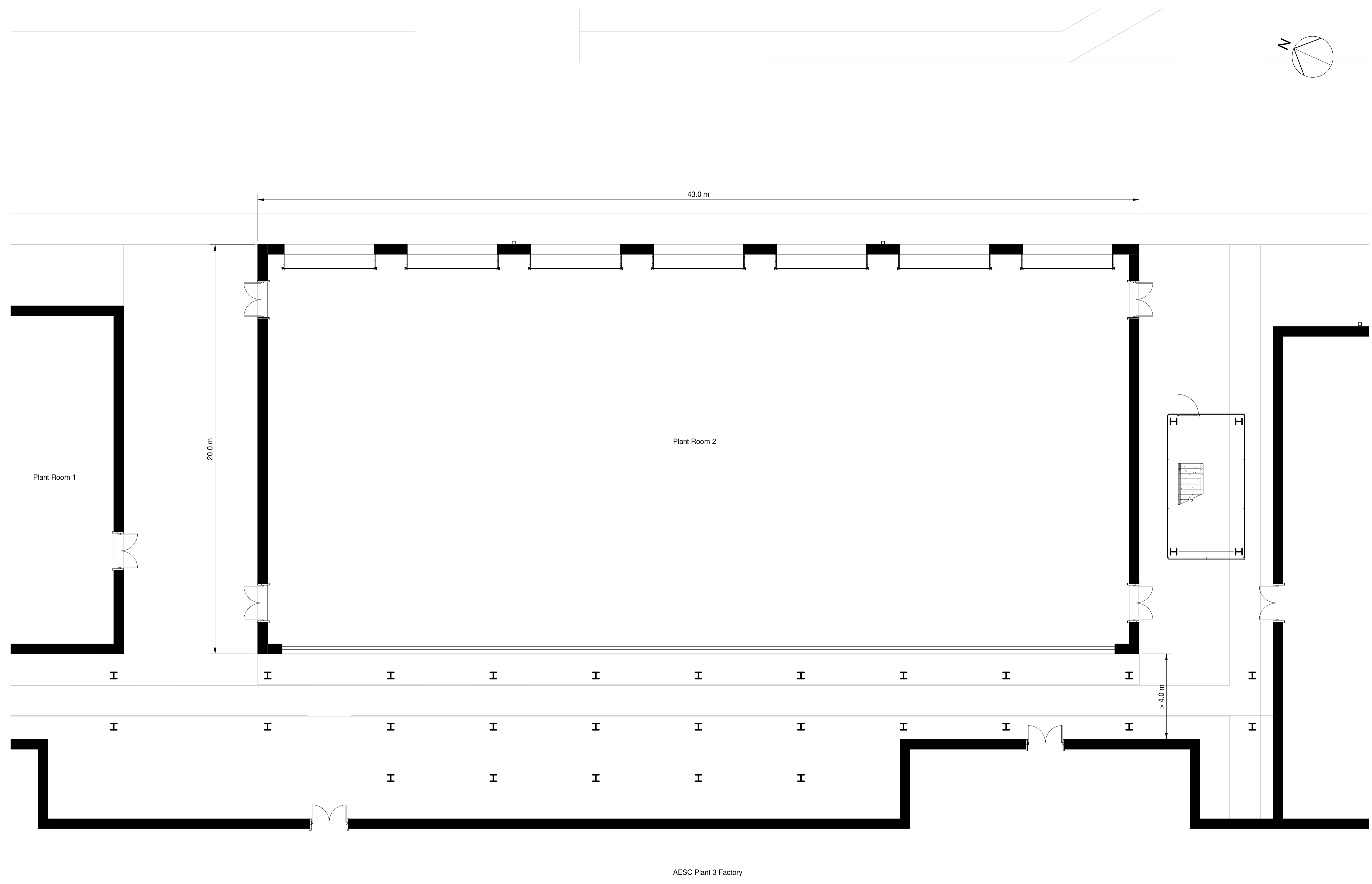
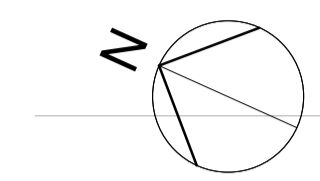

**Plant Room 2 - Proposed Plan**  
1 : 100

P02	Planning Submission	HH	JAT	29/09/23
Rev	Description	By	Apr	Date

**rps** MAKING COMPLEX EASY  
A TETRA TECH COMPANY  
Sherwood House, Sherwood Avenue,  
Newark, Nottinghamshire, NG24 1QQ  
T:01536 605 700 E: rpsnewark@rpsgroup.com

Client  
**AESC Wates**

Project **AESC Giga Factories Plot 2 Planning**

Title **AESC Plant 3 Factory Plant Room 2 Proposed Plan**

RPS Project Number	Scale @A1	Date Created
NK020439P	1 : 100	03/07/23
Task Team Manager	Information Author	Task Information Manager
JAT	JGG	OP
Status		
S2 (Suitable For Information)		
Document Number		Revision
224		P02
<a href="http://rpsgroup.com">rpsgroup.com</a>		

