

1:200 ORNAMENTAL PLANTING DETAILS

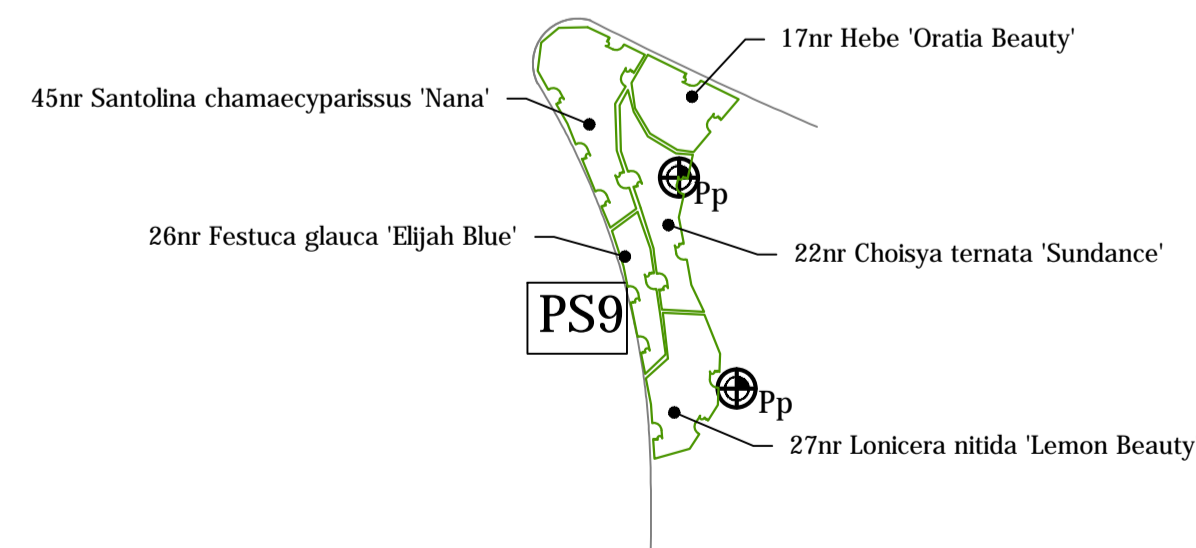
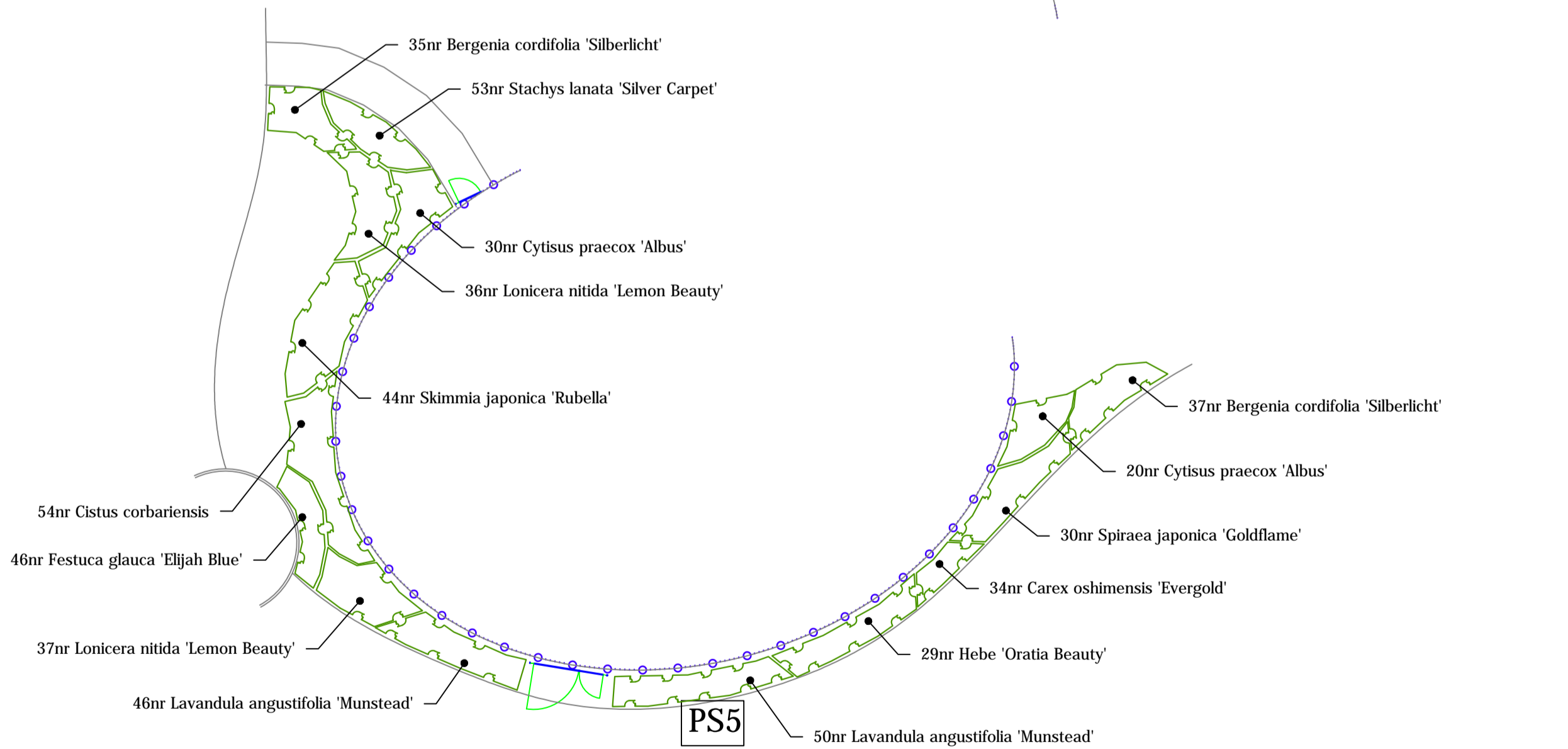
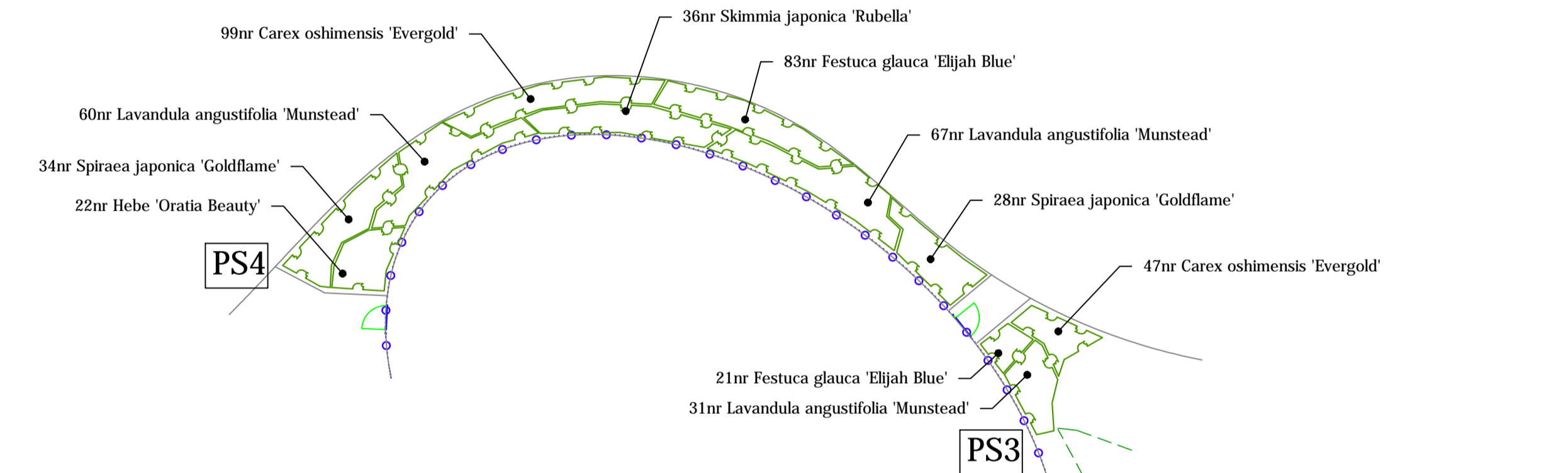
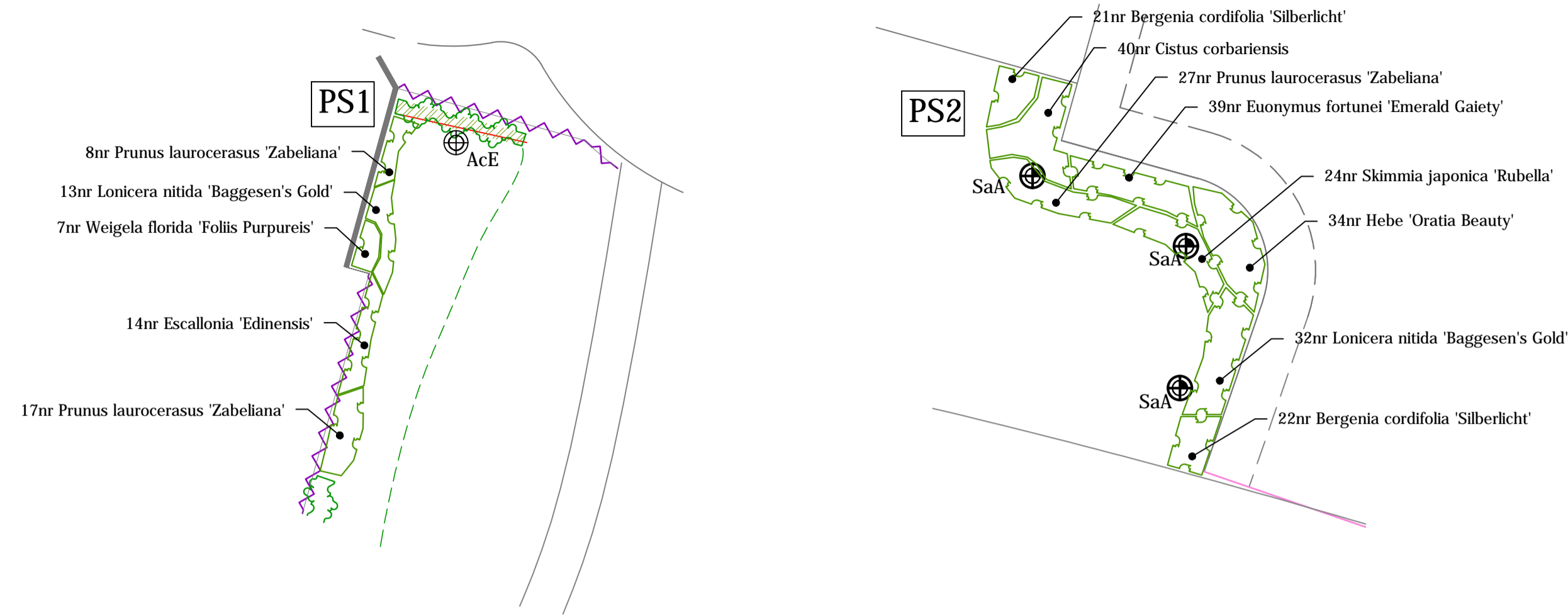

PLANTING SCHEDULES

NATIVE SPECIES SHRUB PLANTING

NATIVE SHRUB MIX SCHEDULE					
Nr	Name	Height/cm	Age	Root	Pot/L
47	Corylus avellana	40-60cm	1/1	B	
35	Ilex aquifolium	40-60cm		C	3L
12	Lonicera periclymenum	60-80cm		C	3L
70	Prunus spinosa	40-60cm	1/1	B	
12	Rosa arvensis	30-40cm	1/1	B	
12	Rosa canina	30-40cm	1/1	B	
47	Viburnum opulus	40-60cm	1/1	B	

Native species shall be planted into 450mm depth, good quality clean topsoil incorporating organic compost and slow release fertiliser, over un-compacted sub-grade. Prior to planting all bareroot plant stock shall be dipped into a suitable mychorrhal plant dip in accordance with the manufacturers recommendations. Plants shall be planted in groups of 3-11 of a single species with the taller growing species to the back of the areas of the areas and the lower growing species to the edges of the areas. Planted areas to be mulched after planting with coarse grade forest mulch to a uniform depth of 50mm.

NATIVE SPECIES HEDGE SCHEDULE

NATIVE HEDGE SCHEDULE					
Nr	Name	Height/cm	Age	Root	Pot/L
348	Corylus avellana	60-80cm	1/1	B	
348	Ilex aquifolium	60-80cm		C	3L
87	Lonicera periclymenum	60-80cm		C	2L
522	Prunus spinosa	60-80cm	1/1	B	
87	Rosa arvensis	40-60cm		B	
348	Viburnum opulus	40-60cm	1/1	B	

Native species shrub mix to be planted at 5/m in double staggered rows. To be pit planted into pits large enough to accommodate the root systems without constriction. Pits to be backfilled with a 3:1 topsoil:compost mix.

PLANTING NOTES

All trees to be planted and procured in accordance with BS 8545:2014 and BS 3936:1992 Nursery Stock Part 1. The providing nursery shall demonstrate Plant Healthy Certification and/or an adopted biosecurity policy and plant passport scheme.

Aftercare shall be in accordance with the approved Landscape Management Document.

GROUND PREPARATION

- Where required all existing topsoil and subsoil shall be stripped and stored separately on site. Heaps must not exceed 3m in height and should be used within 12 months in accordance with BS 4425 (Code of practice for general landscape operations).
- Existing topsoil and inert sub soils, shall be analysed in accordance with BS 3882 to determine available nutrients, texture, organic matter content and pH. Where required, existing soils are to be improved in accordance with BS 3882:2015. Subsoils shall conform to BS 8601:2013
- In all instances, where soil is to be retained and relatively undisturbed for the purposes of planting new vegetation on site, then it must be alleviated to avoid compaction, must be tested for pH for specific species suitability, and may require the addition of biochar + compost + organic fertiliser + native soil.
- Imported topsoil and site won soils shall be to British Standards BS 3882 - Multipurpose Grade. Spread to 300mm depth over areas to be planted with trees and shrubs. Remaining minimum rooting depth to be provide by a good quality subsoil to BS 8601:2013, free of building material debris to achieve the following overall rooting depths:
Grass - 450mm
Shrubs - 600mm
Trees - 900mm

SEE SEPARATE LANDSCAPE MANAGEMENT PLAN FOR MANAGEMENT SPECIFICATIONS

SEE DRAWING R/1970/11H FOR POS MASTERPLAN, TREE SPECIES LOCATIONS AND NATIVE PLANTING LABELS

TREE SCHEDULE

SPECIES	Ht in m	NUMBERS REQUIRED			
		3.0-3.5	3.5-4.25	4.25 min	2.5-3.0
	Birth in cm	10-12	12-14	14-16	multistemmed
Acer campestre 'Elsrijk' (AcE)	-	-	7	-	-
Acer platanoides (Apl)	4	11	1	-	-
Betula pendula (Bp)	7	-	-	-	23
Carpinus betulus (Cb)	-	12	7	-	-
Corylus avellana (Ca)	-	-	-	-	19
Crataegus monogyna (Cm)	-	-	-	-	16
Fagus sylvatica (Fs)	-	-	7	-	-
Liquidambar styraciflua 'Worpleston' (Lw)	-	-	2	-	-
Prunus avium (Pa)	6	5	-	-	-
Prunus padus (Pp)	3	2	3	-	-
Pyrus calleryana 'Red Spire' (PeR)	-	2	2	-	-
Quercus robur (Qr)	3	7	3	-	-
Sorbus 'Embley' (SE)	-	3	4	-	-
Sorbus aucuparia (Sau)	7	2	2	-	-
Sorbus aucuparia 'Asplenifolia' (SaA)	-	12	3	-	-
Tilia cordata (Tc)	-	6	6	-	-

All trees to have clear stems to 1.8m above ground level and 2.0m above ground level for extra heavy standard with well developed branching heads with a single, central leader and healthy, fibrous root systems. Multi stemmed specimens shall be at the specified height. Trees shall be root balled or container grown dependant on the time of planting and fitted with an irrigation tube with cap. Trees shall be planted into pits of an appropriate size to accommodate the root system without restriction, backfilled with a 3:1 topsoil:compost mix and shall be secured to a machine rounded stake using 1 no. tree tie with rubber spacer. Finished height of stake shall not exceed 1/3 height of staked tree above ground. Foundation design of new buildings shall accommodate proposed tree planting in accordance with NHBC guidelines.

ORNAMENTAL PLANTING SCHEDULE

ORNAMENTAL PLANTING SCHEDULE				
Herbaceous				
Nr	Name	Ht in cm	Pot(L)	Density
115	Bergenia cordifolia 'Silberlicht'		3L	6.00
180	Carex oshimensis 'Evergold'		3L	11.00
176	Festuca glauca 'Elijah Blue'		3L	9.00
53	Stachys lanata 'Silver Carpet'		3L	9.00
Shrub				
Nr	Name	Ht in cm	Pot(L)	Density
22	Choisya ternata 'Sundance'	30-40cm	3L	4.00
94	Cistus corbariensis	30-40cm	3L	5.00
50	Cytisus praecox 'Albus'	40-60cm	3L	4.00
14	Escallonia 'Edimensis'	50-60cm	3L	4.00
39	Euonymus fortunei 'Emerald Gaiety'	20-30cm(D)	3L	6.00
102	Hebe 'Oratia Beauty'	30-40cm	3L	4.00
254	Lavandula angustifolia 'Munstead'	25-30cm	3L	6.00
45	Lonicera nitida 'Baggesen's Gold'	30-40cm	3L	4.00
100	Lonicera nitida 'Lemon Beauty'	30-40cm	3L	5.00
52	Prunus laurocerasus 'Zabeliana'	50-60cm	3L	4.00
45	Santolina chamaecyparissus 'Nana'	25-30cm	3L	6.00
104	Skimmia japonica 'Rubella'	30-40cm	3L	4.00
92	Spiraea japonica 'Goldflame'	30-40cm	3L	4.00
7	Weigela florida 'Folius Purpureis'	30-40cm	3L	4.00

All shrub material shall be first quality, sturdy, well rooted non-refrigerated stock with well branched heads and fibrous root systems. Shrubs shall be planted into 450mm good quality fibrous topsoil incorporating organic compost and slow release fertiliser in accordance with all good horticultural practice.

All plant material shall be a minimum of 3L pot size unless otherwise specified and conform to BS3936 Part 1 and BS 4428. Finished beds shall be lightly forked over and dressed with 50mm coarse forest bark mulch.

GRASS SEEDING

LOW MAINTENANCE GRASS MIX

100mm depth of topsoil complying with BS3882 to be spread to area.

Pre-seed fertiliser to be applied at 50g/m². Soil to be cultivated using a disc harrow or rotovator, to 50mm depth then further cultivated and rolled to produce a firm seed bed.

Low maintenance grass seed mix such as Germinal Seeds A22 mix to be sown at 35g/m².

WILDFLOWER MIX

Subsoil to be cultivated using a disc harrow or rotovator, to 30mm depth then further cultivated and rolled to produce a firm seed bed.

An 80% grasses:20% wildflower seed mix to be sown. Eg: Emorsgates EM2 at 5g/square metre.

Rev.A: Play areas updated to reference Miracle spec (SF)

April 2024

<p>Westleigh Hall Wakefield Road Denby Dale Huddersfield HD8 8QJ telephone 01484 861611 fax 01484 861616 isdn 01484 866900 email info@fdlandscape.co.uk www.fdlandscape.co.uk</p>	/client Barratt Homes (Yorkshire East) Ltd
	/project Residential Development INGS LANE, BROUGH SOUTH PHASE 4
/drawing title POS DETAILS	/scale 1:500/200 @A0
/date Dec 23	/drwn by SF
/drawing no R/1970/22A	

Development layouts and landscaping are not intended to form part of any contract or warranty unless specifically incorporated in writing into the contract. Images and development layouts are for illustrative purposes and should be used for general guidance only. Development layouts including parking arrangements, social/affordable housing, commercial buildings/space, retail buildings/space, play areas and public open spaces may change to reflect changes in planning permission and are not intended to form part of any contract or warranty unless specifically incorporated in writing. Please speak to your solicitor to whom full details of any planning consents including layout plans will be available.

WARNING TO HOUSE-PURCHASERS
Property Misdescriptions Act 1991
Images and site layout are intended for illustrative purposes only and should be treated as general guidance only.
Site layout including parking arrangements, (social/ affordable housing, community buildings, play areas and public open spaces) may change to reflect changes in the planning permission for the development. Please speak to your solicitor to whom full details of any planning consents including layout plans will be available.
Site layouts and landscaping are not intended to form part of any contract or warranty unless specifically incorporated in writing into the contract.
DO NOT SCALE. IF IN DOUBT ASK.