

LOCATION PLAN
SCALE: 1:1250

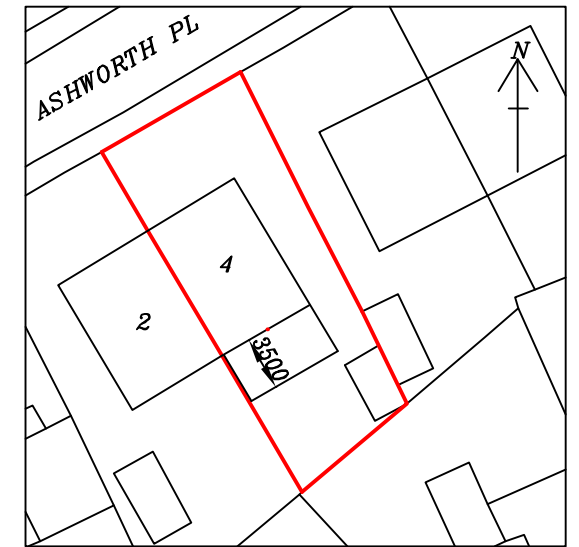

SITE PLAN
SCALE: 1:500

*PROPOSED 1-STOREY REAR
EXTENSION AT 4 ASHWORTH
PLACE, BRADFORD, BD6 1AJ,
FOR MS J. HADWIN*

SCALE: 1:100(A3) | DATE: MAR 2024 | DRAWN BY: ZESHAN KHAWAJA

PLANNING/BUILD REGS | DRAWING NUMBER: 24/3087/JH4

Khawaja
PLANNING SERVICES
TEL: 01274 618780 | MOB: 07956 184960