

1. Existing field access to be utilised as site entrance.



2. Facing southwest on A863 adjacent to site access.



3. Facing northeast on A863 adjacent to site access.

Date	Description	Rev	By
29.03.24	Add data from topo survey	A	XD

Revision Description

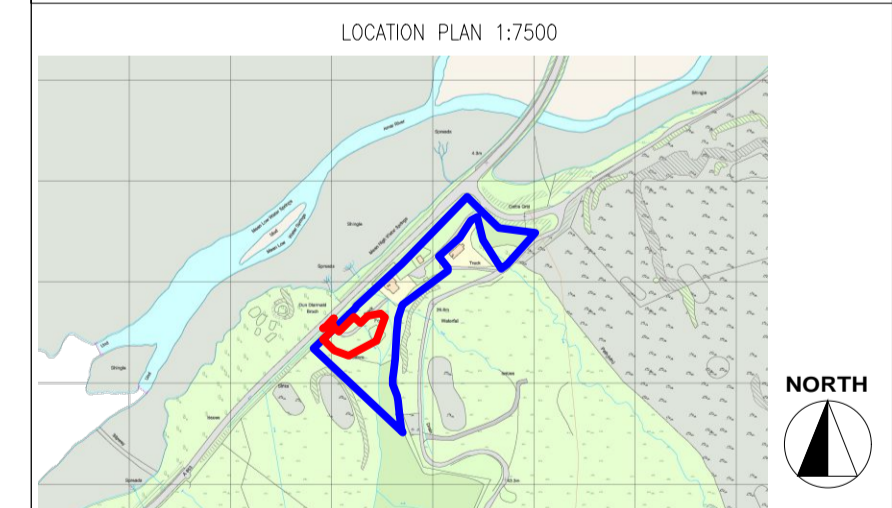

Project:
 Proposed Glamping Site - For Keith Mabbott
 2 Coillire, Struan, Isle of Skye
 IV56 8FX

Drawing Title:
 ROAD AND ACCESS PLAN

Drawing Number:
231221-01-06

Revision: A
Date: 16.01.2024
Scale: 1:100 @ A1
Drawn By: XD
CAD Dwg File: -
Checked By: -

Issue Status:
Full Planning Application

