









KEY TO SYMBOLS

-  GLAMPING POD WITH DECKING
-  EXISTING FENCE
-  NEW FENCE
-  EXISTING TREE
-  NEW NATIVE SHRUBBERY - INDICATIVE
-  NEW PERMEABLE FOOTPATH
-  NEW PERMEABLE BUILD-UP
-  NEW TARMAC
-  EXISTING TARMAC

KEY

1. Public road (A863)
2. Existing site access - to be improved
3. Existing track - to be improved
4. Refuse & recycling storage
5. Shared parking for P1 & P2
6. Parking for P3
7. Hammerhead turning point
8. Turning area - no parking
9. Utility / storage shed w. secure bicycle storage
10. Barrel sauna

 OWNERSHIP BOUNDARY  
 AREA = 1.1 ha.

 SITE BOUNDARY  
 SITE AREA = 1,470 m<sup>2</sup>

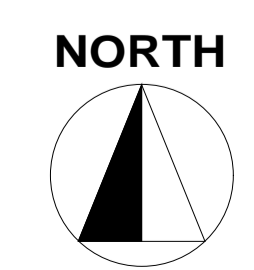
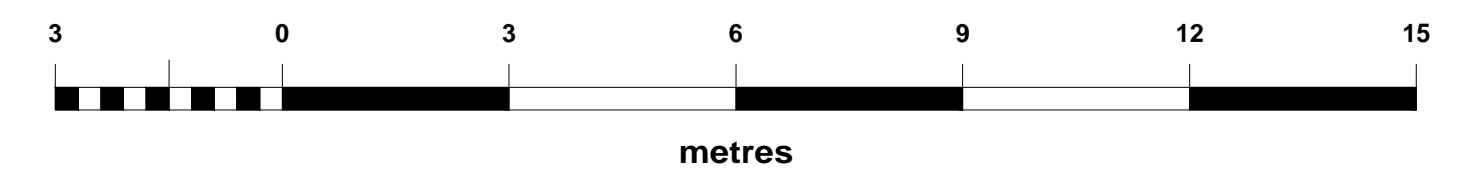

Date	Description	Rev	By

Revision Description

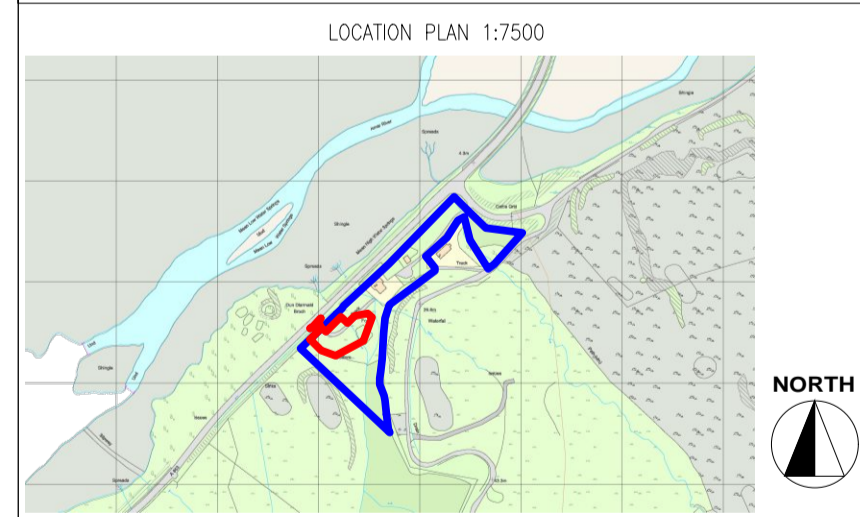

Project:  
**Proposed Glamping Site - For Keith Mabbott**  
 2 Coillire, Struan, Isle of Skye  
 IV56 8FX

Drawing Title:  
**PROPOSED LAYOUT PLAN**

Drawing Number:  
**231221-01-02**

Revision: -  
 Date: 16.01.2024  
 Scale: 1:100 @ A1  
 Drawn By: XD  
 CAD Dwg File: -  
 Checked By: -

Issue Status:  
**Full Planning Application**