

KEY

1. Public road (A863)
2. Exiting site access
 - To be improved with tarmac for 5 metres from public road edge.
 - Existing gate is positioned 7.5 metres back from road edge to allow vehicles to fully pull off public road when opening/closing gate.
 - Existing surface water drainage course retained.
3. Existing track
 - to be improved with additional permeable build-up where required.
4. Refuse & recycling storage
5. Shared parking for P1 & P2

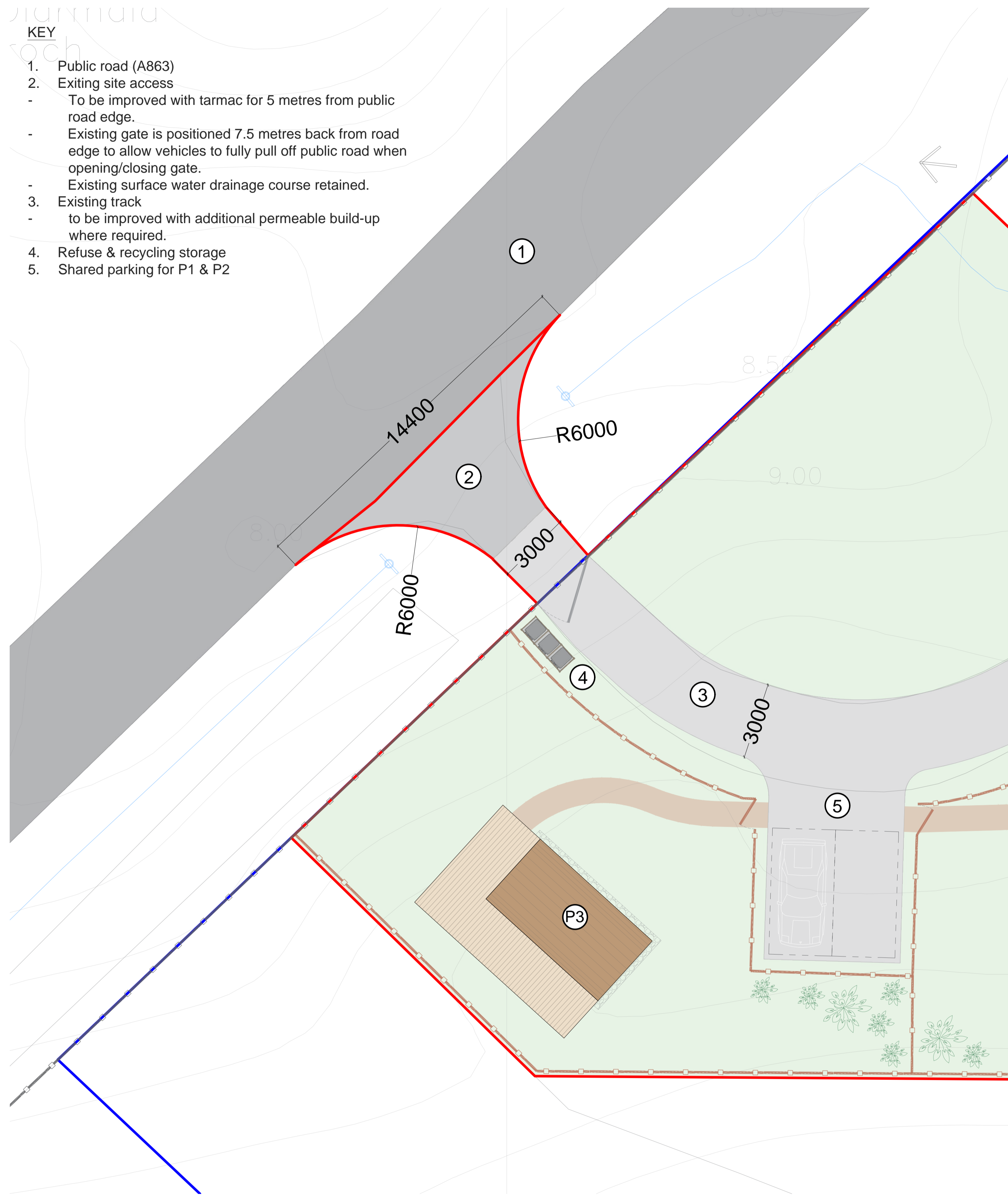

OWNERSHIP BOUNDARY
AREA = 1.1 ha.

SITE BOUNDARY
SITE AREA = 1,470 m²

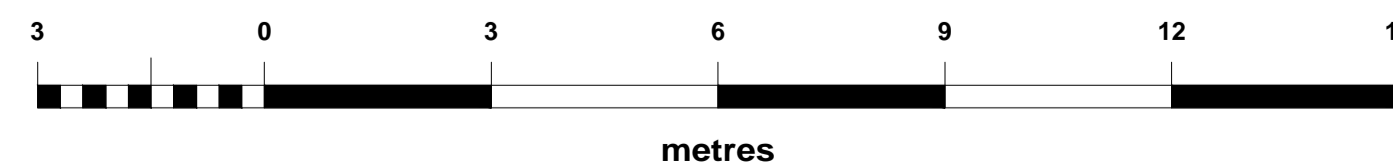

W: WWW.GLAMPITECT.CO.UK
E: CONTACT@GLAMPITECT.CO.UK
T: 0131 202 9002

KEY TO SYMBOLS

- NEW PERMEABLE BUILD-UP
- NEW TARMAC
- EXISTING TARMAC



1. Existing field access to be utilised as site entrance.



2. Facing southwest on A863 adjacent to site access.



3. Facing northeast on A863 adjacent to site access.

Date	Description	Rev	By

Revision Description

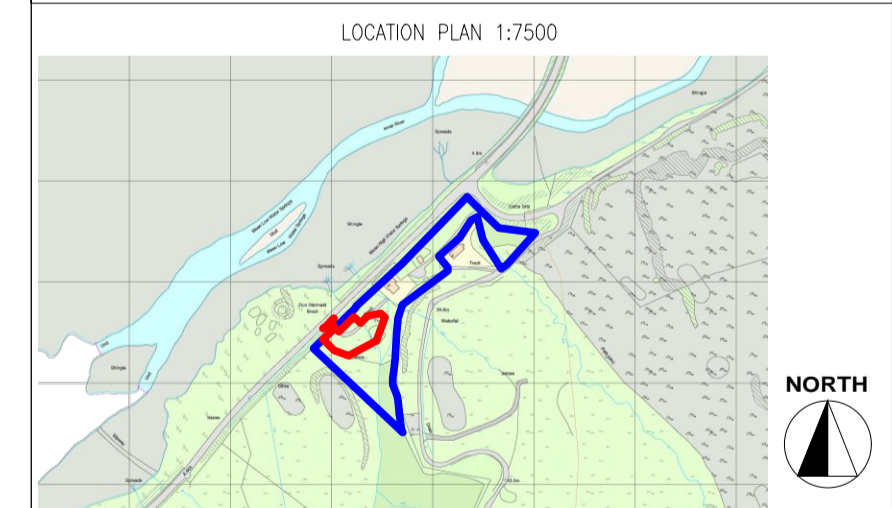

Project:
Proposed Glamping Site - For Keith Mabbott
2 Coillire, Struan, Isle of Skye
IV56 8FX

Drawing Title:
ROAD AND ACCESS PLAN

Drawing Number:
231221-01-06

Revision: -
Date: 16.01.2024
Scale: 1:100 @ A1
Drawn By: XD
CAD Dwg File: -
Checked By: -

Issue Status:
Full Planning Application

