

# 13 COSBY ROAD, LEICESTER.

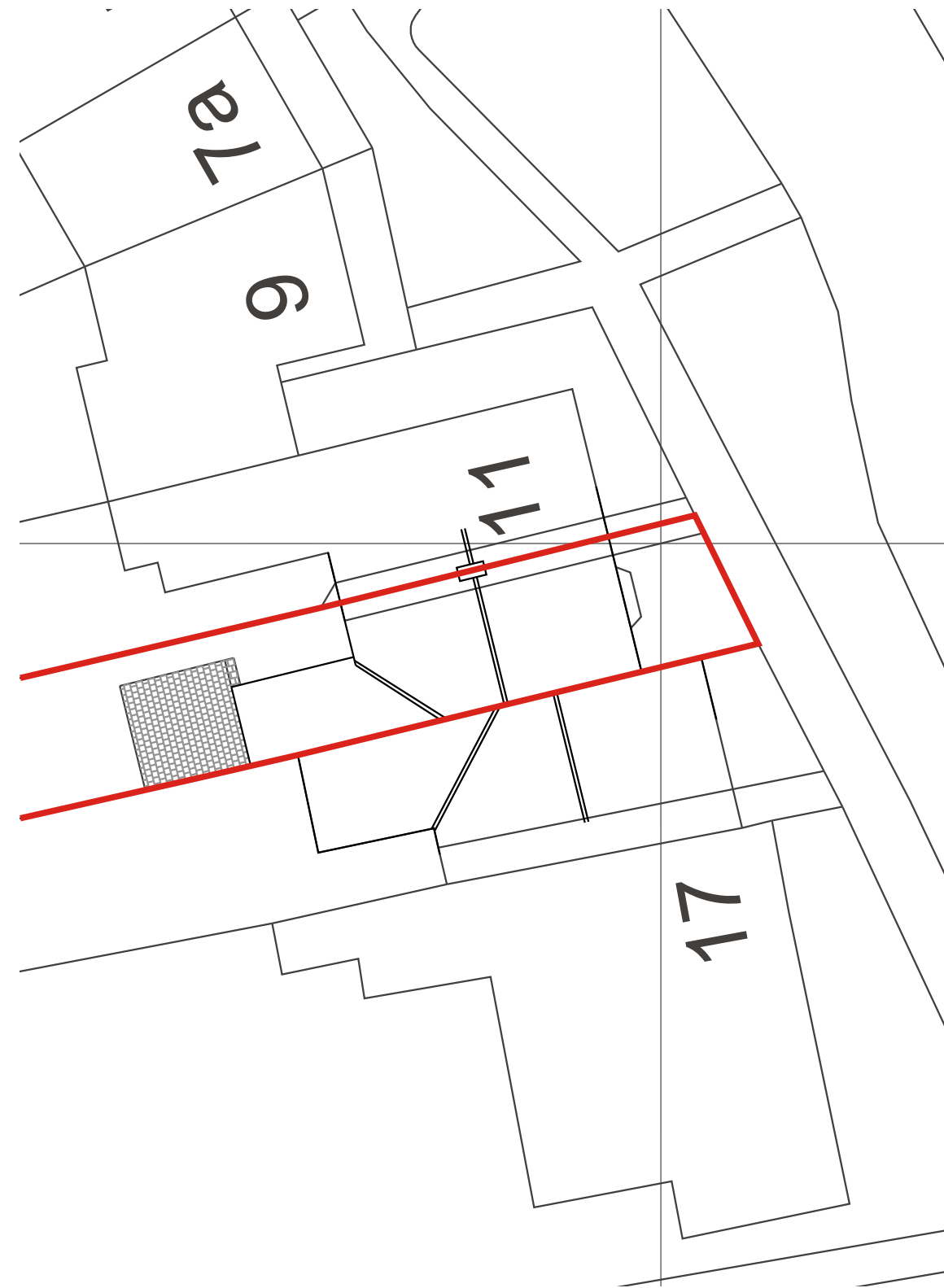

PROPOSED SITE PLAN  
scale 1:200

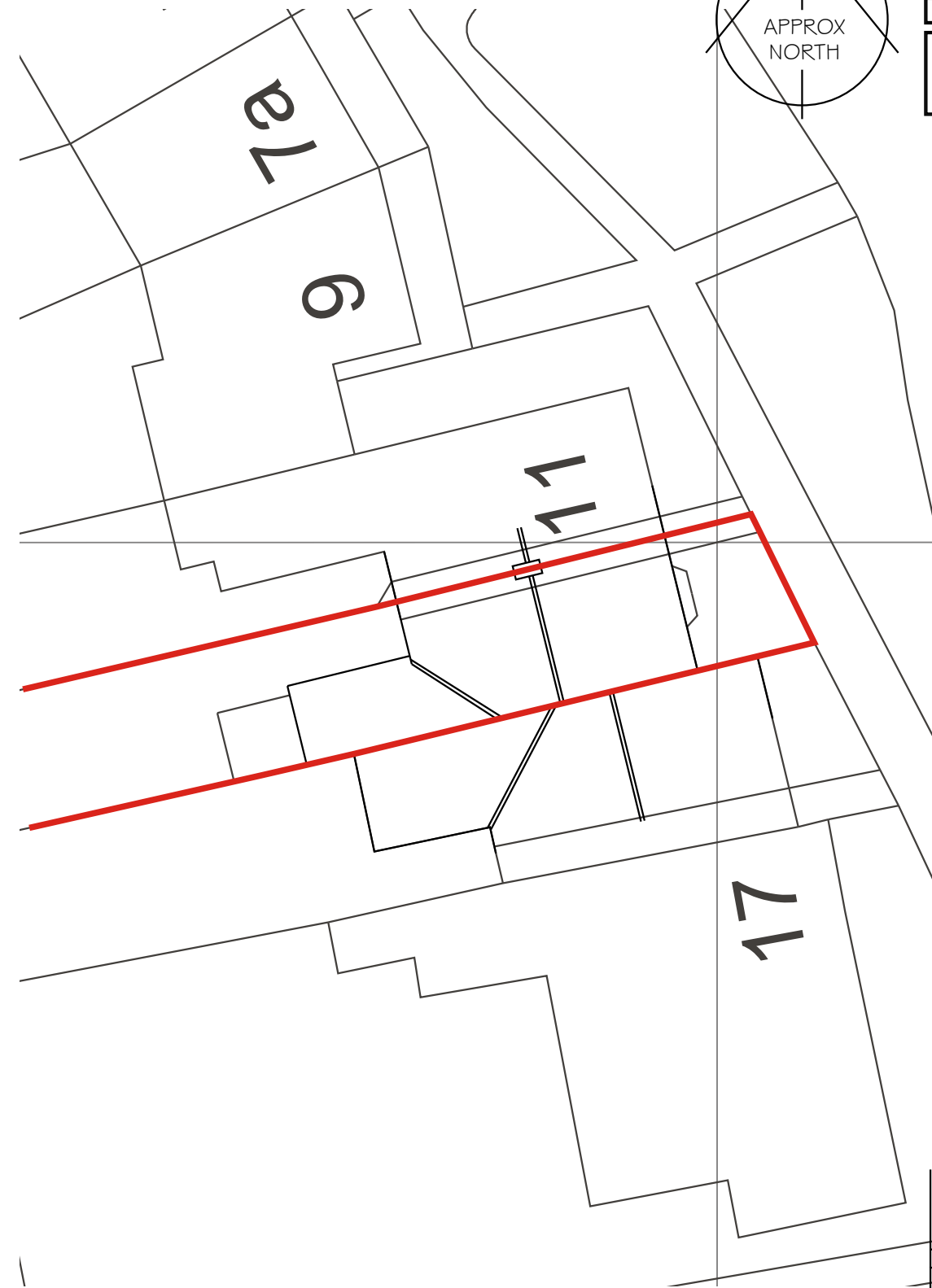

EXISTING SITE PLAN  
scale 1:200

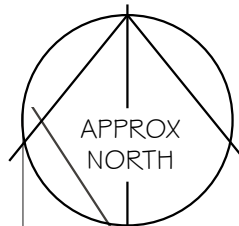

It is the responsibility of the client to advise of matters relating to land title, restrictive covenants, wayleaves or positions of public drains in relation to the site. Site boundaries are taken as visible fence lines unless advertised otherwise

Drawings may be scaled for planning purposes only.

All existing and proposal drawings are based on measured surveys. Site drawings are based on ordnance survey plans. Halford Jones Architecture cannot guarantee the accuracy of drawings that have been imported from other agencies, eg Ordnance Survey.



**PRELIMINARY ~ SITE PLANS**

Revision:	Amendment Description:	Initials:	Date:
xxx	xxxxxxxx	xxx	xxxx



<b>Client Address:</b>		<b>Project Address:</b>	
		Ms Nadine Hill 13 Cosby Road Littlethorpe Leicester LE19 2HG	
<b>Project No:</b> 240306	<b>Drawn By:</b> [ ]		
<b>Drawing No:</b> AD02	<b>Revision:</b> /		
<b>Date:</b> 08 04 24	<b>Scale:</b> 1:200		
<b>Drawing Title:</b> Site Plans		<b>Checked By:</b> [ ]	
<b>Issue Type:</b> PRELIMINARY			
Registered Office: Halford Jones Architecture Ltd, 34 Park Hill Drive, Aylestone, Leicester, LE2 8HR. (Company Number: 10312655) Tel: 0116 2832578 Mob: 07508 807002 Email: office@halfordjones.com Website: www.halfordjones.com			
NO DIMENSIONS ARE TO BE SCALED FROM THIS DRAWING. ALL DISCREPANCIES WITH THE DETAILS TO BE REPORTED AND CLARIFIED PRIOR TO COMMENCING WORKS ON SITE. IF IN DOUBT - ASK. THIS DRAWING IS COPYRIGHT.			

