

notes:  
 Copyright in this drawing remains the property of Coach Haus Architecture Limited.  
 Do not scale from this drawing for construction. Work to figured dimensions only. All figured dimensions are to be checked on-site.  
 Any discrepancies are to be reported to Coach Haus Architecture Limited prior to commencing work.  
 Contractors shall include for all works described / indicated on the drawings or can be reasonably inferred in pursuit of the proper execution of the works.  
 Structural elements shown are preliminary only, refer to specialist consultant drawings and details.  
 This drawing shall be used only for the purposes intended.

material specification

-

revision ref. / notes	date
/- First Issue	01.03.2024

PLANNING

**COACHHAUS**  
 ARCHITECTURE  
 www.coach-haus.co.uk  
 Chy-an-Hobi | Newmill | Penzance | Cornwall | TR20 8XW |  
 E. design@coach-haus.co.uk W. www.coach-haus.co.uk

client: Ms. R. Robinson		
project: Loft conversion, rear extension and alterations at 3 Polgoon Close, Tredarvah, Penzance, TR18 4JZ.		
drawing: Ground Floor Plan + Section - Existing		
drawn by: MC	check by: XX	
scale: 1:100	date: 03/2024	paper size: A3
job number: 32162	drawing number: PL002	rev: /

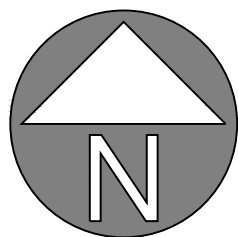

ground floor plan - existing

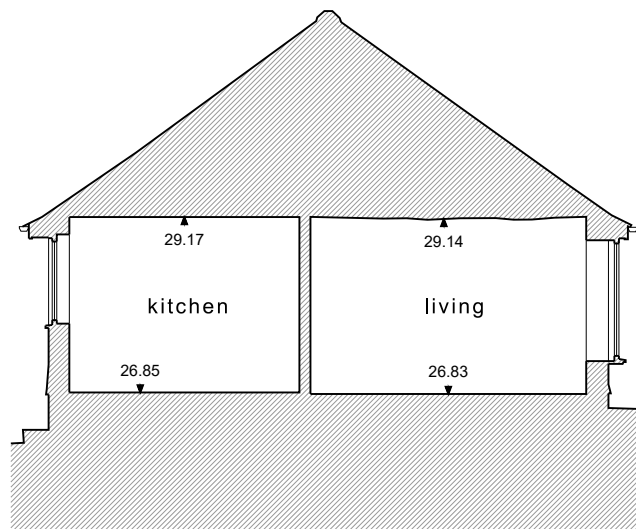

section a:a - existing