

This line should measure 80mm when printed correctly  
 This drawing is the copyright of Roberts Limbrick Ltd and should not be reproduced in whole or in part or used in any manner whatsoever without their written permission.  
 Responsibility is not accepted for errors made by others in scaling from this drawing. Use only figured dimensions and report any discrepancies or omissions to the Architect immediately.

Rev	Date	By	Chk	Description
P01	14.03.24	CJF	AWR	First Issue
A	15.03.24	CJF	AWR	First Issue
B	08.04.24	CJF	AWR	First Issue

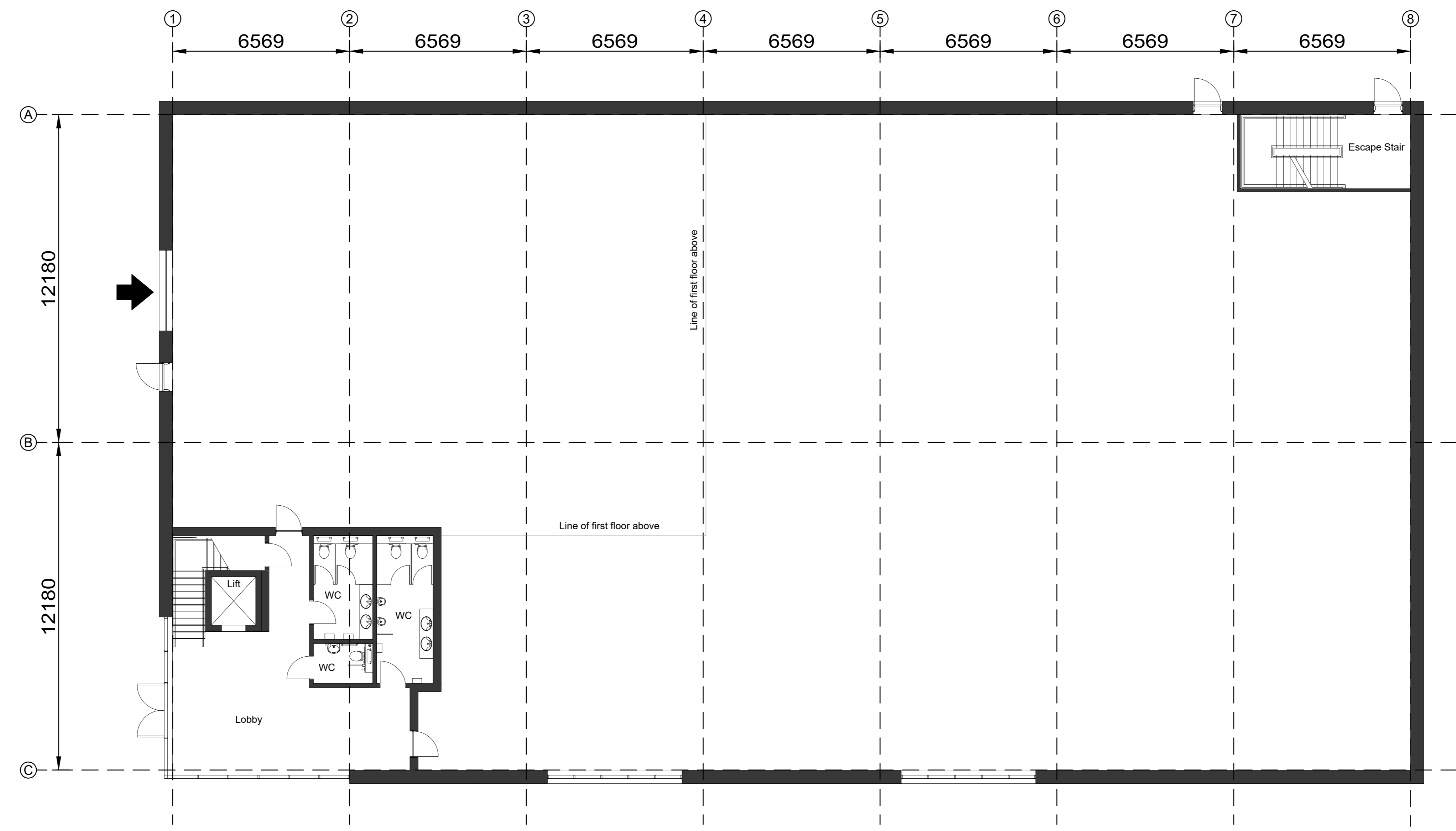

Ground Floor Plan  
 GF GIFA - 1,120sqm/12,055sqft  
 GF GEFA - 1,191sqm/ 12,820sqft

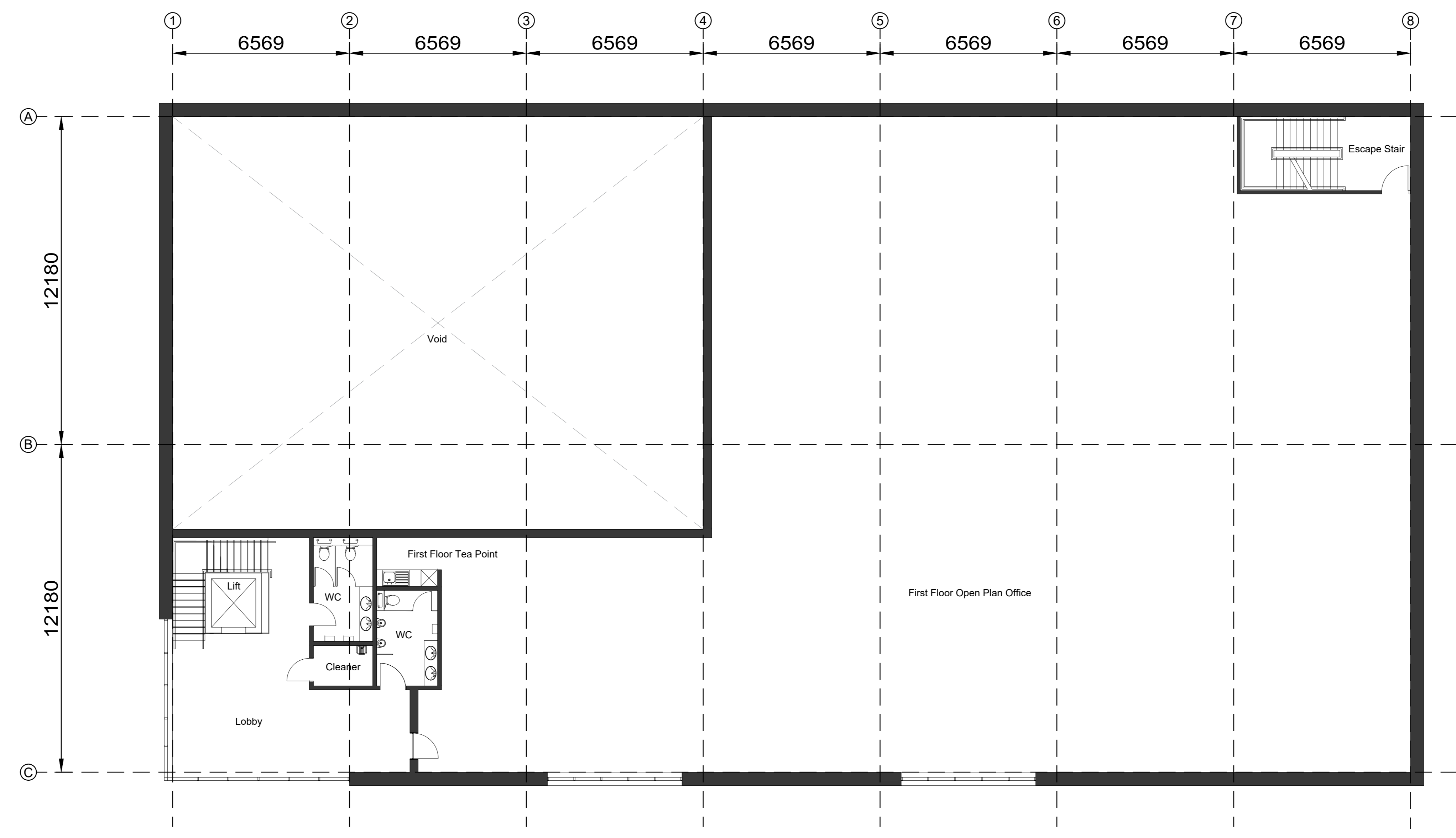
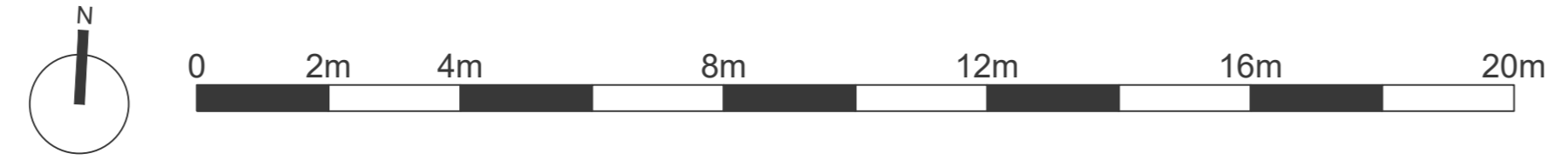

First Floor Plan  
 FF GIFA - 800sqm / 8,611sqft  
 FF GEFA - 871sqm / 9,375sqft

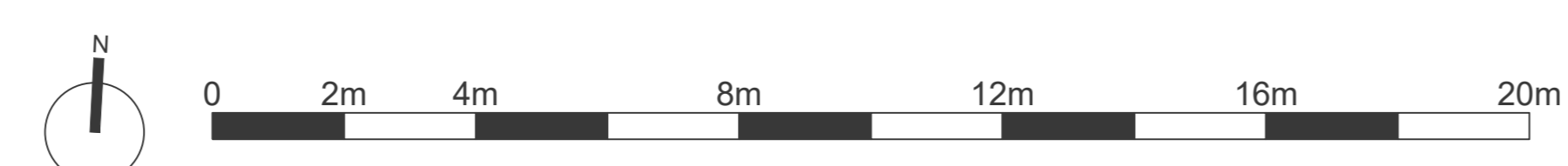

**Roberts Limbrick**  
 03333 405 500  
 mail@robertslimbrick.com  
 robertslimbrick.com  
Registered Office: England No. 06658209  
**Project Name**  
 Former Fuel Depot  
 Chichester

**Client Name**  
 Seaward (Bognor Road) Limited

**Drawing Title**  
 Proposed Floor Plans

**Scale** 1/100 • A0  
**Project No.** 7702-6

**Status** S0  
**Purpose Of Issue** Work In Progress

Project 7702-6 • Org RLA • Vol XX • Level ZZ • Form DR • Date A

**Number** S2100  
**Revision** B