

This line should measure 80mm when printed correctly
 This drawing is the copyright of Roberts Limbrick Ltd and should not be reproduced in whole or in part or used in any manner whatsoever without their written permission.
 Responsibility is not accepted for errors made by others in scaling from this drawing. Use only figured dimensions and report any discrepancies or omissions to the Architect immediately.

Rev	Date	By	Chk	Description
P01	08.02.24	LM	CF	First Issue
A	08.03.24	LM	CF	Revised to suit client comments
B	08.04.24	LM	CF	Revised to suit client comments

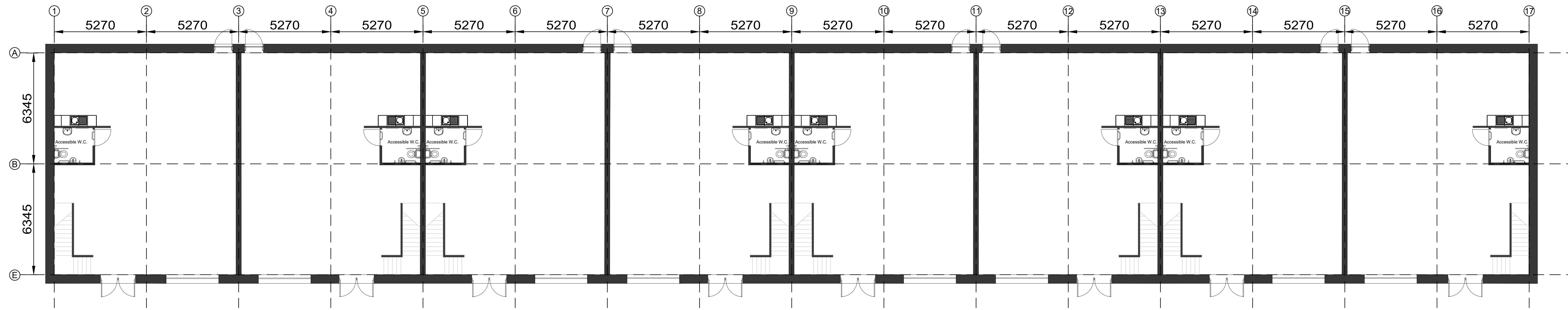

Ground Floor Plan

GF GIFA - 1,072sqm/11,528sqft

GF GEFA - 1,169sqm/12,583sqft

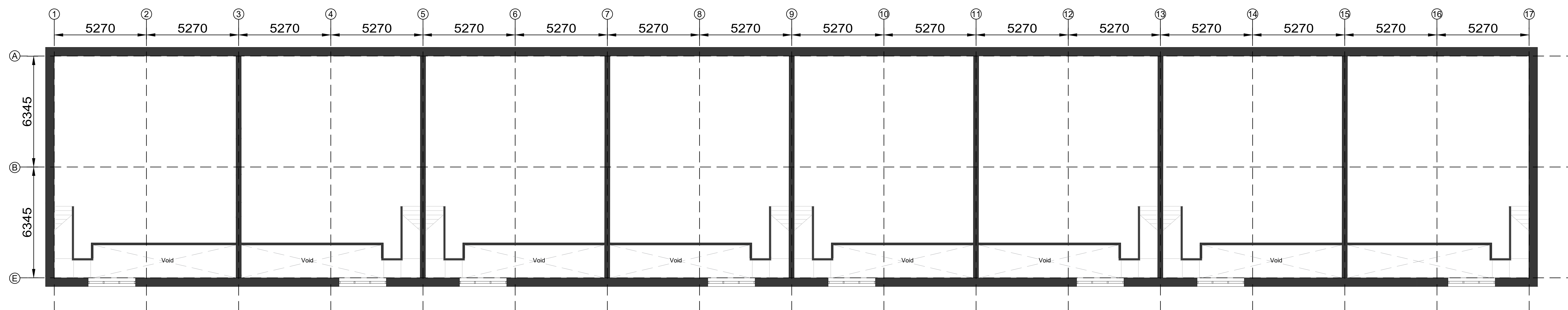
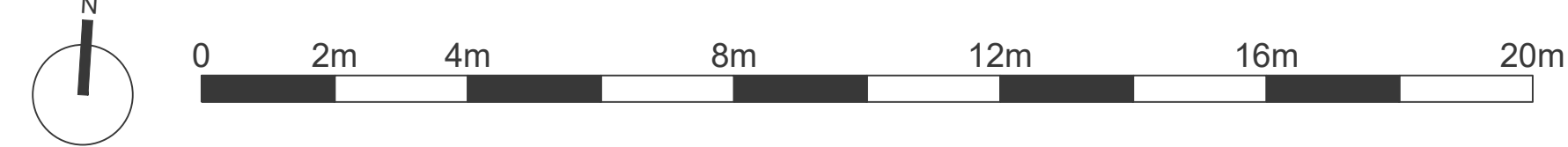

First Floor Plan

FF GIFA - 848sqm/9,128sqft

FF GEFA - 983sqm/10,581sqft

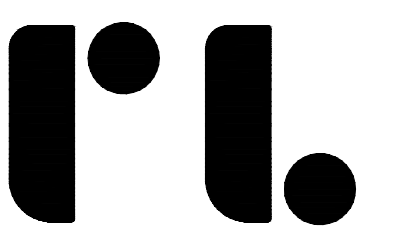

Roberts Limbrick

03333 405 500
 mail@robertsylimbrick.com
 robertsylimbrick.com

Registered Office: England No. 06658029

Project Name

Former Fuel Depot
 Chichester

Client Name

Seaward (Bognor Road) Limited

Drawing Title

Proposed Floor Plans

Scale **Project No.**

1/100 • A0 7702-4

Status **Purpose Of Issue**

S0 Work In Progress

Project Org Vol Level Form Rule

7702-4 • RLA • XX • ZZ • DR • A

Number **Revision**

S2100 **B**