

No operations are to commence on site until it has been ascertained (beyond reasonable doubt) that there are no Asbestos Containing Materials (ACM's) or any other hazardous material / substances within the area of the "site" that will be affected by this work.

Reference must be made in the first instance to the Asbestos Risk Register (Management Survey) prior to starting operations on site.

Where applicable, a separate Refurbishment / Demolition survey has been undertaken and issued to the Principal Contractor identifying the location of any known ACM. Where appropriate, a separate programme of works to control / remove any ACM's by the Construction Compliance Team will also be issued.

Should a suspect material be discovered or exposed during the course of the works, all operations within the relevant area are to cease immediately and further instruction obtained from the project Contract Administrator.

Where Asbestos Containing Materials or presumed Asbestos Containing Materials have been damaged (either previously or during the course of these works), then **Fire Council Corporate Health & Safety (Emergency) Procedure OHS-C-17 "Managing Asbestos-related Emergencies"** must be implemented.

Following any Asbestos related incident, construction works must **not** recommence until the **Construction Compliance Team** have given approval in writing to do so.

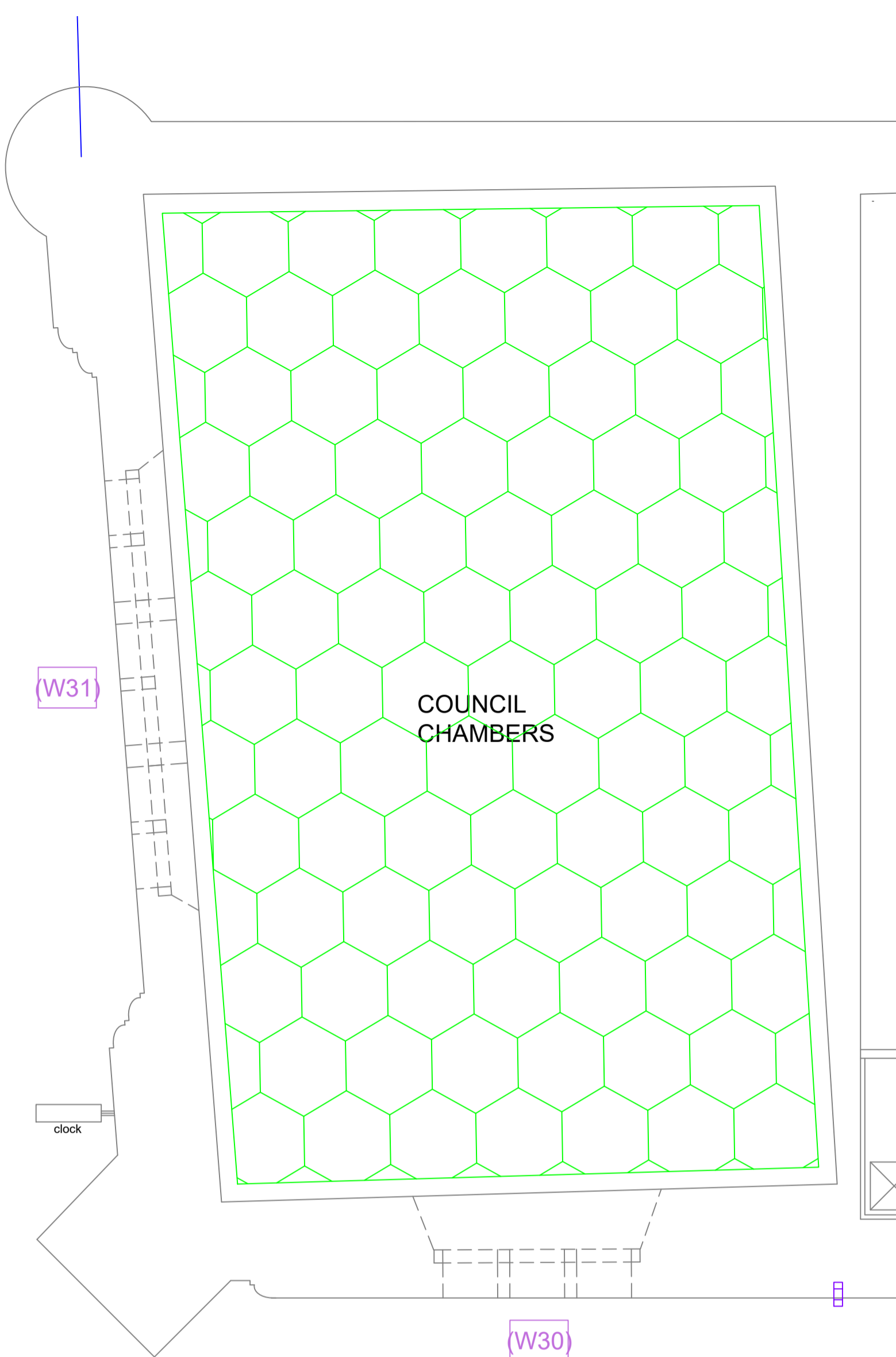

COUNCIL CHAMBERS CEILING PLAN - AS PROPOSED
1 : 50

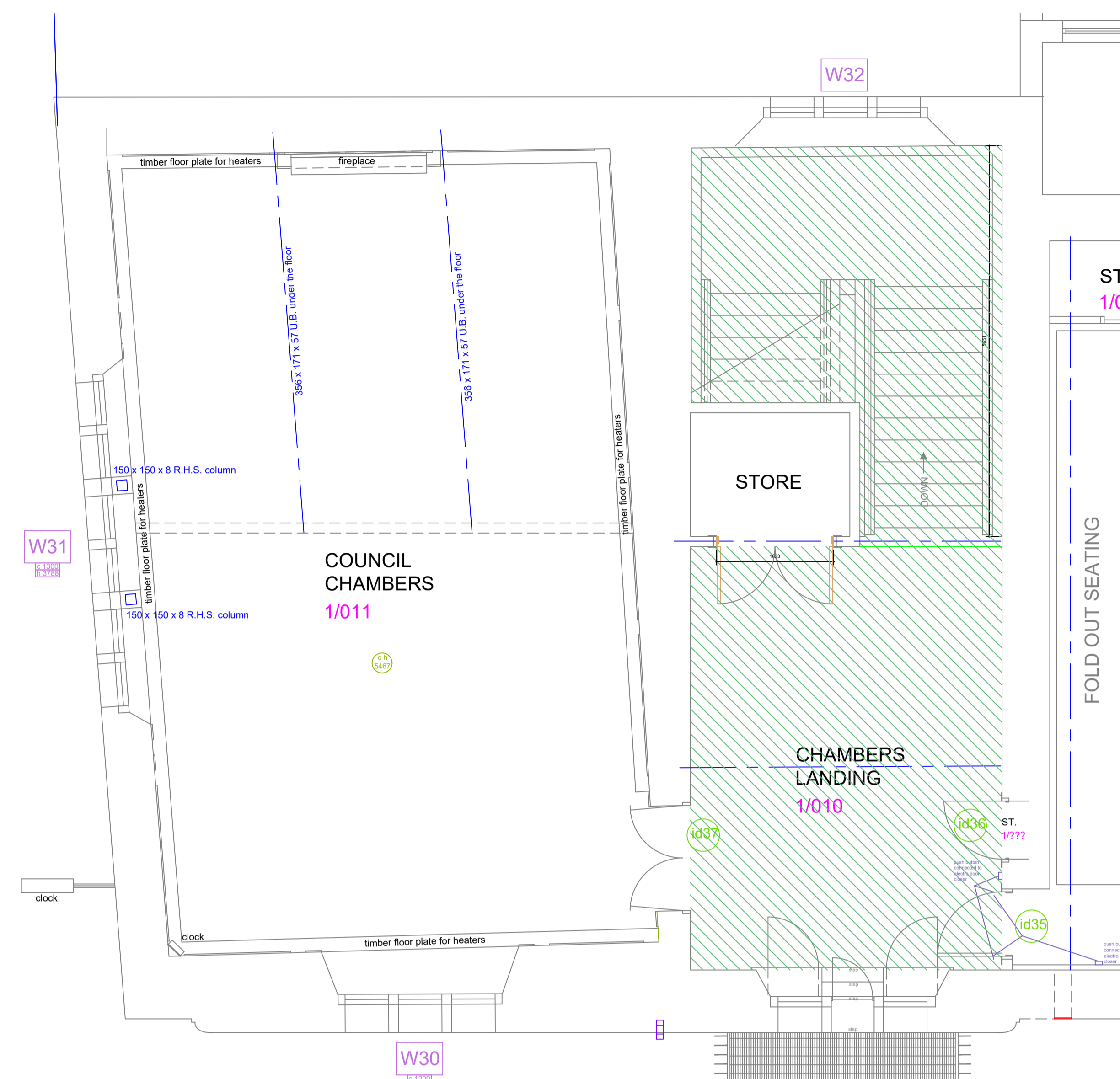

COUNCIL CHAMBERS PLAN - AS PROPOSED
1 : 50

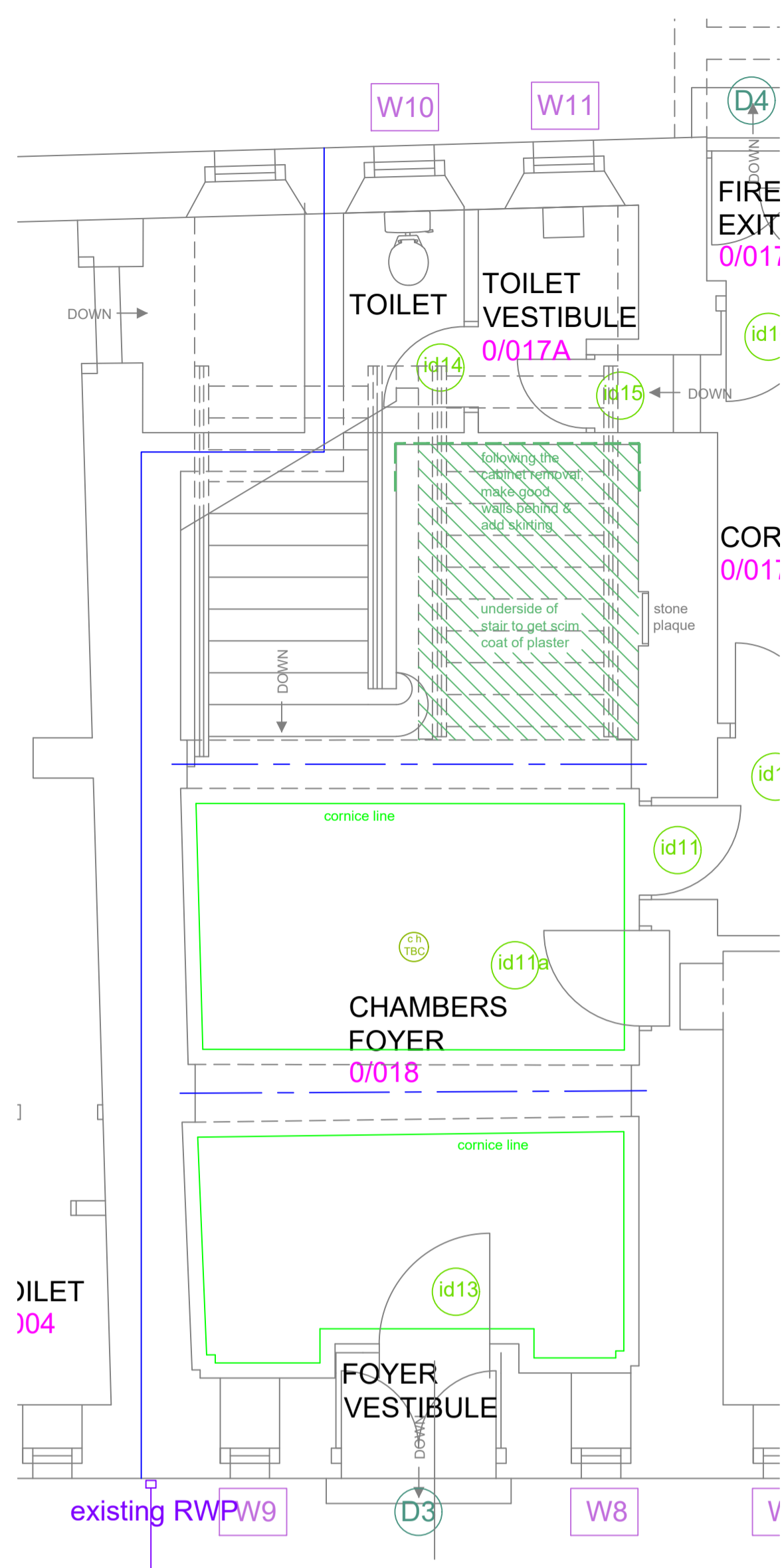

CHAMBERS FOYER PLAN - AS PROPOSED
1 : 50

Rev	Date	Description	By
A	Apr. '24	Drawing title and number corrected. Plans titles changed to Proposed	P.M.

REVISIONS



ASSET and FACILITIES MANAGEMENT SERVICE: PROPERTY SERVICES

Property Services Manager: **ALAN PAUL**
Bankhead Central, 1 Bankhead Park, Glenrothes, Fife, KY7 6GH
Tel: (01592) - 653238 E-mail: Property.Clientgroup1@fife.gov.uk

Drawing Status:

PLANNING

Contract Administrator:
PAULINE MARTIN

Drawn By: Date: Scale: Checked By:
P.M. OCT. 23 1 : 50 / 10

Property Address:
**ST ANDREWS TOWN HALL
QUEENS GARDENS, ST ANDREWS**

Project Title:
COUNCIL CHAMBERS WORKS

Drawing Title:
DECORATION

Computer Reference:

Works Request Number: IPRN:
CS7602318 00041300

Drawing Number: Revision:
15 A

- DECORATION**
- WALLS**
All woodchip and other wallpapers to be stripped.
- All new and previously painted lime plastered walls, ceiling, moldings are to be cleaned and prepared for painting. To seal the new plaster, apply a thinned mist coat of water based matt emulsion. Walls to finished with Timonox fire retardant paints applied as per the manufacturers recommendations:
- Coats
- 1 Spot Prime Crown Trade Timonox Bonding Primer
 - 1 Basecoat Crown Trade Timonox Upgrade Basecoat
 - 1 Finish Crown Trade Timonox Scrubbable Matt
 - 1 Finish Crown Trade Timonox Scrubbable Matt
- COLOURS:**
Walls - main Light cream (ref TBC)
Walls - panels Dark Cream (ref TBC)
Moldings WHITE
- CEILINGS**
All new and previously painted lime plastered walls, ceiling, moldings are to be cleaned and prepared for painting. To seal the new plaster, apply a thinned mist coat of water based matt emulsion. Ceilings to finished with Timonox fire retardant paints applied as per the manufacturers recommendations:
- Coats
- 1 Spot prime Crown Trade Timonox Bonding Primer
 - 1 Bring forward Crown Trade Timonox Vinyl Matt
 - 1 Finish Crown Trade Timonox Vinyl Matt
 - 1 Finish Crown Trade Timonox Vinyl Matt
- COLOUR: WHITE**
NOTE: Chambers 1/011 light blue ceiling background is to be changed to white
NOTE: The dark blue backed ceiling background in Chambers 1/011, and the embossed detailing are to be carefully cleaned. CA to be advised if there are any areas that need to be repainted.
- TIMBER - PAINT** (Window frames, ingoes, cills, new door leafs, door frames, skirtings, Chambers floors battens)
All new and previously painted timbers are to be cleaned and prepared for painting. Timbers to finished with Timonox fire retardant paints applied as per the manufacturers recommendations:
- Coats
- 1 Spot Prime Crown Trade Fastflow Quick Dry Primer Undercoat
 - 1 Bring forward Crown Trade Fastflow Quick Dry Primer Undercoat
 - 1 Undercoat Crown Trade Fastflow Quick Dry Primer Undercoat
 - 1 Finish Crown Trade Fastflow Quick Dry Gloss
 - 1 Finish Crown Trade Fastflow Quick Dry Gloss
- COLOURS:**
Window frames, ingoes, cills, new doors leafs, door frames, skirtings
WHITE
Chambers floor battens BLACK
- TIMBER - VARNISH 1** (Chambers doors, stair, balustrade, Foyer Entrance door)
All new and previously varnished timbers are to be cleaned and prepared for varnishing. Timbers to finished with Sadolin varnish applied as per the manufacturers recommendations:
- Coats
- 1 Spot Prime Sadolin PV67 Heavy duty varnish
 - 1 Bring forward Sadolin PV67 Heavy duty varnish
 - 1 Finish Sadolin PV67 Heavy duty varnish
 - 1 Finish Sadolin PV67 Heavy duty varnish
 - 1 Finish Sadolin PV67 Heavy duty varnish
- TIMBER - VARNISH 2** (Chambers Foyer floor)
All new and previously varnished timbers are to be cleaned and prepared for varnishing. Timbers to finished with Sadolin varnish applied as per the manufacturers recommendations:
- Coats
- 1 Spot Prime Sadolin polyurethane extra durable floor varnish
 - 1 Bring forward Sadolin polyurethane extra durable floor varnish
 - 1 Finish Sadolin polyurethane extra durable floor varnish
 - 1 Finish Sadolin polyurethane extra durable floor varnish
 - 1 Finish Sadolin polyurethane extra durable floor varnish

CARPET (Council Chambers, Chambers landing ad stair)
NOTE: Existing blue carpet is to be carefully removed from the underlay below and set aside for refitting. There are some areas where the underlay has been glued to the carpet which is to be removed to allow for new underlay.
IF, the underlay cannot be removed from the back of the carpet allowing it to be relayed flat and smooth, order new carpet as follows:
Ege Uni wall-to-wall carpet laid in accordance, over new underlay, with the manufacturer's recommendations
COLOUR: 5520 BC10 BLUE
Allow for new brass colours threshold carpet strips where req.

INTERNAL CEILING PANEL COLOUR CHANGED TO WHITE

INTERNAL PANEL COLOUR MAIN WALL COLOUR

MAIN WALL COLOUR

INTERNAL PANEL COLOUR

