

- Lighting Notes**
- The contractor shall examine the drawings and visit site before the works commence to ascertain all local conditions/restrictions likely to affect the execution of the works. No claims arising from failure to do so will be considered.
 - This drawing is to be read in conjunction with all accompanying M&E services drawings, specifications, and schedules.
 - The lighting installation shall be installed in accordance with BS 5271 IET wiring regulations and applicable British standards.
 - The general lighting final circuit cabling shall be installed in SF 22-220 1m and earth copper conductors installed within all round bends within the ceiling voids. Drops to outlets shall be installed direct within the building fabric wiring zones to BS 6717 wiring regulations to the respective outlet complete with RCD protection to all circuits. Surface metallic conduit to be used in BA and BP.
 - All lighting accessories shall be flush mounted PVC with the exception of switch rooms, plant rooms, risers and external which shall be of the surface metal clad type. A sample board is to be provided to obtain client and architect sign off for the respective accessories/outlets.
 - Final locations and heights of accessories and outlets are to be agreed with the architect and client prior to installation.
 - Please refer to the luminaire schedules and lighting technical submission for the proposed luminaire selection.
 - Exact luminaire cut out dimensions to be provided to the contractor to create holes to be formed within plasterboard ceilings. Additional ceiling fixing support and noggin to be provided as required, to provide the necessary support within the ceiling for the installed luminaires.
 - Where luminaires are suspended from the ceiling then the contractor are to provide the appropriate ceiling supports to enable a secure fixing to be made for the proprietary wire suspension. These suspension points shall be strategically positioned to suit the manufacturer's recommendations.
 - Any remote-control gear for luminaires shall be independently supported from the structure and shall not be laid on the back of any ceiling systems.
 - Lighting control strategy to be confirmed at next phase.
 - The emergency lighting luminaires are to be generally of the stand-alone led type, non-maintained with 3-hour duration unless noted otherwise. Testing shall be provided via test key switches incorporated into the same plate as the local lighting circuit switches and engraved 'emergency lighting test' purposes for compliance with BS5266.
 - /D denotes dimmable version of fitting.
 - /E denotes emergency version of fitting.
 - /AM denotes integral microwave sensor version of fitting.
 - Emergency escape signage to be confirmed.
 - External lights controlled via an astronomical timeclock and photocell adjacent to the distribution board.

B9 02 - Lighting
1 : 50

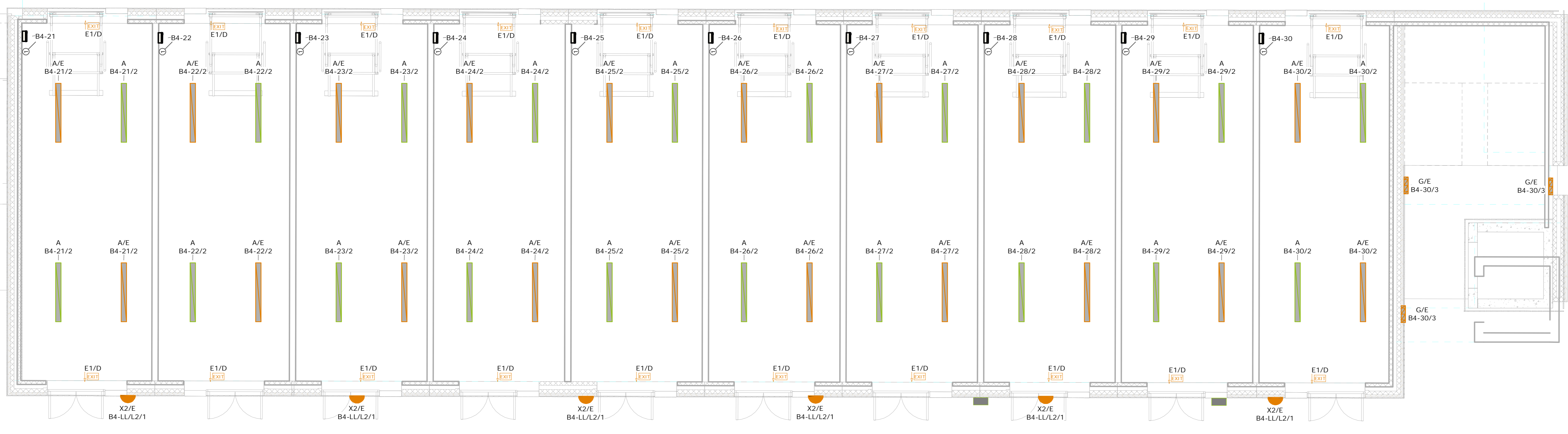

Luminaire Schedule B4					
Legend	Filter	Manufacturer	Description	Power	Image
A		Lucoo PLC	IP65 Linear Corrosion Resistant Luminaire: Climate Extra Twin, 1500mm, 6600m, 48w, fixed output driver	48W	
A/E		Lucoo PLC	IP65 Linear Corrosion Resistant Luminaire: Climate Extra Twin, 1500mm, 6600m, 48w, fixed output driver & emergency pack	48W	
E1/D		Lucoo PLC	Maintained emergency exit blade with ceiling or wall mounting (down arrow)	3W	
G/E		Lucoo PLC	3200mm, fixed output driver, Emergency output 390m	24 SW	
X2		Thorn	Wall mounted IP65 luminaire with marine grade finish 1 x TL_P1A2-B30		
X2/E		Thorn	Wall mounted IP65 luminaire with marine grade finish 1 x TL_P1A2-B30		

Lighting Controls			
Description	Manufacturer	Model	
Stand-alone Hard Wired PIR in Absence Mode	GP Electronics	EBDSPIR-PSM	
2 gang plate light switch (grey)	Schneider Electric	Ultimate Slimline GU1022GY	
3 gang 3 position centre bias refractive light switch (grey)	Schneider Electric	Ultimate Slimline GUG03GGY & 3 No. GUG200CW	
3 gang 3 position centre bias refractive light switch (grey)	Schneider Electric	Ultimate Slimline GUG03GGY & 3 No. GUG200CW	
Scene select light switch (white)	GP Electronics	Vitesse Plus Modular - VITPP1-45C-W	
Modular Controls PIR in Presence Mode (15m dia coverage)	GP Electronics	Vitesse Plus Modular - VITPP1-EBDMR	
12 output, 7 channel switching and DALI & DS1 lighting control module	GP Electronics	Vitesse Plus Modular - VITPP1-MB-DD	

B9 01 - Lighting
1 : 50



B9 00 - Lighting
1 : 50

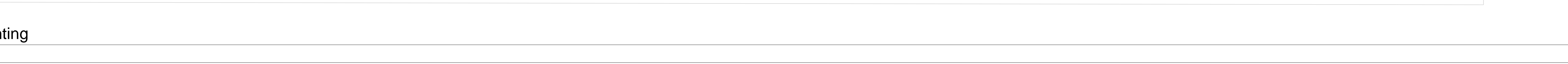

Number	Description	Date
PO4	Revised for Planning	07.11.23
PO3	SI&A 4 Issue	28.07.23
PO2	SI&A 3 Issue	03.06.23
PO1	SI&A 3 Issue	29.04.23



Project: S3 - Review & Comment



Client: Scarborough - West Pier

Drawing Title: B4 - Lighting & Emergency Lighting

BA Stage	Status
2 - Concept Design	
3 - Spatial Coordination	
4 - Technical Design	✓
5 - Manufacturing and Construction	

Rev	Designed	Checked	Scale
PO4	TP	LB	info@ridings.co.uk

© copyright © Ridings Consulting Engineers Ltd