

NEW TO EXISTING TIMBER JOINT  
TO BE SUPPLEMENTED WITH 2No.  
GALVANISED M10 BOLTS

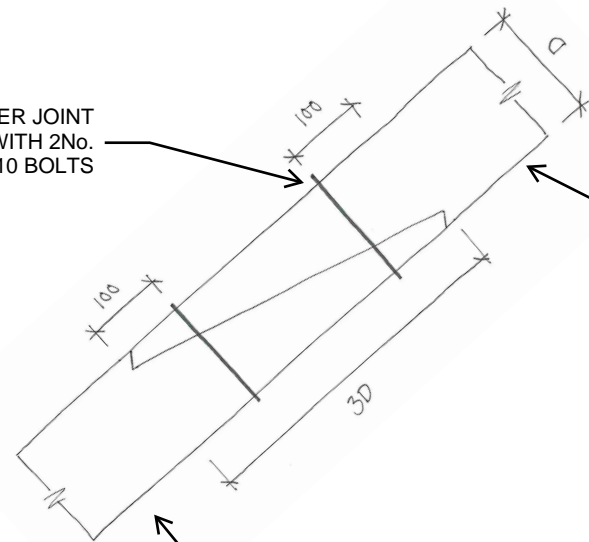

EXISTING RAFTER

DECAYED TIMBER TO BE CAREFULLY REMOVED  
AND CUT BACK MIN. 100mm INTO SOUND TIMBER.  
NEW TIMBER OF MIN. GRADE C24 TO BE  
CONNECTED TO SOUND EXISTING TIMBER WITH  
UNDERSQUINTED STOP SPLAYED SCARF JOINT.

DETAIL B: RAFTER SPLICE DETAIL

DECAYED WALL PLATE TO BE CAREFULLY REMOVED AND  
RESULTING VOID INFILLED WITH STOCK BRICKS LAID IN 1  
PART SHARP SAND TO 3 PARTS NHL3.5 OR SIMILAR  
APPROVED. NEW 100mm WIDE x 50MM THICK DRIED OAK  
WALL PLATE TO BE INSTALLED ATOP STEP IN INTERNAL FACE  
OF BRICKWORK GABLE AND FIXED IN PLACE WITH 3No. M10  
HIT-HY 270 RESIN ANCHORS BY HILTI OR SIMILAR APPROVED.

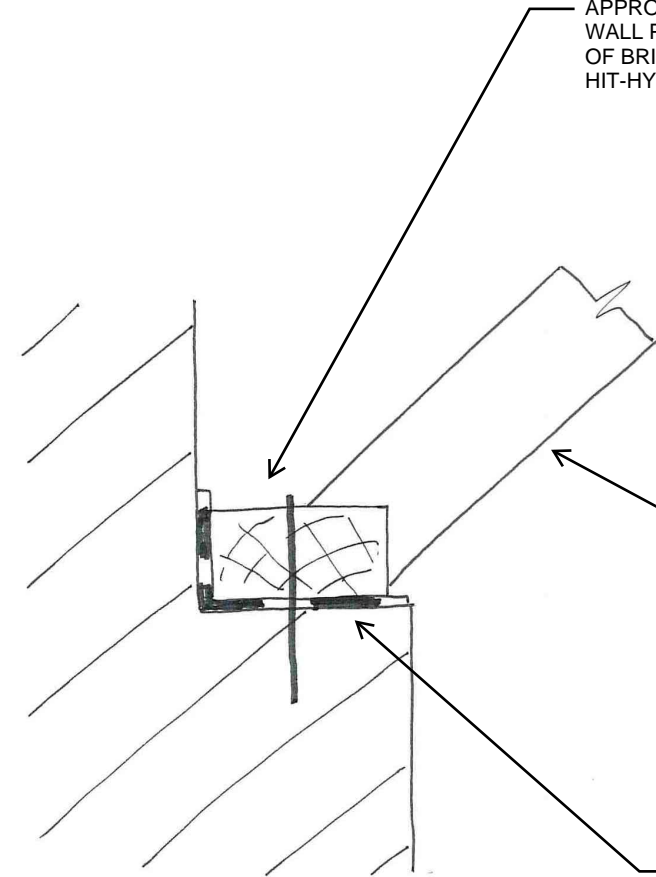

REPAIRED OR EXISTING RAFTER FEET  
TO BE ADJUSTED TO SUIT NEW WALL  
PLATE POSITION AS REQUIRED

ALL SURFACES OF NEW WALL PLATE TO  
BE SEPARATED FROM DAMP BRICKWORK  
WITH CONTINUOUS WATERPROOF  
MEMBRANE (DPC OR SIMILAR)

DETAIL C: WALL PLATE DETAIL



P54	25.04.24	Scale notes updated	KC	KC
P4	20.04.24	Scale notes updated	KC	KC
P3	19.03.24	Scale notes updated	KC	KC
P2	12.03.24	Scale bar added	KC	KC
P1	29.02.24	Preliminary issue	KC	KC

Rev Date Description

Scale	Drawn	Engineer	Date
1:10@A3	KC	KC	FEB 2024

Drawing Status	Project No	Revision
PRELIMINARY	230770	P5

Drawing No
SSK401

**conisbee** Consulting Structural Engineers  
Consulting Civil Engineers

London • Cambridge • Norwich  
1-5 Offord St London N1 1DH  
Telephone 020 7700 6666  
www.conisbee.co.uk

Project  
Quebec House, Westerham

Title  
Roof  
Proposed remedial details (2 of 2)