

NOTES

All necessary consents and approvals are to be obtained before commencing any works.

All services are to be traced and their locations confirmed prior to commencing any intrusive works.

All site operations are to be undertaken by fully trained and qualified personnel.

The contractor is to take all necessary precautions to screen and protect relevant areas.

All works are to be inspected and approved by the structural engineer.

All areas are to be reinstated to suit their previous appearance following inspection by the structural engineer.

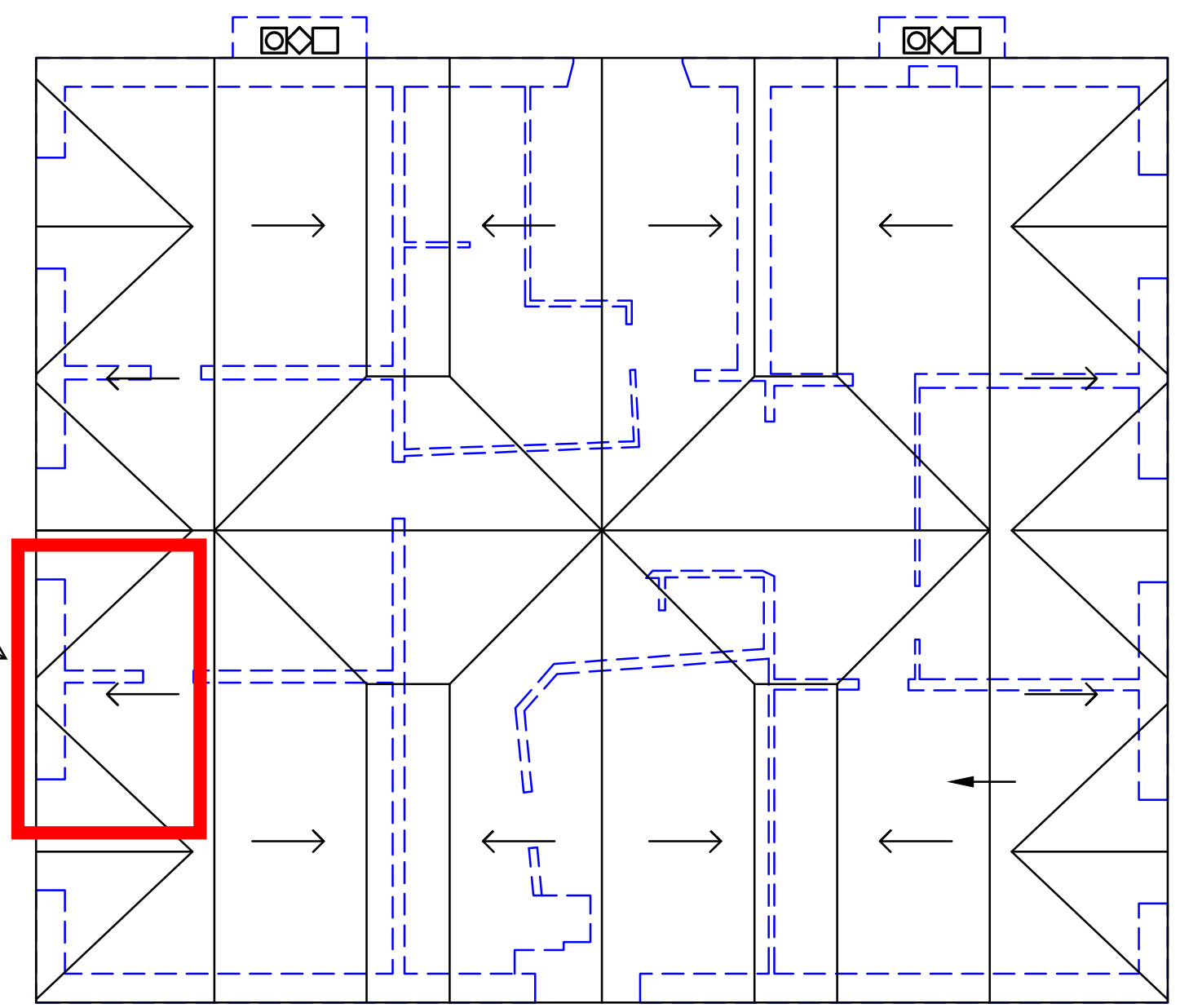

DECAYED ROOF TIMBERS TO BE REPAIRED AND BRICKWORK GABLES TO BE TIED TO ROOF STRUCTURE IN THIS AREA. REFER TO CONISBEE DRAWINGS SSK400 AND SSK401 FOR DETAILS.



ROOF PLAN



THIS DRAWING MUST BE READ IN CONJUNCTION WITH THE SPECIFICATION AND ALL OTHER RELEVANT DRAWINGS.

Rev	Date	Description		
P3	20.04.24	Scale notes updated	KC	KC
P2	19.03.24	Scale notes updated	KC	KC
P1	12.03.24	Preliminary issue	KC	KC

conisbee Consulting Structural Engineers
Consulting Civil Engineers

London • Cambridge • Norwich
1-5 Offord St London N1 1DH
Telephone 020 7700 6666
www.conisbee.co.uk

Project
Quebec House, Westerham

Title
Roof plan
Proposed remedial works

Scale	Drawn	Engineer	Date
1:75@A3	KC	KC	MAR 2024
Drawing Status	Project No	Revision	
PRELIMINARY	230770	P3	
Drawing No			
SSK099			