

LEGEND

Boundary Reference Points

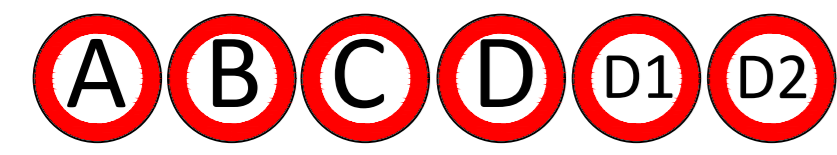

Boundary Schedule

- A-B** 1.8 m high close boarded timber fence against school security fence
- B-C** Open Boundary with Kidbrooke Park Road
- C-D** Open boundary with Phase 2
- D-D1** 3m high security fence/retaining wall
- D1-A** 1.8 m high close boarded timber fence against school security fence
- D1-D2** 1.8 m high close boarded timber fence with steel double gates to nursery



External Cycle Stands

13No Sheffield Type Stainless Steel Cycle Stands
(26 cycle spaces)

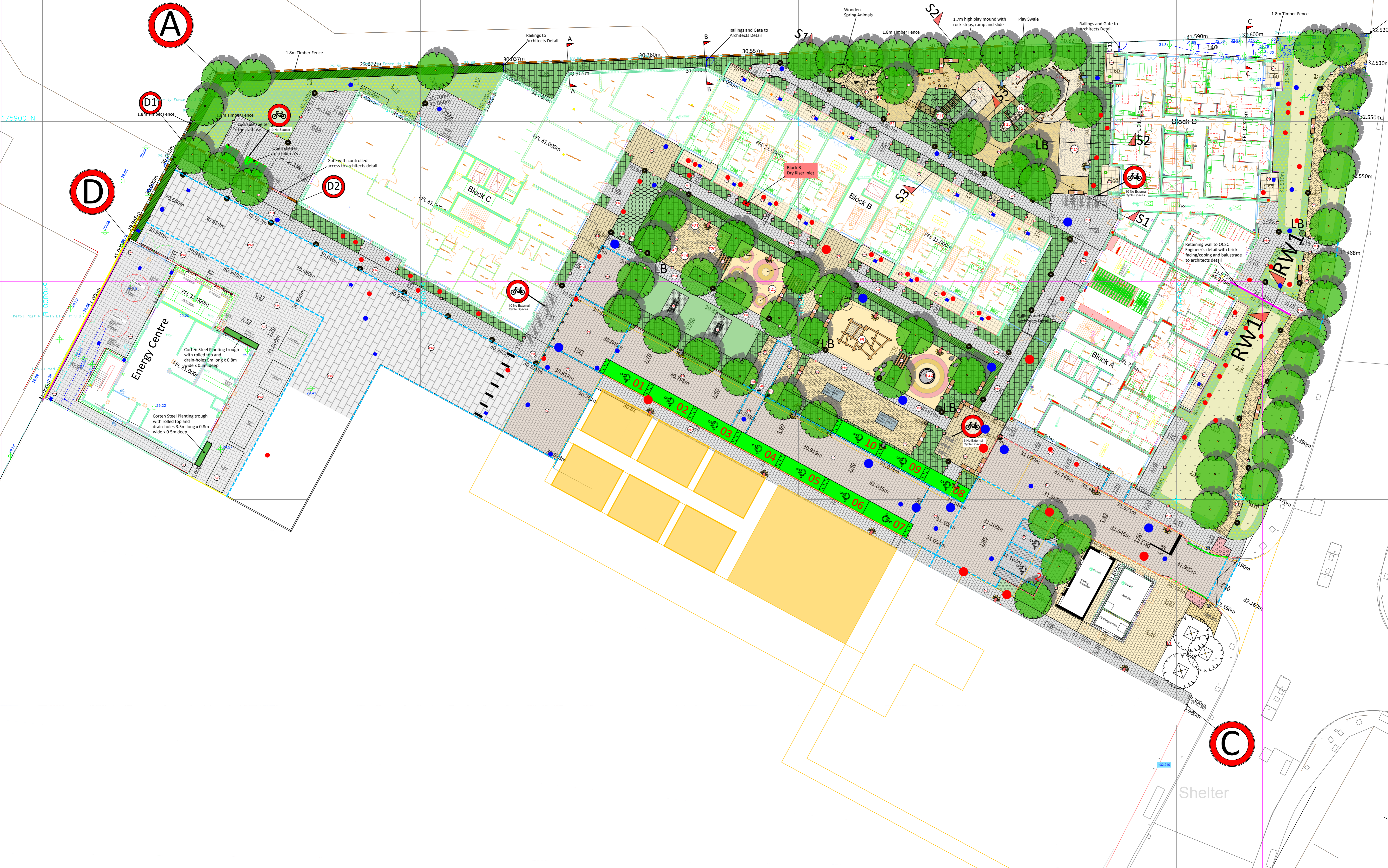

LANDSCAPE KEY	
Proposed Tree Position	
Formal Hedge Planting	
Species Rich Turf - 80% Slow Growing Grasses & 20% Native Wildflowers - Maintained to a minimum mow height of 50mm	
P4 Native Wildflower Meadow Turf	
Tiller's Turf Flora Meadow Wildflower Turf with Bulbs, Corms and Tubers as schedule	
Planted Area	
Swale Gravel Filter Bed	
Turf with Reinforcement Mesh suitable for occasional emergency services use	
Lawn Reinforcement under Play Equipment to limit minimum use zone	
Surfgreen GR11 colour 'Green'	

HARD LANDSCAPE KEY	
P1 - Carriageway PERMEABLE Paving	
P1A - Carriageway IMPERMEABLE Paving	
P2 - Parking Bays, PERMEABLE Paving	
P2A - Energy Centre IMPERMEABLE	
P3A - Footpaths IMPERMEABLE	
P4 - Pedestrian Feature Areas	
P5 - Self-Binding Gravel	
P6 - Wet Pour Porous Safety Surface	
P7a - Rubber Mulch safety surface to play area.	
P7b - Rubber Mulch safety surface to play area.	
P8 - Concrete Flag Paving to Private Terraces	
P14 - Concrete Flag Paving to rear of Energy Centre	

Revisions

- Rev P01: 02/08/22 First Issue
- Rev P02: 03/08/22 Energy Centre added.
- Rev P03: 25/08/22 Temporary Paved Access to Energy Centre indicates a new access route to Energy Centre. Paved area north of Block D added in lieu of planting.
- Rev P04: 04/10/22 Play equipment scheduled and explanatory sections added.
- Rev P05: 06/10/22 Access path on northern corner of block B amended to provide separation from boundary.
- Rev P06: 30/01/23 Exterior cycle parking moved to Block D and play area adjusted to accommodate revised access.
- Rev P07: 03/04/23 Phase 2 interface introduced and paving updated. Northern boundary sections indicated. Boundary schedule added. Tender package boundaries indicated.
- Rev P08: 14/04/23 WSP Lighting scheme added for coordination. Benches detailed. Fences and paving added to Block D north flank. Play equipment revised and scheduled. Proposed tree deleted north of Block C.
- Rev P09: 20/04/23 Layout restored to original Phase 1 extent.
- Rev P10: 24/04/23 Green line indicated.
- Rev P11: 27/04/23 Tree positions amended to accommodate drainage and M&E services.
- Rev P12: 18/05/23 Children's nursery cycle store added.
- Rev P13: 23/05/22 Paving materials and furniture reverted to HTA Landscape Specification.
- P14: 07/06/23 Cycle stands amended to HTA layout. Private terrace paving added. Paving to Nursery frontage amended.
- Rev T01: 12/06/23 TENDER ISSUE
- Rev T02: 14/06/23 Durkan comments addressed
- Rev T03: 18/06/23 Watermain north of access road checked for clash with trees.
- Rev T04: 28/06/23 Sub-Station and Generator updated.
- Rev T05: 26/07/23 Litter bins amended to 4No and relocated as ROSPA comments.
- Rev T06: 14/09/23 Site entrance coordinated with OCS plans. Boundary schedule updated.
- Rev T07: 28/09/23 Site entrance amended on OCS advice.
- Rev T08: 09/11/23 Boundary lines deleted and updates to kerbs and Energy Centre Paving.
- Rev T09: 31/11/23 Paving materials updated. Temporary Parking indicated.
- Rev T10: 07/12/23 Block B Dry Riser relocated. Block B Fire Tender access restored.
- Rev T11: 07/12/23 VE Paving specification updated as instruction via email 07/12/23 UP/PP. Temporary parking bay 8 relocated. Lighting amended.
- Rev T12: 04/01/24 Temporary Play Provision expanded. Temporary parking bays adjusted to accommodate 2 permanent disabled bays next to sub-station.
- C01: 10/01/24 CONSTRUCTION ISSUE
- C02: 12/01/24 Carriageway and Parking Bays Paving bonds indicated. Play safety surface rubber mulch maximum depth indicated.
- C03: 15/01/24 Footpaths shown IMPERMEABLE Paving to rear of EC to be Tobermore Classica slabs. Road access to EC to be IMPERMEABLE. Paved apron to front of EC to be IMPERMEABLE.
- C04: 24/01/24 Energy Centre turning head stopped at Phase 2 hoarding line.
- C05: 29/01/24 E2 edging deleted and replaced with flush E1 edging throughout. Trough planters added to Energy Centre. OCS Engineers Levels and gradients added. OCS Engineers Inspection Chambers and Gullies indicated for coordination.

KERBS AND EDGINGS	
Metal edge, 150mm Flexible Edging, laid flush	
Tobermore Fusion Kerb 'Silver' 255 x 145 x 915mm laid flush 125mm upstand	
Tobermore Fusion Kerb 'Silver' 255 x 145 x 915mm laid flush 145mm wide	
Tobermore Fusion Kerb 'Silver' 255 x 145 x 915mm dropper kerb section	

FURNITURE	
Steel-Framed Bench with Padded and Sanded Iroko Slats	
Cycle racks	
Hardwood Bollard	
Removable Bollard - F4b	
Litter Bin - OMOS 545 TA	
Lighting (KPR-WSP-SW-XX-DR-E-630101-C01)	
Thorn Thor bollard - mounting height 1m, colour temperature 4000K led, luminaire output 672lm, power 11w / equal and approved	
Thorn Isaro pro x2 - mounting height 6m, colour temperature 4000K led, luminaire output 2070lm, total power 15w / equal and approved	
Thorn Isaro pro - mounting height 4m, colour temperature 4000K led, luminaire output 2070lm, total power 15w / equal and approved	
Temporary Parking Bay	

mca DURKAN

Kidbrooke Park Road Phase 1

Ground Level Landscape - Hard Landscape and Furniture

1:200/A0 01/08/22 MC

KPR-MCA-SW-00-DR-L-0005 C05