

Site Plan as Existing

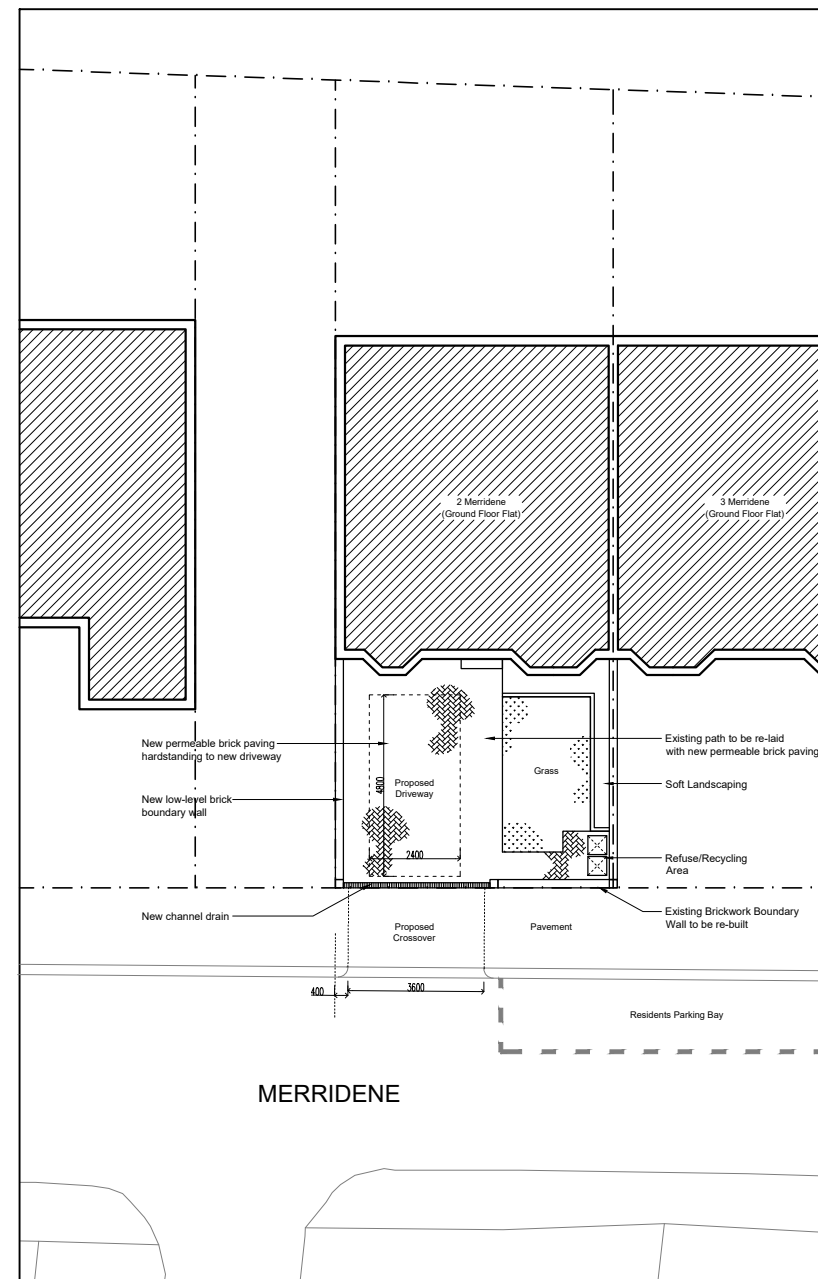

Site Plan as Proposed

**PPLX**  
Architects

58 Pine Grove  
Brookmans Park  
Herts  
AL9 7BW

t: 07886 526 081  
f: 01707 642 026  
e: papalexandrakos@hotmail.com

Site:  
2 Merridene  
Winchmore Hill  
N21 1RD

Client:  
Mrs Charalambous

Title:  
Site Plan as  
Existing and Proposed

Drawn: NP | Drg. No. 336\_03

Date: Oct. 2022 | Rev. B

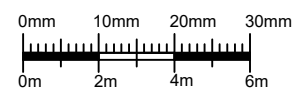

Scale: 1:200 | Drg. Size: A3

Key:

Existing Walls/Floors

Boundary Line

Rev.	Date	Note