

447900N

447800N

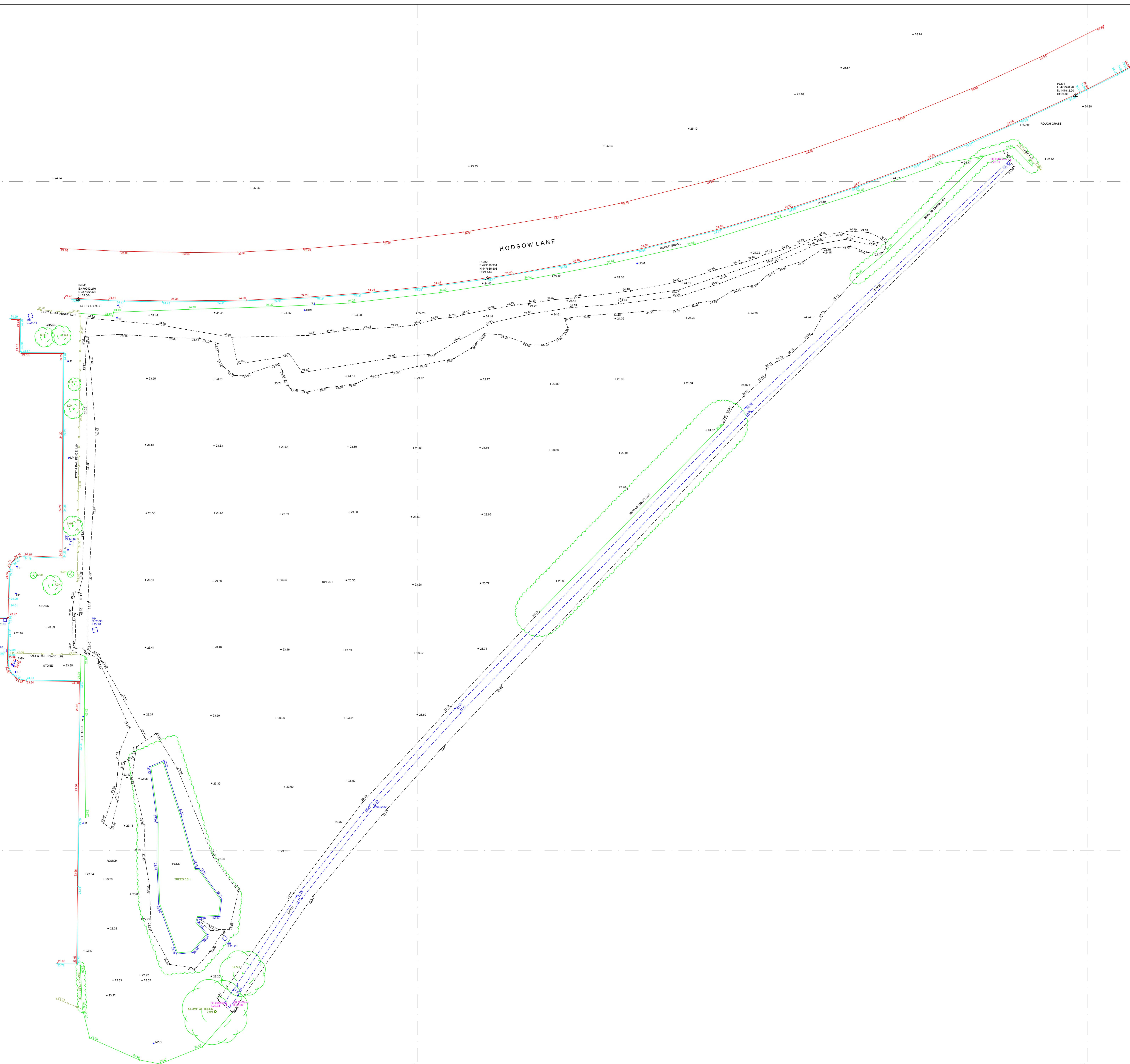
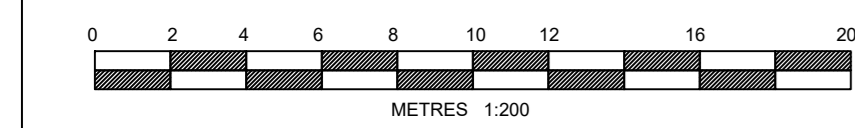

REV	DATE ISSUED	SURVEYED	DRAWN	GRID
A	04/12/2023	AM	MM	AM

DESCRIPTION: FIRST ISSUE

NOTES
 LEVELS ARE RELATED TO O.D. (NEWLYN).
 CO-ORDINATES ARE RELATED TO NATIONAL GRID
 DERIVED VIA GPS - OSGB36(15) SYSTEM.

LEGEND

• 111.71	SPOT LEVELS
△	SURVEY STATION
○	TREE (DECIDUOUS)
○	SHAW
---	DITCH
---	EXTENT OF SPREAD / CANOPY
---	FENCE
---	FOUNDATION
---	GRIDLINE
---	HEDGE (EDGE)
---	KERB TOP
---	ROAD
---	UTILITY
---	VEGETATION

ABBREVIATIONS

CL	COVER LEVEL
G	GULLY
H	HEIGHT
HBM	HIGHWAY BOUNDARY MARKER
I	INVERT LEVEL
LP	LAMP POST
MH	MANHOLE
MBR	MARKER
OF	CUTFALL
POM	PERMANENT GROUND MARKER
PRF	POST & RAIL FENCE
SP	SIGN POST
WL	WATER LEVEL

1:5 Transmission Confidentiality limited means for materials, expressed or implied. Not compliance with this drawing, or any other document issued by LSTC, shall be treated as sufficient to ensure safe systems of work or operation. Users are reminded of their own duties under health and safety legislation.

CLIENT: JG HATCLIFFE

PROJECT: BROADHELM BUSINESS PARK
POCKLINGTON

TITLE: TOPOGRAPHICAL SURVEY

SCALE	1:200 (AS PER CONTRACT DRAWING)	DRKMAN	MM
DATE SURVEYED	27/11/2023	CHECKED	AM
DATE ISSUED	04/12/2023	APPROVED	DBe



ORIGINAL DRAWING NUMBER	REV
A0	06_231098_01
	A