

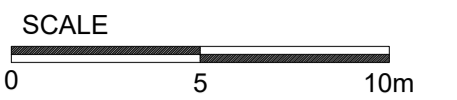

Disclaimer:
Subject to survey.



Notes:

 Indicative zone allocated for PV layout (in line with energy strategy report and BREEM requirements). Extent and location TBC.

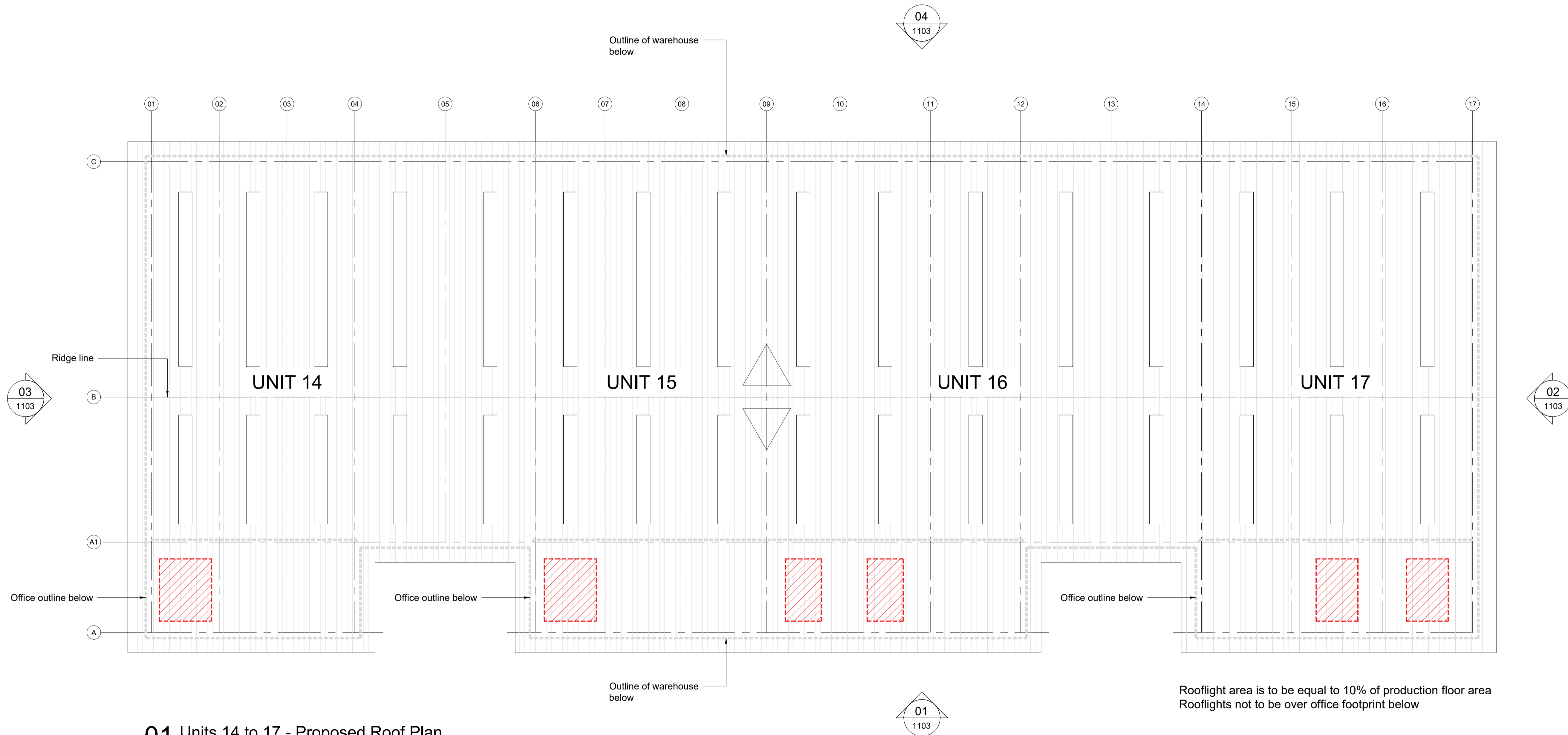

01 Units 14 to 17 - Proposed Roof Plan

1:200 @ A1 / 1:400 @ A3

A Planning Issue 11.03.2024 SK HA

Rev: Notes: Date: Dwn: Iss:

Suitability Code:

PLANNING

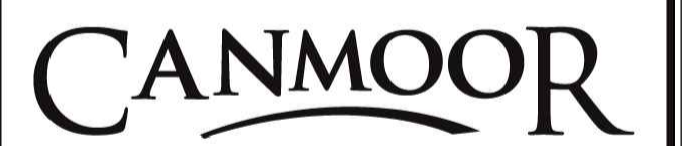

hale
ARCHITECTURE

22c Leathermarket Street, London, SE1 3HP

Project:
Windrush, Witney
Plot B

Drawing Title:
Units 14 to 17
Proposed Roof Plan

Project No: 23052 Scale @ A1/A3 1:200/1:400 Revision: A

Drawing No:
PL-1102