

FIRE DETECTION:

- Call Point
- Ⓢ Smoke Detector
- Ⓜ Heat Detector

DOOR LEGEND:

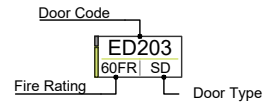

DOOR TYPES:

- SD Solid Door
- TP Glazed Top Panel

FR 60 Upgrade:

Allow for upgrade of all fire doors of the main stairwell (15 no.) as follows:

- - 1.5 pairs of satin brass 60min FR certifier door hinges
- - satin brass 60 min FR door closer
- - 60 min FR intumescent and smoke seals to perimeter
- - 'FIRE DOOR - KEEP SHUT' signage blue on brass, 76mm dia

DO NOT SCALE FROM THIS DRAWING

GD Lodge accepts responsibility for this document only for the intended use by the commissioning party and not to any other.

All 3D visualisations are for indicative purposes only.

This drawing is for information only, is subject to approval of the local authority and should not be used for construction.

Rev	Alterations Made	Dwn	Chk	Date
\	INITIAL ISSUE	MS	AM	19.10.23
A	TITLE BOX AMENDED	AG	AM	26.04.24

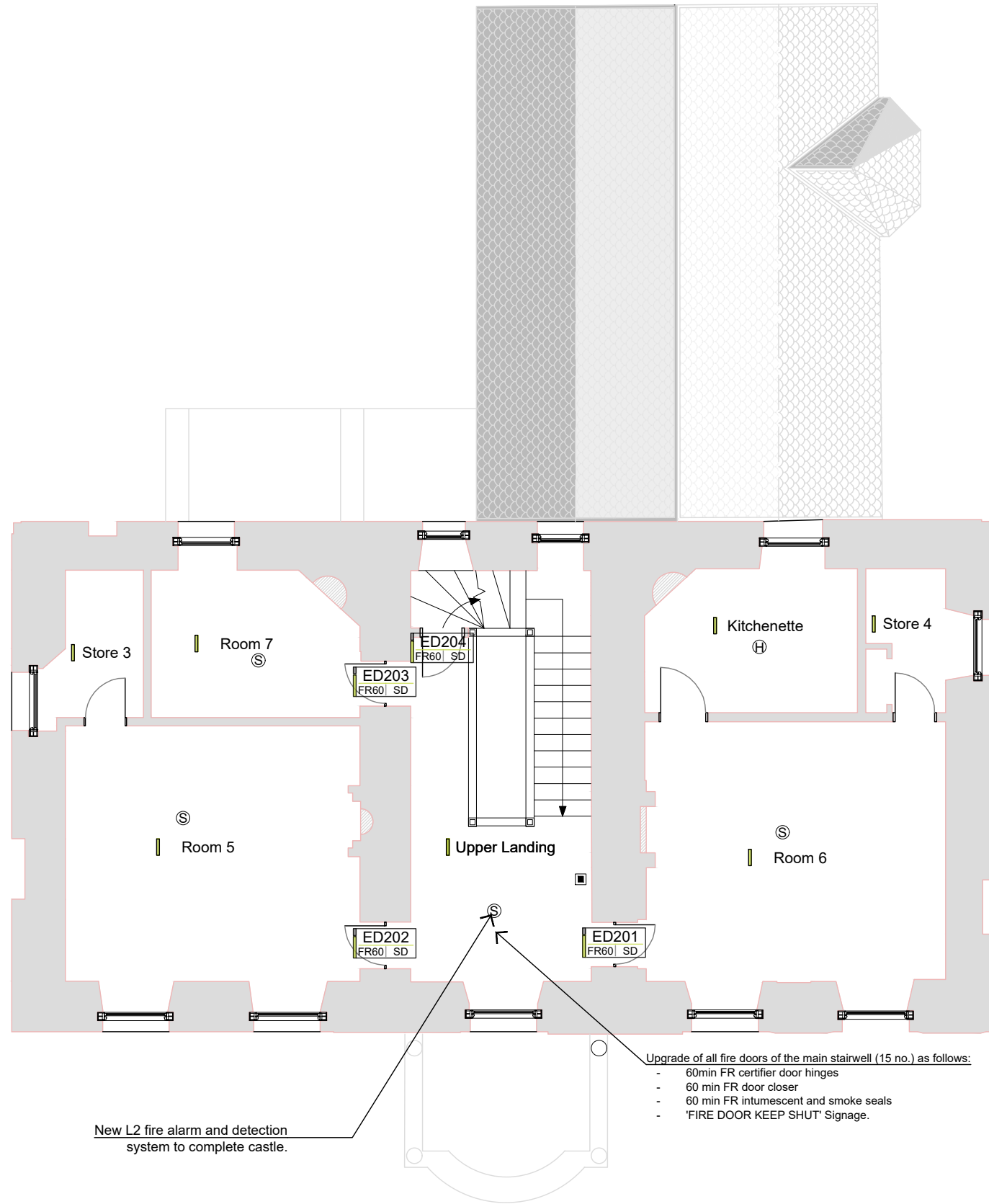

- Upgrade of all fire doors of the main stairwell (15 no.) as follows:
- 60min FR certifier door hinges
 - 60 min FR door closer
 - 60 min FR intumescent and smoke seals
 - 'FIRE DOOR KEEP SHUT' Signage.

New L2 fire alarm and detection system to complete castle.

P06

Proposed Second Floor Plan



gd lodge architects

crown house 152 west regent street glasgow G2 2RQ
 www.gdlodge.co.uk projects@gdlodge.co.uk 0141 332 6804

Client
 BANFF CASTLE

Project
 Banff Castle

Drawing
 Proposed Second Floor Plan

Status Planning	Scale 1:100	Paper Size A3
Job No. 2952	Drawing No. 313	Rev. A