

Fascias and berge boards to match existing uPVC goods.

All rainwater system to match existing and to utilise existing drainage system

1400 x 1140 Velux roof windows fully openable.
Brown uPVC

New roof natural slates to match main building on 25 x 50 battens and couterbattens on roofing felt. Roof joists at 450 centres designed to suit with 150 x 50 joists. Roof insulation above ceiling 300mm Rockwool or equal over trusses . Ventilated eaves and plasterboard to ceiling following line of roof pitch. Roof pitch to match existing building on Wheatholme Street.

Roof Plan

Wall Construction, External leaf 100 reconstructed stone as existing, cavity 100 wide with inner leaf of Hi Seven or similar blockwork, 12 plasterboard on dabs lining. Insulation Celotex CG5000 70thick giving total u value of 0.20 W/M²/°C, 50 clear cavity. Wall ties at 300 vertical and 750 horizontal spacing, and no more than 300 vert spacing with 225 of openings.

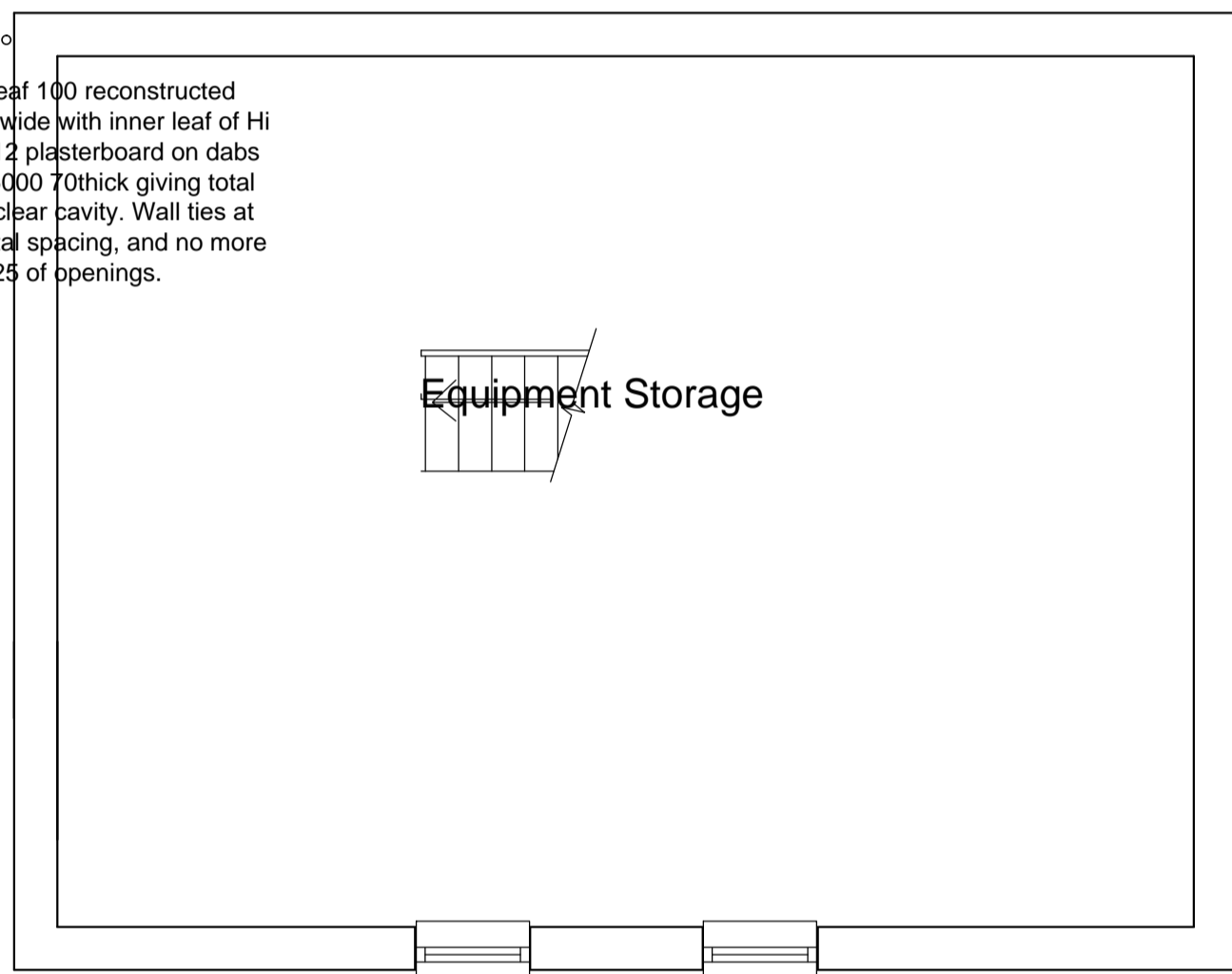

Roof Storage

Floor construction 20 thick t&G boards laid on 200 x 50 SC4 joists at maximum 450 centres (laid between existing joists) underdrawn wirh 15 fireline board (this is in place but needs checking)

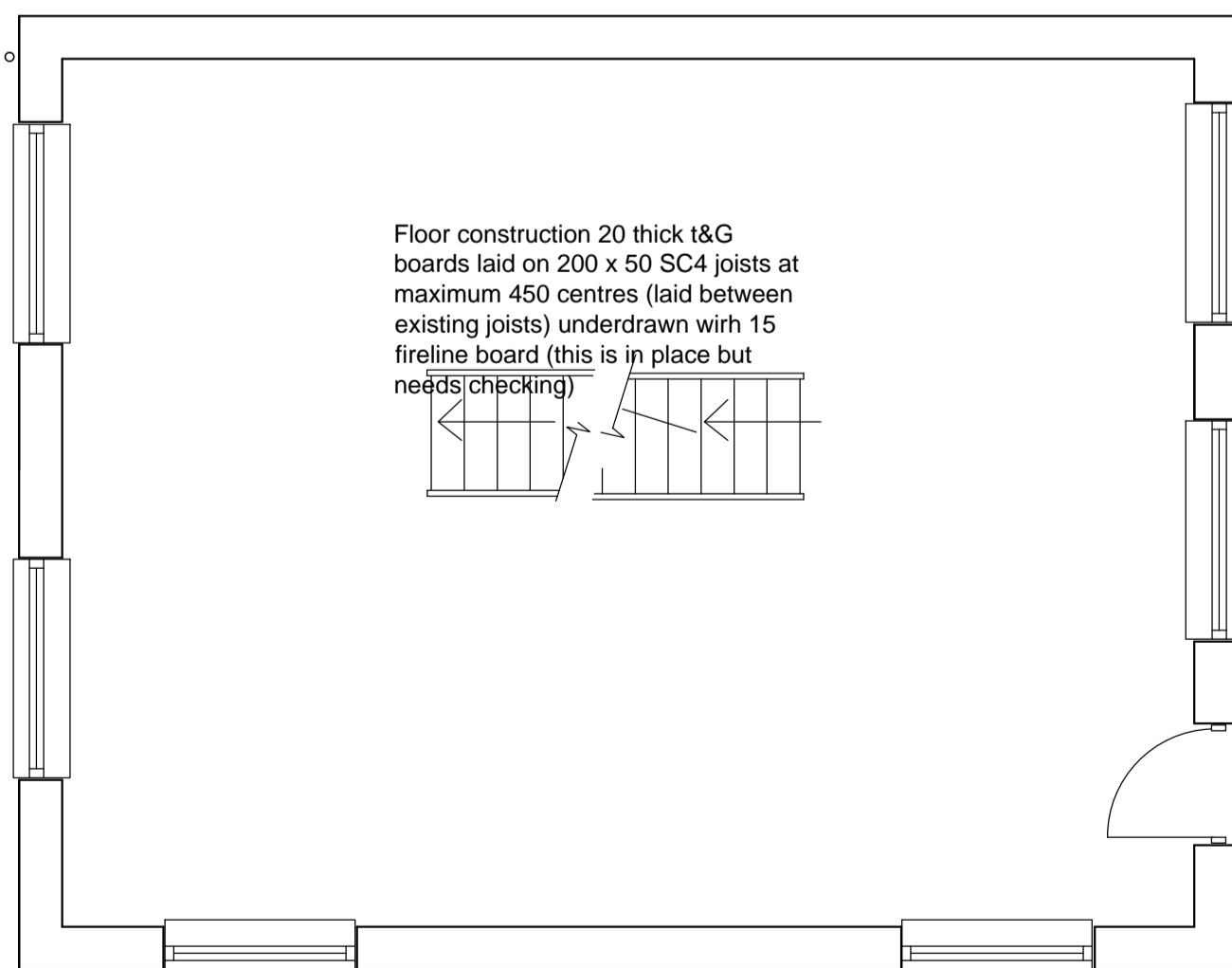

Wall Construction, External leaf 100 reconstructed stone as existing, cavity 100 wide with inner leaf of Hi Seven or similar blockwork, 12 plasterboard on dabs lining. Insulation Celotex CG5000 70thick giving total u value of 0.20 W/M²/°C, 50 clear cavity. Wall ties at 300 vertical and 750 horizontal spacing, and no more than 300 vert spacing with 225 of openings.

Physiotherapy/Gym Level

Title
Existing Plans

Job
Kashmir House, Greenbank
Gardens, Rawtenstall

Client

Dwg No
16011/2

Scale
1:50

DJ Hancock Design
22 Croft Street
Bacup
Tel 01706 563502
Mob 07599 008 791