

This drawing is the property of GWP Architecture. Copyright is reserved by them and the drawing is issued on the condition that it is not copied, reproduced, retained, or disclosed to any unauthorised person, either wholly or in part, without the consent in writing of GWP Architecture.

All drawings and specifications should be read in conjunction with the project health and safety plan, any possible conflicts should be presented to the Planning Coordinator.

All work to be carried out in accordance with current Building Regulations.

Contractors must verify all dimensions at the job before commencing any work or making shop drawings.

Written dimensions should be taken.

Do not scale off drawing.

Do not take digital dimensions from this drawing.

Any discrepancies to be reported to the Architect.



Scale - 1:250 @A3

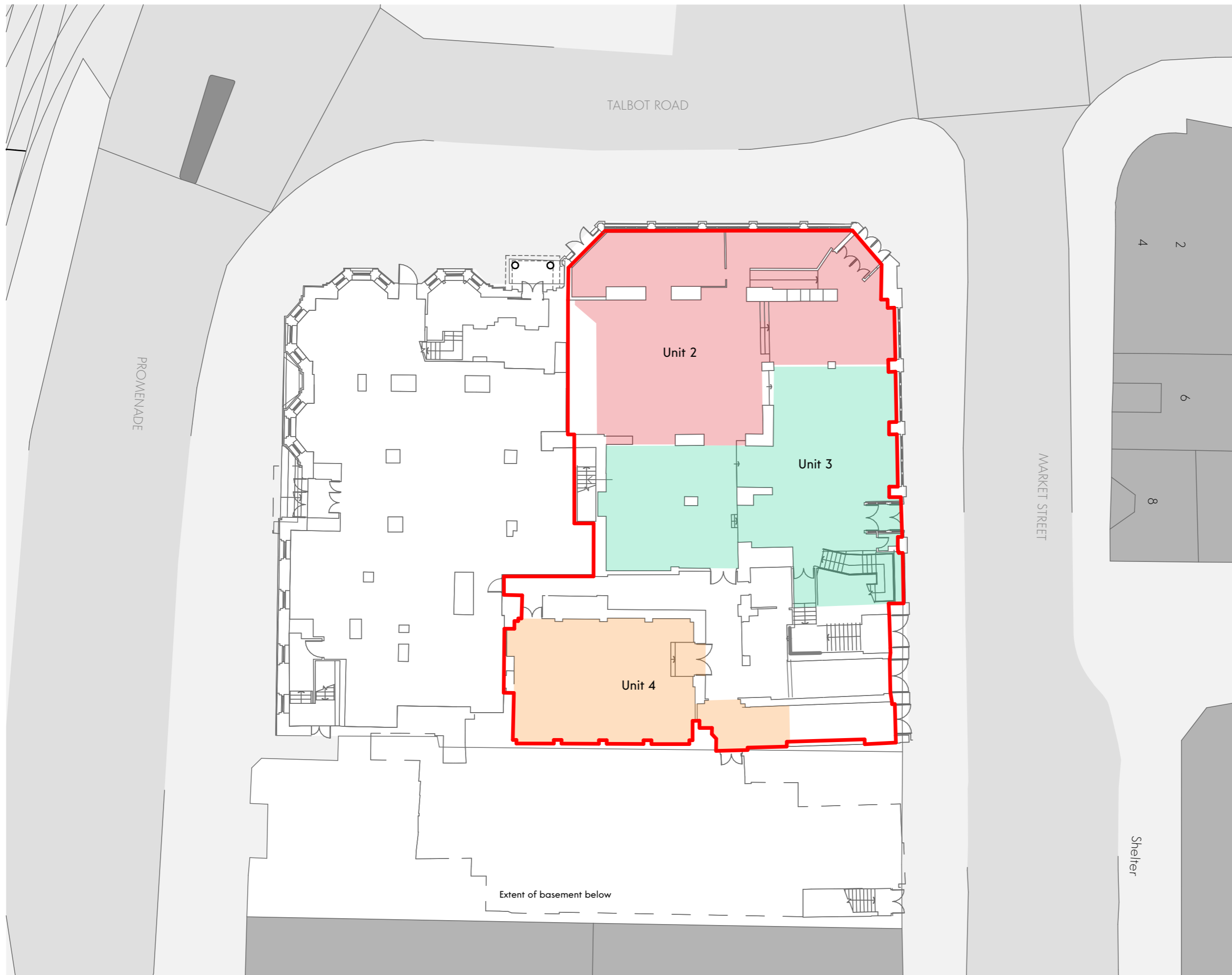

Rev	Date	Comment	Dr	Ch
P02	10.04.24	Unit Extents Shown	JH	RT
P01	28.03.24	First Issue	JH	RT



CHARTERED ARCHITECTS
INTERIOR DESIGNERS
SPACE PLANNERS
PROJECT MANAGERS
LANDSCAPE ARCHITECTS

First Floor Swan Buildings, 20 Swan Street Manchester M4 5JW
+44(0)113 266 6044 (t) +44(0)113 266 1859 (f)
architecture@gwp-arch.com | www.gwp-arch.com

GWPA Ref (505)2404

Job Title Forshaw's Hotel, Blackpool

Client BL Blackpool LTD

C.O.U Site Plan

Name (505)2404-GWP-01-XX-D-A-(00)-0002

Scale 1:500@A3 Revision P02

Drawn/Checked JH/RT First Issue 28.03.24

Drawing Status S2 - For Information

Z:\Volumes\Data\CAD\5052404 Forshaw Hotel, Blackpool\A_Architects_GWP\Media\5052404-GWP-01-XX-D-A-Forshaw Hotel, Blackpool-RT1.rvt