

HM Land Registry  
Official copy of  
title plan

Title number **CL277701**  
Ordnance Survey map reference **SX2691NW**  
Scale **1:2500**  
Administrative area **Cornwall**

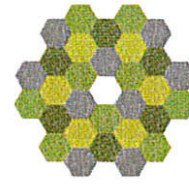

© Crown Copyright. Produced by HM Land Registry. Reproduction in whole or in part is prohibited without the prior written permission of Ordnance Survey. Licence Number 100026316.

Construction Risks Maintenance/Cleaning Risks Demolition/Adaptation Risks  
In addition to the hazards normally associated with the types of work detailed on this drawing take note of the above. It is assumed that all works on this drawing will be carried out by a competent contractor working, where appropriate, to an appropriate method statement.  
Safety Health and Environmental Information Box  
Disclaimer

This document and its design content is copyright ©. It shall be read in conjunction with all other associated project information including models, specifications, schedules and related consultants documents. Contractors must check all dimensions on site. Only figured dimensions are to be worked from. Discrepancies must be reported immediately to the Architect before proceeding. If in doubt ASK.

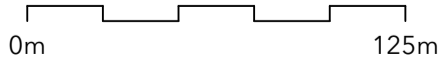
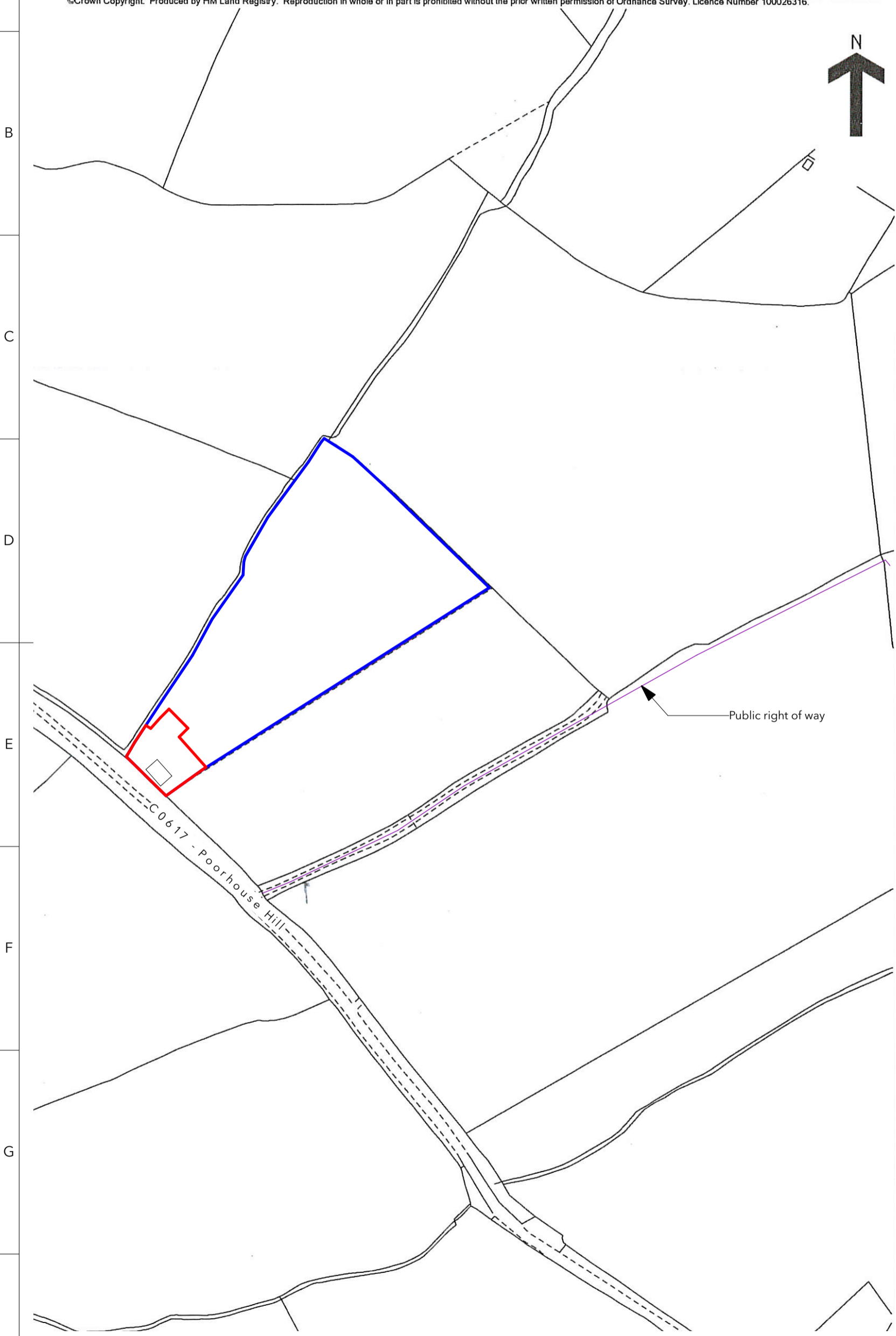

1 Location Plan  
1:2500

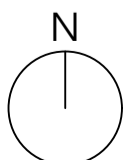

Key:  
■ Site ownership boundary  
■ Site development boundary

02	Ch-03	Existing building and road label added	09/04/2024
01			13/02/2024
RevID	CHID	Change Name	Date

**Location**  
Sans Souci Garage, Poorhouse Hill,  
North Petherwin, Launceston,  
Cornwall. PL15 8FJ

**Client**  
Leoni & Paul Hollett

**Layout Name**  
Location Plan

**Project Number** 023-38  
**Drawing Number** 300

**Revision** 02  
**Scales at A3** 1:2500

**Checked By** MK  
**Purpose of Issue** Planning



people@placearchitects.co.uk  
01566 772035