

PLANT SCHEDULE

Native Hedge

No.	Abbrev	Species Name	Common Name	Height	Girth	Specification	Density
64	CARBET	Carpinus betulus	Common Hornbeam	60-80cm	1+1	:Transplant :BR 0.4Ctr Double Staggered at 0.4m offset	

Shrubs

No.	Abbrev	Species Name	Common Name	Height	Specification	Pot Size	Density
22	Cd	Cotoneaster dammeri	Bearberry cotoneaster	30-40cm	Bushy :4 brks	3L	4/m ²
10	CISLUD	Cistus lusitanicus 'Decumbens'		30-40cm	Bushy :4 brks	3L	4/m ²
8	EfSQ	Euonymus fortunei 'Silver Queen'	Euonymus 'Silver Queen'	30-40cm	Bushy :6/9 brks	5L	3/m ²
15	EI	Escallonia 'Iveyi'	Escallonia 'Iveyi'	60-80cm	Bushy :6 brks	10L	0.35Ctr
15	HEBRA	Hebe rakaiensis	Shrubby Veronica	20-30cm	Bushy :5 brks	3L	6/m ²
24	LaH	Lavandula angustifolia 'Hidcote'	Lavender 'Hidcote'	30-40cm	Bushy :9 brks	10L	0.3Ctr
4	LAUNO	Laurus nobilis	Bay Laurel	150-175cm	1m clear stem; clipped head 50cm dia.	10L	Counted
21	Pf 'LRR'	Photinia 'Little Red Robin'		30-40cm	Branched :4/6 brks	3L	3/m ²
52	VINMIGEJ	Vinca minor 'Gertrude Jekyll'		20-30cm	Full Pot :5 brks	2L	6/m ²

Herbaceous

No.	Abbrev	Species Name	Pot Size	Density
93	BBW	Bergenia 'Bressingham White'	2L	9/m ²

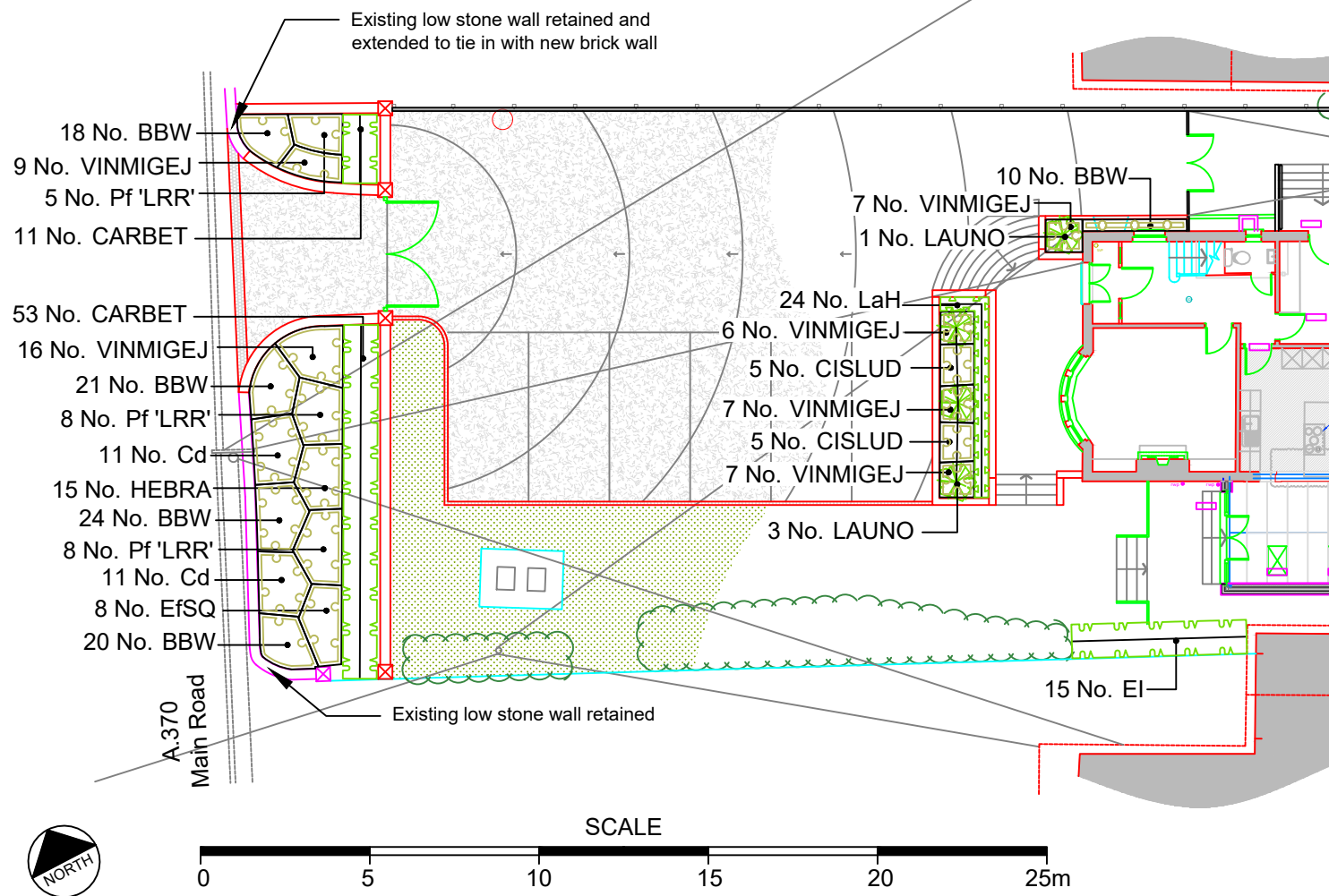

SPECIFICATION NOTES:

- Proposals to be read in conjunction with WH Architect's Drawings;
- All landscape operations to be in accordance with BS 4428: 1989 & BS 3936: 1992 and all amendments to date;
- Any topsoil to be stripped from site in dry conditions, stored in heaps not exceeding 2m high, and maintained weed free for re-use on site;
- Prior to placing topsoil, subsoil to be ripped to alleviate any compaction and ensure free drainage to the minimum rooting depth which shall normally be 450mm for grass and 600mm for shrubs;
- Any imported topsoil to be to BS 3882, medium texture, neutral pH value, reasonably stone free with no stones over 20mm in size;
- Topsoil depths to be minimum 450mm for shrubs and groundcover planting, 300mm for native hedge & 150mm for grass areas;
- Finished topsoil levels to be 25mm above adjacent paved surfaces to allow for settlement.
- Garden grass areas should be prepared by thorough weeding and cultivation of topsoil to a fine tilth, spread to smooth and flowing levels prior to turfing with good quality lawn turf laid in accordance with good practice or seeding with British Seed Houses A2 Mix 'Quality Lawn, sown at 35g/sq.m. (or similar approved);
- All bare-root and rootballed stock to be planted during the first planting season (November to March) following completion of the construction works;
- Any bare root or rootballed out of season planting to be substituted with container grown stock of similar size;
- Transplants in native hedge to be of local provenance, notch planted and protected with spiral rabbit guards and canes as necessary;
- Specimen shrubs to be planted in topsoil pits 600mm diameter x 450mm deep and supported with a single stub stake or angled stake and rubber Tom Tie fixed no more than 50mm from the top of the stake, with stakes removed after two years;
- All planting areas to be covered with a 75mm depth of medium grade bark mulch and to a minimum of 1m width along hedges;
- Fortnightly watering to be carried out at the rate of 10 litres per shrub / linear metre of hedge (weekly during drought periods) from April to September for the first 2 years after planting;
- All planting to be maintained and guaranteed for 10 years to include watering, weeding, pest & disease control.

LEGEND

- EXISTING HEDGE
- RETAINED
- PROPOSED HEDGE
- PROPOSED LOW EDGING HEDGE
- PROPOSED SHRUBS & GROUNDCOVER
- PROPOSED SPECIMEN SHRUBS
- EXISTING GRASS LAWN REINSTATED AS NECESSARY

MAINTENANCE & MANAGEMENT NOTES:

- All planting areas to be maintained and guaranteed for 10 years to include watering, weeding, pest & disease control and litter collection;
- Mulch to be topped up to 75mm depth annually for the first three years after planting;
- Planting to be inspected weekly and during periods of drought to be watered with 5 Litres per shrub to maintain moist rooting area as necessary;
- Native hedge on boundary to be maintained at a height of approximately 1.5-1.8 metres and lightly trimmed annually to maintain a dense base;
- Shrub and groundcover planting to be lightly pruned as necessary to allow development of the species natural form and encourage plants to 'knit' together to form a complete vegetation cover, while ensuring that paths and hard surfaces are kept clear of foliage;
- Specimen shrubs to be allowed to develop to their full form and height with only light formative pruning as necessary;
- Grass to be spot weeded as necessary and turf cut approximately fortnightly throughout the growing season;
- All arisings and litter to be removed from site after each visit;
- Any dead, dying or diseased plants within the first 10 years to be replaced with like for like plants or a suitable alternative as agreed with the LPA.

Rev. Date Amendment Drawn Checked

Client / Project
LYNN-WOOD, BROCKLEY
Drawing Title
LANDSCAPE PROPOSALS

Scale Date Drawn Checked

1:200 @ A3 SIZE 17-04-24 JB JB

Drawing No.

1107-01

BRIDGES DESIGN
ASSOCIATES

LANDSCAPE ARCHITECTURE • ENVIRONMENTAL PLANNING

50 Ridgeway Road, Long Ashton, Bristol BS41 9ES
Tel:01275 393450 Fax:01275 394776 E-mail:mail@bridgesdesign.co.uk