

**GENERAL NOTES:**

These drawings are for purposes of a Planning Application and/or Certificate of Lawfulness and are to be read in conjunction with all other drawings and specifications relating to this application from contributing consultants.

**CONSTRUCTION (DESIGN AND MANAGEMENT) REGULATIONS 2015 CDM**  
 These proposals fall within the requirements of the Construction (Design and Management) Regulations 2015. The Client is responsible for the appointment of the CDM designer and Principal Contractor. The Principal Contractor will be required to perform the construction tasks in accordance with the Health and Safety plan and to adopt them during the course of the construction process and to implement the requirements given to them by the CDM Designer during site visits.

**PARTY WALL**  
 Party Wall Act: The owner has a duty to serve a party structure notice to any adjoining owner if works are to be carried out to a party wall, structure, or line of junction; or if works involve excavations lower than the foundations of a neighbouring building within 3m, or excavations cut through a 45° line from the foundations of a neighbouring building within 6m. a party wall agreement/award should be formalised before the commencement of the works.

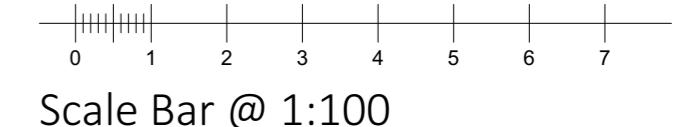
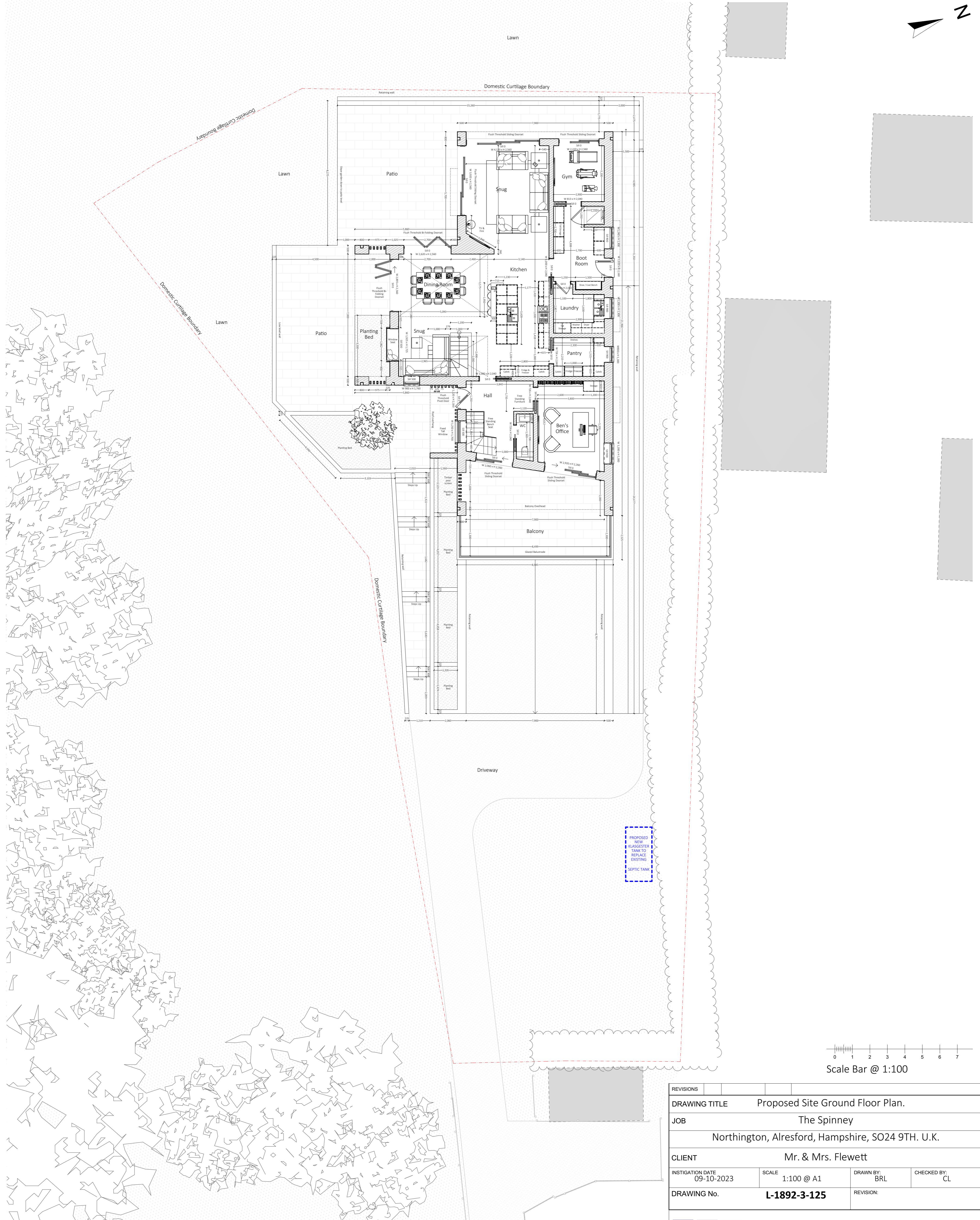
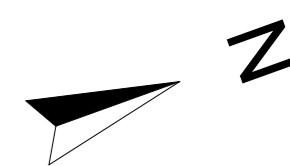

REVISIONS			
DRAWING TITLE Proposed Site Ground Floor Plan.			
JOB The Spinney			
Northington, Alresford, Hampshire, SO24 9TH. U.K.			
CLIENT Mr. & Mrs. Flewett			
INSTIGATION DATE 09-10-2023	SCALE 1:100 @ A1	DRAWN BY: BRL	CHECKED BY: CL
DRAWING No. L-1892-3-125		REVISION:	