

The contractor will be held to have examined the site and checked all dimensions, levels and setting out prior to commencing construction work. No dimensions should be scaled from this drawing.

Rev.	Date
A: UPDATED TO CLIENT COMMENT	11.12.23
B: UPDATED TO CLIENT COMMENT	20.12.23
C: UPDATED FOR PLANNING APPLICATION	12.03.24
D: UPDATED TO CLIENT COMMENT	22.03.24

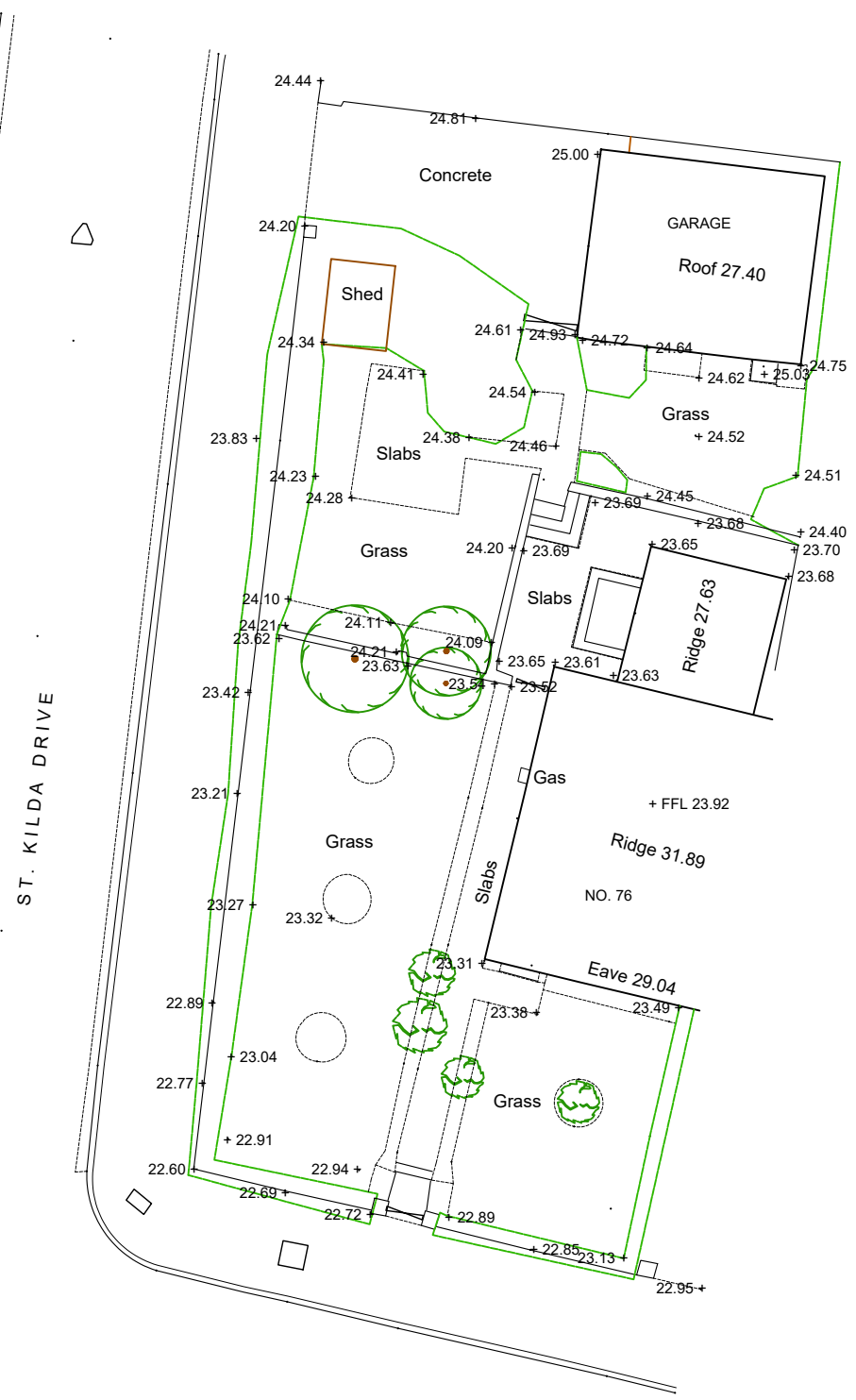

EXISTING SITE PLAN 1:200

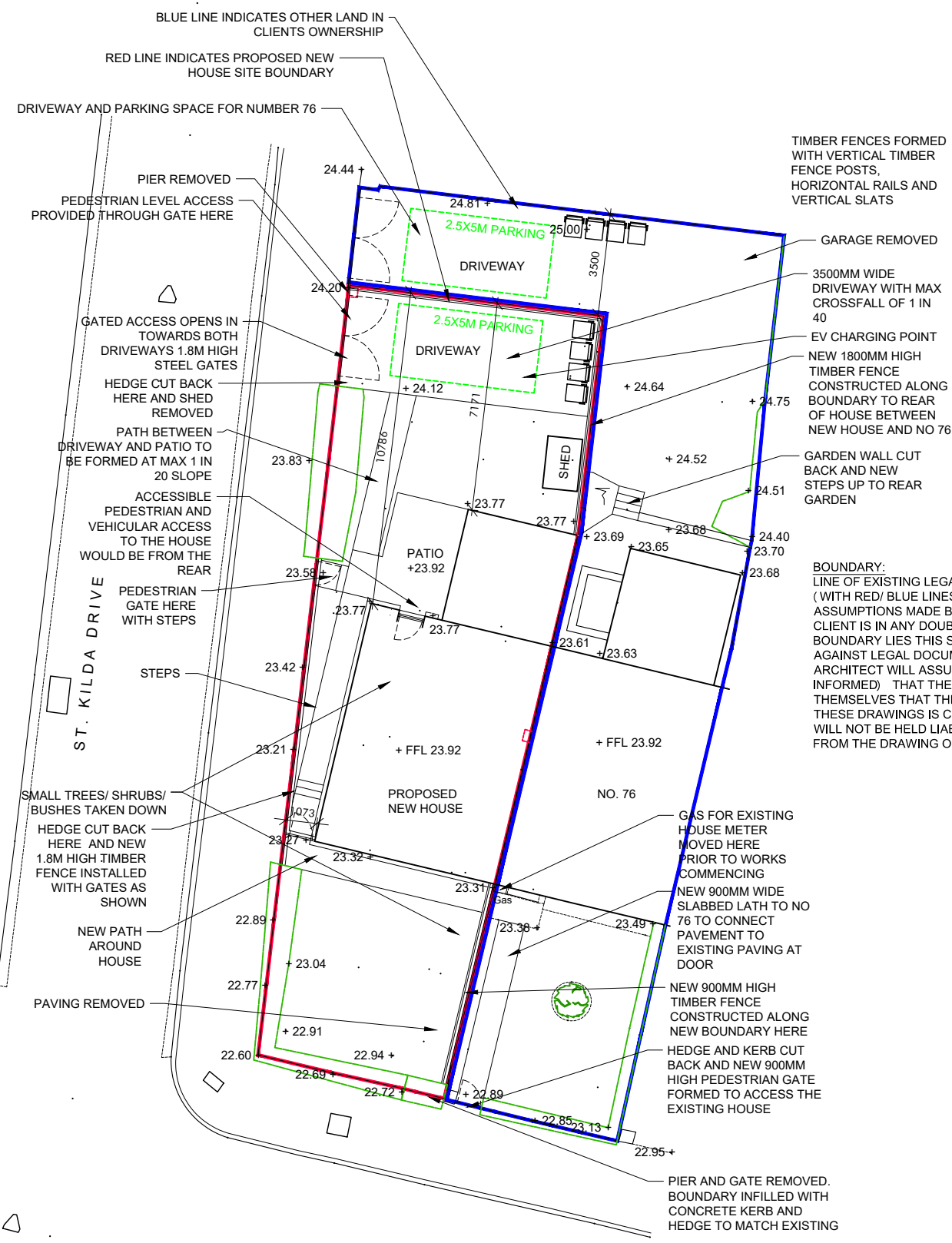
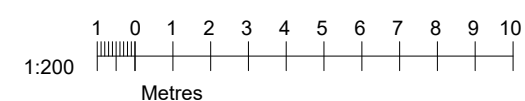

PROPOSED SITE PLAN 1:200

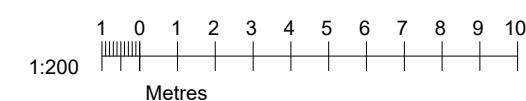

TIMBER FENCES FORMED WITH VERTICAL TIMBER FENCE POSTS, HORIZONTAL RAILS AND VERTICAL SLATS

BOUNDARY: LINE OF EXISTING LEGAL BOUNDARY HAS BEEN DRAWN (WITH RED/ BLUE LINES) BASED ON VARIOUS ASSUMPTIONS MADE BY THE ARCHITECT ON SITE. IF THE CLIENT IS IN ANY DOUBT AS TO WHERE THE LEGAL BOUNDARY LIES THIS SHOULD BE CHECKED BY CLIENT AGAINST LEGAL DOCUMENTS FOR THE PROPERTY. THE ARCHITECT WILL ASSUME, (UNLESS OTHERWISE INFORMED) THAT THE CLIENT HAS SATISFIED THEMSELVES THAT THE LEGAL BOUNDARY SHOWN ON THESE DRAWINGS IS CORRECT. A:B STUDIO ARCHITECTS WILL NOT BE HELD LIABLE FOR ANY ISSUES ARISING FROM THE DRAWING OF INCORRECT LEGAL BOUNDARIES

SERVICES/ DRAINAGE  
IT IS INTENDED THAT A NEW SEPARATE DRAINAGE SYSTEM WILL CONNECT TO EXISTING SEWER. NEW SERVICES CONNECTIONS WILL BE FORMED FOR POWER, TELECOMS AND WATER

**A:B Studio**  
Chartered Architects Ltd  
T: 0141 258 3680 M: 07816 350 736  
www.ab-architects.co.uk  
colin.thompson@ab-architects.co.uk  
32 Langside Place, Glasgow, G41 3DL

---

CLIENT: JENNY SMILLIE  
PROJECT: NEW HOUSE AT 76 MITRE ROAD  
DRAWING TITLE: SITE PLANS  
DRAWING STATUS: PLANNING  
DATE: 31-08-23 DRAWING NO: 19032/02D SCALE: 1:200@A3