

SITE AREA		
	ACRES	HECTARES
OVERALL SITE BOUNDARY	2.06	0.84
SITE APPLICATION BOUNDARY	0.05	0.02

Architects are to be notified of any discrepancies. Contractors must check all dimensions on site. This drawing is subject to copyright laws and is to be used only for the information as stated only. For other information refer to the latest revision of any other referenced drawings. To be read in conjunction with relevant design standards/provisions.

This is a colour drawing. In order to ensure any subsequent reproduction is viewed correctly it should be printed in full colour.

PARKING PROVISION

	EXISTING	PROPOSED
STANDARD SPACES	134	134
PARENT & CHILD SPACES	5	5
ACCESSIBLE SPACES	10	10
EVC SPACES	8	8
TOTAL	157	157

— PROPOSED STRUCTURES/ELEMENTS
 - - - STRUCTURES/ELEMENTS TO BE REMOVED/DEMOLISHED

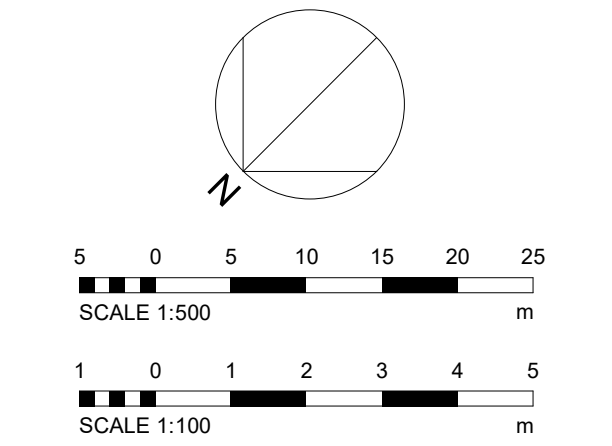

ROAD MARKING TO CARPARK SCOPE:

AREA LOWER CARPARK FROM STORE ENTRANCE TO TOP OF CARPARK AND SPACES ALONG TIMBER FENCE ADJACENT TO YARD.

- PAINT ALL PARKING SPACES LIKE FOR LIKE
- BURN OFF CROSS HATCHING & LOGOS IN ACCESSIBLE & P&C BAYS (DO NOT REINSTATE)
- REPAINT LOGOS TO CURRENT STANDARDS
- INSTALL WALKWAY TO CENTRAL TO THE YARD END.
- ADD WALKING PERSON
- CROSSING - PAINT LIKE FOR LIKE
- YELLOW LINING - REPAINT AROUND FRONT OF STORE ONLY
- WAYFINDING - REPAINT ON FOOTPRINT

AREA HATCHED SHOWS EXTENT OF CARPARK WHITE LINING REPAINTING SCOPE

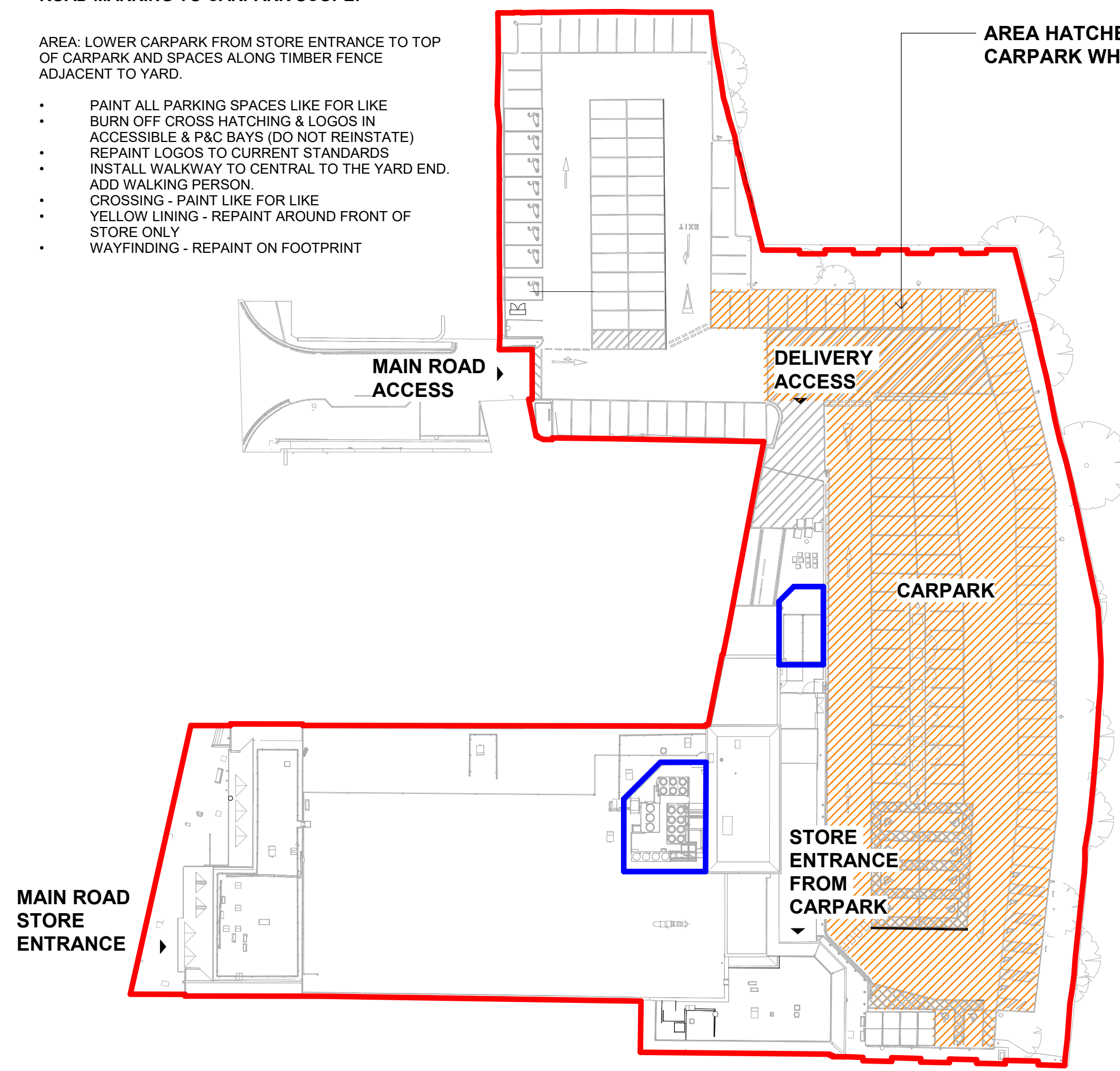

2 ROAD MARKING TO CARPARK KEY PLAN
 1:500

DASH LINE INDICATE CASH MACHINE BELOW ROOF

FLOOR/WALL-MOUNTED TROLLEY HOOPS TO BE REMOVED - ALLOW MAKING GOOD TO PAVING & WALL (BELOW ROOF)

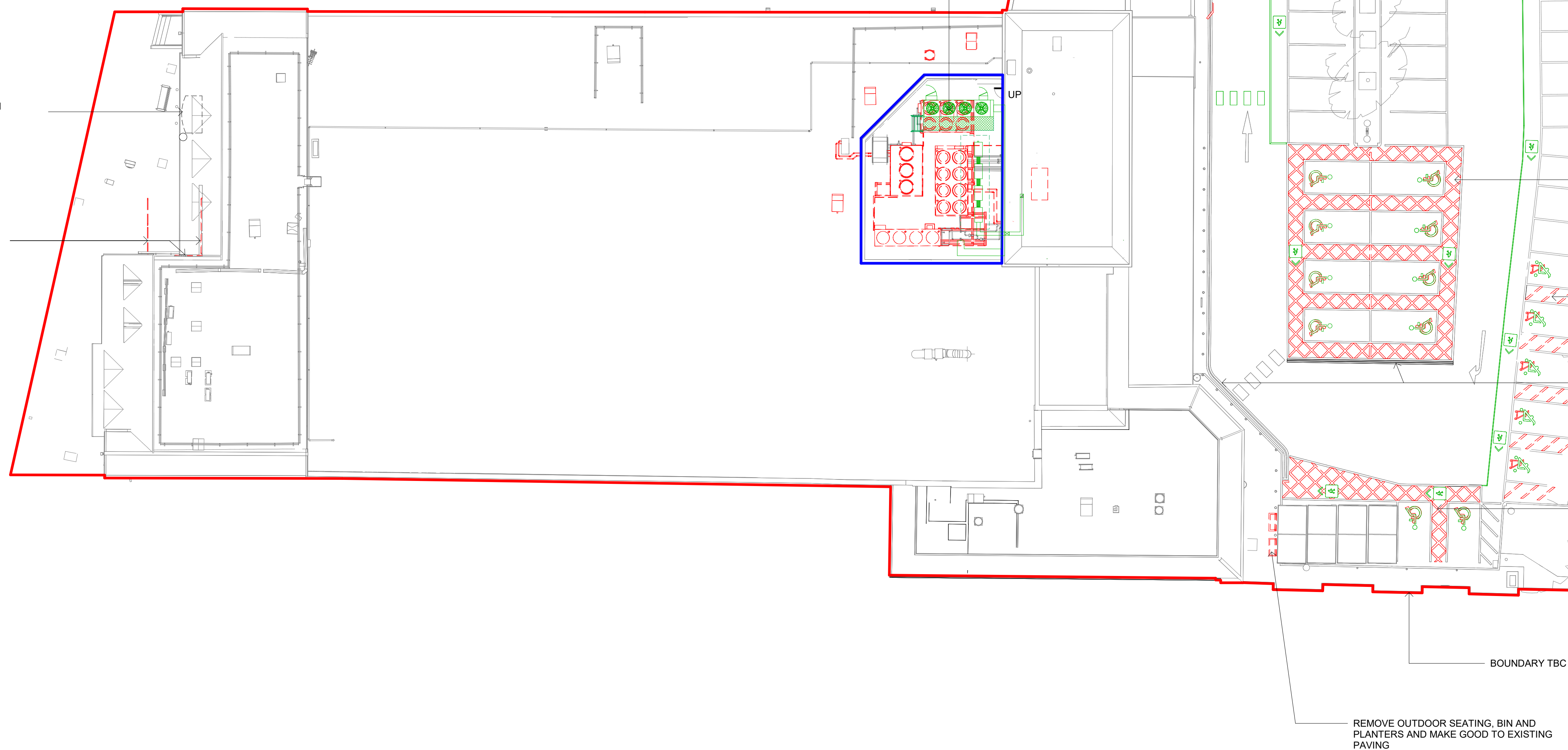

C1 PLANNING ISSUE 20/02/24 MN DM
 Rev Description Date Dm Dm Cmt

Status
 PLANNING



Floor 2, The Exchange, Station Parade, Harrogate, HG1 1TS
 01423 707 757 admin@smrarchitects.co.uk

Project
 Waitrose Biggin Hill

Client
WAITROSE & PARTNERS

Drawing Title
 PROPOSED SITE PLAN (PLANNING)

Proj Ref	Origin	Zone	Level	Type	Rate	Norm	Status	Rev
240_06675	SMR	CR	ZZ	DR	A	2006	AL	C1
SMR Job Ref	Sheet	Scale	Drawn					
7635-CR-2006	A0	NOTED	DM					