

PART PLAN OF LOADING DOCK
(SCALE 1:100)

- NOTES:**
- NEW RAISED CONCRETE PLINTHS TO BE MIN 150mm THICK AND CAST TO PROVIDE A LEVEL SURFACE FOR NEW PLANT IN UNLOADING BAY AREA. (CONTRACTOR TO CARRY OUT SMALL TRIAL HOLE PRIOR TO CASTING SLAB TO DETERMINE SURFACE BUILD-UP)
 - LOCATION AND EXTENT OF SLAB TO SUIT PLANT SIZES & SETTING OUT (TO SERVICES CONSULTANTS DETAILS). PLINTH SIZES SHOWN ARE BASED ON OAKSMERE DWG 240_08675-OAK-CR-ZZ-DG-H. CONTRACTOR TO VERIFY LATEST PLANT PROPOSALS PRIOR TO SETTING OUT PLINTH FORMWORK.
 - EXTENT OF PLINTHS MUST WHEREVER POSSIBLE AVOID EXISTING YARD DRAINAGE & OTHER SERVICES CHAMBERS CONTRACTOR TO COORDINATE ON SITE. (WHERE THEY CLASH, PLINTHS TO BRIDGE OVER EXISTING DRAINAGE CHANNELS, WHILST RETAINING FULL ACCESS FOR FUTURE MAINTENANCE)
 - CRASH BARRIERS FENCING AND SECURITY FENCING SURROUNDING PLANT TO DETAILS BY OTHERS
 - ALL REINFORCEMENT TO HAVE 50mm COVER
 - CONCRETE TO BE GRADE C32/40

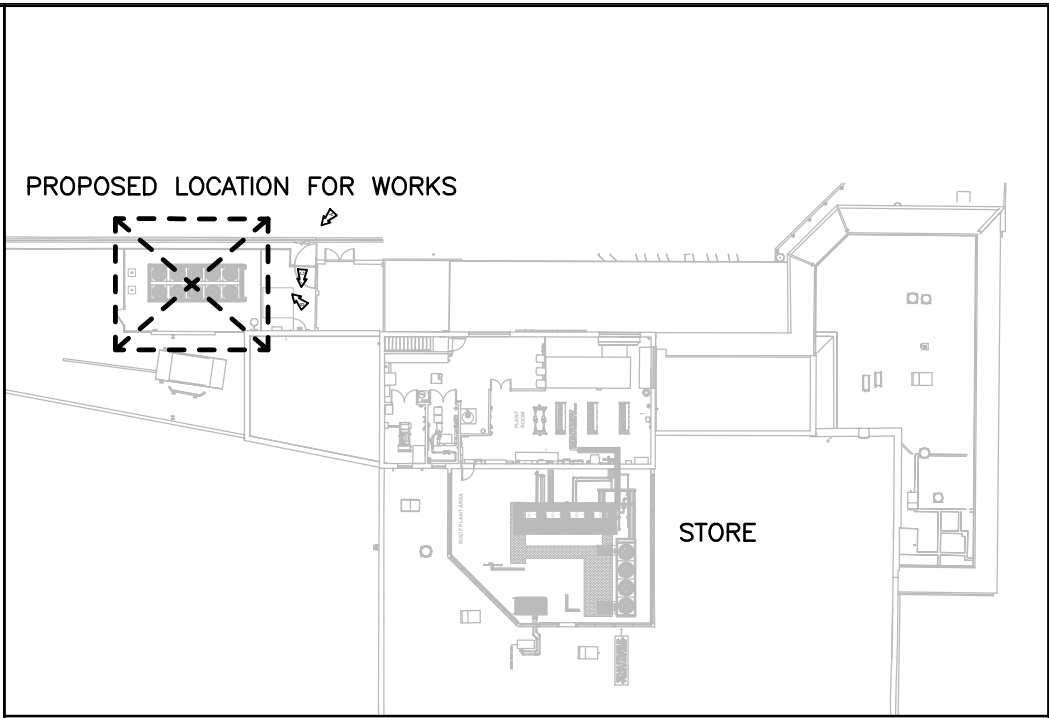

KEY PLAN

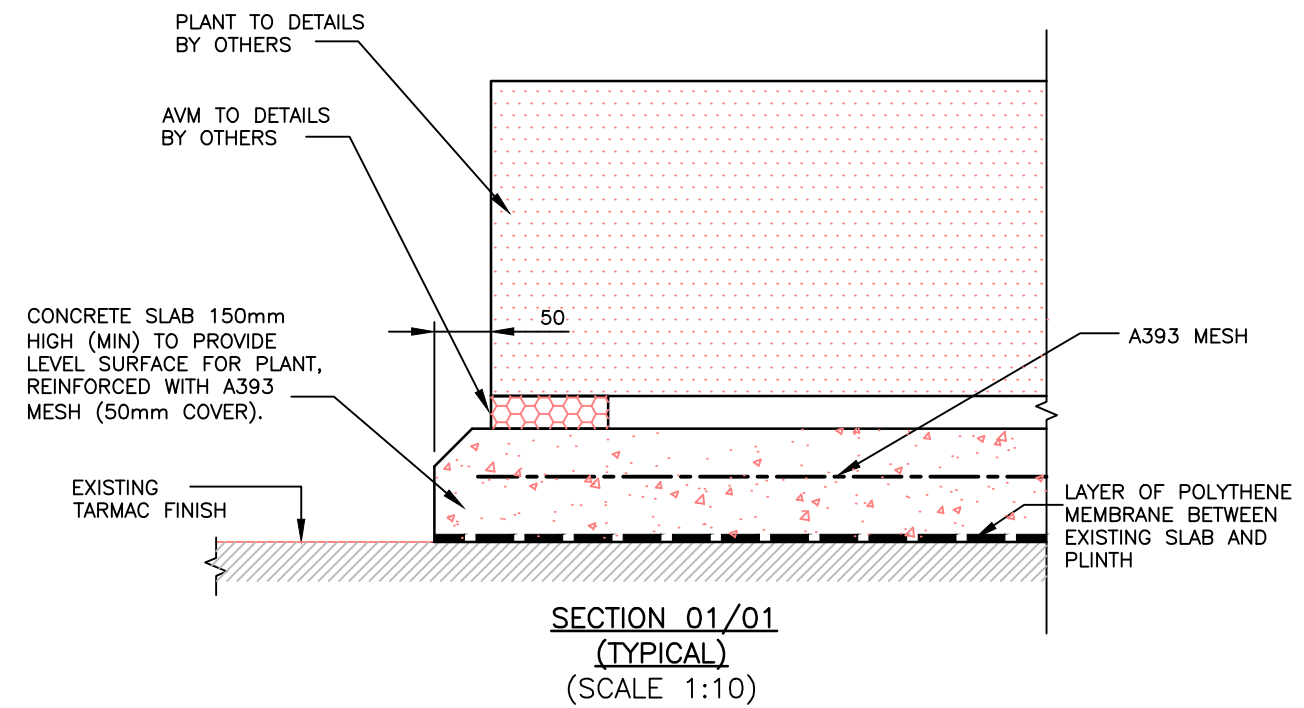

SECTION 01/01
(TYPICAL)
(SCALE 1:10)

CONCERTO REFERENCE: 240-08675-HPM-CR-00-DG-S-09-Adf2-T01

- NOTES**
- THIS DRAWING IS TO BE READ IN CONJUNCTION WITH ALL RELEVANT DRAWINGS, DETAILS AND SPECIFICATIONS.
 - CDM DETAILS REFERS TO THE CONSTRUCTION (DESIGN AND MANAGEMENT) REGULATIONS. THE READER MUST REFER TO METHOD STATEMENTS OR RISK ASSESSMENTS AS APPROPRIATE, WHICH IDENTIFY UNUSUAL AND ABNORMAL RISKS THAT A COMPETENT CONTRACTOR COULD NOT BE EXPECTED TO ANTICIPATE.

CDM DETAILS (Refer note 2)		ENG	
NONE BEYOND THOSE WHICH A COMPETENT CONTRACTOR SHOULD BE ABLE TO ANTICIPATE.		JP	
T01	ISSUED FOR TENDER	JI	FT
		JRP	09 02 24
No	Revision	By	Chk'd
		Passed	Date

Hurst Peirce + Malcolm LLP
CONSULTING CIVIL & STRUCTURAL ENGINEERS

HPM

CELTIC HOUSE
33 JOHN'S MEWS
HOLBORN
LONDON WC1N 2QL

©
TEL: 020 7242 3593
FAX: 020 7405 5274

E-MAIL: enquiries@hurstpm.co.uk
WEB PAGE: www.hurstpm.co.uk

Architect	SMR ARCHITECTS
Project	WAITROSE BIGGIN HILL L4L 2024
Status	TENDER
Scale	AS SHOWN @ A3

Title LOADING DOCK DAC PLANT PLINTH DETAILS			
Drawn DB	Checked JP	Passed JRP	Date JAN 2024
Drawing No. 26480-11			T1