

ZOLL AED 3

Professional Technology for Everyone

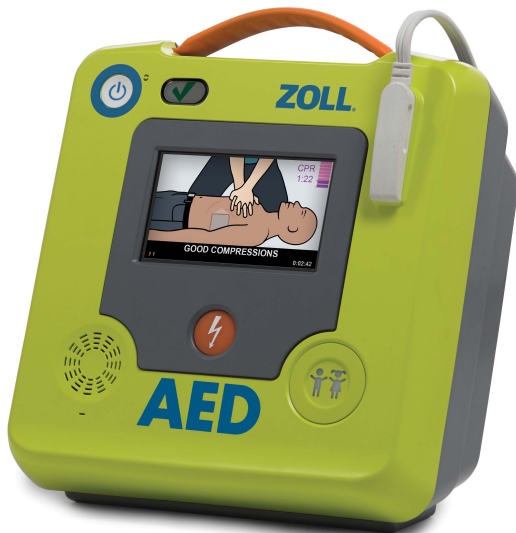

ZOLL

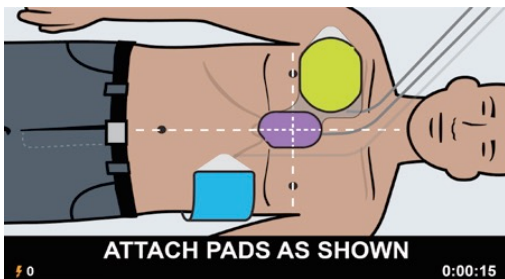
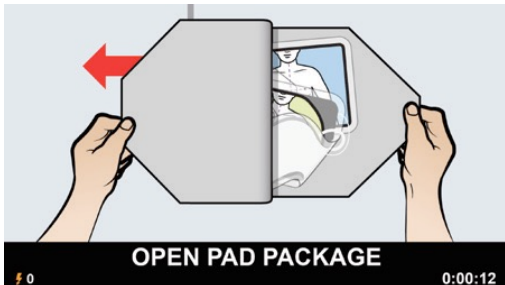

Introducing a new defibrillation platform from ZOLL that builds on their reputation for providing rescuers with unmatched support plus a low total cost of ownership:

Real-time CPR Feedback

Like all of ZOLL's professional defibrillators, the AED 3 is equipped with Real CPR Help technology to help lay rescuers perform high-quality CPR. The sensor in the pads lets the AED see your chest compressions so it can guide you to the proper rate and depth with prompts and an on-screen bar gauge.

Real CPR Help instils confidence by guiding rescuers' compressions to the right rate and depth

Sooner Is Better

At 8 seconds with a fresh battery, the AED 3 is among the fastest at delivering a shock after chest compressions stop. Research shows that minimising time to shock after the CPR cycle ends may improve survival. The 2015 ERC Guidelines notes, "The delay between stopping chest compressions and delivery of the shock (the pre-shock pause) must be kept to an absolute minimum; [any] delay will reduce the chances of the shock being successful."

Easy to Use

Clear, colourful graphic images combine with audio prompts to step you easily and precisely through the rescue.

Every AED comes supplied with a Rescue Accessory Pack that is attached to Universal CPR Uni-padz™, and contains non-latex gloves, barrier mask, razor, towlette, and scissors for easy removal of clothing.

Leading Technology. Reasonable Cost.

Once installed, the AED 3 costs significantly less than almost any other AED to maintain. Because the CPR Uni-padz can defibrillate both children and adults and because the CPR Uni-padz and the battery both last five years this means fewer replacements and lower costs.

No other AED's paediatric pads last 5 years. No other AED lets rescuers rescue a child at the push of a button, and replace pads and battery only once in the first 10 years of service.

AED warranty: 8 years

The 'People-Heart' logo, DefibShield logo, cPAD logo, VETS logo and CHT logo are trademarks of the Community HeartBeat Trust

Registered charity number 1132824

www.communityheartbeat.org.uk 0845 86 27739



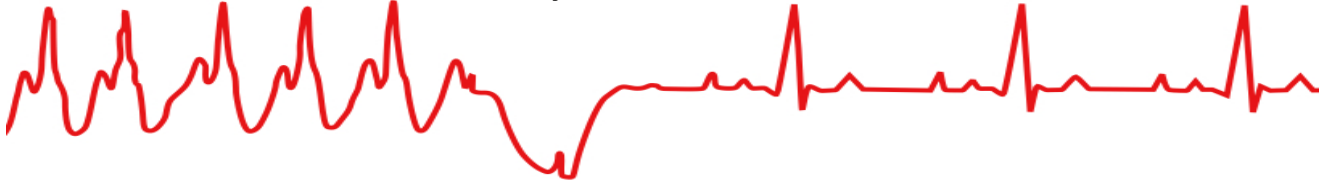

- **Defibrillator Models:** Semiautomatic and Fully Automatic
- **Energy Selection:** Factory preprogrammed selection (Adult: 120 J, 150 J, 200 J; Child: 50 J, 75 J, 85 J)
- **Charge Time:** Less than 10 seconds with new battery
- **Pre-shock Pause:** 8 seconds with new battery
- **Self-test:** Configurable automatic self-test every day or every 7 days. Default: every 7 days. Monthly full-energy test (200 J).
- *Automatic Self-test Checks:* Battery capacity, status and expiration; electrode connection and expiration; ECG and charge/ discharge circuits; microprocessor hardware and software; CPR circuitry and pads sensor; audio circuitry
- **Compression Depth :**1.9 cm to 10.2 cm; 0.75 in to 4 in (adult patients only)
- **Display Format:** High-resolution LCD with capacitive touch panel
- **Display Screen Size:** 5.39 cm x 9.5 cm; 2.12 in x 3.74 in
- **Data Recording and Storage:** User-configurable for 1 or 2 clinical events for total of 120 minutes. Includes ECG, impedance measurements, device prompts and CPR data.
- **Data Recovery:** Controlled by touchscreen, uploaded to USB memory stick, or ZOLL Case Review™ over a Wi-Fi network
- **Device: Size:** (H x W x D) 12.7 cm x 23.6 cm x 24.7 cm; 5.0 in x 9.3 in x 9.7 in
- *Weight:* 2.5 kg; 5.5 lbs
- **Battery:** Standby Life (once installed): 5 years with weekly
- *Type:* Disposable, sealed lithium manganese dioxide
- **Electrodes:** ZOLL CPR Uni-padz™ Shelf Life: 5 years Combined Adult & Paediatric
- Attached Rescue Accessory Pack Contents: Non-latex gloves, a CPR barrier mask, razor, paper towel, and towelette.
- **Particle and Water Ingress:** IP55
- **Drop Test:** 1 metre; 3.28 feet

