

1 DUDLEY ROAD

ROWLEY REGIS. B65 8JH

- KEY:
- existing walls
 - new walls
 - removed walls
 - retail unit 01
 - retail unit 02
 - retail unit 03
 - retail unit 04
 - flat entrance
 - store

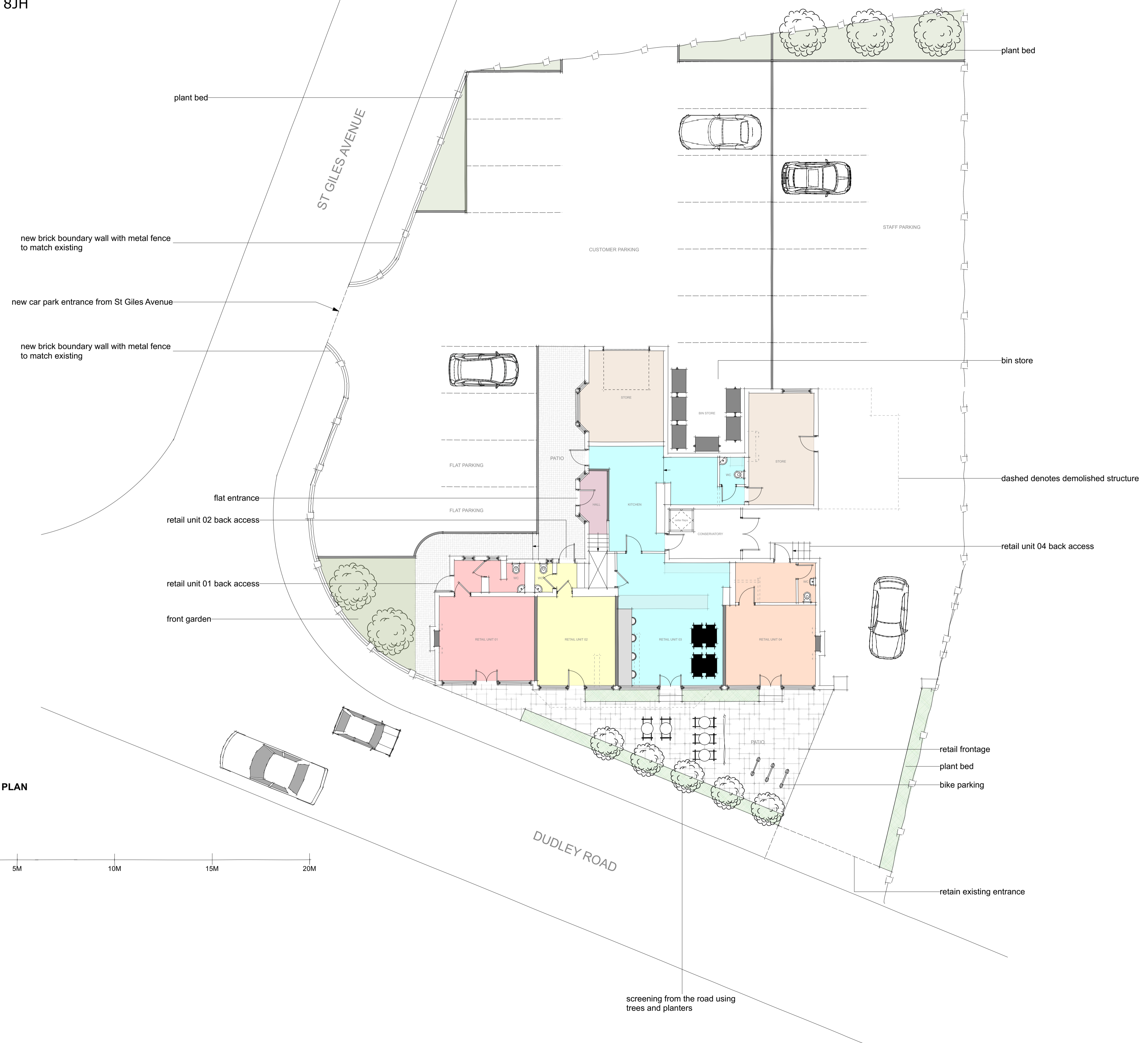

GROUND FLOOR PLAN
Scale 1:100 @ A1

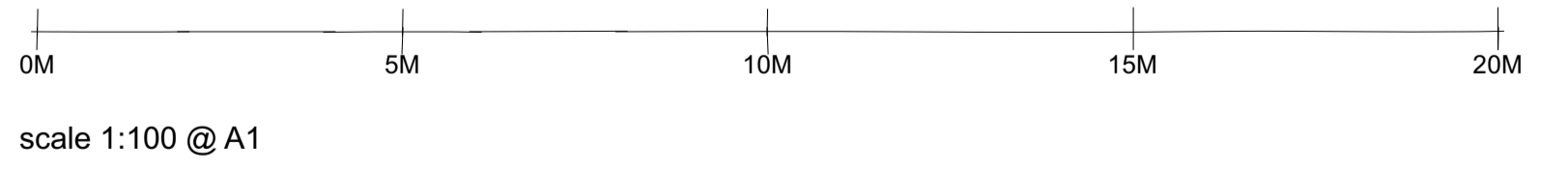

IDAFA
ARCHITECTS

AS PROPOSED

NOTE:
the client is advised of their duty under the party wall act 1996 to serve notice upon their neighbours minimum 2 months prior to any construction work on site.
the Architect is the "author and owner" such that the architect retains all rights, including copyrights, to these documents