



This drawing is to be used for planning purposes only. Not for construction.

This drawing is the property of Richard Parr Associates. Copyright is reserved by them and the drawing is issued on the condition that it is not copied, reproduced, retained or disclosed to any unauthorised person, either wholly or in part without written consent.

© Copyright Richard Parr Associates

Checked by  
.....

Drawn by  
.....

Date  
.....

Description  
.....

Rev  
.....

Job No  
315

Project  
West Bradley House

Title  
Existing Ground Floor Plan

Drng No 315-SB-00-010-P1

Scale 1:50@A1, 1:100@A3

Date of First Issue March 2024

Status Planning

**Key**  
[Red Box] Proposed Demolition  
[Grey Box] Salvaged Fabric

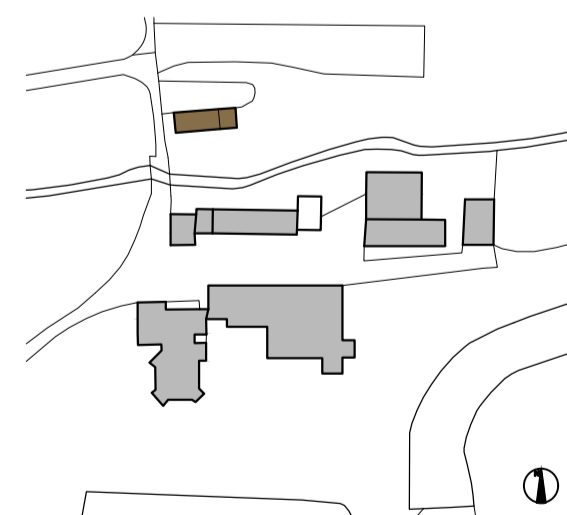

**RICHARD PARR ASSOCIATES**

studio@richardparr.com  
+44 (0)1453 860200  
richardparr.com  
@richardparrassociates

+  
COUNTRY  
Eaister Park  
Nympsfield, Stonehouse  
Gloucestershire GL10 3UL

TOWN  
The People's Hall  
Studio 5, 2 Olaf Street  
London W11 4BE

BL Beam Level  
CL Ceiling Level  
FL Floor Level  
DP Down Pipe  
HWC Hot Water Cylinder  
SVP Soil Vent Pipe  
RWP Rain Water Pipe  
RWO Rain Water Outlet

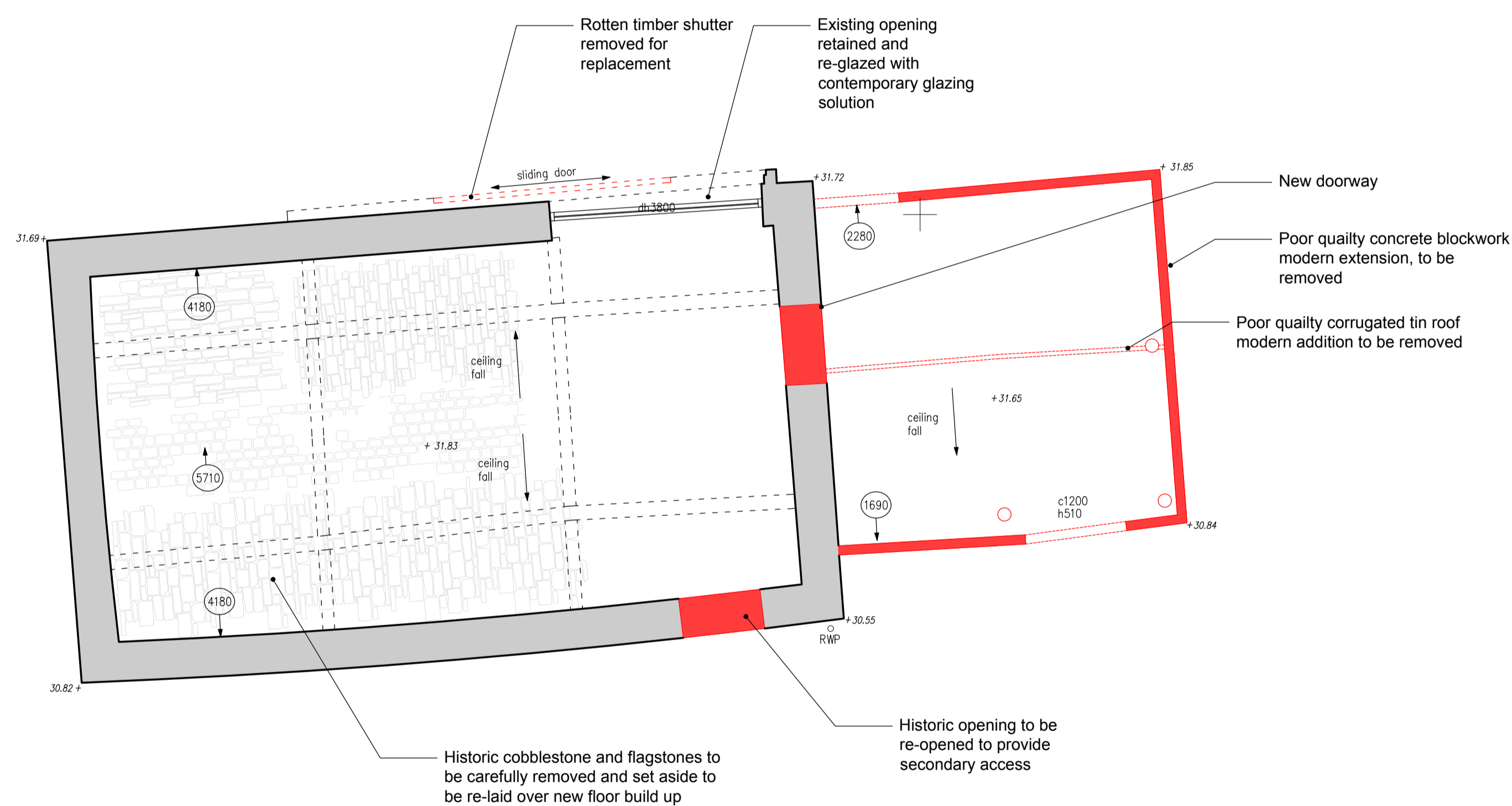
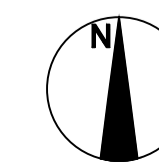

01 Existing Ground Floor Plan  
1:50@A1, 1:100@A3

