

01 Proposed Second Floor Plan  
1:50@A1, 1:100@A3

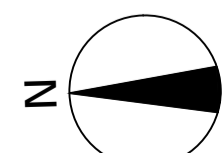

LEGEND

	Proposed Walls
	Existing Walls

Floor Build-up key:

- |   |  |
|---|--|
| <p><b>01</b></p> <ol style="list-style-type: none"> <li>Lath + plaster extg ceiling finish</li> <li>Extg 200mm joists strengthened with sistered joists</li> <li>100mm 60kg/m3 density rockwool between joists</li> <li>Heavy pugging on plywood shelf on noggins fixed to side of joists</li> <li>Pre-routed foil board with wet fed UFH pipes on compacted pugging</li> <li>Impact joist strips adhered to joists and extg floorboards re-instated to original FFL</li> </ol> <p><b>02</b></p> <ol style="list-style-type: none"> <li>Compacted sand binding on compacted Type 1</li> <li>New poured re-inforced concrete slab</li> <li>Damp proof membrane</li> <li>140mm PIR insulation</li> <li>80mm screed inlaid with wet fed UFH</li> <li>Extg flagstones re-instated</li> </ol> <p><b>03</b></p> <ol style="list-style-type: none"> <li>Compacted sand binding on compacted Type 1</li> <li>New poured re-inforced concrete slab</li> <li>Damp proof membrane</li> <li>140mm PIR insulation</li> <li>80mm screed inlaid with wet fed UFH</li> <li>Timber or stone tile floor finish TBC</li> </ol> | <p><b>04</b></p> <ol style="list-style-type: none"> <li>Extg oak timbers to be retained on existing steel posts</li> <li>New timber joists mechanically hung between extg beams at 400mm ctrs flush to top of extg beams</li> <li>100mm 60kg/m3 rockwool between joists</li> <li>Pre-routed foil board with wet fed UFH pipes on new plywood shelf sitting on noggins fixed to joists</li> <li>Impact joist strips adhered to joists</li> <li>New 25mm plywood subfloor screwed at 150mm ctrs</li> <li>New floor finish TBC</li> </ol> <p><b>05</b></p> <ol style="list-style-type: none"> <li>Double acoustic plasterboard on resilient bars</li> <li>New steel structure with 200mm joists spanning in-between web of steels at 400mm ctrs</li> <li>100mm 60kg/m3 rockwool between joists</li> <li>Pre-routed foil board with wet fed UFH pipes on new plywood shelf sitting on noggins fixed to joists</li> <li>Impact joist strips adhered to joists</li> <li>New 25mm plywood subfloor screwed at 150mm ctrs</li> <li>New floor finish TBC</li> <li>Externally, a new 25mm ply sub-floor will support 140mm PIR insulation, waterproof membrane and stone paving slabs on pedestals.</li> </ol> |
|---|--|

General Notes:

- Building to be subject to full service upgrade including electric, lighting, plumbing, drainage etc. New SVPs, mechanical and electrical services to be installed through existing walls, floors and ceilings where required using chases, penetrations and risers, made good to match existing finishes.
- Redundant surface mounted services and boxing to be removed.
- Repairs or alterations to windows and doors to be carried out as required to match existing where retained. All retained window and door sets, including shutters and shutter boxes to be inspected for defect and damage and refurbished accordingly. New paneled timber shutters to match extg to be reinstated where missing.
- All extg windows and external doors to be fully draught-proofed and thermally upgraded.
- Modern joinery and wall panelling to be removed in general.
- Localised repair works to be carried out as required on further inspection to match existing materials and details.
- Rain water goods replaced with heritage cast iron goods.
- All building materials to be locally sourced where possible. All removed stonework and bricks to be set aside to store for potential reuse.
- All new stone elements, including new stone steps, plinths and cornices to be made from salvaged stonework as far as reasonably practicable.
- Structural steel and timbers to be checked and replaced where necessary.
- Areas around demolition to be made good to match existing.
- All ground floor flagstones to be labeled, recorded and carefully lifted to allow installation of new insulated floor slab and waterproofing. Flagstones to be relayed in original location as per record survey.
- Original skirting's to be repaired and reinstated. In case of damage/defect, skirting's to be replaced to match extg.
- All chimney flues and draws to be inspected internally and externally for defects and damage and repaired accordingly. All chimney pieces, hearths, mantels and chimney breasts to be inspected for defects and damage, repaired accordingly and cleaned.
- All extg stone walls and all stone elements including sills, steps, plinths, cornices, decorations, mouldings, stone/concrete/limber lintels, etc. to be inspected for defects and damage, repaired accordingly and lightly steam cleaned taking care of retaining historic patina. All missing/damaged elements to be replaced with new stone sections to match extg. Any damaged or loose stone to be repointed with lime mortar to match extg.
- All floor structures to be inspected for damage and defect and structurally strengthened or replaced where necessary.
- All floors to be acoustically upgraded.

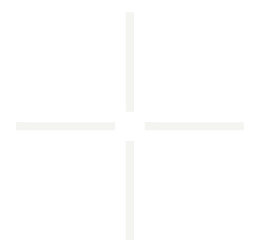

This drawing is to be used for planning purposes only. Not for construction.

This drawing is the property of Richard Parr Associates. Copyright is reserved by them and the drawing is issued on the condition that it is not copied, reproduced, retained or disclosed to any unauthorised person, either wholly or in part without written consent.

© Copyright Richard Parr Associates

Checked by

Drawn by

Date

Description

Rev

Job No

315

Project

West Bradley House

Title

Proposed Second Floor Plan

Drig No

315-315-MH-00-112-P1

Scale

1:50@A1, 1:100@A3

Date of First Issue

March 2024

Status

Planning

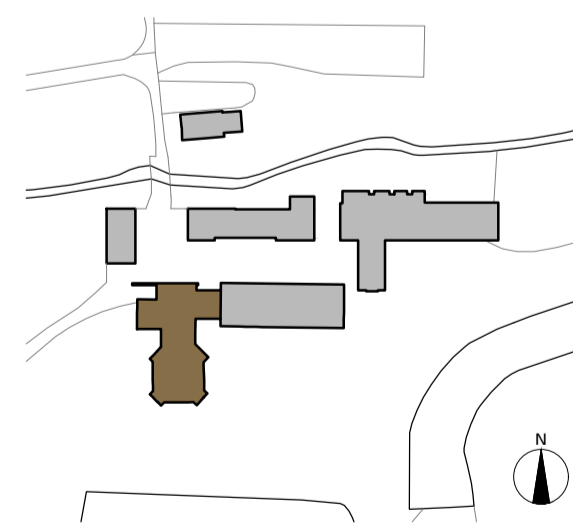

**RICHARD PARR ASSOCIATES**

studio@richardparr.com  
+44 (0)1453 860200  
richardparr.com  
@richardparrassociates

+ COUNTRY  
The People's Hall  
Nympsfield, Stonehouse  
Gloucestershire GL10 3UL

TOWN  
The People's Hall  
Studio 5, 2 Old Street  
London W11 4BE