

NEW PITCH ROOF IS TO BE SITE MEASURED, DESIGNED BY SPECIALIST AND DETAILS ARE TO BE SUBMITTED TO BUILDING CONTROL PRIOR TO THE FABRICATION OR THE ERECTION OF ANY MATERIALS

TIMBER RAFTERS AT 400-600 CENTRES TO BE DESIGNED BY SPECIALIST MANUFACTURER AND TO BE SUBMITTED TO LOCAL AUTHORITY BUILDING INSPECTOR PRIOR TO COMMENCEMENT OF ANY CONSTRUCTION WORKS. ALL WORKS TO COMPLY WITH BS 5268: PART 3: 1985.

WARM ROOFS TO BE INSULATED WITH MINIMUM 100MM KINGSPAN K107 INSULATION BETWEEN RAFTERS (PROVIDE MIN 50MM VENTILATION GAP ABOVE INSULATION IF VENTILATED ROOF) AND KINGSPAN K118 INSULATION UNDER RAFTERS (THICKNESS TO MEET TARGET U VALUE, ASSUMED 0.25MM + 12.5MM PLASTERBOARD IF ALL OTHER INSULATION SPECIFICATIONS ARE USED AS NOTED), TO PROVIDE A MINIMUM OVERALL U-VALUE OF 0.15W/M²K, TAKING IN TO ACCOUNT THERMAL BRIDGING ALL WITH INTEGRAL VAPOUR CONTROL LAYER OR VCL POSITIONED BEHIND THE PLASTERBOARD, PLASTERBOARD # 5KIM FINISH TO ALL CEILING.

RAFTER TO BE TRIMMED AND 'DOUBLED UP' FOR FORMING OF VELUX OPENINGS

PROVIDE NEW 300/302mm THICK WALL TO ACHIEVE A U-VALUE OF 0.18w/m² COMPRISING OF 100mm LIGHTWEIGHT THERMAL BLOCKWORK INNER SKIN (UNLESS ALTERNATIVE IS SPECIFIED BY ENGINEER), 100mm INSULATED CAVITY (90MM KINGSPAN KOOLTHERM K106 WITH 10MM RESIDUAL GAP) AND EXPOSED LEAVES TO BE BRICKWORK TO MATCH EXISTING.

PLEASE NOTE ALTERNATIVE INSULATION SPECIFICATIONS MAY REQUIRE ENLARGED CAVITIES OR INSULATED PLASTERBOARD.

MINIMUM OF 2NO COURSES OF BRICKWORK BELOW GROUND

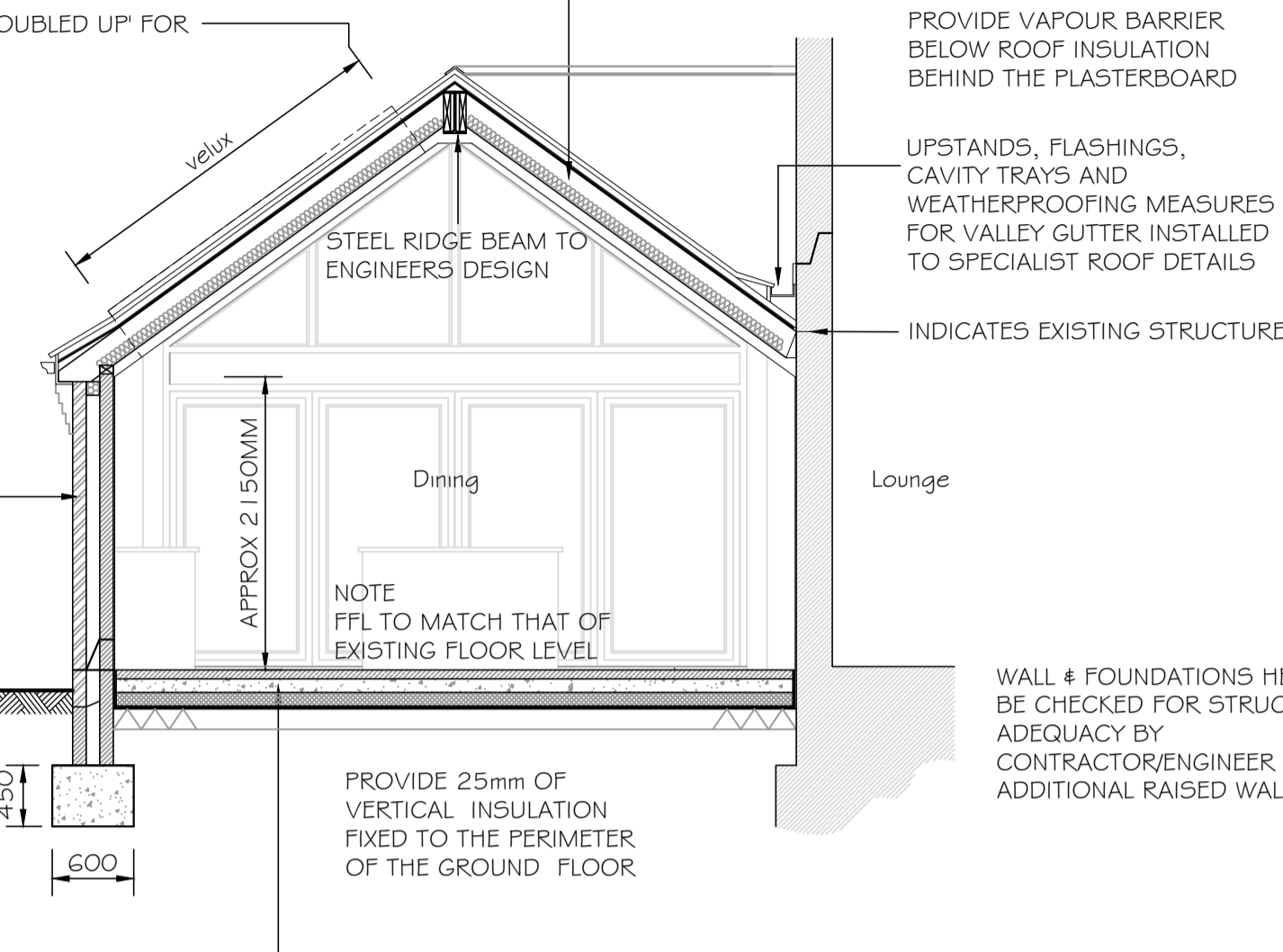

PROVIDE VAPOUR BARRIER BELOW ROOF INSULATION BEHIND THE PLASTERBOARD

UPSTANDS, FLASHINGS, CAVITY TRAYS AND WEATHERPROOFING MEASURES FOR VALLEY GUTTER, INSTALLED TO SPECIALIST ROOF DETAILS

WALL & FOUNDATIONS HERE TO BE CHECKED FOR STRUCTURAL ADEQUACY BY CONTRACTOR/ENGINEER FOR ADDITIONAL RAISED WALLS

FLAT ROOF UPSTANDS AND WEATHERPROOFING MEASURES INSTALLED TO SPECIALIST ROOF DETAILS

ROOF LANTERN BY SPECIALIST MANUFACTURER

DOUBLED UP TIMBERS TO SUPPORT LANTERN ALL TO ENGINEERS DESIGN

NOTE FFL TO MATCH THAT OF EXISTING FLOOR LEVEL

PROVIDE 25mm OF VERTICAL INSULATION FIXED TO THE PERIMETER OF THE GROUND FLOOR

Section 2-2 Through Extension (scale 1:50)

GROUND FLOOR TO GIVE A U VALUE OF 0.18 WM² AND TO COMPRISE OF MINIMUM 65mm SAND / CEMENT SCREED 100-150mm DEEP CONCRETE SLAB (TO ENGINEER DESIGN) ON MINIMUM 100mm KINGSPAN KOOLTHERM K103 INSULATION FLOOR BOARD INCLUDING VAPOUR LAYER TO WARM SIDE OF INSULATION (BASED ON CURRENT DESIGN AND AREA/PERIMETER CALC) ON 1200 GAUGE 'VISQUEEN' DPM ON 150mm SUB-BASE, FLOOR LEVELS TO RUN THROUGH.

THE DAMP PROOF MEMBRANE IS TO BE A COMBINED RADON GAS MEMBRANE AND IS TO BE TAPED AND SEALED. JOINT POSITIONED AT SLAB EDGE TO AVOID SLIP PLANE AT WALL / SLAB JUNCTION

Section 1-1 Through Extension (scale 1:50)

PROVIDING GROUND CONDITIONS ARE OF AN ADEQUATE NATURE THEN EXCAVATE 600mm WIDE x 450mm DEEP TRENCH FILL FOOTINGS TO EXTERNAL WALLS (UNLESS NOTED OTHERWISE), FINAL DEPTH AND SIZE TO BE AGREED ON SITE WITH LOCAL AUTHORITY BUILDING INSPECTOR.

THE FORMATION DEPTH OF THE FOUNDATIONS IS TO BE DOWN TO A FIRM LOAD-BEARING STRATA TO FORM A STABLE FOUNDATION. THE MIN. DEPTH IS TO BE 1000mm IN MEDIUM SHRINKABLE CLAYS. ALL FINAL DEPTHS AND PROTECTIONS OF FOOTINGS ARE TO BE AGREED ON SITE BETWEEN THE LOCAL AUTHORITY BUILDING INSPECTOR AND THE BUILDING CONTRACTOR.

GENERAL NOTE

ALL WORKS ARE TO COMPLY WITH CURRENT BUILDING REGULATIONS ALL MATERIALS AND COMPONENTS ARE TO COMPLY WITH CURRENT BRITISH STANDARDS AND ARE TO BE INSTALLED STRICTLY IN ACCORDANCE WITH THE MANUFACTURERS INSTRUCTIONS AND CURRENT CODES OF PRACTICE. THE CONTRACTOR IS TO CHECK ALL DIMENSIONS AND DETAILS PRIOR TO THE PROCUREMENT, FABRICATION OR ERECTION OF ANY COMPONENTS AND PRIOR TO THE COMMENCEMENT OF ANY CONSTRUCTION WORKS

ELECTRICAL WORKS

ALL ELECTRICAL WORK IS TO MEET THE REQUIREMENTS OF PART P (ELECTRICAL SAFETY) MUST BE DESIGNED, INSTALLED, INSPECTED AND TESTED BY A PERSON COMPETENT TO DO SO. PRIOR TO COMPLETION OF THE WORKS THE LOCAL AUTHORITY MUST BE SATISFIED OF COMPLIANCE WITH PART P THIS MAY REQUIRE AN APPROPRIATE BS7671 ELECTRICAL INSTALLATION CERTIFICATE TO BE ISSUED FOR THE WORKS BY A PERSON COMPETENT TO DO SO.

FEATURE GLAZING TO SPECIALIST DESIGN WITH ALL FINALISED STEEL ARRANGEMENT TO BE COORDINATED

MINIMUM OF 2NO COURSES OF BRICKWORK BELOW GROUND

PROVIDE 25mm OF VERTICAL INSULATION FIXED TO THE PERIMETER OF THE GROUND FLOOR

Section 3-3 Through Extension (scale 1:50)

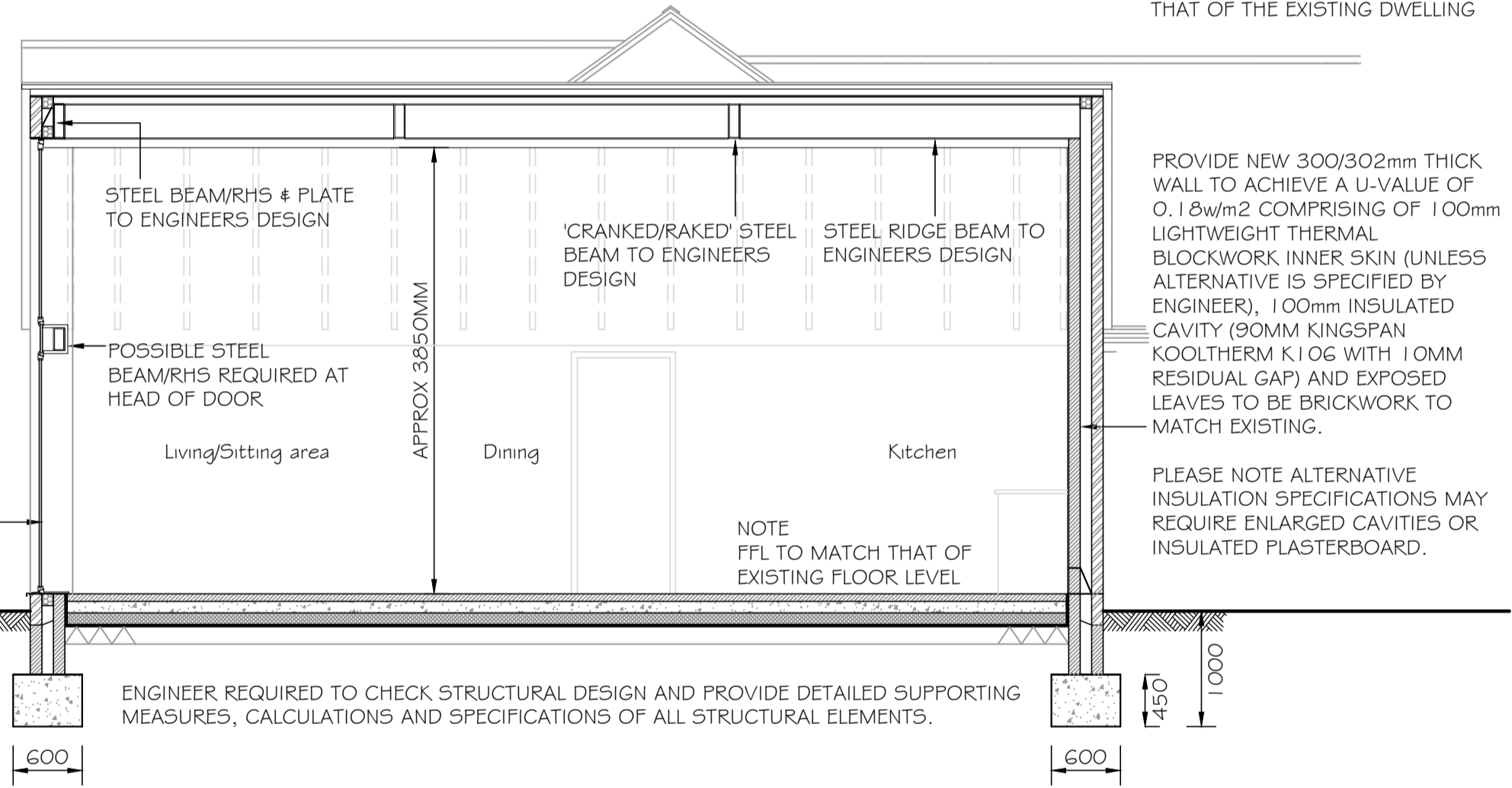

PROVIDE NEW 300/302mm THICK WALL TO ACHIEVE A U-VALUE OF 0.18w/m² COMPRISING OF 100mm LIGHTWEIGHT THERMAL BLOCKWORK INNER SKIN (UNLESS ALTERNATIVE IS SPECIFIED BY ENGINEER), 100mm INSULATED CAVITY (90MM KINGSPAN KOOLTHERM K106 WITH 10MM RESIDUAL GAP) AND EXPOSED LEAVES TO BE BRICKWORK TO MATCH EXISTING.

PLEASE NOTE ALTERNATIVE INSULATION SPECIFICATIONS MAY REQUIRE ENLARGED CAVITIES OR INSULATED PLASTERBOARD.

ENGINEER REQUIRED TO CHECK STRUCTURAL DESIGN AND PROVIDE DETAILED SUPPORTING MEASURES, CALCULATIONS AND SPECIFICATIONS OF ALL STRUCTURAL ELEMENTS.



Proposed Internal Visuals (n.t.s)

PROVIDE MONAPERM 500 BREATHABLE ROOFING TILE UNDERLAY SUITABLE FOR USE WITHOUT ROOF VENTILATION.

PROVIDE AT LEAST 20mm SPACE ABOVE THE ROOF INSULATION TO ALLOW THE BREATHER FELT TO SAG OR A BATTEN WILL REQUIRE PLACING ON TOP OF RAFTER BEFORE TILE LATTIS ARE FITTED

THE TILE SPECIFICATION IS TO MATCH THAT OF THE EXISTING DWELLING

ALL NEW WALLS ARE TO HAVE BITUMINOUS FELT DPC'S OR SIMILAR TO BS743 A MINIMUM OF 150mm ABOVE FINISHED GROUND LEVEL.

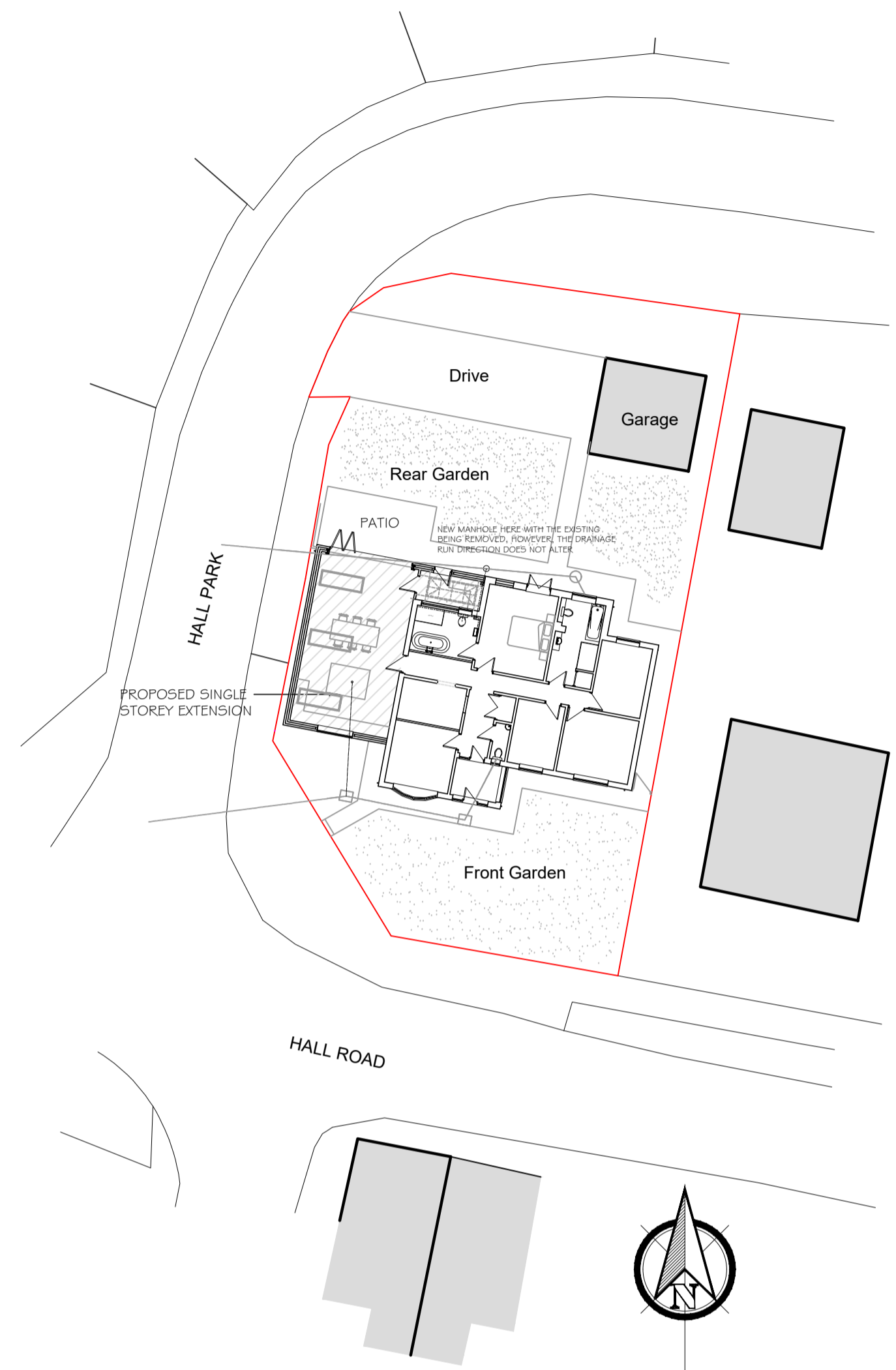

Proposed Site Plan (scale 1:250)

Revision	Amendment	Date
A	Design revised to clients specifications	04/24

Client:

Project: Proposed Extensions and Alterations
25 Hall Road
Great Hale
Lincolnshire

Dwg Title: Proposed Sections and Site Plan

Dwg No: 233272-03A
Scale: 1:50
Date: 01/24

Rick Smith Design
Architectural Design Consultancy

Ardent House, 18 Eastgate
Sleaford, Lincolnshire NG34 7DP
Tel: 01529 414363 or 07786 838788
e-mail: rick@ricksmithdesign.com