

First floor plan | proposed

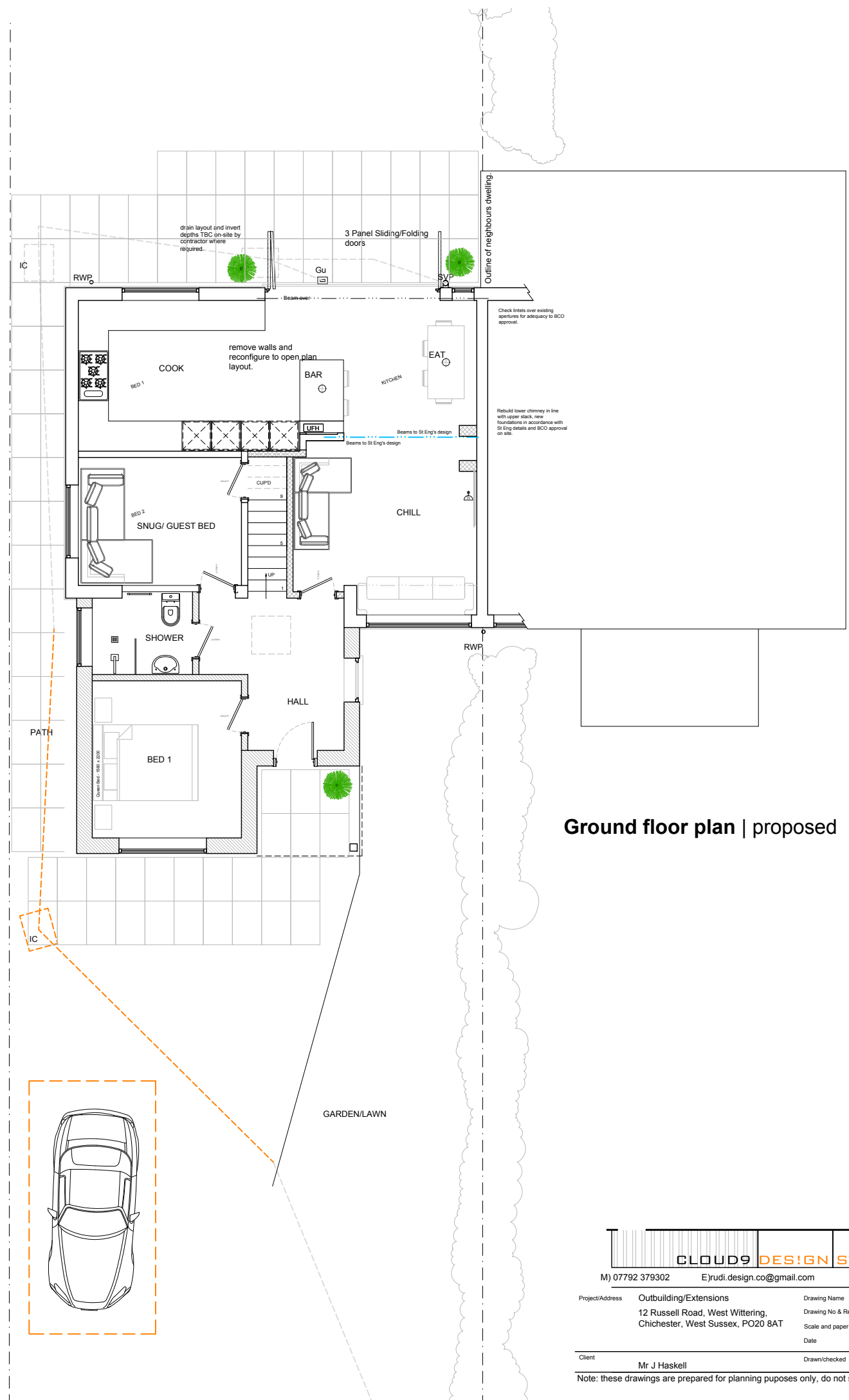

Ground floor plan | proposed

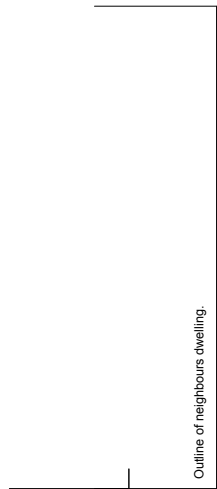

05 Proposed Plans



- Extensions
- Infill and alterations
- Existing walls
- Areas with headroom under 1.5m
- demolition/walls removed

CLOUD9 DESIGN STUDIO

M) 07792 379302 E)rudi.design.co@gmail.com w)cloud9designstudio.co.uk

Project/Address	Outbuilding/Extensions 12 Russell Road, West Wittering, Chichester, West Sussex, PO20 8AT	Drawing No & Rev	Proposed Plans C9/0238/05
Scale and paper	1:100 @ A3	Date	February 2023
Client	Mr J Haskell	Drawn/checked	Rudi

Note: these drawings are prepared for planning puposes only, do not scale for any other purpose.

PROPOSED PLAN