

FFL +6.94

FFL +3.30

Section AA as Existing
1:20

FFL +6.94

FFL +3.30

Section AA as Proposed
1:20

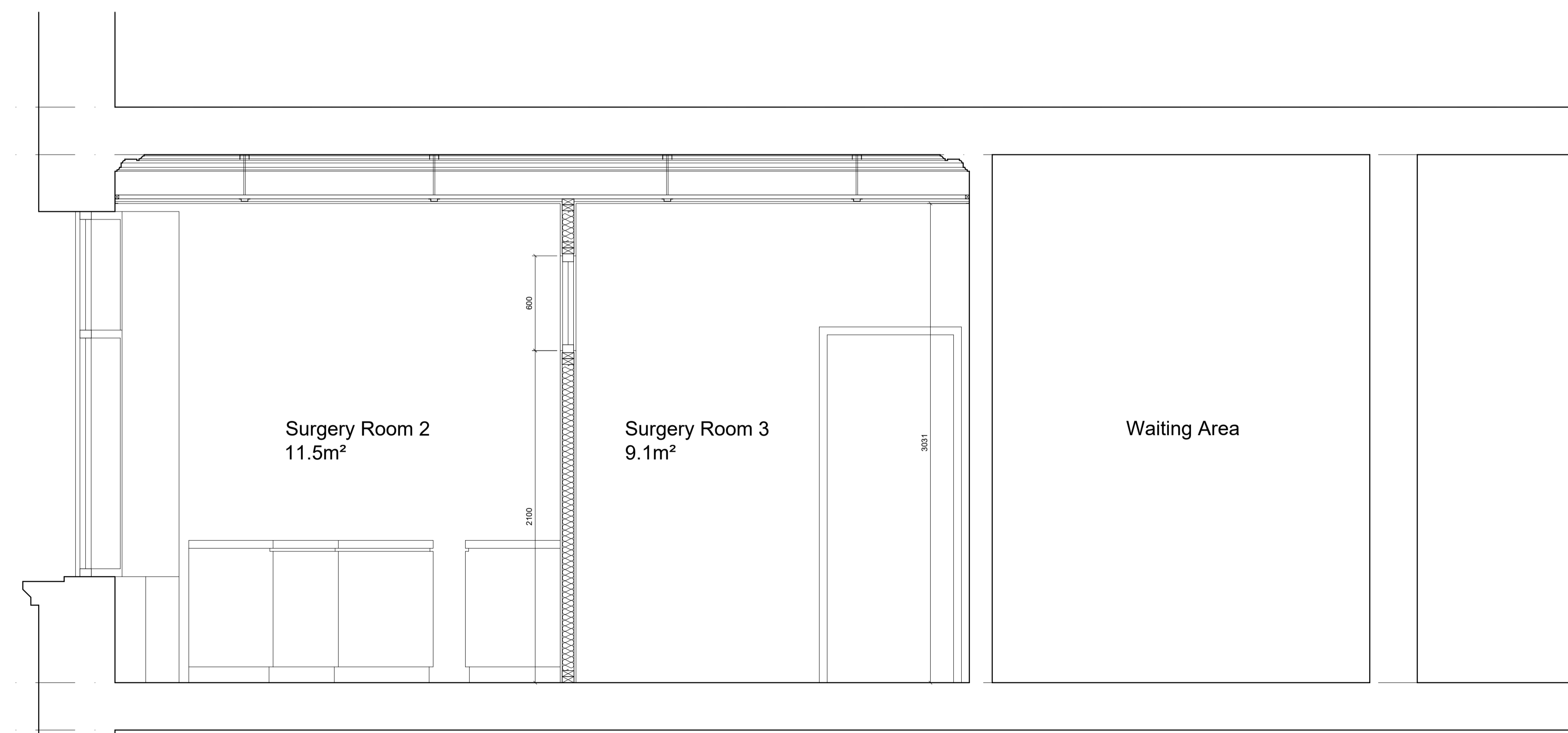
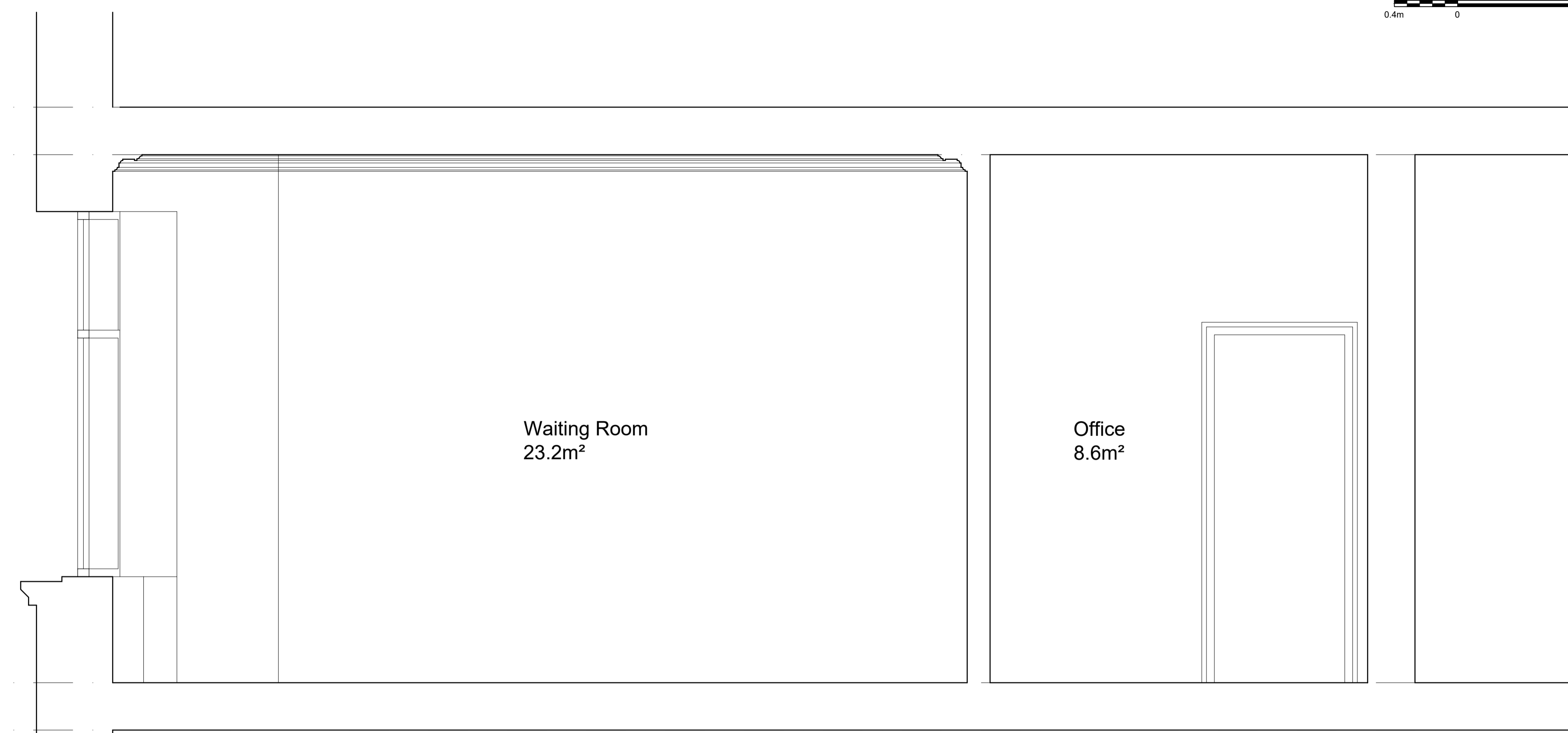

Notes:

Rev	Date	Description	Iss
-----	------	-------------	-----

Project Status: Planning

Tel: 07920 224 517

Alterations

Mr Jeffcoate Flat 1/3 810 Crow Road Glasgow G13 1LY	Section AA as Existing & Proposed Scale: As noted @ A1
---	---

L(20)007 -