

BS5837 Tree Survey Schedule

Surveyed Trees / Groups

Ref	Species	Common Name	Height	Stem Diameter	Canopy NESW	Crown Clearance	Age Class	Observations	Recommendations	Est. Remaining Contribution	Date Surveyed	BS Cat
01	Tilia x europaea	European Lime	16m	600#mm	5 N 5 E 5 S 5 W	2.5m	Mature	Fair overall Physiological and Structural condition. Typical basal growth.	Lift crown to give 5m clearance.	20 Years	31/3/2022	B1
02	Fagus sylvatica	Common Beech	20m	800#mm	8 N 9 E 8 S 5 W	4#m	Mature	Good overall Physiological and Structural condition. Off-site and inaccessible- dimensions estimated. Rooted on retained ground. RPA restricted by retaining wall and garage.		40 Years	31/3/2022	A1
03	Taxus baccata	English Yew	12m	600mm	6 N 6 E 6 S 6 W	2m	Mature	Good overall Physiological and Structural condition.		20 Years	31/3/2022	B1
04	Quercus robur	Pedunculate Oak	13m	300#mm	3.5 N 3.5 E 3.5 S 3.5 W	4m	Semi-Mature	Fair overall Physiological and Structural condition. Seedling becoming established		10 Years	31/3/2022	C1
05	Pinus nigra	Black Pine	18m	700#mm	6 N 6 E 9 S 6 W	5m	Mature	Good overall Physiological and Structural condition. Off-site and inaccessible- dimensions estimated.		40 Years	31/3/2022	A1
09	Chamaecyparis lawsoniana	Lawson Cypress	10m	700#mm	4 N 4 E 4 S 4 W		Mature	Off-site and inaccessible- dimensions estimated. Fair overall Physiological and Structural condition.		10 Years	31/3/2022	C1
10	Pinus nigra	Black Pine	21m	700mm	7 N 7 E 7 S 7 W	7m	Mature	Good overall Physiological and Structural condition. Off-site and inaccessible- dimensions estimated.		40 Years	31/3/2022	A1
12	Carpinus betulus	Hornbeam	6m	200mm	3 N 3 E 3 S 3 W	2m	Semi-Mature	Fair overall Physiological and Structural condition.		10 Years	31/3/2022	C1
13	Taxus baccata	English Yew	4.5m	200#mm	2.5 N 2.5 E 2.5 S 2.5 W	2m	Early-Mature	Fair overall Physiological and Structural condition. Small		10 Years	31/3/2022	C1
14	Robinia pseudoacacia	False Acacia	14m	300#mm	4 N 6 E 3 S 2 W	4m	Mature	Off-site and inaccessible- dimensions estimated. Asymmetric crown.		10 Years	31/3/2022	C1
15	Laburnum anagyroides	Common Laburnum	3.5m	200mm; 100mm	2 N 3 E 2 S 1 W	2m	Mature	Small ornamental. Limited wider landscape value		10 Years	31/3/2022	C1

Survey by Mark Welby DipArb(RFS), TechCert(ArborA), FArborA
 Arboricultural Association Registered Consultant
 www.mwelby.com

denotes estimated dimension. Typically due to the tree being inaccessible.
 Where dimensions are not listed please refer to the plan graphics for an indicative representation (typically for groups).

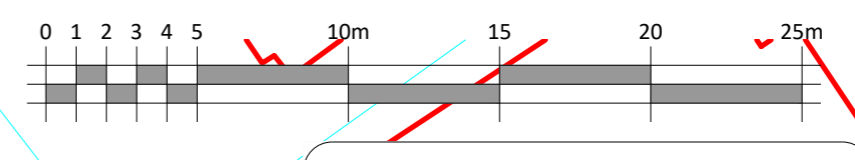

Key

Number/category/species

Crown spread

Stem location & Category colour

Root protection area (RPA)

BS 5837:2012 Tree Quality Categories - Table 1

- Category A - High quality
- Category B - Moderate quality
- Category C - Low quality
- Category U - Unsuitable for retention

TPOs

Trees protected by a Tree Preservation Order

Ref	Common Name	Category
02	Common Beech	A1
10	Black Pine	A1

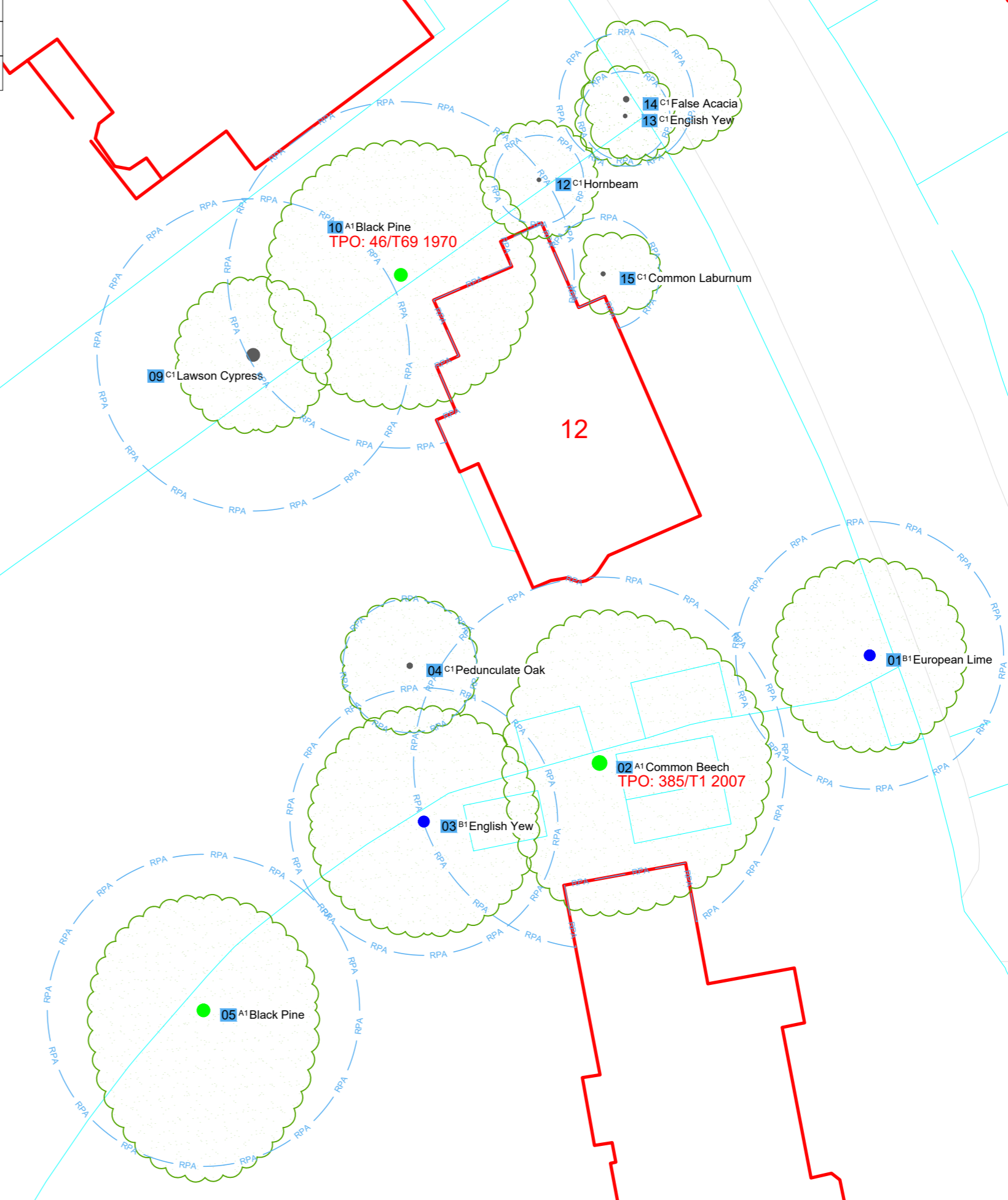

NOTES

This Tree Survey has been undertaken within the recommendations of British Standards 5837:2012 and current arboricultural best practice.

- The reference numbers of surveyed trees and groups of trees are shown. Stem locations within groups may be estimated, and indicative of canopy only
- The tree survey was carried out from ground level only, with the aid of binoculars as necessary, following the Visual Tree Assessment (VTA) method.
- Where trees are located on neighbouring land an estimated appraisal has been made of their quality and dimensions.
- Where stems or branches are obscured by ivy or other materials a full assessment of those parts will not be possible.
- Height dimensions are estimated and are given in metres.
- Trunk/stem diameters are measured in mm at 1.5 metres above ground level, unless otherwise stated. Where this is not possible, then Figure C.1 of the British Standard is followed.
- Tree canopies, where markedly asymmetrical, were measured (or estimated by pacing) in four directions only, with dimensions in the remaining directions assumed to be similar. For the canopies of groups of trees, the maximum radius for each compass point is measured (more complicated groups will have further notes taken and an accurate representation will be shown on the plan).

Statutory Tree Protection
 Tree Protection Orders: Yes. See tree references.

Conservation Area: NO

Felling licence: Garden areas are exempt.

Guidance on the implementation and use of this information, along with its limitations and more can be downloaded here:
<http://bit.ly/BSGuidance>

This plan has been drafted in colour. A monochrome version must not be relied upon

Date	Notes	Rev
25/04/24	Trees 6,7,8 & 11 removed	A

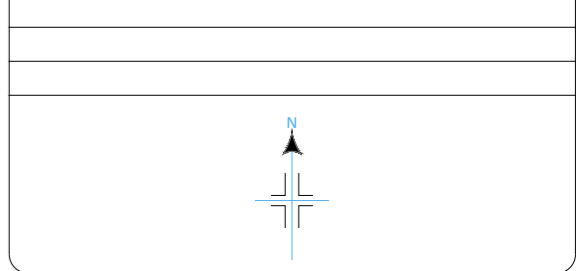

BS5837:2012 Cascade chart for tree quality assessment

Category & Definition	Criteria (including subcategories where appropriate)		
Trees unsuitable for retention			
Category U			
Those in such a condition that they cannot realistically be retained as living trees in the context of the current land use for longer than 10 years	<ul style="list-style-type: none"> Trees that have a serious, irremediable, structural defect, such that their early loss is expected due to collapse, including those that will become unviable after removal of other category U trees (e.g. where, for whatever reason, the loss of companion shelter cannot be mitigated by pruning) Trees that are dead or are showing signs of significant, immediate, and irreversible overall decline Trees infected with pathogens of significance to the health and/or safety of other trees nearby, or very low quality trees suppressing adjacent trees of better quality <p>NOTE Category U trees can have existing or potential conservation value which it might be desirable to preserve</p>		
Trees to be considered for retention			
	1. Mainly arboricultural qualities	2. Mainly landscape qualities	3. Mainly cultural values, including conservation
Category A			
Trees of high quality with an estimated remaining life expectancy of at least 40 years	Trees that are particularly good examples of their species, especially if rare or unusual; or those that are essential components of groups or formal or semi-formal arboricultural features (e.g. the dominant and/or principal trees within an avenue)	Trees, groups or woodlands of particular visual importance as arboricultural and/or landscape features	Trees, groups or woodlands of significant conservation, historical, commemorative or other value (e.g. veteran trees or wood-pasture)
Category B			
Trees of moderate quality with an estimated remaining life expectancy of at least 20 years	Trees that might be included in category A, but are downgraded because of impaired condition (e.g. presence of significant though remediable defects, including unsympathetic past management and storm damage), such that they are unlikely to be suitable for retention for beyond 40 years; or trees lacking the special quality necessary to merit the category A designation	Trees present in numbers, usually growing as groups or woodlands, such that they attract a higher collective rating than they might as individuals; or trees occurring as collectives but situated so as to make little visual contribution to the wider locality	Trees with material conservation or other cultural value
Category C			
Trees of low quality with an estimated remaining life expectancy of at least 10 years, or young trees with a stem diameter below 150 mm	Unremarkable trees of very limited merit or such impaired condition that they do not qualify in higher categories	Trees present in groups or woodlands, but without this conferring on them significantly greater collective landscape value; and/or trees offering low or only temporary/transient landscape benefits	Trees with no material conservation or other cultural value

Tree Survey

12 Burgh Heath Road
 Epsom
 Surrey, KT17 4LJ

Date: 21/04/2022 Scale: 1:250 @A2

DWG Ref: MW.22.0315.TS.RevA

MARK WELBY
 CONSULTING ARBORISTS

Mark Welby
 DipArb(RFS), TechCert(ArborA), FArborA
 Arboricultural Association Registered Consultant
 01730 229 492 | mark@mwelby.com
 www.mwelby.com
 M Welby Ltd | Hampshire | UK

Arboricultural Association
 Fellow Member