

Note - Contractor to check all dimensions on site and verify prior to ordering roof trusses.

Note - Plans to be read in conjunction with outline specifications and engineers details.

Raised tie roof trusses by specialist contractor.

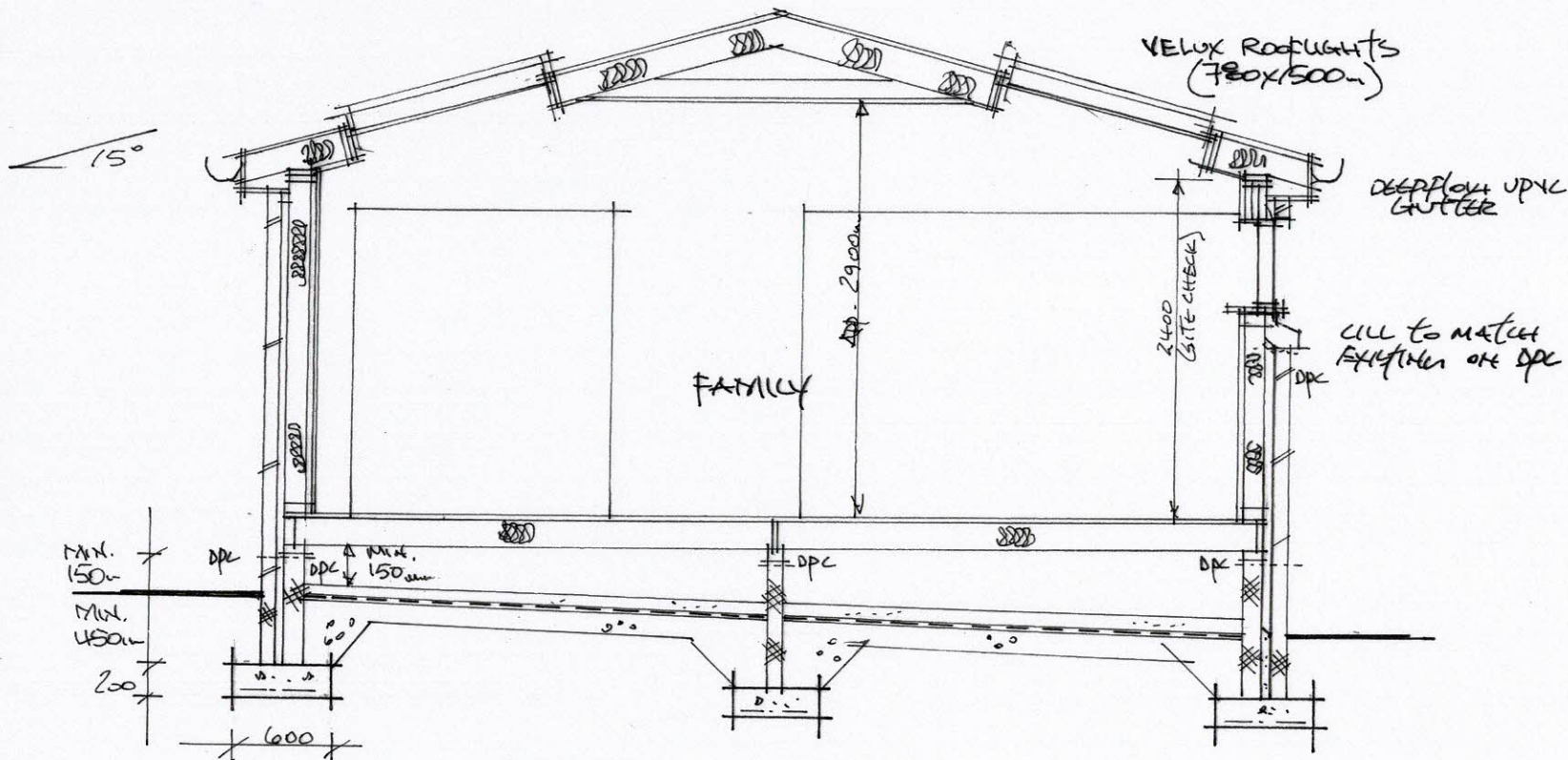

SECTION 1-1

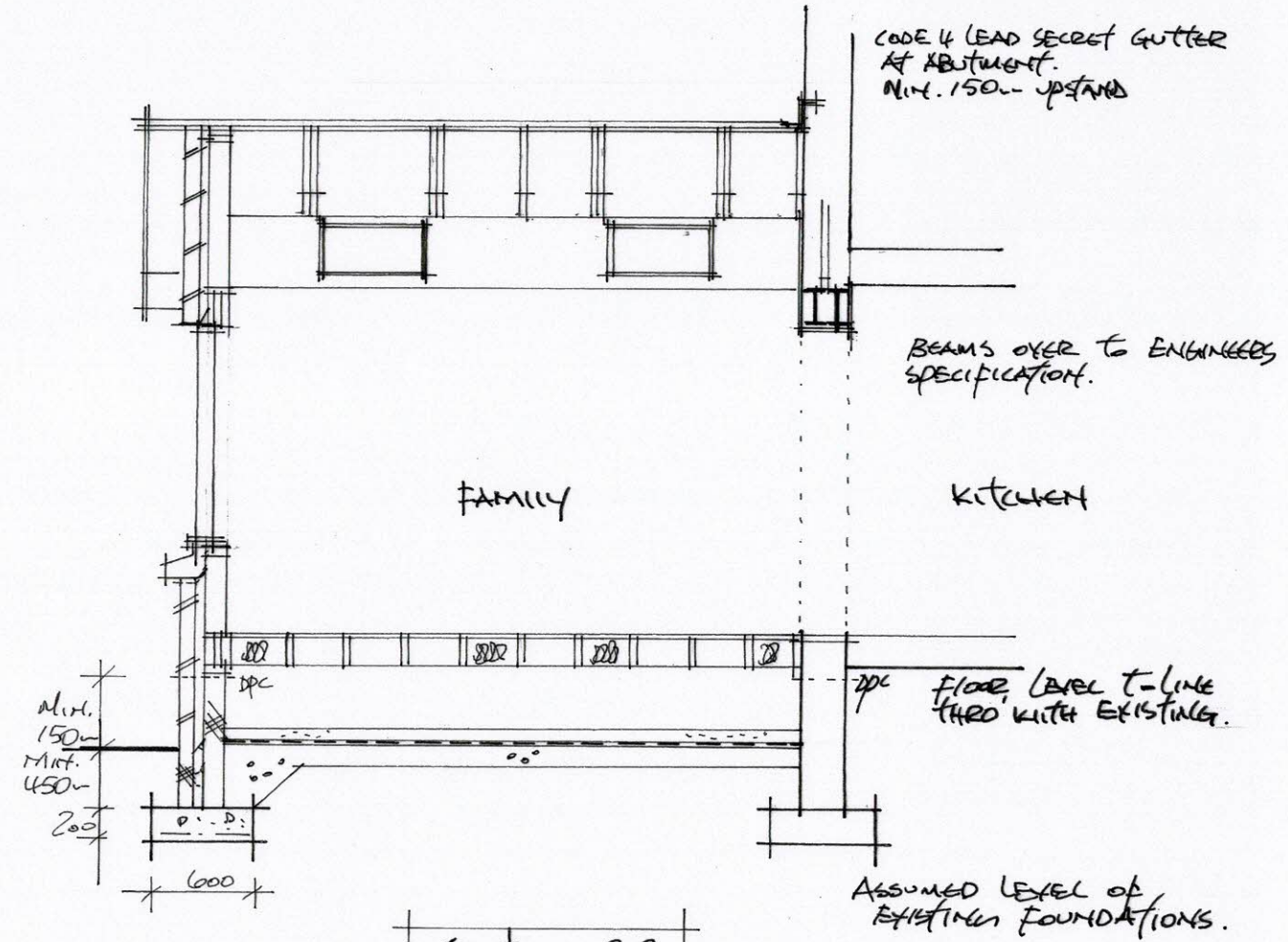

SECTION 2-2

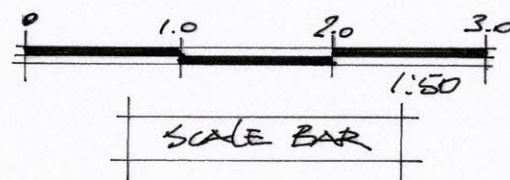

PROPOSED EXTENSION TO HOUSE
AT 3 KIRK LANE
LIVINGSTON VILLAGE

SCALE - 1:50

DRG. NO - 03

DATE - APRIL 2024

REV. -