

01- Section view of staircases - 1:25 @ A1

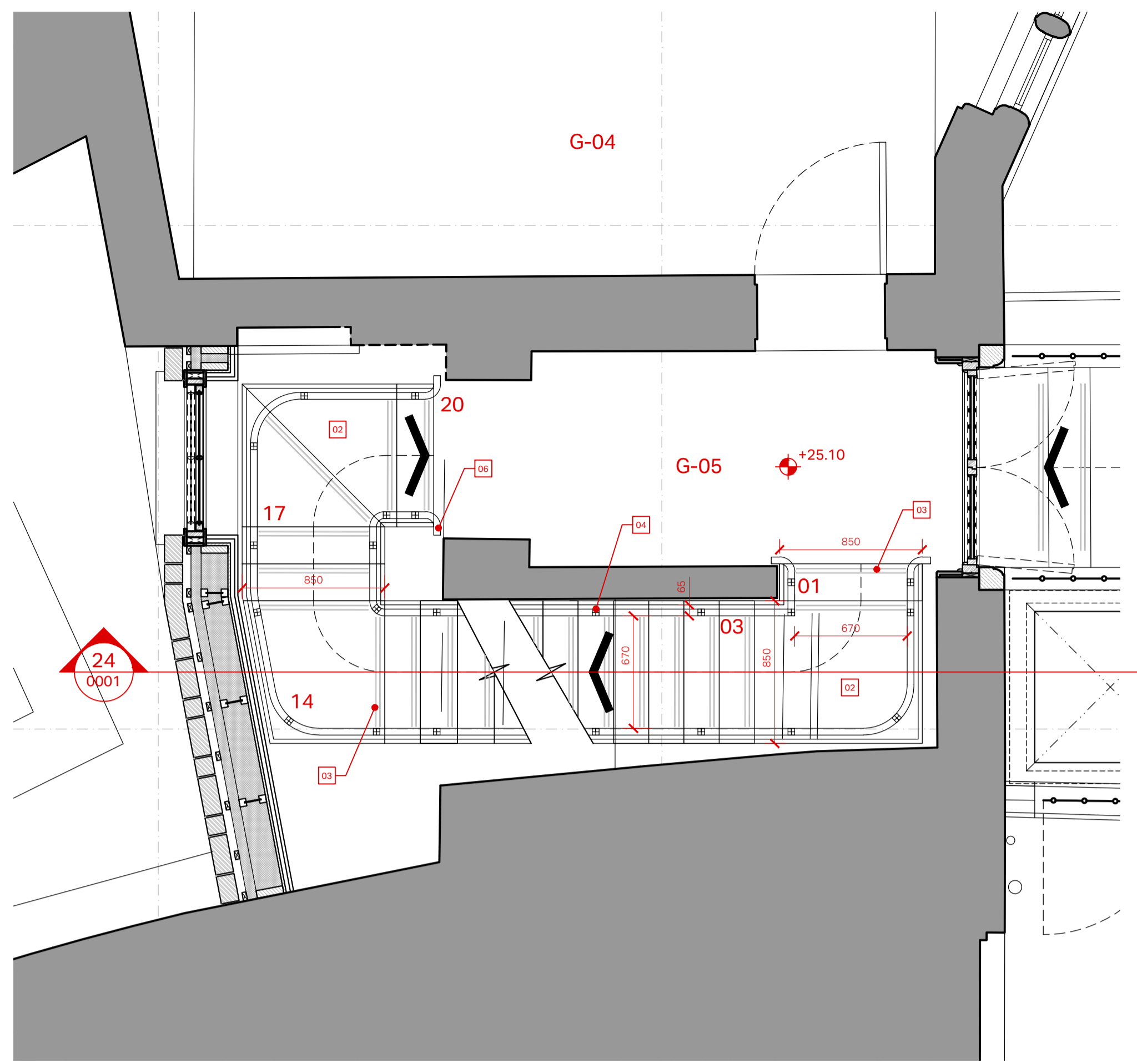

02- Plan view at Ground Floor -1:25 @ A1

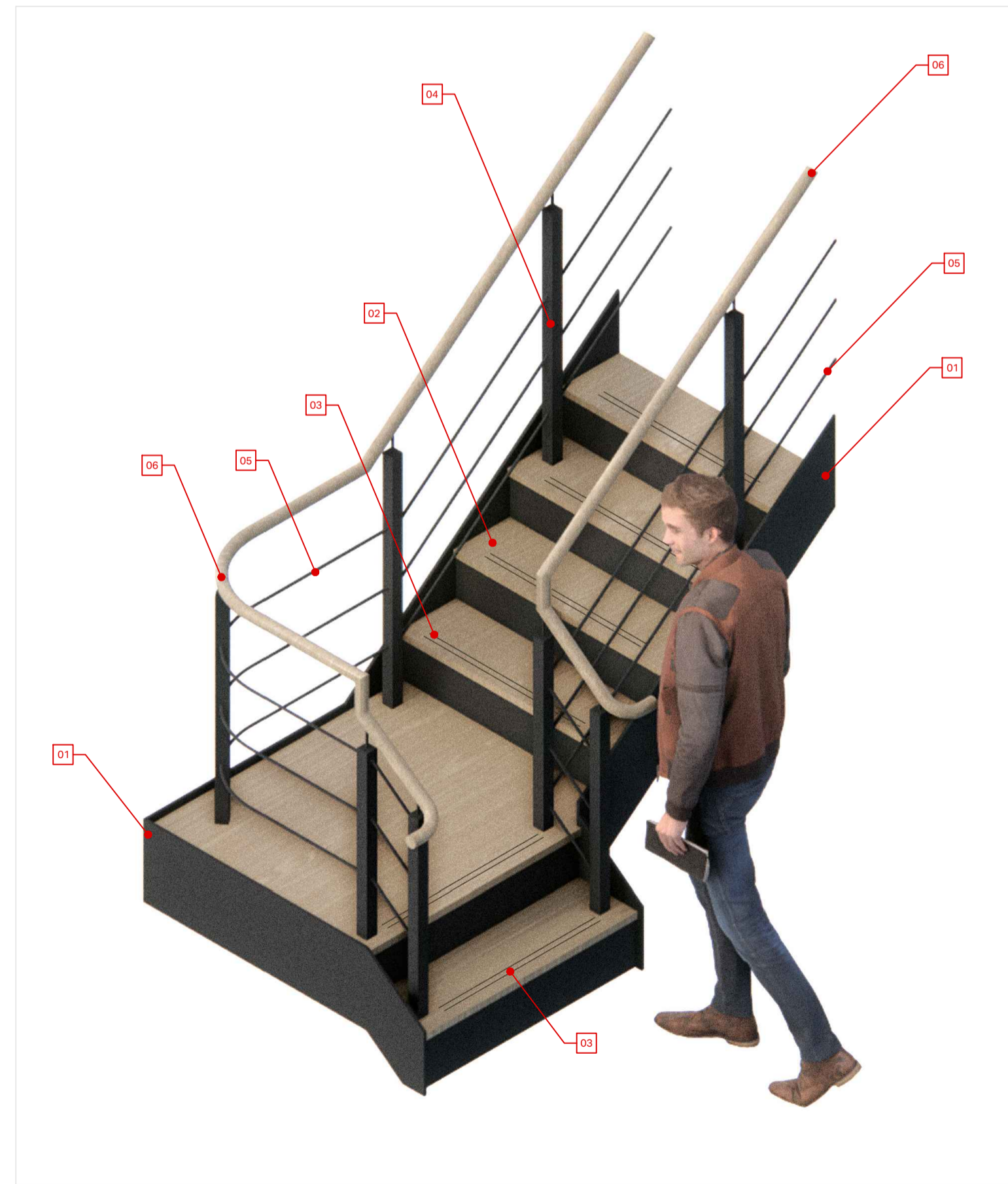

03- 3D visual of staircase - NTS

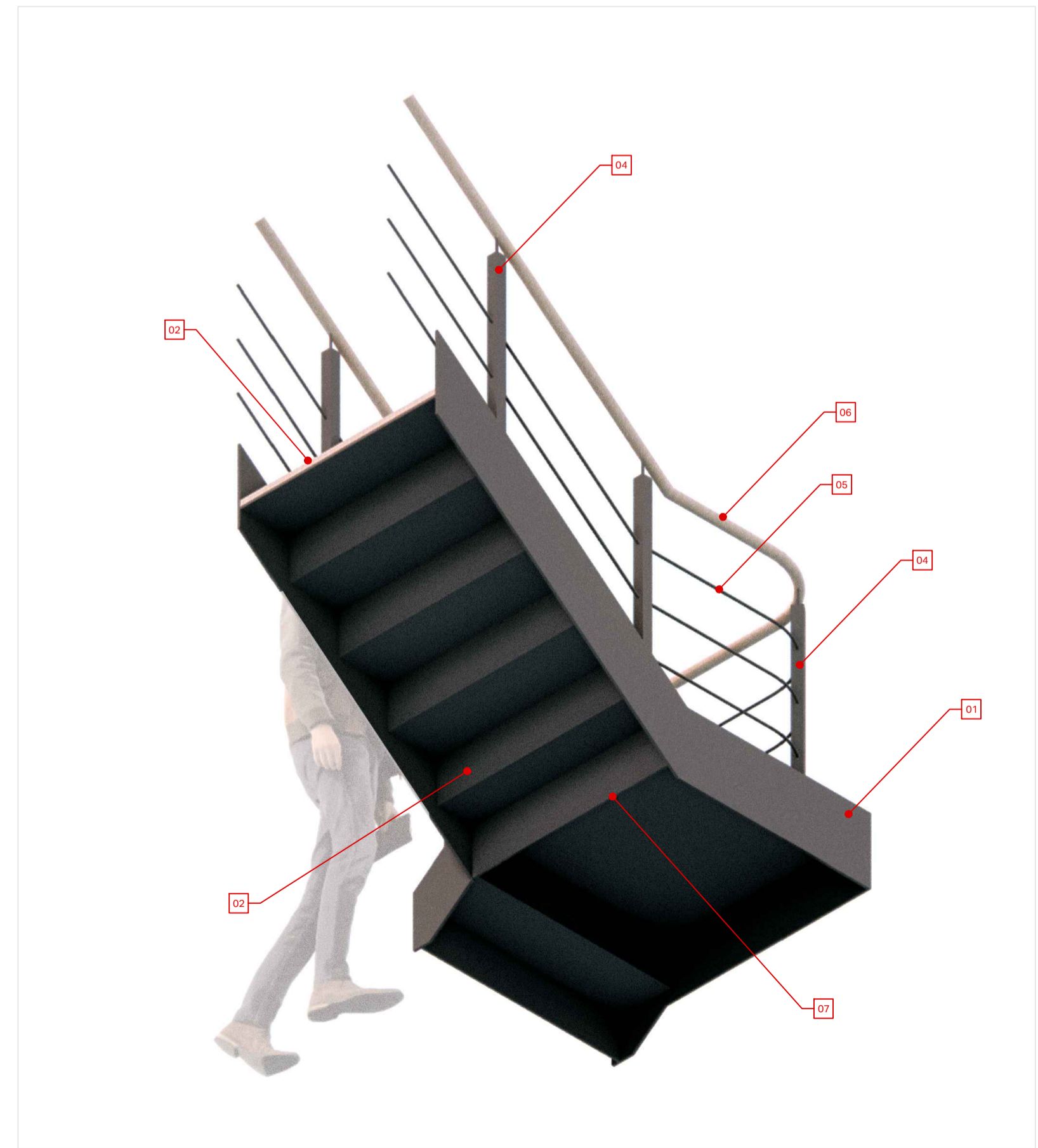

04- 3D visual of underside of staircase - NTS

- NOTES:**
 Contents of this drawing are subject to the proposed site investigation work. Existing build-ups and structure have been assumed for coordination purposes.
- KEY:**
1. Painted architectural metal plate stringer: NBS: Ss_35_10_40_42;
 2. Continuous welded metal treads with timber tread overlay on concealed fixings: NBS: Ss_35_10_40_42;
 3. Painted metal inlay nosing: NBS: Ss_35_10_40_42;
 4. Box section balustrade post with metal rod balustrade connector to timber handrail: NBS: Ss_35_10_40_42;
 5. Horizontal metal plate balustrade infill: NBS: Pr_20_76_06_11;
 6. Timber handrail: NBS: Pr_25_30_36_86 and
 7. Metal plate stiffener: NBS: Ss_35_10_40_42.

Designsplus Architects
 4 Anchor Cottages, Maldon Road, Tiptree, Essex, CO5 0BW
 Tel: +44 (0)7745 526 443 | Web: <https://designs-plus.co.uk/>
 E-mail: mail@designs-plus.co.uk

For Designsplus Architects electronic information disclaimer please visit:
<https://designs-plus.co.uk/electronic-information-disclaimer>

NOTES:
 - DO NOT SCALE THIS DRAWING.
 - Measurements are based on the metric system.
 - Existing buildings to be measured on site and confirmed by the Contractor.
 - All levels are in metres, measured to the Ordnance Datum unless otherwise stated.
 - The Contractor should verify all conditions, levels and dimensions on site, notifying the Contract Administrator of any variations before construction or fabrication commences.
 - Any discrepancies should be reported to Designsplus Architects.
 - Document to be printed in colour.
 - The drawing contains architectural information only, please refer to other consultant documents for further information.
 - The contents of this drawing are confidential and the copyright is the property of Designsplus Architects.
 © Designsplus Architects 2023

KEY:
 Existing building

C01 Issue for tender 011223
 Revisions 00 MAY 23

Project: No.8 Carlos Place, London
 Client: Grosvenor Britain & Ireland
 Drawing Name: Escape Staircase
 Bay Study

Date: 01/12/23 Drawn: BC
 Scale: 1:25 @ A1 Rev/Status: C01 A1
 Drawing No. 2208-DP-24-ZZ-08-A-0001