

26C001 Castle School, Thornbury
R2L2 Data Sheet

R2L2

THORN

96268421 R2L2 S 12L70 740 RC CL2 GY

| | | | | | | | | | | | |
|--------------------------|----------------|------|------|--|----|--|-----|--|--|---------------|--|
| LED 28W R2L2_12L70-740RC | ISO 9223 C5 | IP66 | IK08 | | CE | | EAC | | | Ta -25 +50 | |
|--------------------------|----------------|------|------|--|----|--|-----|--|--|---------------|--|

R2L2

A small size LED road lighting lantern with 12 LEDs driven at 700mA with Road & Comfort optic. LED driver Programmable. Class II electrical, IP66, IK08. Housing: die-cast aluminium (EN AC-44300), powder coated textured light grey. Enclosure: tempered flat glass. Screws: stainless steel, Ecolubric® treated. Post top (Ø60/76mm, tilted 0°/5°/10°) or lateral (Ø34/42/49/60mm, tilted 0°/-5°/-10°/-15°) mounting. For lateral mounting to Ø34/42mm spigots an adaptor (59005840 R2L2 MA34/42 NPA) should be ordered separately. Complete with 4000K LED.

Dimensions: 655 x 362 x 155 mm
Luminaire input power: 28 W
Luminaire luminous flux: 3846 lm
Luminaire efficacy: 137 lm/W
Weight: 8.89 kg
Scx: 0.05 m²



TLG_R2L2_F_SPDB.jpg

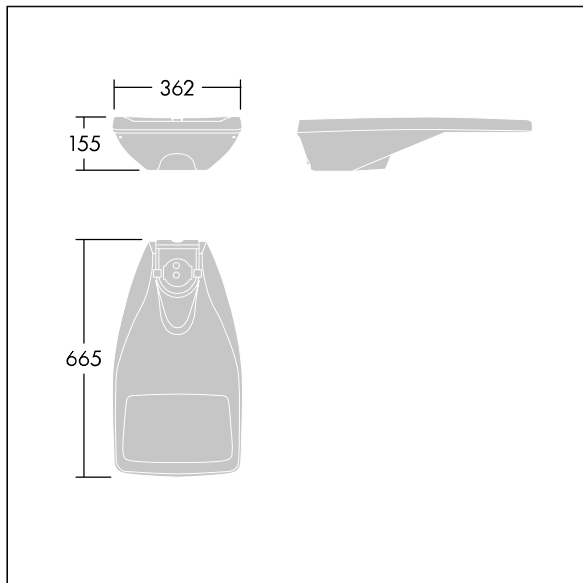

TLG_R2L2_M_LDS.wmf

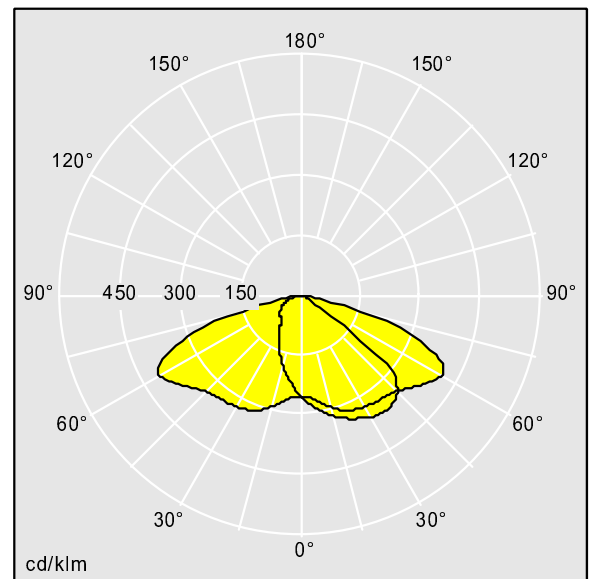

TL_RS12L70RC740.ltd

Lamp position: STD - standard
Light Source: LED
Luminaire luminous flux*: 3846 lm
Luminaire efficacy*: 137 lm/W
Colour Rendering Index min.: 70
Ballast: 1 x 87500884 LCO 40/200-1050/64 o4a NF C
EXC3

Correlated colour temperature*: 4000 Kelvin
Chromaticity tolerance (initial MacAdam): 5
Rated useful life (B10)*:
L90 100000h at 25°C
Luminaire input power*: 28 W Power factor = 0.95
Dimming: PROG
LOR: 1,00 ULOR: 0,00 DLOR: 1,00

This product contains a light source of energy efficiency class D.

All values marked with an * are rated values. Thorn uses tried and tested components from leading suppliers, however there may be isolated instances of technology-related failures of individual LEDs during the rated product lifetime. International standards set the tolerance in initial flux and connected load at ±10%. Unless stated otherwise, the values apply to an ambient temperature of 25°C.

Thorn Lighting is constantly developing and improving its products. The right is reserved to change specifications without prior notification or public announcement.
© Thorn Lighting

26C001 Castle School, Thornbury
Piazza II Led Data Sheet
96666256

Piazza II LED

THORN

96666256 PIAZZA II LED 1690-840 HF ANT

| | | | | | | | | | |
|-----|-------------|------|------|---|----|--|--|--|---------------------------|
| LED | 15W TL_PIA2 | IP65 | IK10 | ⊕ | CE | | | | T _a -20 +40 |
|-----|-------------|------|------|---|----|--|--|--|---------------------------|

Piazza II LED

A robust Wall mounted luminaire. Electronic, fixed output control gear. Back plate: die-cast aluminium, painted anthracite. Body: anthracite polycarbonate. Ø20mm cable entry via rear or side conduit entries, BESA compatible. IP65, IK10. Complete with 4000K LED.

Dimensions: 381 x 196 x 305 mm
Luminaire input power: 15.4 W
Luminaire luminous flux: 1844 lm
Luminaire efficacy: 120 lm/W
Weight: 2.8 kg



TLG_PIA2_F_PDB.jpg

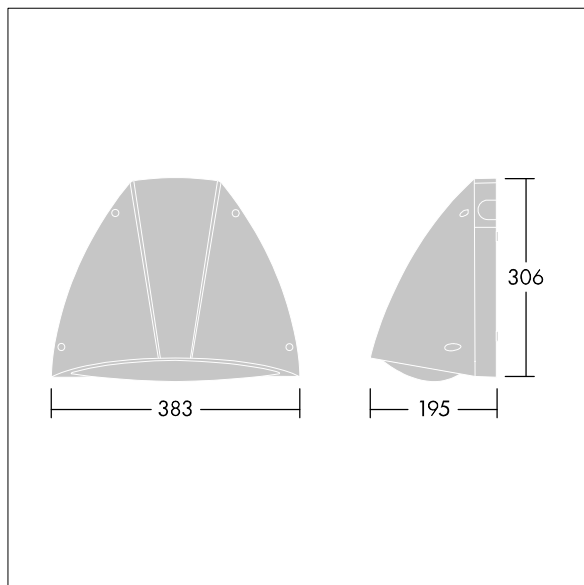

TLG_PIA2_M_LD1.wmf

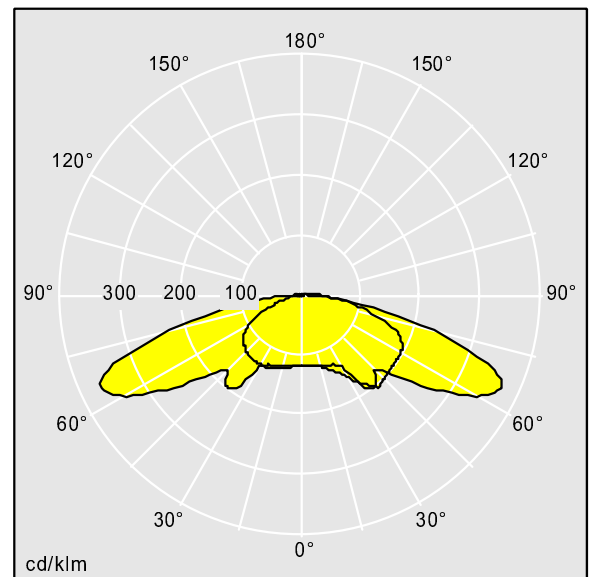

TLTP_PIA2_1690.idt

Lamp position: STD - standard
Light Source: LED
Luminaire luminous flux*: 1844 lm
Luminaire efficacy*: 120 lm/W
Colour Rendering Index min.: 80
Ballast: 1 x 87500630 PIAZZA II LED 1690-840 HF ANT

Correlated colour temperature*: 4000 Kelvin
Chromaticity tolerance (initial MacAdam): 5
Rated median useful life*:
L70 60000h at 25°C
Luminaire input power*: 15.4 W
Dimming: FO
LOR: 1,00 ULOR: 0,02 DLOR: 0,98

This product contains a light source of energy efficiency class E.

All values marked with an * are rated values. Thorn uses tried and tested components from leading suppliers, however there may be isolated instances of technology-related failures of individual LEDs during the rated product lifetime. International standards set the tolerance in initial flux and connected load at ±10%. Unless stated otherwise, the values apply to an ambient temperature of 25°C.

Thorn Lighting is constantly developing and improving its products. The right is reserved to change specifications without prior notification or public announcement.
© Thorn Lighting

26C001 Castle School, Thornbury
Piazza II Led Data Sheet
96666261

Piazza II LED

9666261 PIAZZA II LED 2700-840 HF ANT

| | | | | | | | | | |
|-----------------|------|------|--|--|--|--|--|--|---------------------------|
| LED 25W TL_PIA2 | IP65 | IK10 | | | | | | | T _a -20 +40 |
|-----------------|------|------|--|--|--|--|--|--|---------------------------|

Piazza II LED

A robust Wall mounted luminaire. Electronic, fixed output control gear. Back plate: die-cast aluminium, painted anthracite. Body: anthracite polycarbonate. Ø20mm cable entry via rear or side conduit entries, BESA compatible. IP65, IK10. Complete with 4000K LED.

Dimensions: 381 x 196 x 305 mm
 Luminaire input power: 25 W
 Luminaire luminous flux: 2910 lm
 Luminaire efficacy: 116 lm/W
 Weight: 2.8 kg



TLG_PIA2_F_PDB.jpg

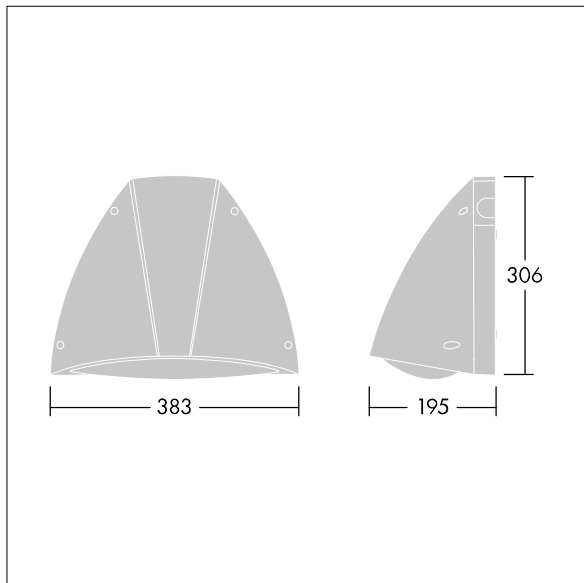

TLG_PIA2_M_LD1.wmf

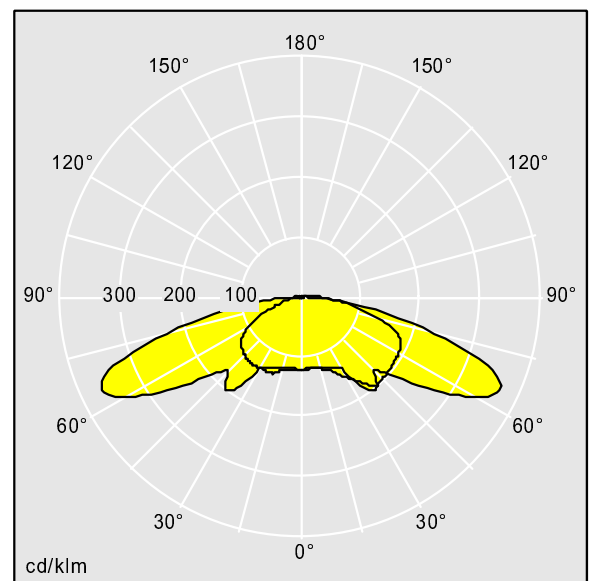

TLTP_PIA2_2700.idt

Lamp position: STD - standard
 Light Source: LED
 Luminaire luminous flux*: 2910 lm
 Luminaire efficacy*: 116 lm/W
 Colour Rendering Index min.: 80
 Ballast: 1 x 87500459 LC 25W 600mA fixC SC SNC

Correlated colour temperature*: 4000 Kelvin
 Chromaticity tolerance (initial MacAdam): 5
 Rated median useful life*:
 L70 60000h at 25°C
 Luminaire input power*: 25 W
 Dimming: FO
 LOR: 1,00 ULOR: 0,03 DLOR: 0,97

This product contains a light source of energy efficiency class E.

All values marked with an * are rated values. Thorn uses tried and tested components from leading suppliers, however there may be isolated instances of technology-related failures of individual LEDs during the rated product lifetime. International standards set the tolerance in initial flux and connected load at $\pm 10\%$. Unless stated otherwise, the values apply to an ambient temperature of 25°C.

26C001 Castle School, Thornbury
EyeKon Led Data Sheet

EyeKon LED

THORN

96665856 EYE VS LED400-840 HF E3 S ANT

| | | | | | | | | | |
|---------------------|----------|------|------|--|--|--|--|-------|----------------------|
| LED 7W EYKL_VSSHE4K | EN 55015 | IP65 | IK10 | | | | | 850°C | T _a 0 +25 |
|---------------------|----------|------|------|--|--|--|--|-------|----------------------|

EyeKon LED

Round, impact resistant LED bulkhead luminaire.
Electronic, fixed output control gear with 3 hour, manual test, emergency lighting circuit. Class I electrical, IP65, IK10. Body: small size, die-cast aluminium (LM6), powder coated anthracite. Diffuser: opal polycarbonate with die-cast aluminium visor feature. Electrical connection via 4 x 2 x 2.5mm² terminal block. Complete with 4000K LED

Dimensions: Ø285 x 150 mm
Luminaire input power: 7 W
Weight: 2.8 kg

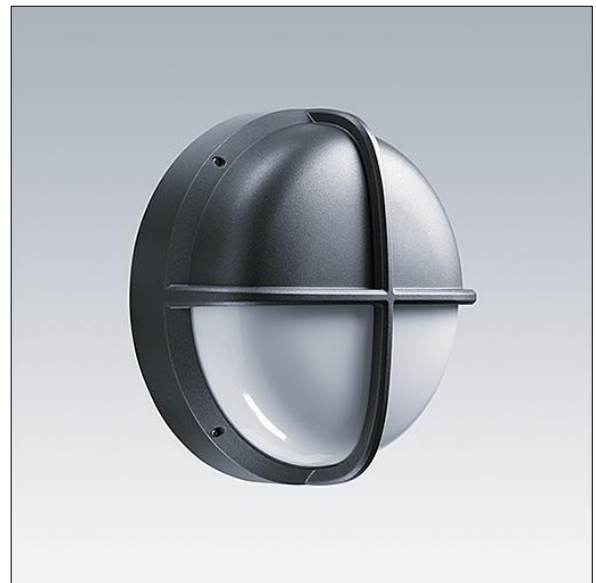

TLG_EYKN_F_SMVSANTHOP.jpg

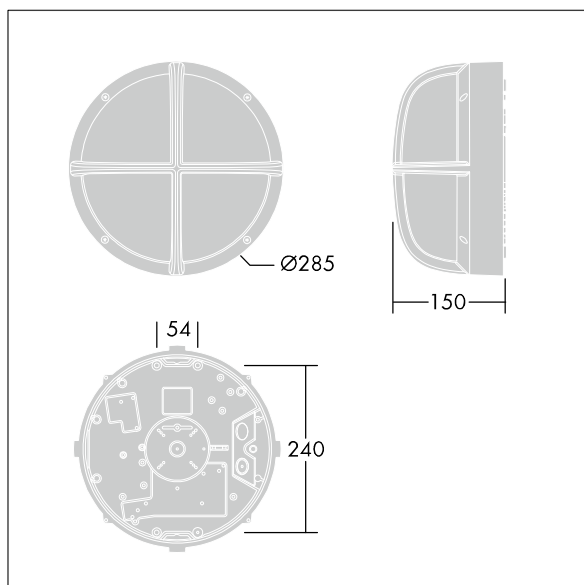

TLG_EYKN_M_SML.wmf

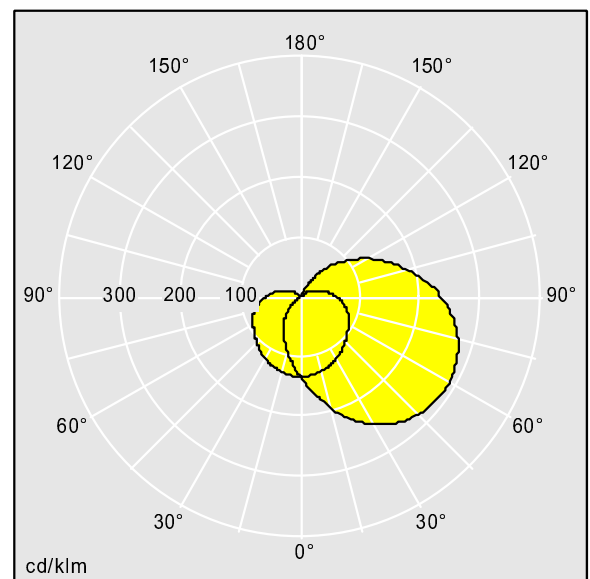

TLG_SP_0042767.idt

Lamp position: STD - standard
Light Source: LED
Luminaire luminous flux*: 435 lm
Total emergency luminous flux: 75 lm
Luminaire efficacy*: 62 lm/W
Colour Rendering Index min.: 80
Ballast 1: 1 x 28000704 LC 10W 150-400mA flexC SC EXC
LOR: 1,00 ULOR: 0,27 DLOR: 0,73

Ballast 2: 1 x 89899858 DRV EM TR LBS P MT NO 1W 1#Screw
Correlated colour temperature*: 4000 Kelvin
Chromaticity tolerance (initial MacAdam): 3
Rated median useful life*: L90 50000h at 25°C
Luminaire input power*: 7 W
Charging power: 4 W
Dimming: FO

This product contains a light source of energy efficiency class C.

All values marked with an * are rated values. Thorn uses tried and tested components from leading suppliers, however there may be isolated instances of technology-related failures of individual LEDs during the rated product lifetime. International standards set the tolerance in initial flux and connected load at ±10%. Unless stated otherwise, the values apply to an ambient temperature of 25°C.

Thorn Lighting is constantly developing and improving its products. The right is reserved to change specifications without prior notification or public announcement.
© Thorn Lighting

**26C001 Castle School, Thornbury
General External Lighting
Calculations**

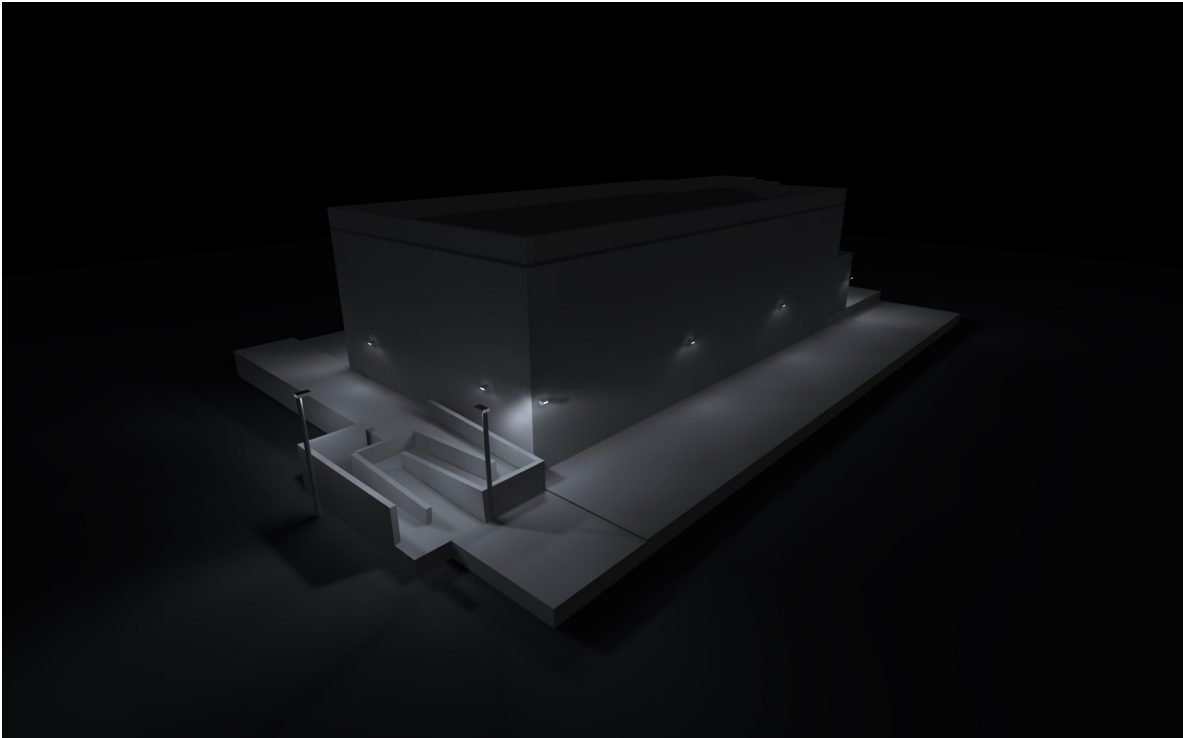

CASTLE ACADEMY (CSET) STEM BLOCK EXTENSION PROJECT

26C001 EXTERNAL GENERAL LIGHTING CALCULATIONS
26C001-WBS-XX-XX-CA-E-0005 C01

Table of Contents

| | |
|---|---|
| Cover | 1 |
| Table of Contents | 2 |
| | |
| Site 1 | |
| Calculation objects / Light scene 1 | 3 |

Site 1 (Light scene 1)

Calculation objects

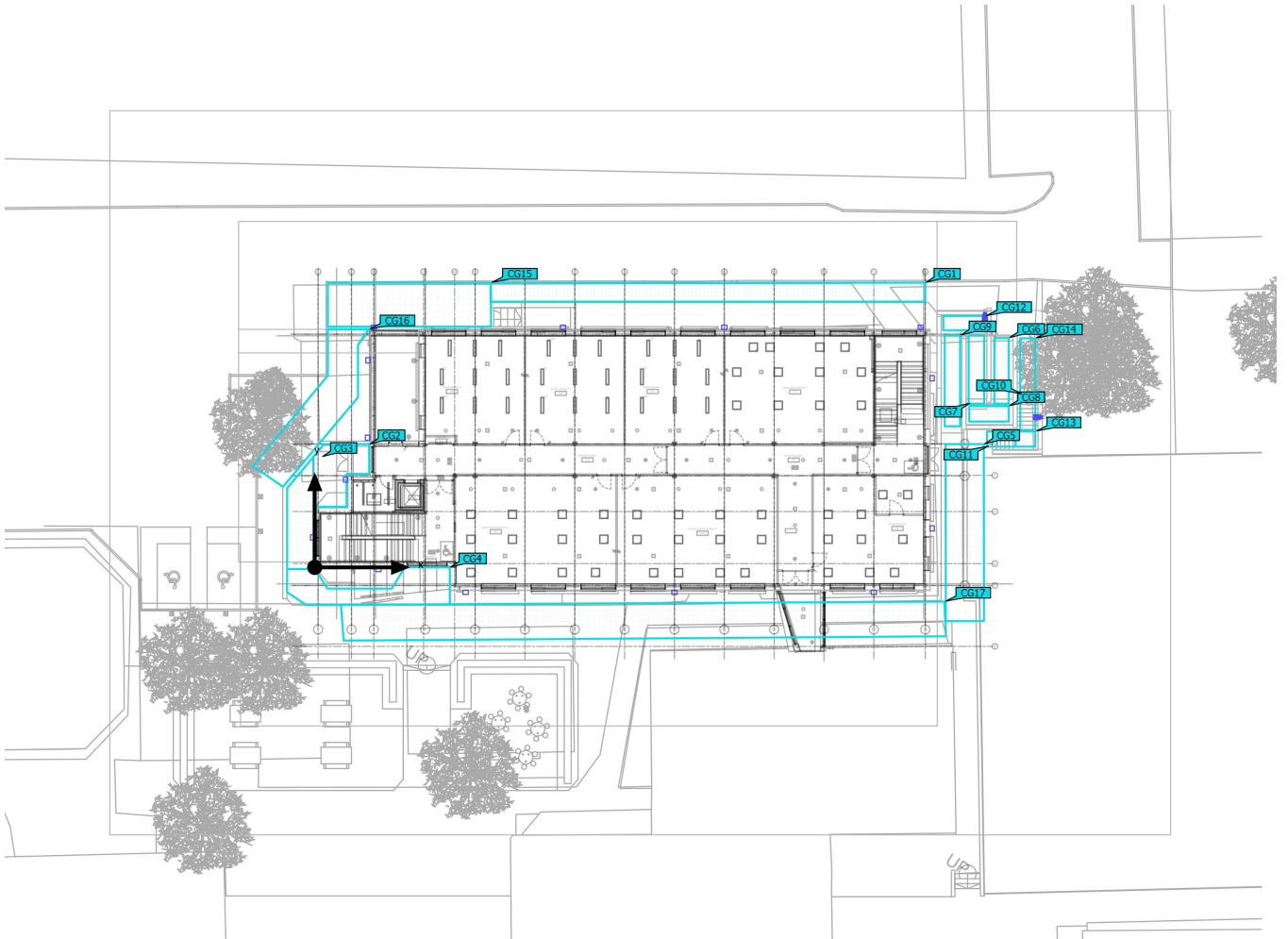

Site 1 (Light scene 1)

Calculation objects

Calculation surfaces

| Properties | \bar{E} | E_{min} | E_{max} | $U_o (g_1)$ | g_2 | Index |
|--|-----------|-----------|-----------|-------------|-------|-------|
| Calculation surface 15 Perpendicular illuminance Height: 1.000 m | 15.4 lx | 10.9 lx | 32.5 lx | 0.71 | 0.34 | CG1 |
| Calculation surface 19 Perpendicular illuminance Height: 2.000 m | 26.2 lx | 10.9 lx | 35.8 lx | 0.42 | 0.30 | CG2 |
| Calculation surface 20 Perpendicular illuminance Height: 2.000 m | 20.2 lx | 5.98 lx | 28.1 lx | 0.30 | 0.21 | CG3 |
| Calculation surface 23 Perpendicular illuminance Height: 2.010 m | 13.3 lx | 4.00 lx | 22.8 lx | 0.30 | 0.18 | CG4 |
| Calculation surface 25 Perpendicular illuminance Height: 2.213 m | 16.4 lx | 5.62 lx | 30.6 lx | 0.34 | 0.18 | CG5 |
| Calculation surface 26 Perpendicular illuminance Height: 1.113 m | 48.3 lx | 42.2 lx | 51.6 lx | 0.87 | 0.82 | CG6 |
| Calculation surface 27 Perpendicular illuminance Height: 1.435 m | 41.0 lx | 14.8 lx | 60.0 lx | 0.36 | 0.25 | CG7 |
| Calculation surface 28 Perpendicular illuminance Height: 1.255 m | 37.3 lx | 24.6 lx | 46.5 lx | 0.66 | 0.53 | CG8 |
| Calculation surface 29 Perpendicular illuminance Height: 1.779 m | 40.6 lx | 21.1 lx | 59.2 lx | 0.52 | 0.36 | CG9 |
| Calculation surface 30 Perpendicular illuminance Height: 1.178 m | 41.5 lx | 35.7 lx | 46.3 lx | 0.86 | 0.77 | CG10 |
| Calculation surface 31 Perpendicular illuminance Height: 1.761 m | 43.3 lx | 37.4 lx | 46.8 lx | 0.86 | 0.80 | CG11 |



Site 1 (Light scene 1)

Calculation objects

| | | | | | | |
|--|---------|---------|---------|------|------|------|
| Calculation surface 33 Perpendicular illuminance Height: 1.578 m | 63.9 lx | 38.9 lx | 78.5 lx | 0.61 | 0.50 | CG12 |
| Calculation surface 34 Perpendicular illuminance Height: 1.500 m | 45.0 lx | 43.2 lx | 46.7 lx | 0.96 | 0.93 | CG13 |
| Calculation surface 35 Perpendicular illuminance Height: 0.926 m | 39.6 lx | 19.0 lx | 47.6 lx | 0.48 | 0.40 | CG14 |
| Calculation surface 38 Perpendicular illuminance Height: 1.000 m | 13.3 lx | 5.73 lx | 23.4 lx | 0.43 | 0.24 | CG15 |
| Calculation surface 37 Perpendicular illuminance Height: 2.000 m | 19.1 lx | 7.97 lx | 28.9 lx | 0.42 | 0.28 | CG16 |
| Calculation surface 39 Perpendicular illuminance Height: 2.000 m | 11.2 lx | 2.85 lx | 27.0 lx | 0.25 | 0.11 | CG17 |

Utilisation profile: DIALux presetting (5.1.4 Standard (outdoor transportation area))