

DISCLAIMER:
Please report any discrepancies or omissions between the 'Designer' and any consultants drawings to the designer immediately. For all other purposes other than Planning applications submitted to Kings Lynn Borough Council, do not scale from Drawings. All dimensions to be checked by contractor on site prior to commencing any work. IF IN DOUBT ASK. Levels and dimensions of existing structures may be from various sources and may be inaccurate. Unless stated otherwise this drawing is for design intent purposes only and should not be used for any other purpose. The drawing is indicative of designers visual requirements.

COPYRIGHT:
This document is the property of Atelier Associates and copyright is reserved by them. No unauthorised copying, in whole or part or any form of reproduction is permitted. It must not be retained for reference and the contents may not be disclosed to any third party without the special written consent of Atelier Associates.

CDM:
This drawing represents design intent only and should not be used for construction purposes without written notification from Atelier Associates or the Principal Designer. It is understood the client's intention is to appoint a Principal Contractor in order to discharge their obligations under CDM.

DRAWING PURPOSES:
CONSTRUCTION: All existing site and building dimensions to be confirmed by contractor prior to ordering of materials or commencement of work. Any variation or discrepancy to be brought to the designers attention immediately and formal instruction must be obtained prior to works commencing / continuing. This drawing must be read in conjunction with all Atelier Associates and other consultant drawings and documents - refer to drawing register for full details and revisions.
Due to the nature and location of projects, construction materials are subject to approval from a number of parties. Materials may be subject to amendment.

PLANNING: This drawing should be used for planning purposes only and should not be used for any other purpose.

DISCUSSION: The content of this drawing is for discussion purposes only between agreed third parties and the information should not be relied upon for any other purpose.

LOCATION PLANS:
These are downloaded from a third party source and do not represent a legal boundary for ownership or any other legal encumbrances. Location plans are to be used for identification purposes only for the sole purpose of obtaining planning permission.

REVISIONS:
Recycle all previous versions of this drawing and check with designer that you have the latest revision.

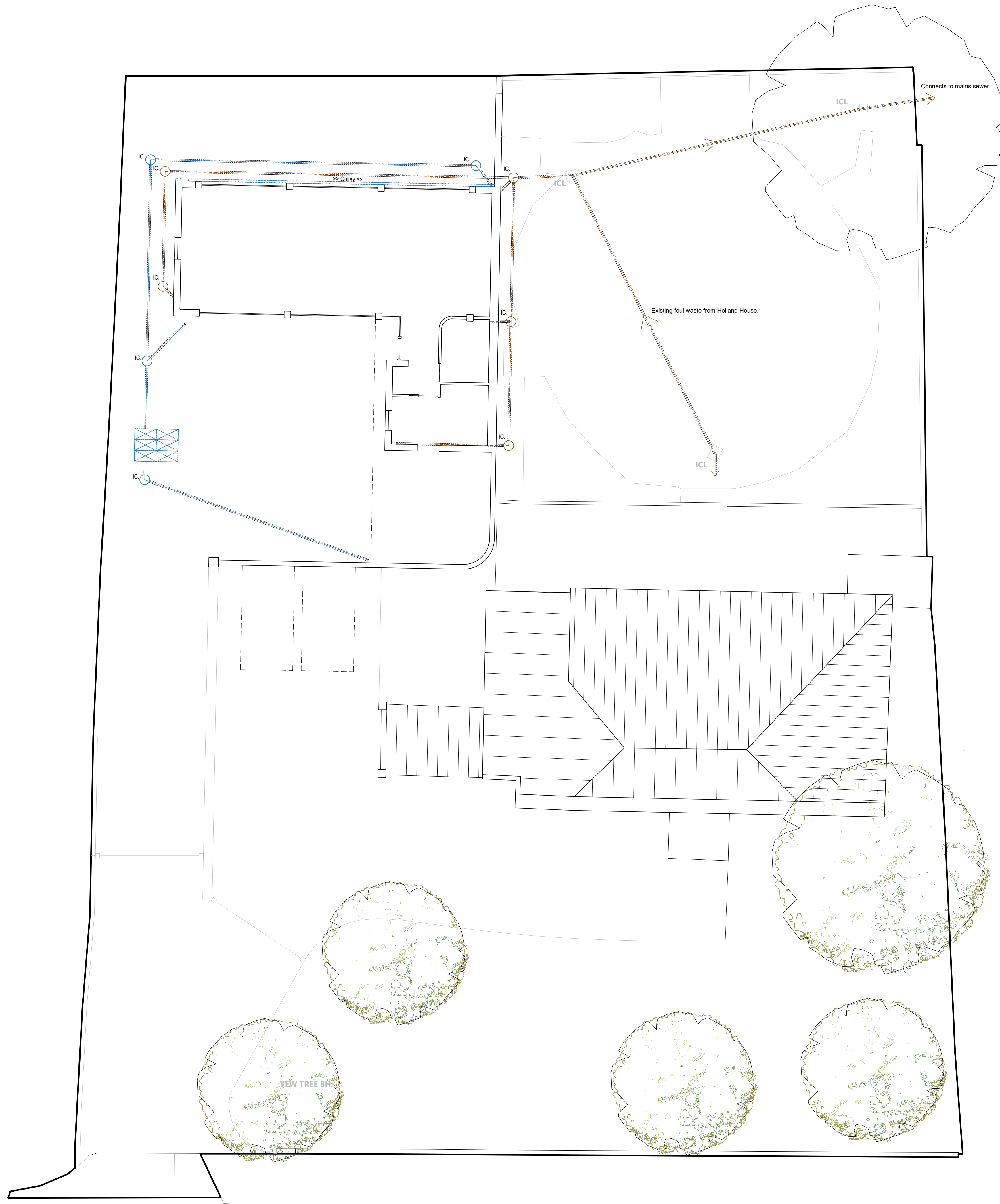



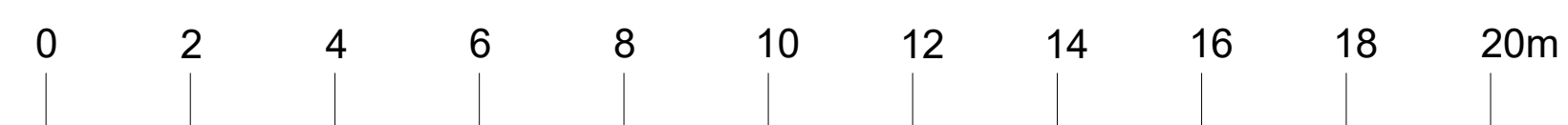

PROPOSED DRAINAGE LAYOUT (Scale 1:100 when printed at A1)



SCALE BAR PRINTED PAPER SIZE A1

Legend

-  Denotes Osma aquacell eco crates installed in landscape to form soak away with minimum 300mm cover and max depth of 1.5m final depth to be determined onsite once ground conditions are unknown, number and configuration of soakaway units to be determined by manufacturer. Percolation test to be carried out to identify infiltration rate of existing ground. Provide permeable Geo-textile wrap and 100mm granular surround in accordance with manufacturers recommendations. All Units to be installed min 5m away from structure
-  Denotes new 1000 foul PVC below ground / floor drainage pipework min gradient 1:80
-  Denotes new 1000 surface water PVC below ground / floor drainage pipework min gradient 1:100
-  Denotes surface/foul 4500 osma inspection chamber to be provided at max 45m apart complete with B125 plastic cover and frames.

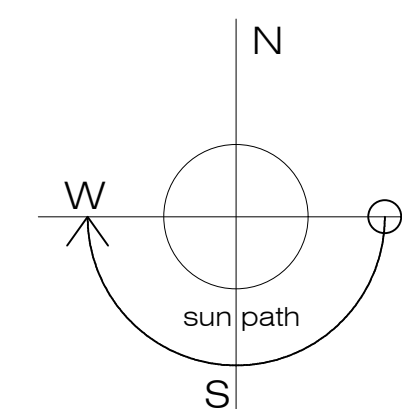

Atelier Associates
Architecture + design

Client:
MR JASON MILES
Project:
LAND ADJACENT HOLLAND HOUSE
Drawing Title:
PROPOSED DRAINAGE PLAN

Date	Designer	Checked	Purpose	Scale
16/02/2022	SS	-	PLANNING	1:100

Drawing number	Revision
JUL01.05.06	A

Barn B Home Farm Common Road Snettisham Norfolk PE317PD
T: 01485 542 729 E: hello@atelierassociates.uk